

INDUSTRIAL FOR LEASE

21 John Hiebert Drive RM of Springfield

(+/-) 1,500 - 3,000 sf Available

Ryan Munt

Executive Vice President

*Ryan Munt Personal Real
Estate Corporation*

T 204 928 5015

C 204 298 1905

ryan.munt@cwstevenson.ca

Shae Halpin

Senior Associate

T 204 560 2536

C 204 558 6071

shae.halpin@cwstevenson.ca



**CUSHMAN &
WAKEFIELD**
Winnipeg



Stevenson

INDUSTRIAL FOR LEASE



21 John Hiebert Drive RM of Springfield



Industrial bays 4 minutes from the Perimeter Highway

PROPERTY HIGHLIGHTS

- Situated just east of the City of Winnipeg and 2 minutes from Dugald Road and 4 minutes from the Perimeter Highway
- Each unit has 1 - 14'x14' grade loading door
- Floor drain in each unit

COMPOUND SPACE AVAILABLE

Unit	SF	Loading	Base Rent	CAM/TAX
104-105	3,000	3 Grade	\$1,750/month	\$375/month
203	1,500	1 Grade	\$1,750/month	\$375/month



Lease Rate: Starting at \$1,750 Per Month

CAM & Tax: \$375 Per Month (2025 est.)

INDUSTRIAL FOR LEASE

21 John Hiebert Drive - RM of Springfield

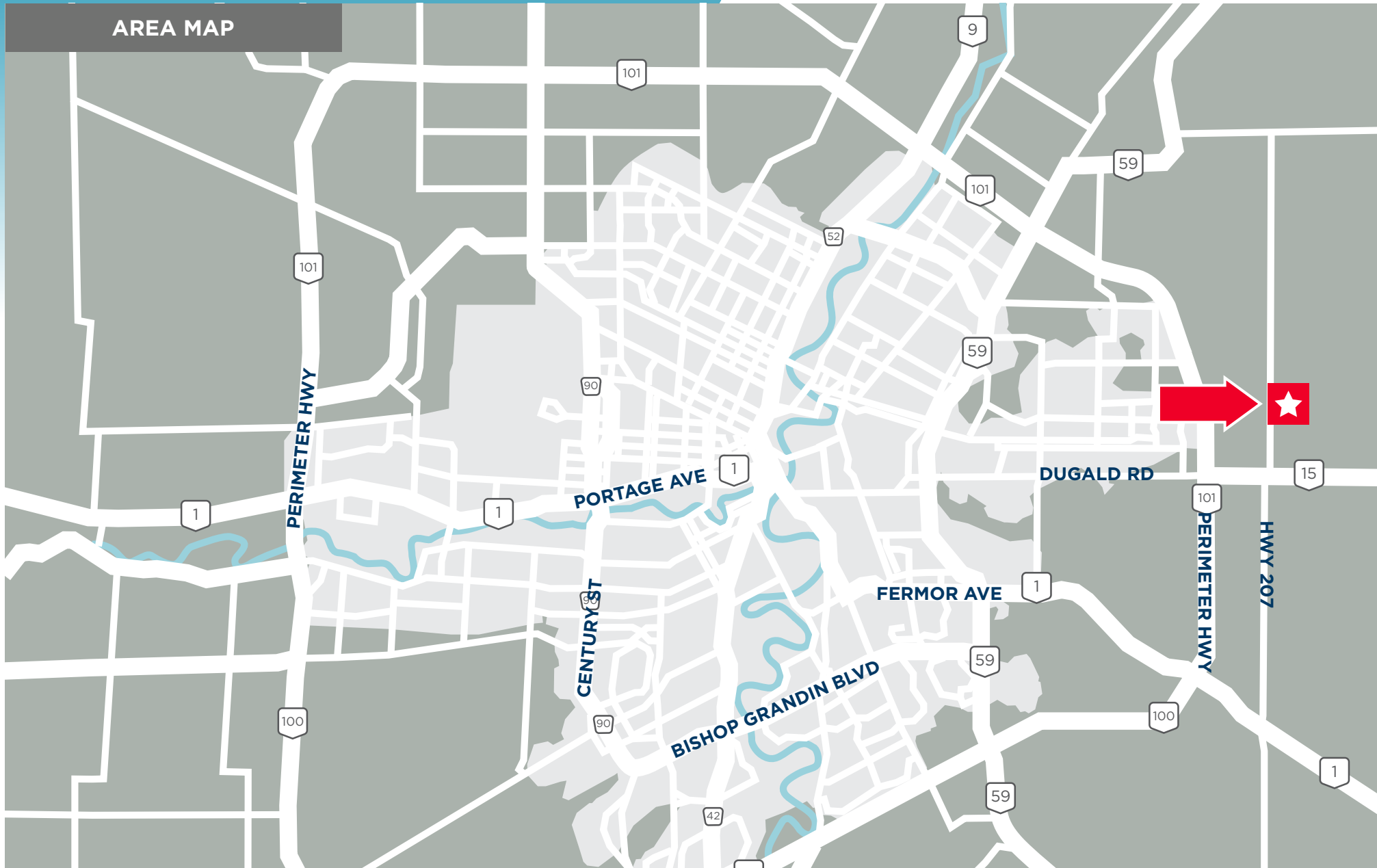

INDUSTRIAL FOR LEASE

21 John Hiebert Drive - RM of Springfield

SITE PLAN

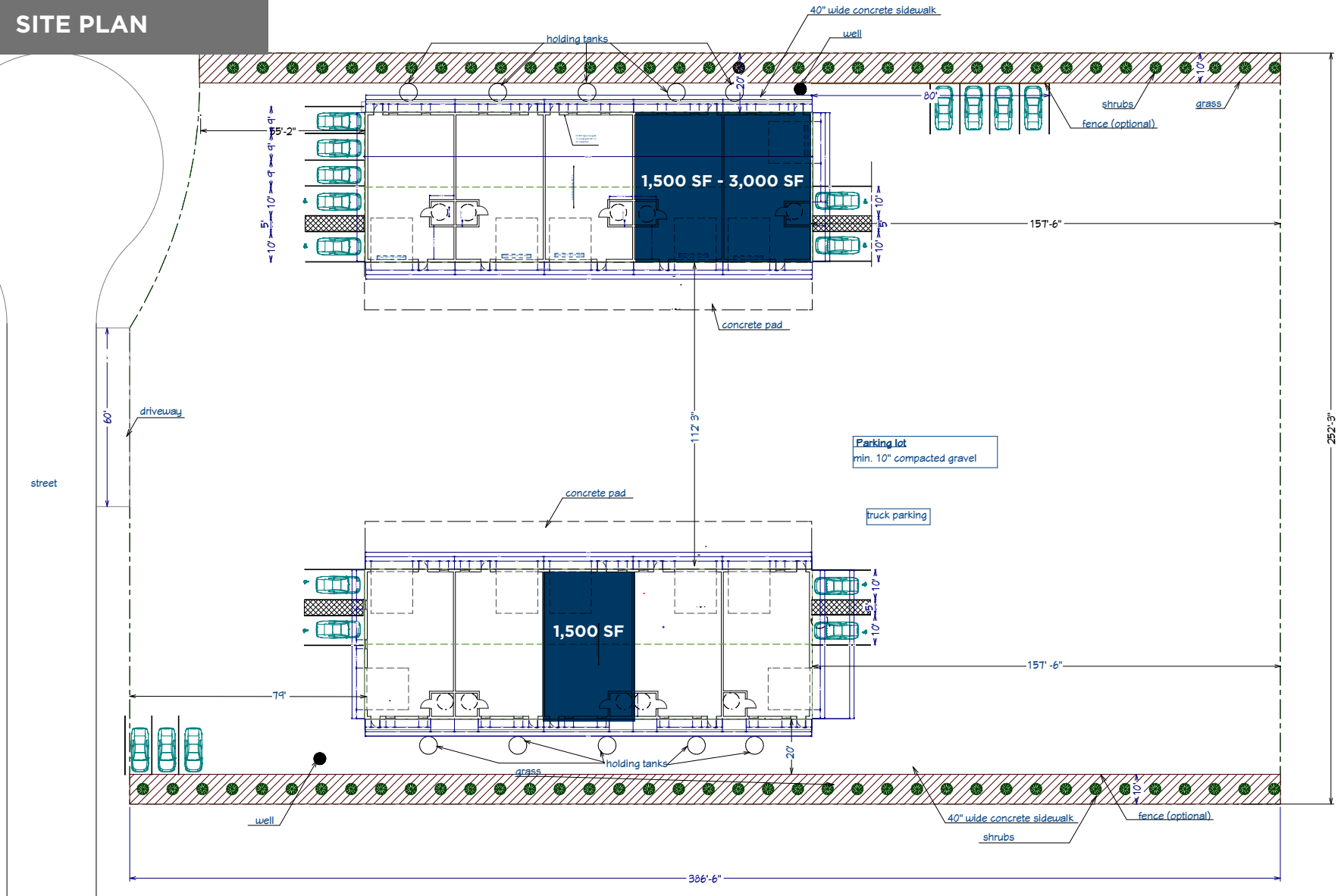

Ryan Munt
Executive Vice President

*Ryan Munt Personal
Real Estate Corporation*

T 204 928 5015

C 204 298 1905

ryan.munt@cwstevenson.ca

Shae Halpin
Senior Associate

T 204 560 2536

C 204 558 6071

shae.halpin@cwstevenson.ca

Independently Owned and Operated / A Member of the Cushman & Wakefield Alliance ©2022 Cushman & Wakefield. All rights reserved. The information contained in this communication is strictly confidential. This information has been obtained from sources believed to be reliable but has not been verified. NO WARRANTY OR REPRESENTATION, EXPRESS OR IMPLIED, IS MADE AS TO THE CONDITION OF THE PROPERTY (OR PROPERTIES) REFERENCED HEREIN OR AS TO THE ACCURACY OR COMPLETENESS OF THE INFORMATION CONTAINED HEREIN, AND SAME IS SUBMITTED SUBJECT TO ERRORS, OMISSIONS, CHANGE OF PRICE, RENTAL OR OTHER CONDITIONS, WITHDRAWAL WITHOUT NOTICE, AND TO ANY SPECIAL LISTING CONDITIONS IMPOSED BY THE PROPERTY OWNER(S). ANY PROJECTIONS, OPINIONS OR ESTIMATES ARE SUBJECT TO UNCERTAINTY AND DO NOT SIGNIFY CURRENT OR FUTURE PROPERTY PERFORMANCE.

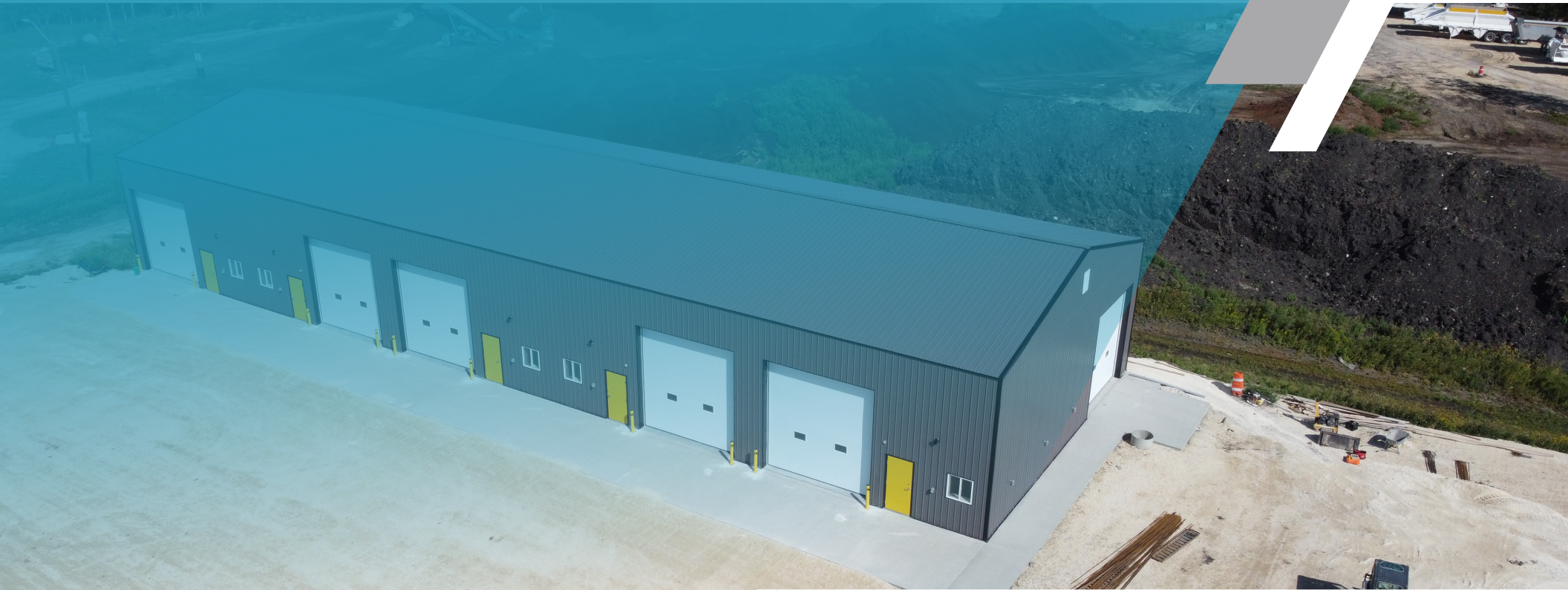

**CUSHMAN &
WAKEFIELD**
Winnipeg



Stevenson