

FOR SALE OR LEASE

# 2330

**GOLD MEADOW WAY**  
GOLD RIVER, CA

**± 24,000 RSF AVAILABLE**

**Walking Distance to Gold River Racquet Club and  
Upscale Gold River Shopping and Restaurants, Easy  
access to Highway 50, Professional Office Campus**



FOR MORE INFORMATION, PLEASE CONTACT:

**CHRIS SCHWARZE | EXECUTIVE DIRECTOR**

+1 916 288 4803

[chris.schwarze@cushwake.com](mailto:chris.schwarze@cushwake.com)

CA LIC #01291261

400 Capitol Mall Suite 1800

Sacramento, CA 95814

+1 916 288 4800

**[cushmanwakefield.com](http://cushmanwakefield.com)**

© Cushman & Wakefield. This information has been obtained from sources believed reliable. We have not verified it and make no guarantee, warranty or representation about it. Any projections, opinions, assumptions or estimates used are for example only and do not represent the current or future performance of the property. You and your advisors should conduct a careful, independent investigation of the property to determine to your satisfaction the suitability of the property for your needs.



# FOR SALE OR LEASE

# 2330

## GOLD MEADOW WAY

### GOLD RIVER, CA

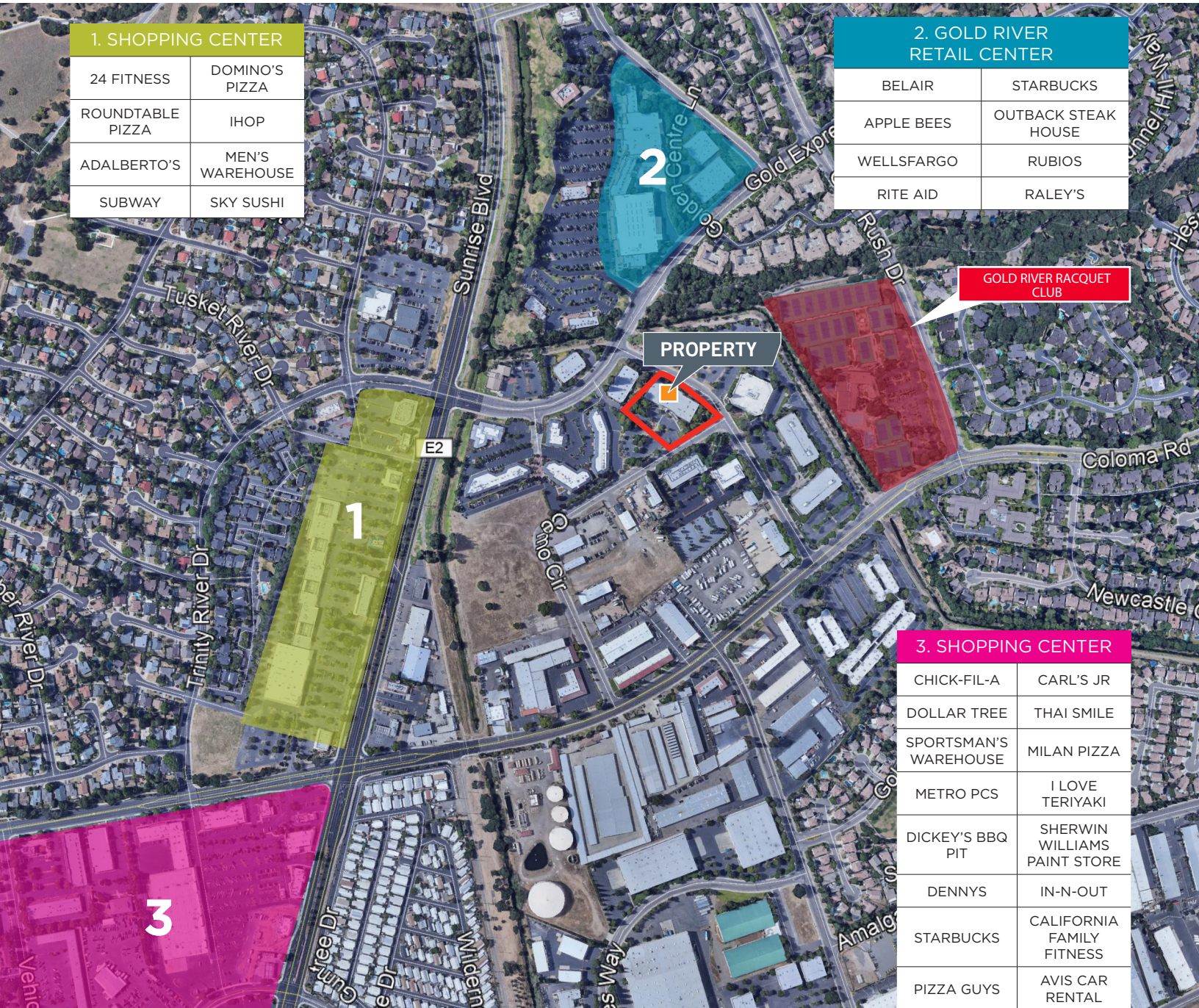

#### 1. SHOPPING CENTER

24 FITNESS	DOMINO'S PIZZA
ROUNDTABLE PIZZA	IHOP
ADALBERTO'S	MEN'S WAREHOUSE
SUBWAY	SKY SUSHI

#### 2. GOLD RIVER RETAIL CENTER

BELAIR	STARBUCKS
APPLE BEES	OUTBACK STEAK HOUSE
WELLSFARGO	RUBIOS
RITE AID	RALEY'S

#### 3. SHOPPING CENTER

CHICK-FIL-A	CARL'S JR
DOLLAR TREE	THAI SMILE
SPORTSMAN'S WAREHOUSE	MILAN PIZZA
METRO PCS	I LOVE TERIYAKI
DICKEY'S BBQ PIT	SHERWIN WILLIAMS PAINT STORE
DENNYS	IN-N-OUT
STARBUCKS	CALIFORNIA FAMILY FITNESS
PIZZA GUYS	AVIS CAR RENTAL

**CHRIS SCHWARZE | EXECUTIVE DIRECTOR**

+1 916 288 4803

chris.schwarze@cushwake.com

CA LIC #01291261

400 Capitol Mall Suite 1800

Sacramento, CA 95814

+1 916 288 4800

**cushmanwakefield.com**

© Cushman & Wakefield. This information has been obtained from sources believed reliable. We have not verified it and make no guarantee, warranty or representation about it. Any projections, opinions, assumptions or estimates used are for example only and do not represent the current or future performance of the property. You and your advisors should conduct a careful, independent investigation of the property to determine to your satisfaction the suitability of the property for your needs.



# FOR LEASE

# 2330

## GOLD MEADOW WAY

### GOLD RIVER, CA



## Floor Plan

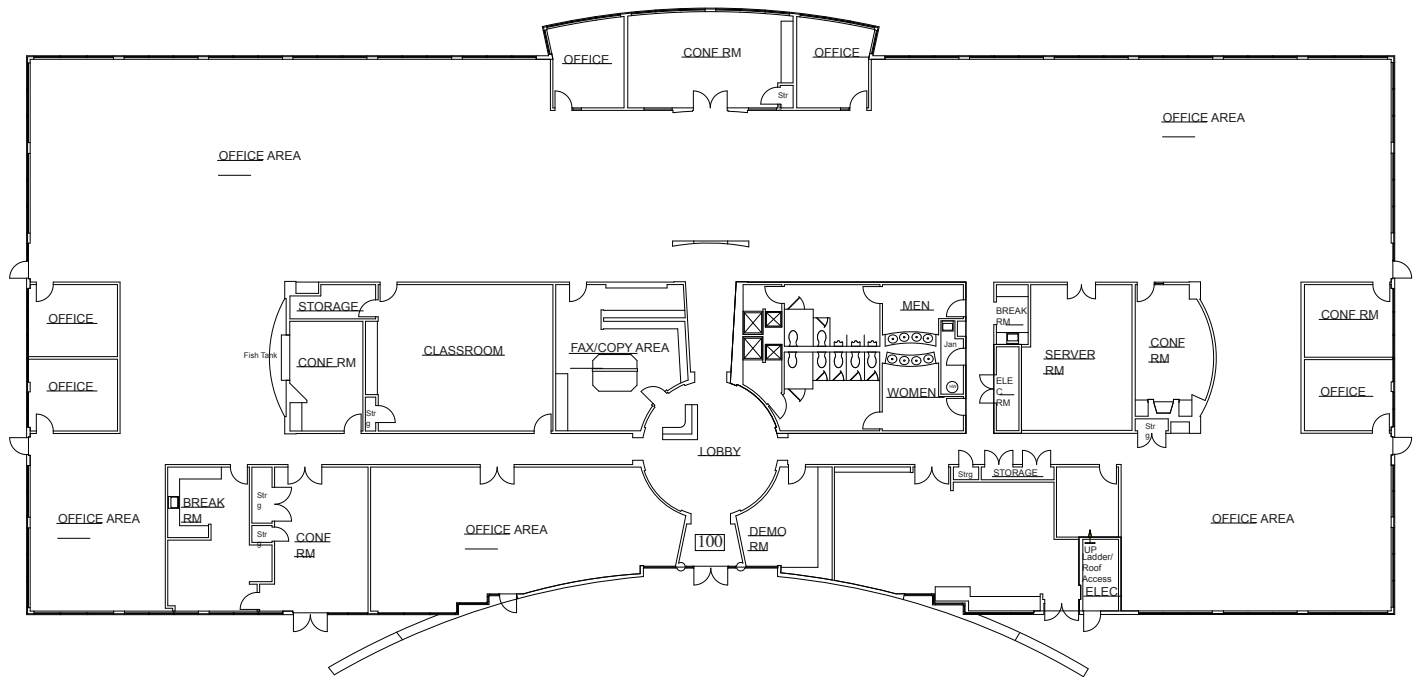

## Property Photos



### CHRIS SCHWARZE | EXECUTIVE DIRECTOR

+1 916 288 4803

chris.schwarze@cushwake.com

CA LIC #01291261

400 Capitol Mall Suite 1800

Sacramento, CA 95814

+1 916 288 4800

**cushmanwakefield.com**

© Cushman & Wakefield. This information has been obtained from sources believed reliable. We have not verified it and make no guarantee, warranty or representation about it. Any projections, opinions, assumptions or estimates used are for example only and do not represent the current or future performance of the property. You and your advisors should conduct a careful, independent investigation of the property to determine to your satisfaction the suitability of the property for your needs.