



**CUSHMAN &  
WAKEFIELD**

# OFFICE SUBLEASE

## South Terraces

115 Perimeter Center Place, Atlanta, GA 30346



**51,652 RSF**

**AVAILABLE ON  
2nd FLOOR**

**\$26.50/RSF**

**FULL-SERVICE  
QUOTED RATE**

**7/31/2029**

**SUBLEASE  
EXPIRATION**

**5.0/1,000 SF**

**COVERED  
PARKING**

## Space Features & Highlights

- Excellent views and elevator lobby exposure
- Highly improved space
- Move-in ready
- Furniture optional

## Excellent Amenities & Location

- Highly amenitized property with conference center, food options, fitness center and outdoor gathering space with putting green
- MARTA shuttle
- Walkable to abundant restaurants, retail and hotels

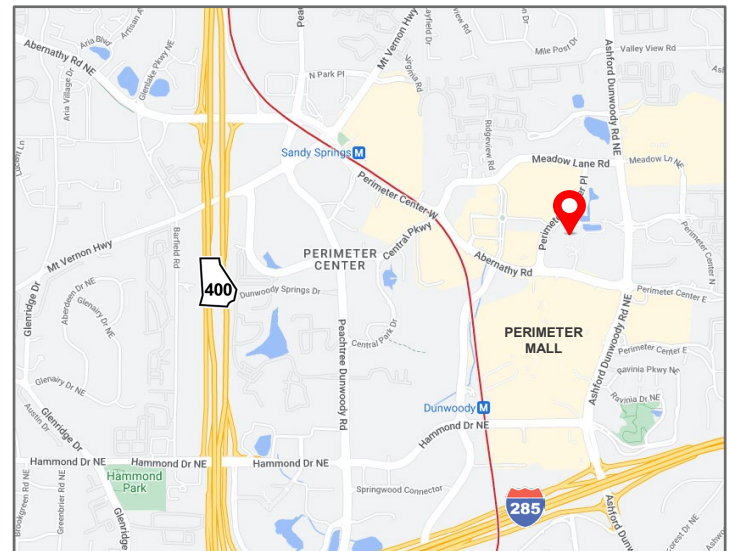

**KIRK DIAMOND**  
Executive Managing Director  
(404) 682 3407  
Kirk.diamond@cushwake.com  
License #150352

**APRIL PARRISH**  
Executive Director  
(404) 682 3413  
april.parrish@cushwake.com  
License #301359

**ERIN SMITH**  
Senior Director  
(404) 682 3444  
erin.smith@cushwake.com  
License #337500

**CUSHMAN & WAKEFIELD, INC.**  
1180 Peachtree Street, NE, Suite 3100  
Atlanta, Georgia 30309  
www.cushmanwakefield.com

The depiction in the included photograph of any person, entity, sign, logo or property, other than Cushman & Wakefield's (C&W) client and the property offered by C&W, is incidental only, and is not intended to connote any affiliation, connection, association, sponsorship or approval by or between that which is incidentally depicted and C&W or its client. This listing shall not be deemed an offer to lease, sublease or sell such property; and, in the event of any transaction for such property, no commission shall be earned by or payable to any cooperating broker except if otherwise provided pursuant to the express terms, rates and conditions of C&W's agreement with its principal, if, as and when such commission (if any) is actually received from such principal. (A copy of the rates and conditions referred to above with respect to this property is available upon request.)





**KIRK DIAMOND**  
Executive Managing Director  
(404) 682 3407  
Kirk.diamond@cushwake.com  
License #150352

**APRIL PARRISH**  
Executive Director  
(404) 682 3413  
april.Parrish@cushwake.com  
License #301359

**ERIN SMITH**  
Senior Director  
(404) 682 3444  
erin.smith@cushwake.com  
License #337500

**CUSHMAN & WAKEFIELD, INC.**  
1180 Peachtree Street, NE, Suite 3100  
Atlanta, Georgia 30309  
www.cushmanwakefield.com

The depiction in the included photograph of any person, entity, sign, logo or property, other than Cushman & Wakefield's (C&W) client and the property offered by C&W, is incidental only, and is not intended to connote any affiliation, connection, association, sponsorship or approval by or between that which is incidentally depicted and C&W or its client. This listing shall not be deemed an offer to lease, sublease or sell such property; and, in the event of any transaction for such property, no commission shall be earned by or payable to any cooperating broker except if otherwise provided pursuant to the express terms, rates and conditions of C&W's agreement with its principal, if, as and when such commission (if any) is actually received from such principal. (A copy of the rates and conditions referred to above with respect to this property is available upon request.)

## Suite 200 – 25,826 SF

- 151 workstations
- 7 private offices
- 2 conference rooms
- 5 copy/storage rooms
- 1 training room
- 1 huddle room
- 1 break room
- 1 wellness/mother room
- 1 reception

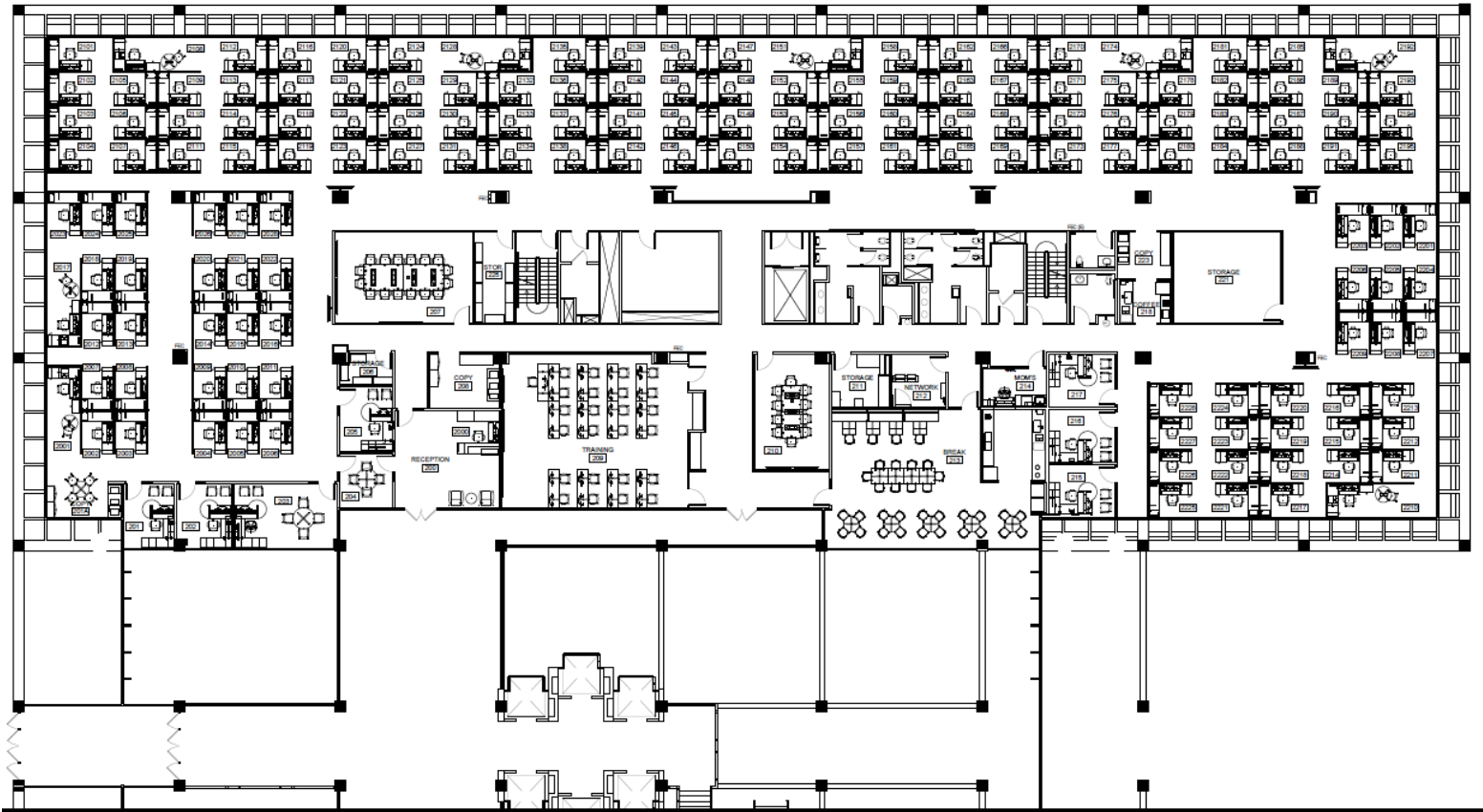

**KIRK DIAMOND**  
Executive Managing Director  
(404) 682 3407  
Kirk.diamond@cushwake.com  
License #150352

**APRIL PARRISH**  
Executive Director  
(404) 682 3413  
april.Parrish@cushwake.com  
License #301359

**ERIN SMITH**  
Senior Director  
(404) 682 3444  
erin.smith@cushwake.com  
License #337500

**CUSHMAN & WAKEFIELD, INC.**  
1180 Peachtree Street, NE, Suite 3100  
Atlanta, Georgia 30309  
www.cushmanwakefield.com

The depiction in the included photograph of any person, entity, sign, logo or property, other than Cushman & Wakefield's (C&W) client and the property offered by C&W, is incidental only, and is not intended to connote any affiliation, connection, association, sponsorship or approval by or between that which is incidentally depicted and C&W or its client. This listing shall not be deemed an offer to lease, sublease or sell such property; and, in the event of any transaction for such property, no commission shall be earned by or payable to any cooperating broker except if otherwise provided pursuant to the express terms, rates and conditions of C&W's agreement with its principal, if, as and when such commission (if any) is actually received from such principal. (A copy of the rates and conditions referred to above with respect to this property is available upon request.)



## Suite 250 – 25,826 SF

- 147 workstations
- 6 private offices
- 2 conference rooms
- 7 copy/storage rooms
- 2 training rooms
- 1 huddle room
- 1 break room
- 1 wellness/mother room
- 1 reception

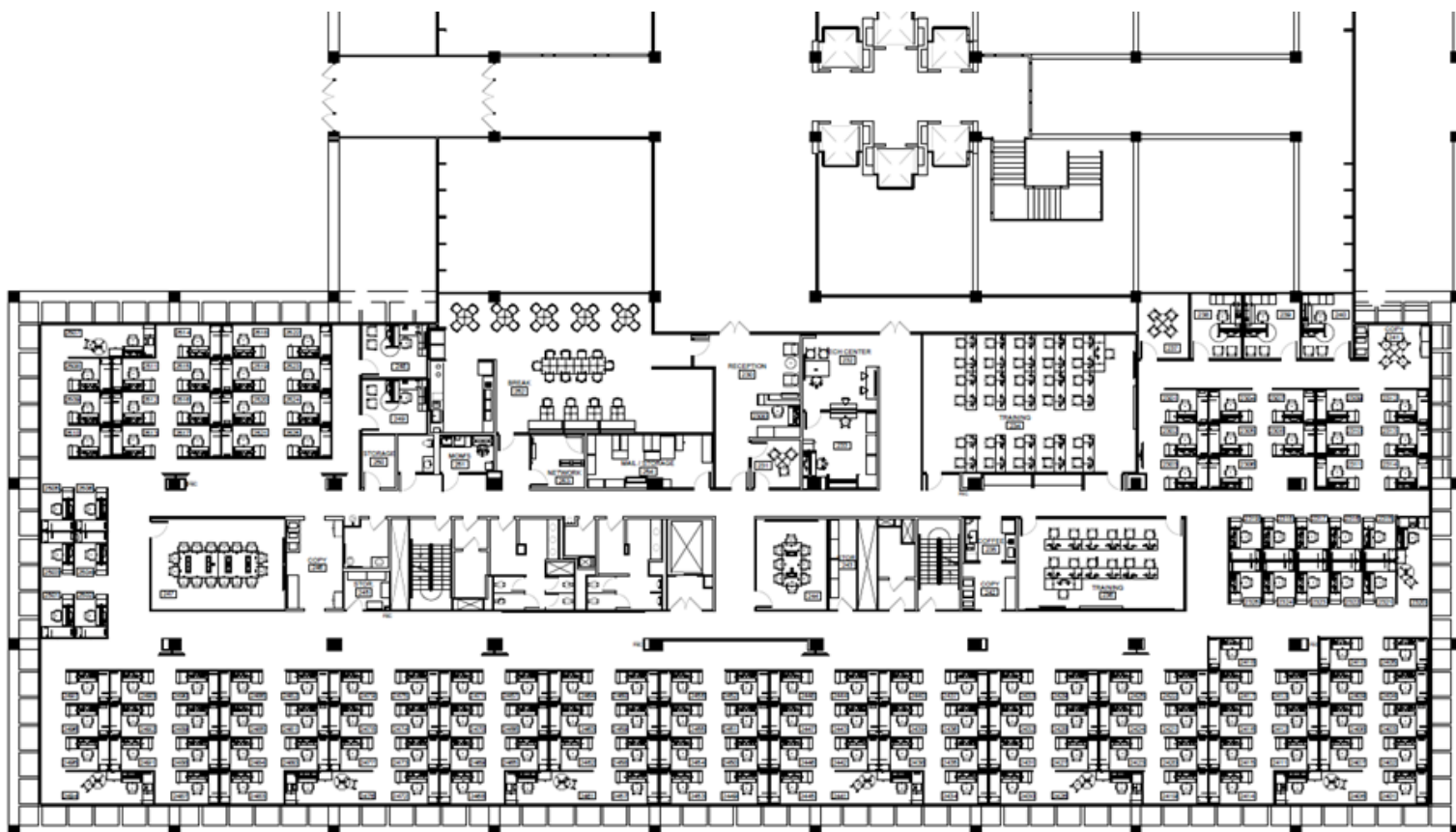

**KIRK DIAMOND**  
Executive Managing Director  
(404) 682 3407  
[Kirk.diamond@cushwake.com](mailto:Kirk.diamond@cushwake.com)  
License #150352

**APRIL PARRISH**  
Executive Director  
(404) 682 3413  
[april.Parrish@cushwake.com](mailto:april.Parrish@cushwake.com)  
License #301359

**ERIN SMITH**  
Senior Director  
(404) 682 3444  
[erin.smith@cushwake.com](mailto:erin.smith@cushwake.com)  
License #337500

**CUSHMAN & WAKEFIELD, INC.**  
1180 Peachtree Street, NE, Suite 3100  
Atlanta, Georgia 30309  
[www.cushmanwakefield.com](http://www.cushmanwakefield.com)

The depiction in the included photograph of any person, entity, sign, logo or property, other than Cushman & Wakefield's (C&W) client and the property offered by C&W, is incidental only, and is not intended to connote any affiliation, connection, association, sponsorship or approval by or between that which is incidentally depicted and C&W or its client. This listing shall not be deemed an offer to lease, sublease or sell such property; and, in the event of any transaction for such property, no commission shall be earned by or payable to any cooperating broker except if otherwise provided pursuant to the express terms, rates and conditions of C&W's agreement with its principal, if, as and when such commission (if any) is actually received from such principal. (A copy of the rates and conditions referred to above with respect to this property is available upon request.)