

1400 N MCDOWELL, PETALUMA

SUITE 300 ± 24,000 SF

AVAILABLE FOR SUBLEASE

MOVE IN READY



Whitney Strotz
Executive Managing Director
+1 415 451 2406
whitney.strotz@cushwake.com
LIC #01351397

Trevor Buck
Executive Managing Director
+1 415 451 2436
trevor.buck@cushwake.com
LIC #01255462

Brian Foster
Executive Director
+1 415 451 2437
brian.foster@cushwake.com
Lic #: 01393059





AVAILABLE SPACE

± 24,000 RSF

END OF MASTER LEASE

1/31/2026

ASKING RATE

\$1.75 FULL SERVICE

Turn-key office space. Entire top floor with exposed ceilings, quality finishes and mix of private offices and open space. Furniture potentially available.

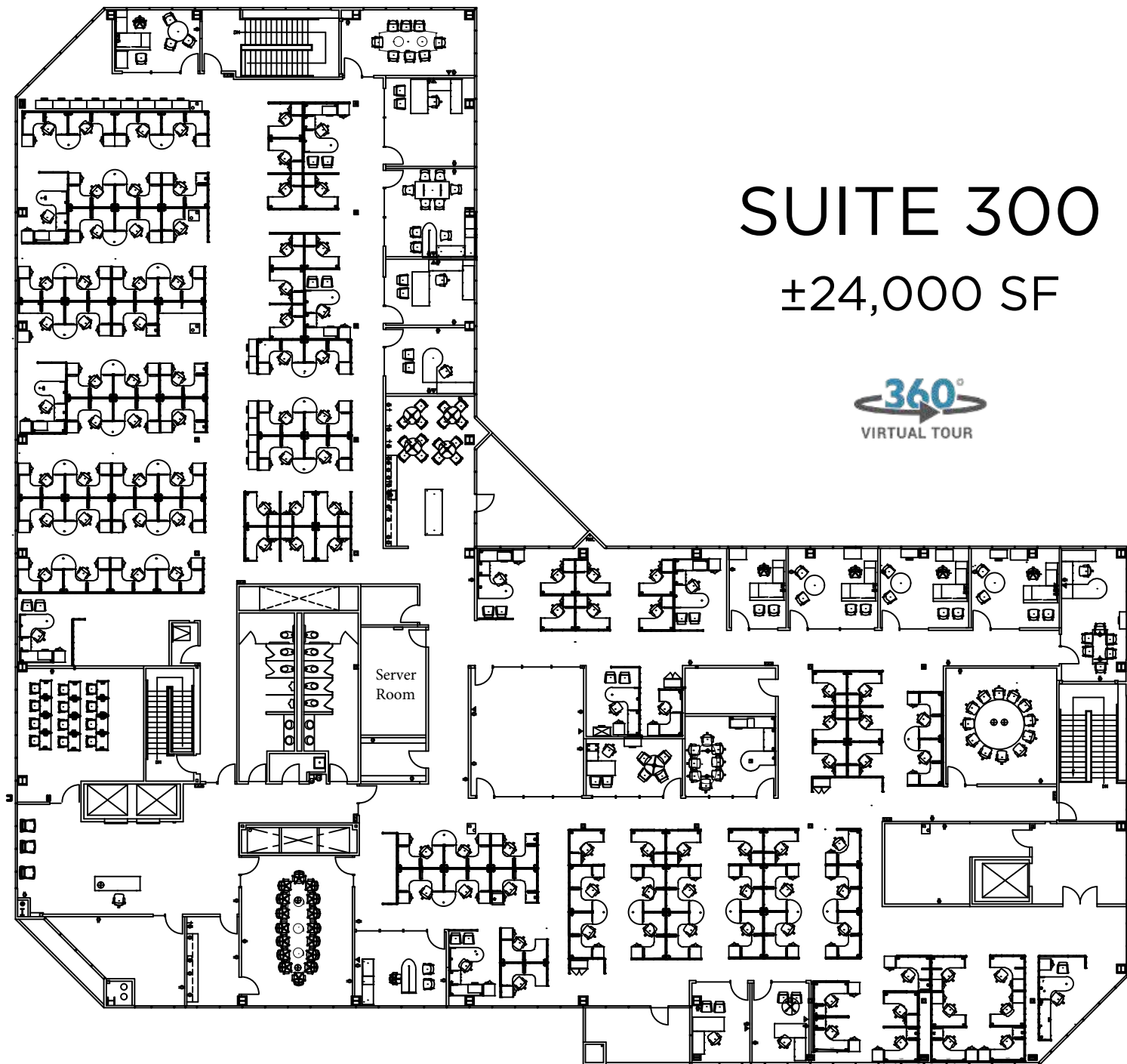

SUITE 300

±24,000 SF



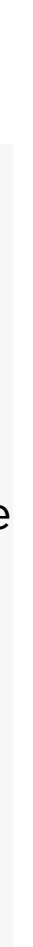

Property Highlights

- Located within Redwood Business Park
- Extensive outdoor space
- Volleyball court on site
- Patio area with outdoor seating
- 80 Surface parking spaces
- Electric Vehicle charging stations
- Abundant natural light
- Easy freeway access
- 3.6/1000 parking

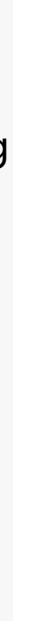



FOOD/BEVERAGE

1. Applebee's
2. IHOP
3. Aloha
4. Goat Rock Cider Company
5. Lagunitas Brewing Company
6. Griffo Distillery
7. Cattleman's
8. Denny's
9. Sonoma Sourdough
10. Henhouse Brewing

OFFICES

1. Scott Porter Corporation, PC
2. Calix
3. IWA Wine Accessories
4. Optio Solutions LLC
5. Sonoma Technology Inc
6. TiBiT Communications
7. Enphase Energy
8. WRA Inc
9. KBI Painting Inc

RETAIL

1. UPS Store
2. Kohl's
3. Wilco Farm Store
4. Autoworld Jeep
5. Victory Chevrolet
6. Hansel Toyota
7. North Bay Nissan
8. Cycle West Honda Suzuki
9. Bay Alarm
10. Electrical Equipment Co Inc
11. Flooring America

INDUSTRIAL

1. FEED Sonoma
2. TWiT
3. Marin Sonoma Produce

*Not all businesses listed