

**LIBERTYVILLE**  
CORPORATE CENTER

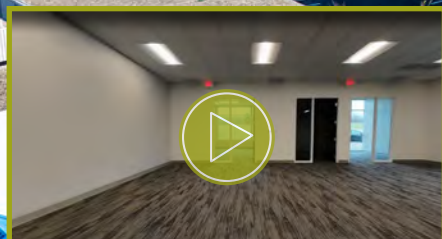

**1850 & 1900 US-45 | Libertyville, IL**



[CLICK TO VIEW SPEC OFFICE](#)

Divisible  
**40,000 - 168,789 SF**

**Up to ±297,598 SF**  
Industrial Space for Lease

Ready for Occupancy  
**with Spec Office &  
Warehouse Lighting**

For more information, please contact:



**KEITH PURITZ**  
Vice Chairman  
+1 847 720 1366  
keith.puritz@cushwake.com

**BRETT KRONER**  
Vice Chairman  
+1 847 720 1367  
brett.kroner@cushwake.com

**ERIC FISCHER**  
Vice Chairman  
+1 847 720 1369  
eric.fischer@cushwake.com

**MARC SAMUELS**  
Senior Director  
+1 847 720 1368  
marc.samuels@cushwake.com



# PROJECT Overview



## 1900 US-45

**128,809 SF**

Available Size

**4,449 SF**

Spec Office Space

**18**

Exterior Docks

**3**

Drive-In Doors

**ESFR Sprinkler**

Fire Suppression

**164,958 SF**

Total Building Size

**32' Clear**

Ceiling Height

**52' x 50' | 52' x 60'**

Bay Spacing | Speed Bay

**140 Spaces**

Car Parking

## 1850 US-45

**168,789 SF**

Available Size

**4,449 SF**

Permitted Spec Office Space

**24**

Exterior Docks

**4**

Drive-In Doors

**ESFR Sprinkler**

Fire Suppression

**168,789 SF**

Total Building Size

**32' Clear**

Ceiling Height

**52' x 50' | 52' x 60'**

Bay Spacing | Speed Bay

**202 Spaces**

Car Parking

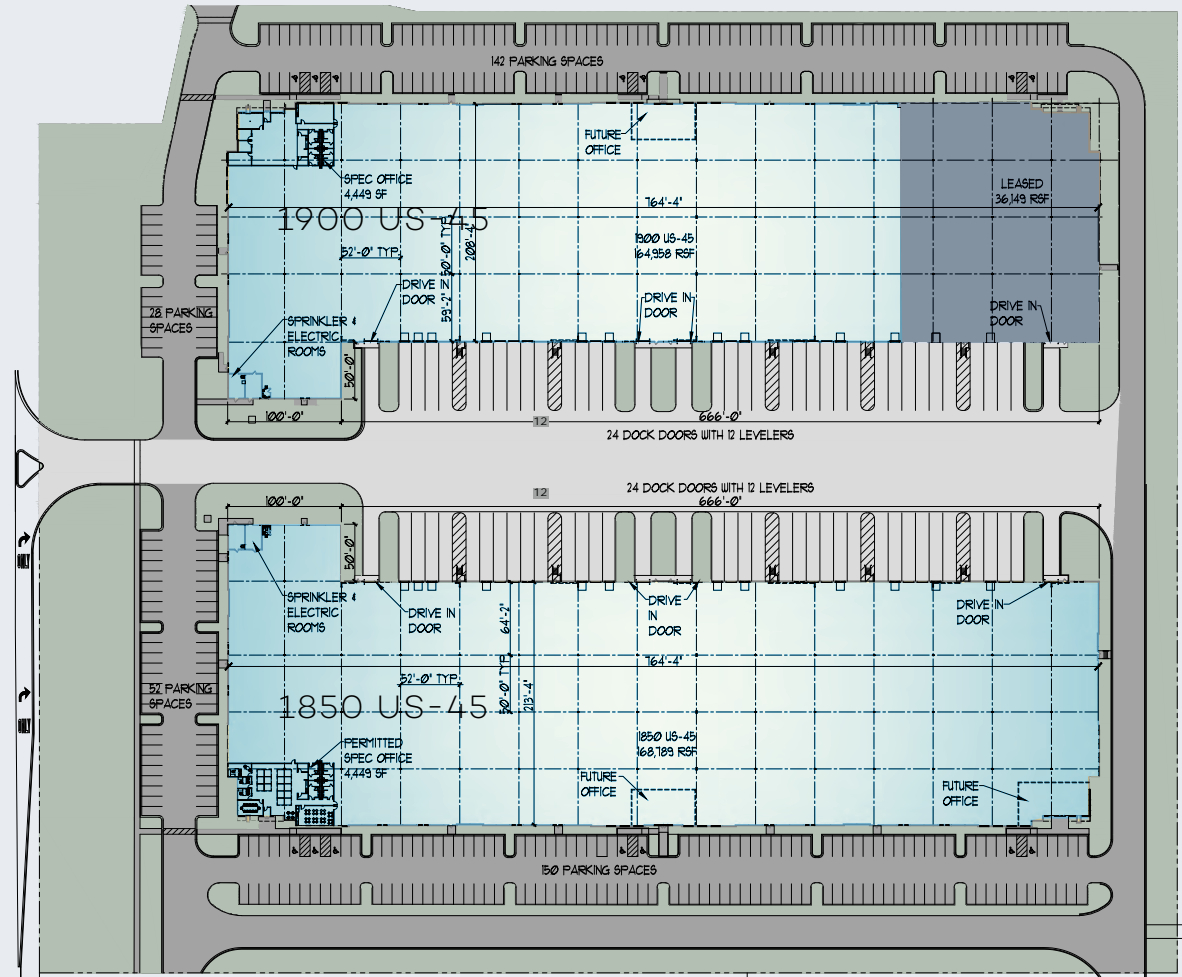

For more information, please contact:



**KEITH PURITZ**  
Vice Chairman  
+1 847 720 1366  
keith.puritz@cushwake.com

**BRETT KRONER**  
Vice Chairman  
+1 847 720 1367  
brett.kroner@cushwake.com

**ERIC FISCHER**  
Vice Chairman  
+1 847 720 1369  
eric.fischer@cushwake.com

**MARC SAMUELS**  
Senior Director  
+1 847 720 1368  
marc.samuels@cushwake.com





# BUILDING Images



[CLICK TO VIEW WAREHOUSE](#)

For more information, please contact:



**KEITH PURITZ**  
Vice Chairman  
+1 847 720 1366  
[keith.puritz@cushwake.com](mailto:keith.puritz@cushwake.com)

**BRETT KRONER**  
Vice Chairman  
+1 847 720 1367  
[brett.kroner@cushwake.com](mailto:brett.kroner@cushwake.com)

**ERIC FISCHER**  
Vice Chairman  
+1 847 720 1369  
[eric.fischer@cushwake.com](mailto:eric.fischer@cushwake.com)

**MARC SAMUELS**  
Senior Director  
+1 847 720 1368  
[marc.samuels@cushwake.com](mailto:marc.samuels@cushwake.com)





# LOCATION Overview



Easy Access from **Route-45**

Only 5 Miles to **I-94**

Adjacent to the  
**Libertyville Sports Complex**

*(Business Memberships Available)*

For more information, please contact:



**KEITH PURITZ**  
Vice Chairman  
+1 847 720 1366  
keith.puritz@cushwake.com

**BRETT KRONER**  
Vice Chairman  
+1 847 720 1367  
brett.kroner@cushwake.com

**ERIC FISCHER**  
Vice Chairman  
+1 847 720 1369  
eric.fischer@cushwake.com

**MARC SAMUELS**  
Senior Director  
+1 847 720 1368  
marc.samuels@cushwake.com





# LOCATION Overview



Strong  
Labor Pool

Easy Access  
to I-94

Low Lake County  
Real Estate Taxes

Pro-Business  
County & Community



For more information, please contact:



**KEITH PURITZ**  
Vice Chairman  
+1 847 720 1366  
keith.puritz@cushwake.com

**BRETT KRONER**  
Vice Chairman  
+1 847 720 1367  
brett.kroner@cushwake.com

**ERIC FISCHER**  
Vice Chairman  
+1 847 720 1369  
eric.fischer@cushwake.com

**MARC SAMUELS**  
Senior Director  
+1 847 720 1368  
marc.samuels@cushwake.com







30 Miles to  
O'Hare International  
Airport

Close to  
Downtown Libertyville with  
Abundant Dining, Shopping &  
Events

For more information, please contact:

**KEITH PURITZ**

Vice Chairman  
+1 847 720 1366  
keith.puritz@cushwake.com

**BRETT KRONER**

Vice Chairman  
+1 847 720 1367  
brett.kroner@cushwake.com

**ERIC FISCHER**

Vice Chairman  
+1 847 720 1369  
eric.fischer@cushwake.com

**MARC SAMUELS**

Senior Director  
+1 847 720 1368  
marc.samuels@cushwake.com



© 2025 Cushman & Wakefield. All rights reserved. The information contained in this communication is confidential, may be privileged and is intended for the exclusive use of the above named addressee(s). If you are not the intended recipient(s), you are expressly prohibited from copying, distributing, disseminating, or in any other way using any information contained within this communication. This information has been obtained from sources believed to be reliable but has not been verified. NO WARRANTY OR REPRESENTATION, EXPRESS OR IMPLIED, IS MADE AS TO THE CONDITION OF THE PROPERTY (OR PROPERTIES) REFERENCED HEREIN OR AS TO THE ACCURACY OR COMPLETENESS OF THE INFORMATION CONTAINED HEREIN, AND SAME IS SUBMITTED SUBJECT TO ERRORS, OMISSIONS, CHANGE OF PRICE, RENTAL OR OTHER CONDITIONS, WITHDRAWAL WITHOUT NOTICE, AND TO ANY SPECIAL LISTING CONDITIONS IMPOSED BY THE PROPERTY OWNER(S). ANY PROJECTIONS, OPINIONS OR ESTIMATES ARE SUBJECT TO UNCERTAINTY AND DO NOT SIGNIFY CURRENT OR FUTURE PROPERTY PERFORMANCE. This e-mail may be considered advertising under federal law.

