

# VIRGINIA 95 BUSINESS PARK



## BUILDING 7

7501 BOSTON BLVD, SPRINGFIELD, VA

OFFICE/LAB SPACE FOR LEASE

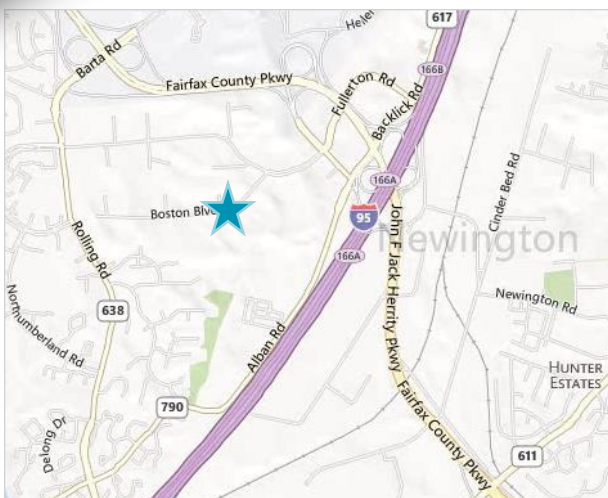

## FEATURES

- 81,768 RSF (Divisible)
- Built out as lab and office
- Approximately 5,000 SF of existing lab space
- Secure Facility
- Rental Rate: Negotiable
- Excellent window line
- Available immediately
- Parking: 4.4/1,000 SF

## PROPERTY HIGHLIGHTS

- First Class Business Park
- Secure Park
- Stable Ownership
- Zoned I-5
- Abundant Parking

Exclusively leased by:

**JON LAWRENCE**

Executive Director

703 448 1200

jon.lawrence@cushwake.com

**CUSHMAN & WAKEFIELD OF VIRGINIA, INC.**

1800 Tysons Boulevard, Suite 200,

Tysons Corner, VA 22102

www.cushmanwakefield.com

Cushman & Wakefield Copyright 2022. No warranty or representation, express or implied, is made to the accuracy or completeness of the information contained herein, and same is submitted subject to errors, omissions, change of price, rental or other conditions, withdrawal without notice, and to any special listing conditions imposed by the property owner(s). As applicable, we make no representation as to the condition of the property (or properties) in question.

# VIRGINIA 95 BUSINESS PARK



## BUILDING 7

7501 BOSTON BLVD, SPRINGFIELD, VA

OFFICE/LAB SPACE FOR LEASE

### FLOORPLANS

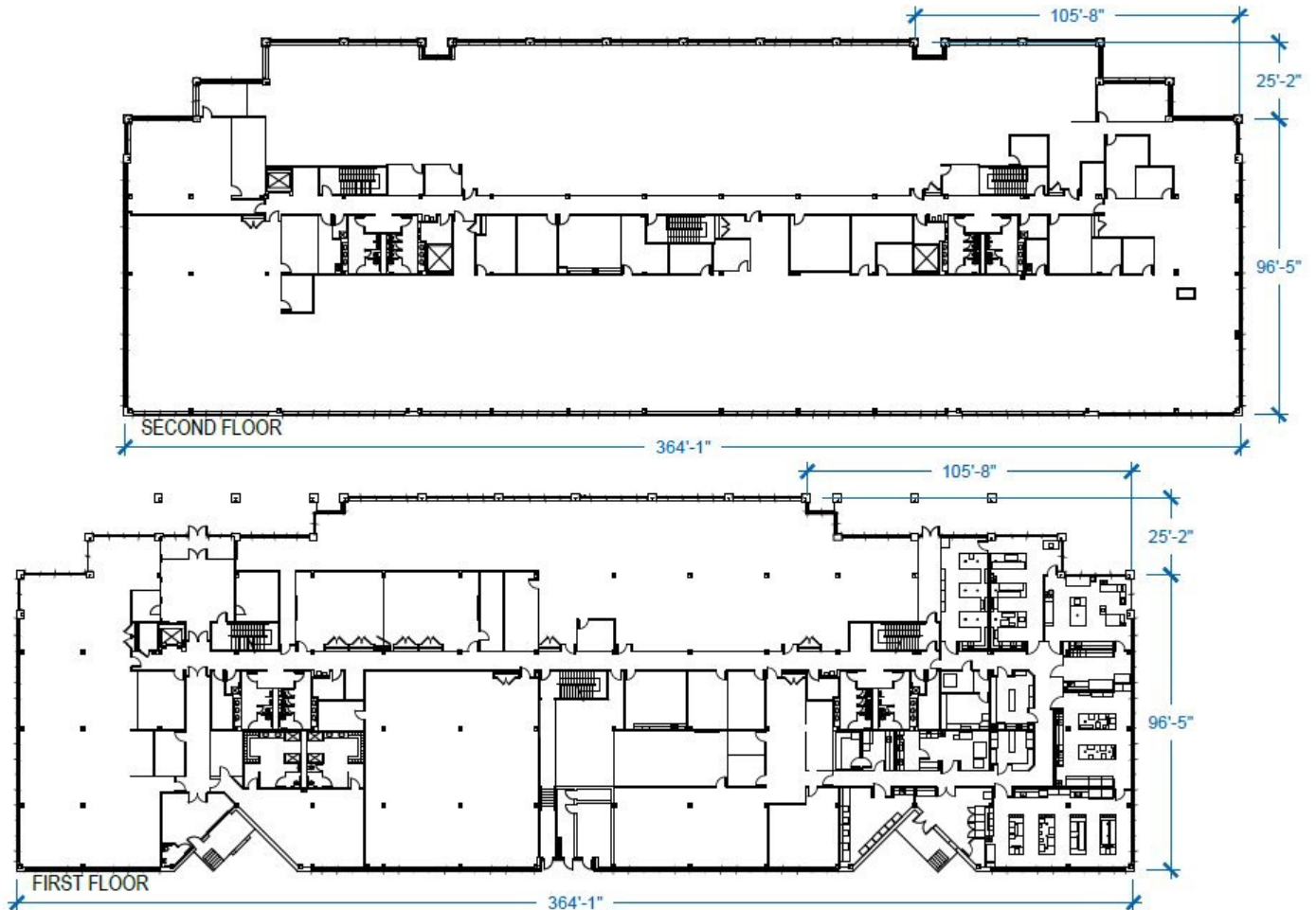

Exclusively leased by:  
**JON LAWRENCE**  
Executive Director  
703 448 1200  
jon.lawrence@cushwake.com

**CUSHMAN & WAKEFIELD OF VIRGINIA, INC.**  
1800 Tysons Boulevard, Suite 200,  
Tysons Corner, VA 22102  
www.cushmanwakefield.com

Cushman & Wakefield Copyright 2022. No warranty or representation, express or implied, is made to the accuracy or completeness of the information contained herein, and same is submitted subject to errors, omissions, change of price, rental or other conditions, withdrawal without notice, and to any special listing conditions imposed by the property owner(s). As applicable, we make no representation as to the condition of the property (or properties) in question.