

# CORPORATE CENTER NORTH

6026 LAKESIDE BLVD. INDIANAPOLIS, IN 46278



**FOR SUBLEASE – 31,654 SF**  
CONVENIENTLY LOCATED AT I-465 & 71ST STREET





# PROPERTY HIGHLIGHTS







- 31,654 RSF AVAILABLE
- Divisible down to 10,000 SF
- Asking Rate: \$10.00 Modified Gross
- Term through 2028
- Above Standard Parking Ratio
- Tenant Improvement available
- Furniture available
- Exterior Signage Facing I-465

# FLOOR PLAN

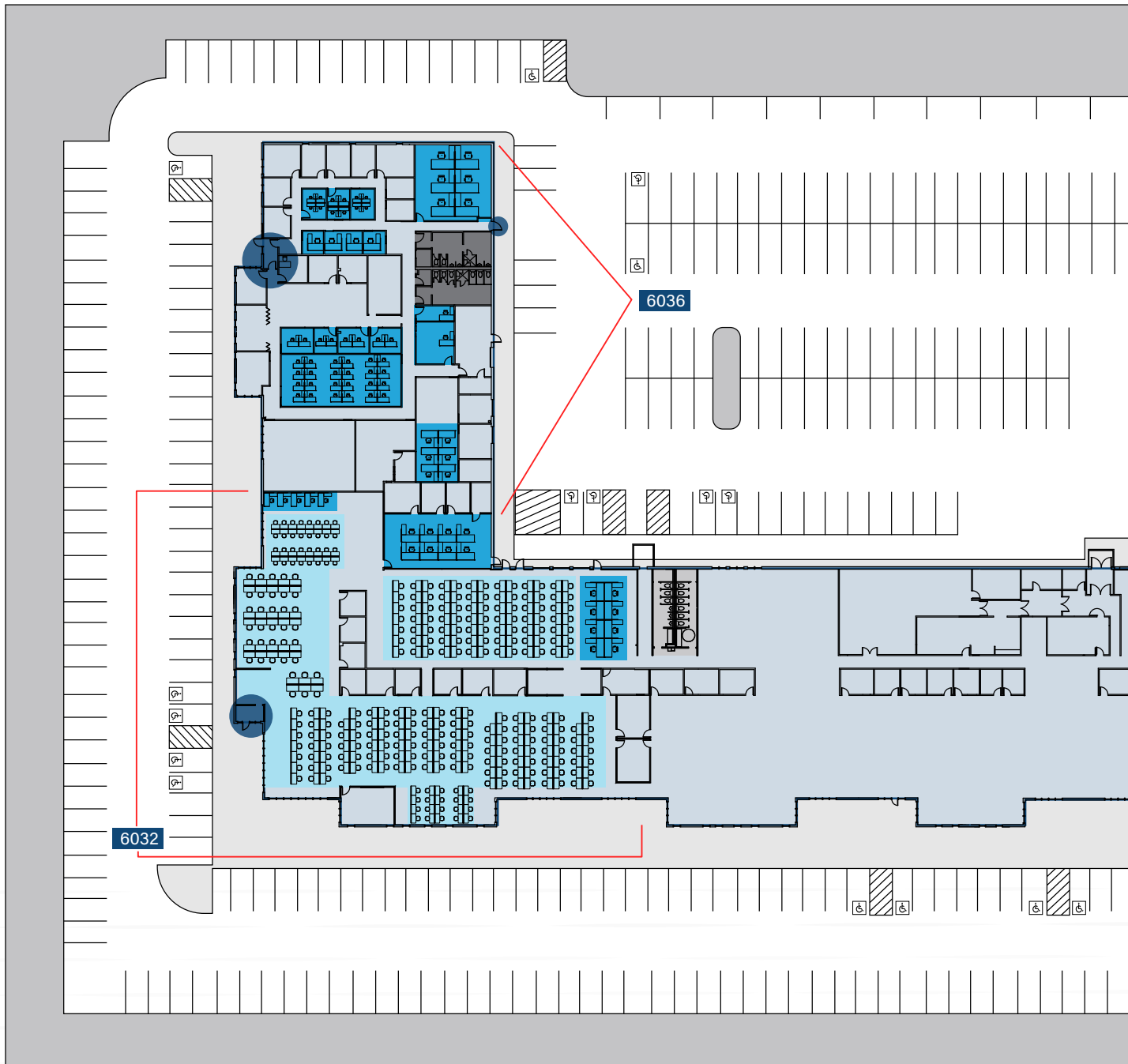

- 78 Admin cubicles
- 303 Agent & Supervisor cubicles
- Front and back entrances

## MATTERPORT LINK

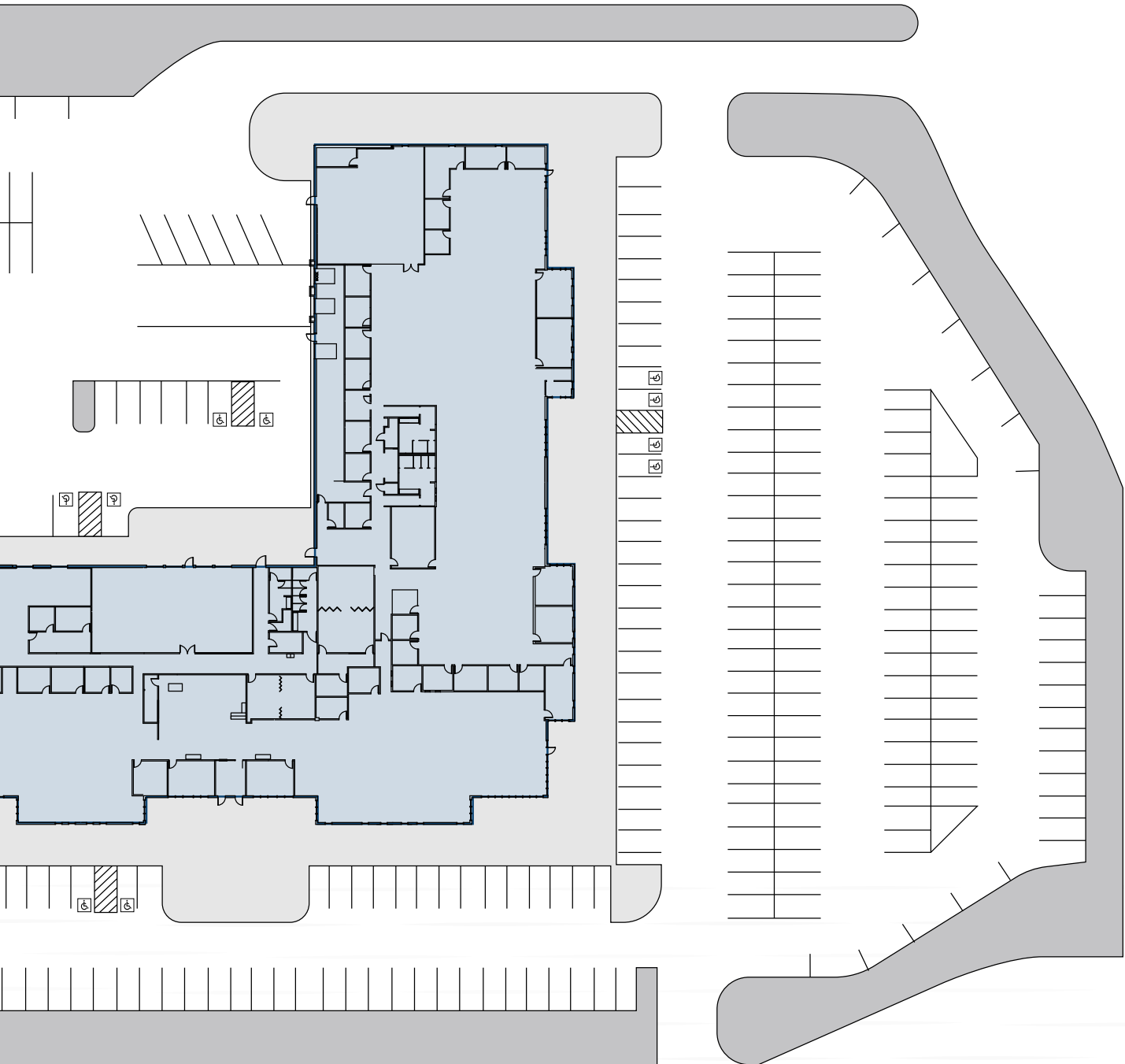

# AMENITY-RICH LOCATION

## EAT

- |    |                           |    |                     |    |                     |
|----|---------------------------|----|---------------------|----|---------------------|
| 1  | Traders Brewing Company   | 18 | Starbucks           | 35 | Noodles & Company   |
| 2  | Burger King               | 19 | Circle K Stores     | 36 | Skyline Chili       |
| 3  | Culver's                  | 20 | GetGo Cafe + Market | 37 | Ted's Montana Grill |
| 4  | Five Guys                 | 21 | GetGo Cafe + Market | 38 | Zaxby's             |
| 5  | McDonald's                | 22 | Cold Stone Creamery | 39 | Blaze Pizza         |
| 6  | McDonald's                | 23 | Chicken Salad Chick | 40 | Donatos Pizzeria    |
| 7  | McDonald's                | 24 | Einstein Brothers   | 41 | Marco's Pizza       |
| 8  | Steak 'n Shake            | 25 | McAlister's Deli    | 42 | Firehouse Subs      |
| 9  | Wendy's                   | 26 | Panda Express       | 43 | Jimmy John's        |
| 10 | Wendy's                   | 27 | Qdoba               | 44 | Jimmy John's        |
| 11 | White Castle              | 28 | Qdoba               | 45 | Panera Bread        |
| 12 | Dairy Queen               | 29 | Chili's Grill & Bar | 46 | Penn Station        |
| 13 | KFC                       | 30 | Crafty Crab         | 47 | Subway              |
| 14 | Popeyes Louisiana Kitchen | 31 | Denny's             | 48 | Subway              |
| 15 | Costa Coffee              | 32 | Famous Dave's       | 49 | Subway              |
| 16 | Starbucks                 | 33 | Le Peep             | 50 | Taco Bell           |
| 17 | Starbucks                 | 34 | LongHorn Steakhouse | 51 | Taco Bell           |

## LIVE

- |    |                       |    |                    |
|----|-----------------------|----|--------------------|
| 1  | Books-A-Million       | 18 | Do It Best         |
| 2  | Party City            | 19 | ALDI               |
| 3  | Shoppers World        | 20 | ALDI               |
| 4  | Old Navy              | 21 | Save-A-Lot         |
| 5  | Ross Stores           | 22 | Anytime Fitness    |
| 6  | Big Lots Stores       | 23 | CycleBar           |
| 7  | Five Below            | 24 | LA Fitness         |
| 8  | Batteries Plus Bulbs  | 25 | Shoe Carnival      |
| 9  | Mattress Firm         | 26 | Kroger             |
| 10 | Michaels              | 27 | The RoomPlace      |
| 11 | Lowe's                | 28 | AMC Theaters       |
| 12 | Goodwill              | 29 | Studio Movie Grill |
| 13 | Goodwill              | 30 | YMCA               |
| 14 | Office Depot          | 31 | CVS                |
| 15 | PetSmart              | 32 | CVS                |
| 16 | Dick's Sporting Goods | 33 | Walgreens          |
| 17 | rue21                 | 34 | Walgreens          |

## STAY

- |    |                                    |
|----|------------------------------------|
| 1  | Best Western                       |
| 2  | Candlewood Suites                  |
| 3  | Clarion                            |
| 4  | Courtyard by Marriott              |
| 5  | Embassy Suites Hotels              |
| 6  | Extended Stay America              |
| 7  | Fairfield Inn & Suites by Marriott |
| 8  | Hampton                            |
| 9  | Hilton Garden Inn                  |
| 10 | Holiday Inn Express                |
| 11 | InTown Suites                      |
| 12 | InTown Suites                      |
| 13 | Quality Inn                        |
| 14 | Residence Inn by Marriott          |
| 15 | TownePlace Suites by Marriott      |

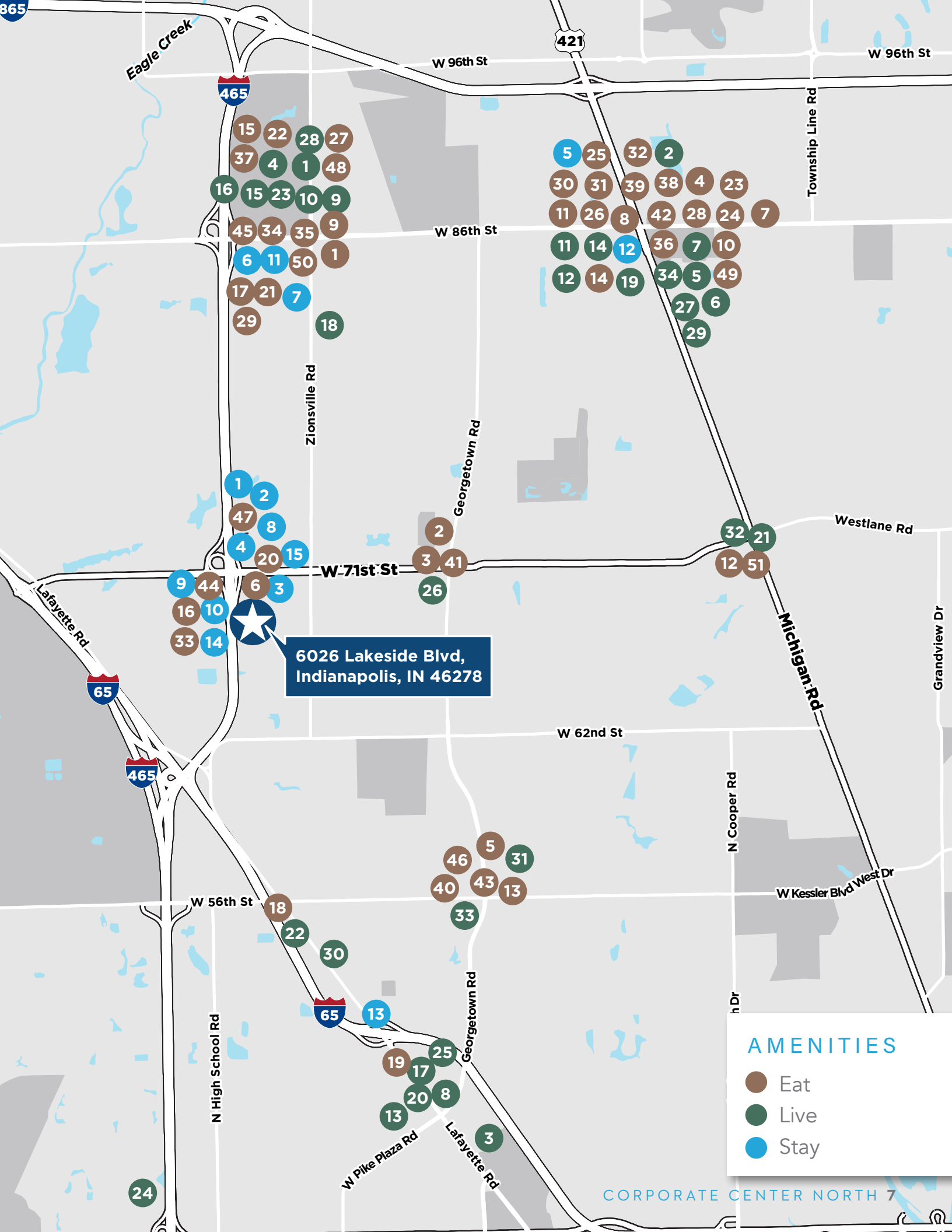



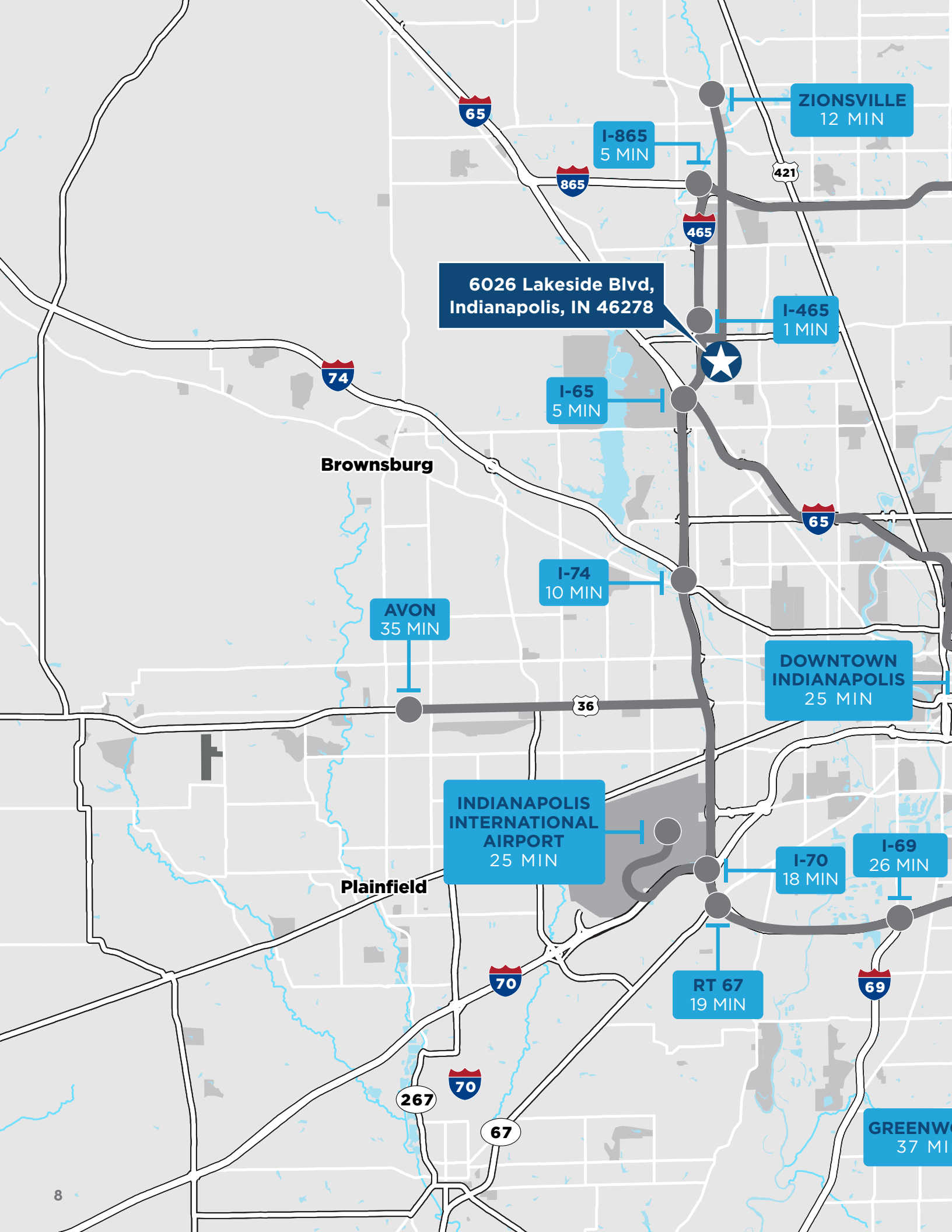



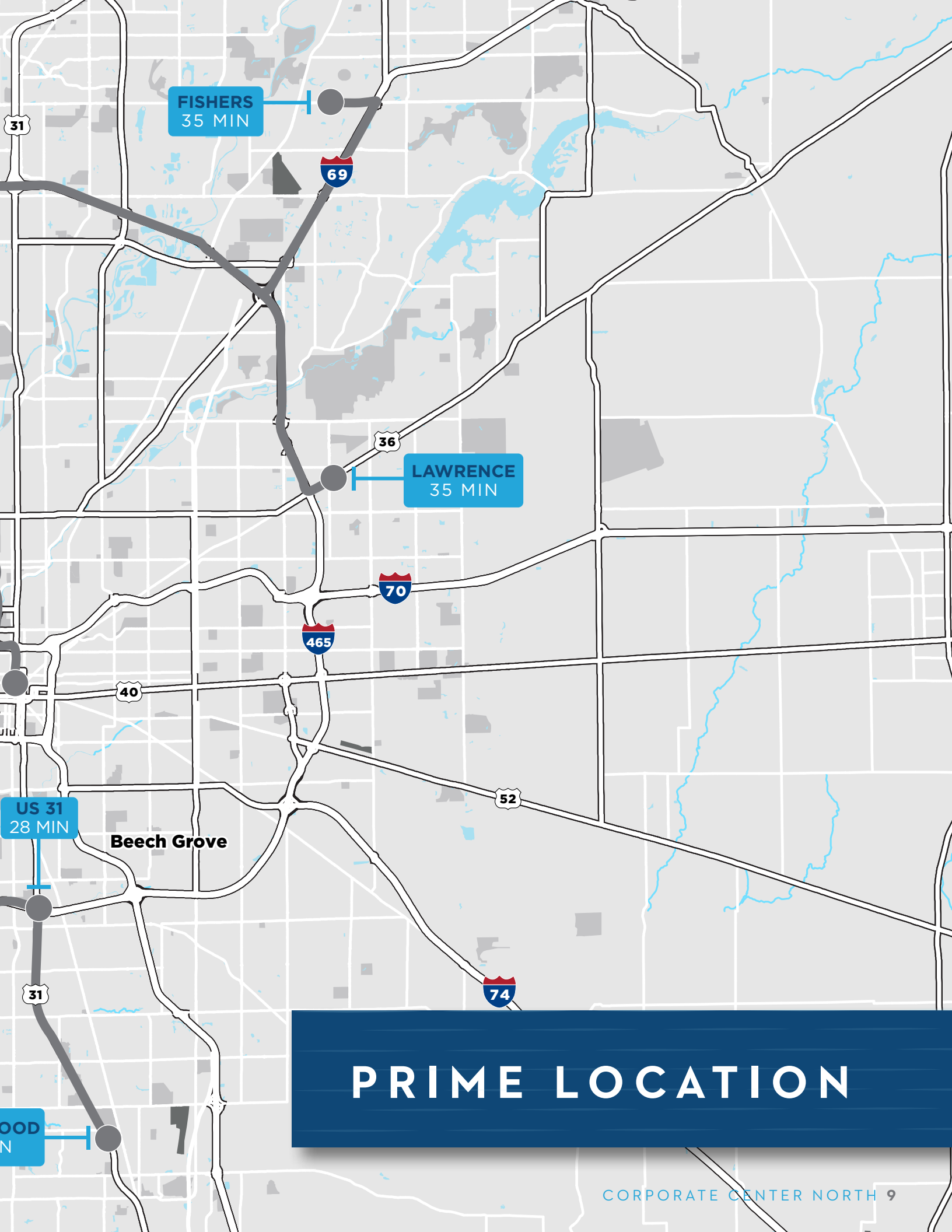

FISHERS  
35 MIN

LAWRENCE  
35 MIN

US 31  
28 MIN

Beech Grove

PRIME LOCATION

# CORPORATE CENTER NORTH

6026 LAKESIDE BLVD. INDIANAPOLIS, IN 46278



For More  
Information,  
Please Contact:

**RUSSELL A. VANTIL**

Director

Direct: +1 317 639 0546

[russell.vantil@cushwake.com](mailto:russell.vantil@cushwake.com)



©2023 Cushman & Wakefield. All rights reserved. The information contained in this communication is strictly confidential. This information has been obtained from sources believed to be reliable but has not been verified. NO WARRANTY OR REPRESENTATION, EXPRESS OR IMPLIED, IS MADE AS TO THE CONDITION OF THE PROPERTY (OR PROPERTIES) REFERENCED HEREIN OR AS TO THE ACCURACY OR COMPLETENESS OF THE INFORMATION CONTAINED HEREIN, AND SAME IS SUBMITTED SUBJECT TO ERRORS, OMISSIONS, CHANGE OF PRICE, RENTAL OR OTHER CONDITIONS, WITHDRAWAL WITHOUT NOTICE, AND TO ANY SPECIAL LISTING CONDITIONS IMPOSED BY THE PROPERTY OWNER(S). ANY PROJECTIONS, OPINIONS OR ESTIMATES ARE SUBJECT TO UNCERTAINTY AND DO NOT SIGNIFY CURRENT OR FUTURE PROPERTY PERFORMANCE.