

GREENBRIER SQUARE

FOR LEASE

GREENBRIER SQUARE

YOUR NAME HERE

1950-1980 OCEANSIDE BLVD | OCEANSIDE, CA | 92054

EXCLUSIVE BROKER



CUSHMAN &
WAKEFIELD



DEMOGRAPHICS

PROPERTY HIGHLIGHTS

- Excellent exposure & accessibility to I-5 and Oceanside Blvd
- Directly across the street from the Sprinter Light Rail Station
- Convenient retail/service center featuring great tenant mix
- 295 new residential units adjacent to subject property under construction

TRAFFIC COUNTS

- Oceanside Blvd: 30,524 ADT
- Crouch St: 7,938 ADT

	1 MILE	3 MILES	5 MILES
Pop (2024)	16,698	92,758	198,311
AHH Income	\$115,684	\$114,450	\$125,910
Daytime Pop.	5,156	39,758	65,730

TENANTS (IN THE AREA)



AVAILABILITIES

SUITE	TENANT	SQ. FT.
1950-A	Rackstarz	2,269
1950-C	Mr. Donuts	1,100
1950-D	Platinum Hair & Nails	1,100
1950-F	Beauty Supply	1,100
1950-H	AVAILABLE (see demising plans)	4,400
1950-K	Front Line Tattoo	1,200

SUITE	TENANT	SQ. FT.
1950-L	Fred Loya Insurance Agency	1,265
1950-O	Smog This	1,372
1950-R	Georgie's Mediterranean Cuisine	1,254
1960	Wienerschnitzel	1,000
1970	Jiffy Lube	1,792
1980	Soapy Joe's Carwash	3,100

Demise Option A:	Demise Option B:
1,375 SF	1,237 SF
1,375 SF	1,237 SF
1,650 SF	1,926 SF

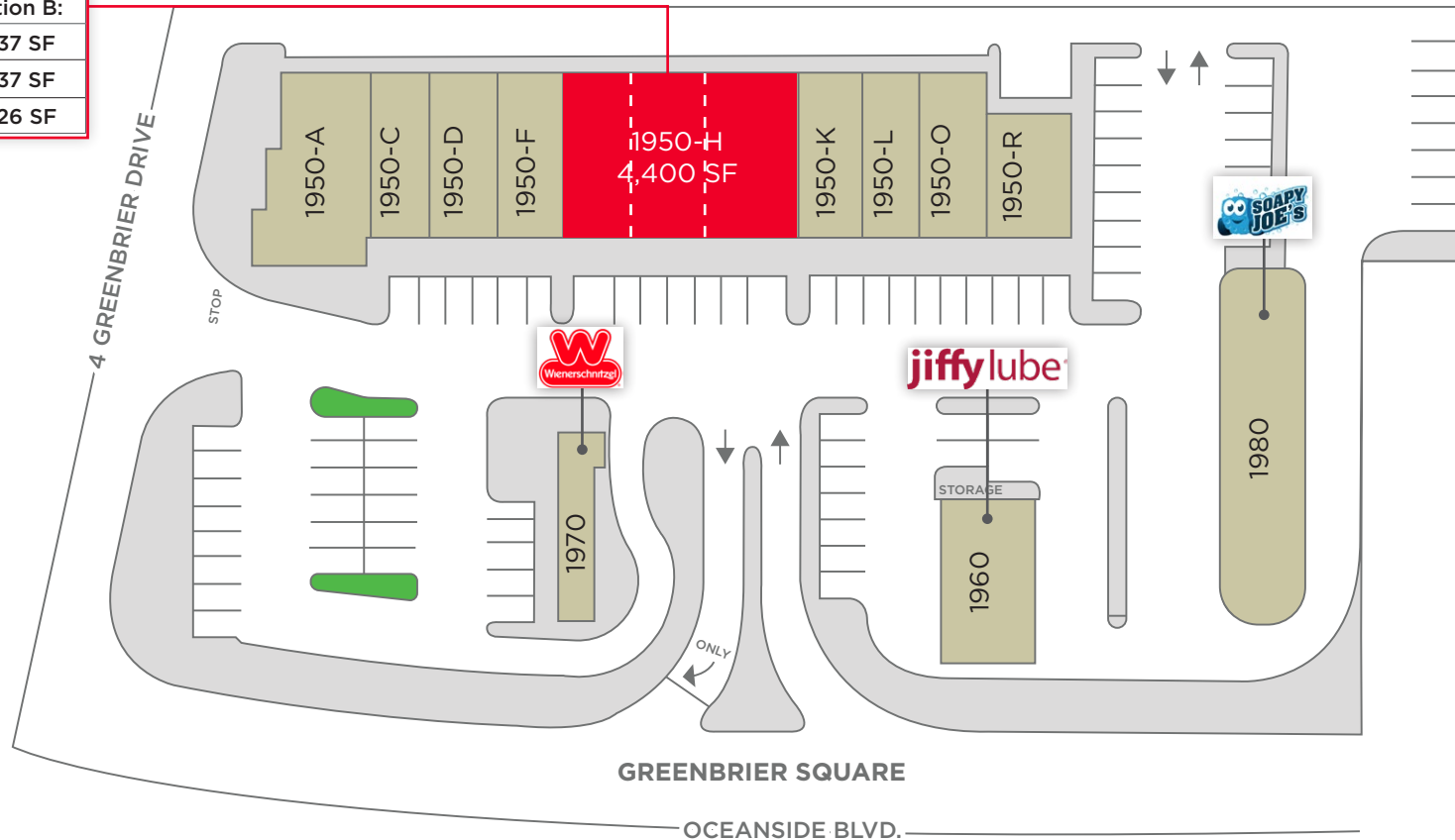

Cushman & Wakefield Copyright 2024. No warranty or representation, express or implied, is made to the accuracy or completeness of the information contained herein, and same is submitted subject to errors, omissions, change of price, rental or other conditions, withdrawal without notice, and to any special listing conditions imposed by the property owner(s). As applicable, we make no representation as to the condition of the property (or properties) in question.

SUITE 1950-H DEMISING OPTIONS

OPTION
A

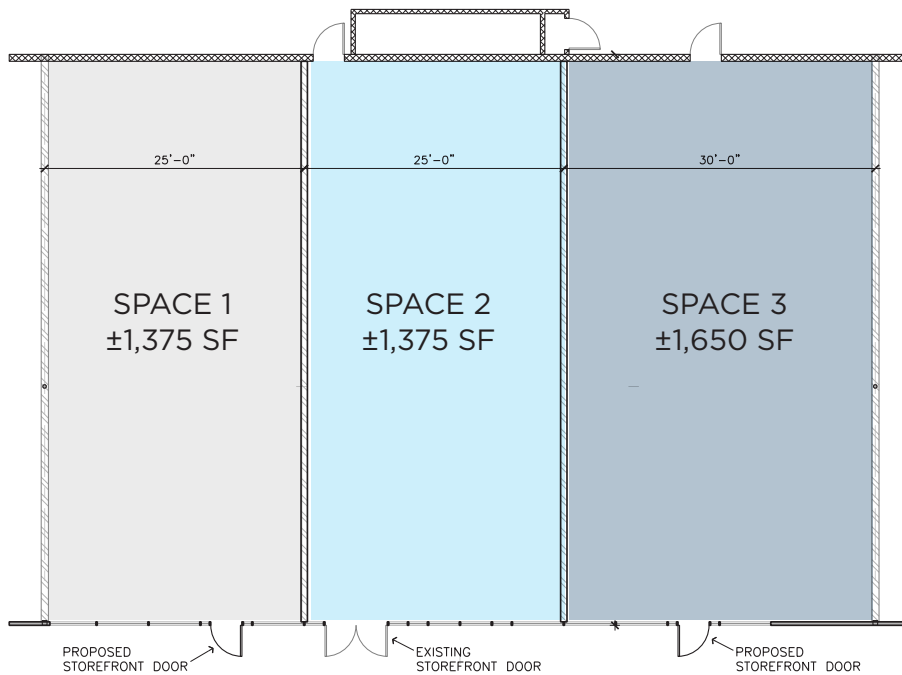

OPTION
B

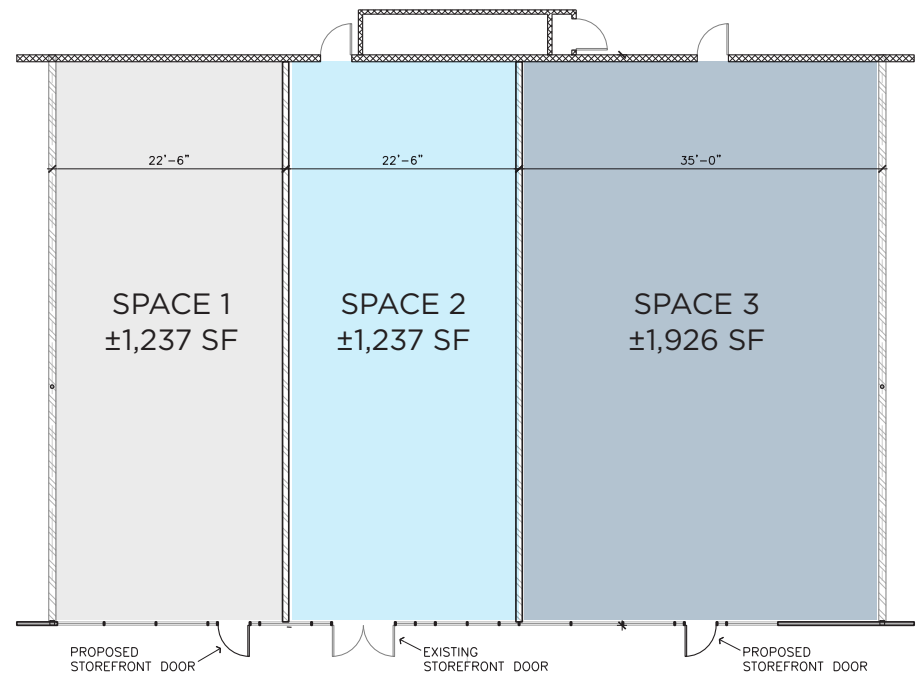

AERIAL



GALLERY



DEMOGRAPHICS

1 Mile

Demographic and Income Profile

1950 Oceanside Blvd, Oceanside, California, 92054 2

1950 Oceanside Blvd, Oceanside, California, 92054

Ring: 1 mile radius

Latitude: 33.19498, Longitude: -117.35455



Summary	Census 2010	Census 2020	2024	2029		
Population	17,576	17,186	16,698	17,118		
Households	6,048	6,332	6,271	6,548		
Families	3,929	-	3,932	4,129		
Average Household Size	2.87	2.67	2.62	2.57		
Owner Occupied Housing Units	2,685	-	2,781	2,849		
Renter Occupied Housing Units	3,363	-	3,490	3,699		
Median Age	32.8	-	38.2	39.3		
Trends: 2023-2028 Annual Rate	Area	State	National			
Population	0.50%	0.09%	0.30%			
Households	0.87%	0.38%	0.49%			
Families	0.98%	0.37%	0.44%			
Owner HHs	0.48%	0.58%	0.66%			
Median Household Income	4.35%	2.70%	2.57%			
Households by Income	2024		2029			
	Number	Percent	Number	Percent		
	<\$15,000	424	6.8%	379	5.8%	
	\$15,000 - \$24,999	405	6.5%	304	4.6%	
	\$25,000 - \$34,999	457	7.3%	363	5.5%	
	\$35,000 - \$49,999	627	10.0%	526	8.0%	
	\$50,000 - \$74,999	1,131	18.0%	1,069	16.3%	
	\$75,000 - \$99,999	686	10.9%	725	11.1%	
	\$100,000 - \$149,999	1,174	18.7%	1,368	20.9%	
	\$150,000 - \$199,999	453	7.2%	639	9.8%	
\$200,000+	913	14.6%	1,174	17.9%		
Median Household Income	\$77,627		\$96,063			
Average Household Income	\$115,684		\$136,544			
Per Capita Income	\$43,976		\$52,924			
Census 2010		2024		2029		
Population by Age	Number	Percent	Number	Percent	Number	Percent
0 - 4	1,399	8.0%	878	5.3%	872	5.1%
5 - 9	1,233	7.0%	903	5.4%	868	5.1%
10 - 14	1,123	6.4%	961	5.8%	939	5.5%
15 - 19	1,344	7.6%	929	5.6%	937	5.5%
20 - 24	1,584	9.0%	1,114	6.7%	1,062	6.2%
25 - 34	2,647	15.1%	2,729	16.3%	2,648	15.5%
35 - 44	2,316	13.2%	2,519	15.1%	2,671	15.6%
45 - 54	2,432	13.8%	2,055	12.3%	2,179	12.7%
55 - 64	1,740	9.9%	1,976	11.8%	1,875	11.0%
65 - 74	870	4.9%	1,650	9.9%	1,764	10.3%
75 - 84	628	3.6%	718	4.3%	984	5.7%
85+	260	1.5%	264	1.6%	316	1.8%

© 2024 Cushman & Wakefield. All rights reserved. The information contained within this report is gathered from multiple sources believed to be reliable. The information may contain errors or omissions and is presented without any warranty or representations as to its accuracy.

3 Mile

Demographic and Income Profile

1950 Oceanside Blvd, Oceanside, California, 92054 2

1950 Oceanside Blvd, Oceanside, California, 92054

Ring: 3 mile radius

Latitude: 33.19498, Longitude: -117.35455



Summary	Census 2010	Census 2020	2024	2029
Population	91,768	93,841	92,758	93,865
Households	35,432	37,360	37,824	39,073
Families	21,793	-	22,628	23,410
Average Household Size	2.47	2.39	2.34	2.29
Owner Occupied Housing Units	14,910	-	16,071	16,665
Renter Occupied Housing Units	20,522	-	21,753	22,408
Median Age	33.0	-	37.4	38.9
Trends: 2023-2028 Annual Rate	Area	State	National	
Population	0.24%	0.09%	0.30%	
Households	0.65%	0.38%	0.49%	
Families	0.68%	0.37%	0.44%	
Owner HHs	0.73%	0.58%	0.66%	
Median Household Income	3.38%	2.70%	2.57%	
Households by Income	2024		2029	
	Number	Percent	Number	Percent
<\$15,000	2,567	6.8%	2,353	6.0%
\$15,000 - \$24,999	2,423	6.4%	1,857	4.8%
\$25,000 - \$34,999	2,389	6.3%	1,969	5.0%
\$35,000 - \$49,999	3,458	9.1%	2,992	7.7%
\$50,000 - \$74,999	6,307	16.7%	5,843	15.0%
\$75,000 - \$99,999	4,901	13.0%	4,931	12.6%
\$100,000 - \$149,999	7,276	19.2%	8,122	20.8%
\$150,000 - \$199,999	3,728	9.9%	4,806	12.3%
\$200,000+	4,775	12.6%	6,200	15.9%
Median Household Income	\$82,479		\$97,384	
Average Household Income	\$114,450		\$133,964	
Per Capita Income	\$46,286		\$55,206	
Census 2010		2024		2029
Population by Age	Number	Percent	Number	Percent
0 - 4	6,479	7.1%	4,723	5.1%
5 - 9	5,182	5.6%	4,425	4.8%
10 - 14	4,831	5.3%	4,222	4.6%
15 - 19	6,316	6.9%	4,952	5.3%
20 - 24	10,469	11.4%	8,593	9.3%
25 - 34	15,233	16.6%	16,197	17.5%
35 - 44	11,033	12.0%	12,830	13.8%
45 - 54	11,434	12.5%	10,051	10.8%
55 - 64	9,432	10.3%	10,414	11.2%
65 - 74	5,362	5.8%	9,468	10.2%
75 - 84	4,031	4.4%	4,943	5.3%
85+	1,966	2.1%	1,941	2.1%

© 2024 Cushman & Wakefield. All rights reserved. The information contained within this report is gathered from multiple sources believed to be reliable. The information may contain errors or omissions and is presented without any warranty or representations as to its accuracy.

DEMOGRAPHICS (cont.)

5 Mile

Demographic and Income Profile

1950 Oceanside Blvd, Oceanside, California, 92054 2

1950 Oceanside Blvd, Oceanside, California, 92054

Ring: 5 mile radius

Latitude: 33.19498, Longitude: -117.35455



Summary	Census 2010	Census 2020	2024	2029			
Population	189,518	199,032	198,311	200,001			
Households	68,777	73,307	74,343	76,574			
Families	45,553	-	48,584	50,123			
Average Household Size	2.66	2.62	2.57	2.52			
Owner Occupied Housing Units	35,440	-	38,691	40,186			
Renter Occupied Housing Units	33,337	-	35,652	36,388			
Median Age	33.4	-	37.9	39.1			
Trends: 2023-2028 Annual Rate	Area	State	National				
Population	0.17%	0.09%	0.30%				
Households	0.59%	0.38%	0.49%				
Families	0.63%	0.37%	0.44%				
Owner HHS	0.76%	0.58%	0.66%				
Median Household Income	2.93%	2.70%	2.57%				
Households by Income	2024		2029				
	Number	Percent	Number	Percent			
	<\$15,000	4,680	6.3%	4,250	5.6%		
	\$15,000 - \$24,999	3,950	5.3%	2,978	3.9%		
	\$25,000 - \$34,999	4,162	5.6%	3,368	4.4%		
	\$35,000 - \$49,999	6,011	8.1%	5,110	6.7%		
	\$50,000 - \$74,999	11,195	15.1%	10,182	13.3%		
	\$75,000 - \$99,999	9,590	12.9%	9,391	12.3%		
	\$100,000 - \$149,999	14,402	19.4%	15,505	20.2%		
	\$150,000 - \$199,999	8,960	12.1%	11,170	14.6%		
\$200,000+	11,394	15.3%	14,620	19.1%			
Median Household Income	\$92,372		\$106,731				
Average Household Income	\$125,910		\$146,921				
Per Capita Income	\$47,098		\$56,047				
Population by Age	Census 2010		2024		2029		
	Number	Percent	Number	Percent	Number	Percent	
	0 - 4	13,371	7.1%	10,497	5.3%	10,244	5.1%
	5 - 9	11,713	6.2%	10,478	5.3%	9,967	5.0%
	10 - 14	11,396	6.0%	10,322	5.2%	10,642	5.3%
	15 - 19	13,498	7.1%	11,366	5.7%	10,906	5.5%
	20 - 24	19,463	10.3%	17,136	8.6%	15,952	8.0%
	25 - 34	29,431	15.5%	31,205	15.7%	29,677	14.8%
	35 - 44	23,914	12.6%	27,128	13.7%	28,693	14.3%
	45 - 54	24,818	13.1%	22,810	11.5%	23,590	11.8%
	55 - 64	19,316	10.2%	22,958	11.6%	21,491	10.7%
	65 - 74	10,720	5.7%	19,854	10.0%	21,030	10.5%
	75 - 84	8,021	4.2%	10,304	5.2%	12,978	6.5%
	85+	3,859	2.0%	4,252	2.1%	4,831	2.4%



© 2024 Cushman & Wakefield. All rights reserved. The information contained within this report is gathered from multiple sources believed to be reliable. The information may contain errors or omissions and is presented without any warranty or representations as to its accuracy.



GREENBRIER SQUARE

1950-1980 OCEANSIDE BLVD | OCEANSIDE, CA | 92054

CHAD IAFRATE, CCIM

+1 760 431 4234

chad.iafrate@cushwake.com

LIC #01329943

VINCE PROVENZANO

+1 760 431 4212

vince.provenzano@cushwake.com

LIC #01926894

NASH JOHNSON

+1 760 431 3831

nash.johnson@cushwake.com

LIC #02188083



12830 El Camino Real, Suite 100
San Diego, CA 92130
cushmanwakefield.com