

# 250 YONGE

STREET TORONTO

22,907 SF OF OFFICE SPACE AVAILABLE FOR SUBLEASE



 CUSHMAN & WAKEFIELD



# 250 Opportunity

Welcome to 250 Yonge Street, where the entire 14th floor covers over 22,907 square feet and is move-in ready, available immediately for lease. This modern space boasts outstanding features and an efficient layout that includes offices and furniture for a plug-and-play setup. The building location provides unparalleled convenience and connectivity, offering direct access to Eaton Centre's retail and dining amenities as well as the PATH.

## Highlights:

Available Space:	14th floor: 22,907 SF
Timing:	Available Immediately
<b>Total Available:</b>	<b>22,907 SF</b>
Term:	March 30, 2028
Asking Rates:	Contact Listing Agents
Additional Rent:	\$27.50 PSF (2025 Est.)



Direct connection to the Eaton Centre retail and restaurant amenities



\$2.00 PSF/annum attractive bonus commission



Direct PATH connection



Access to transit within minutes











# 250 Amenities

## On-site Amenities

Endless amenity offerings to suit your food & beverage, service or retail needs.

	FOOD & BEVERAGE	50 <sup>+</sup>
	RETAIL	50 <sup>+</sup>
	ENTERTAINMENT	6 <sup>+</sup>
	HEALTH & WELLNESS	4 <sup>+</sup>
	BANKING	8 <sup>+</sup>
	HOTEL	10 <sup>+</sup>
	FITNESS	6 <sup>+</sup>

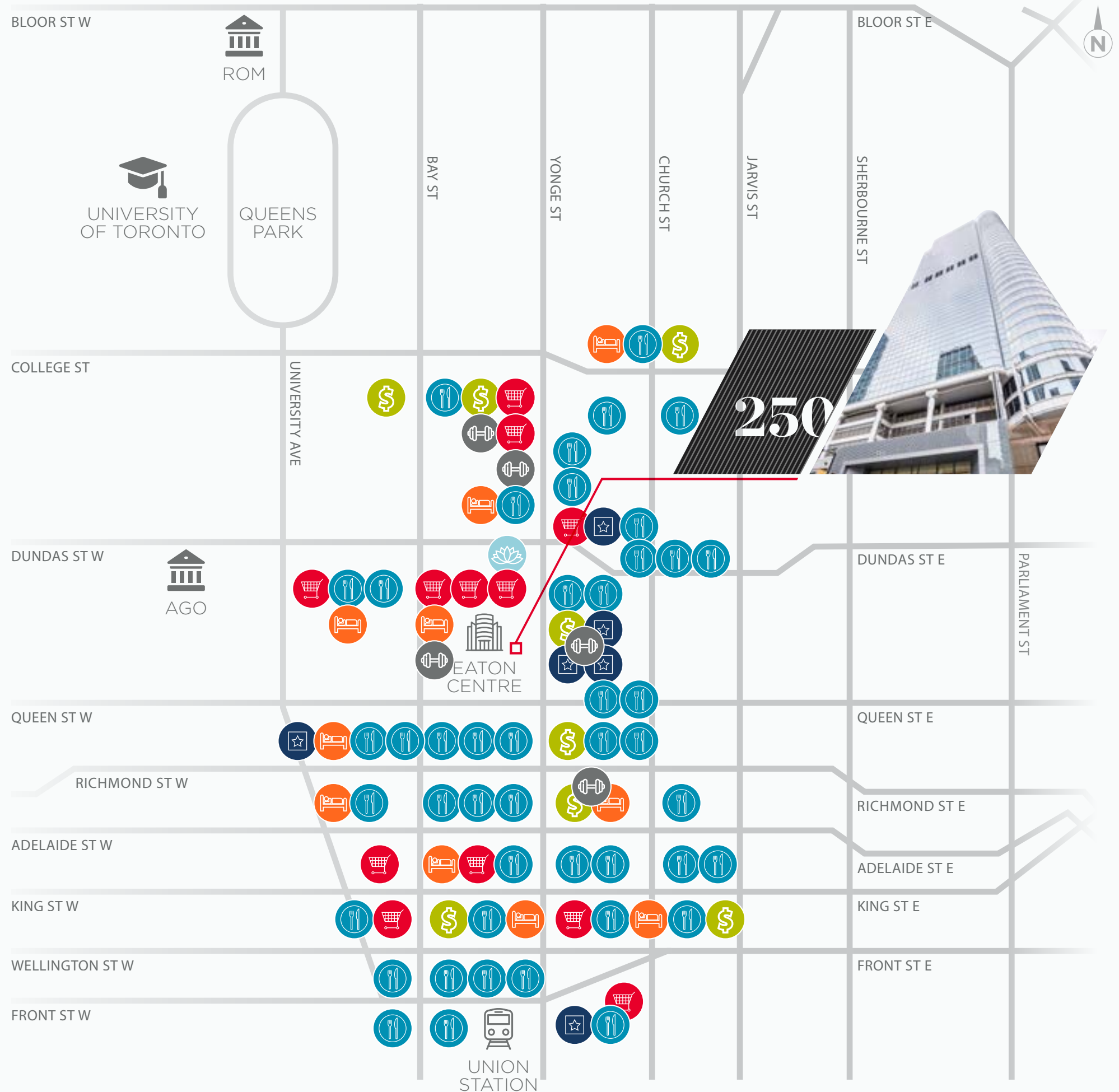



250

Floor 14 22,907 SF





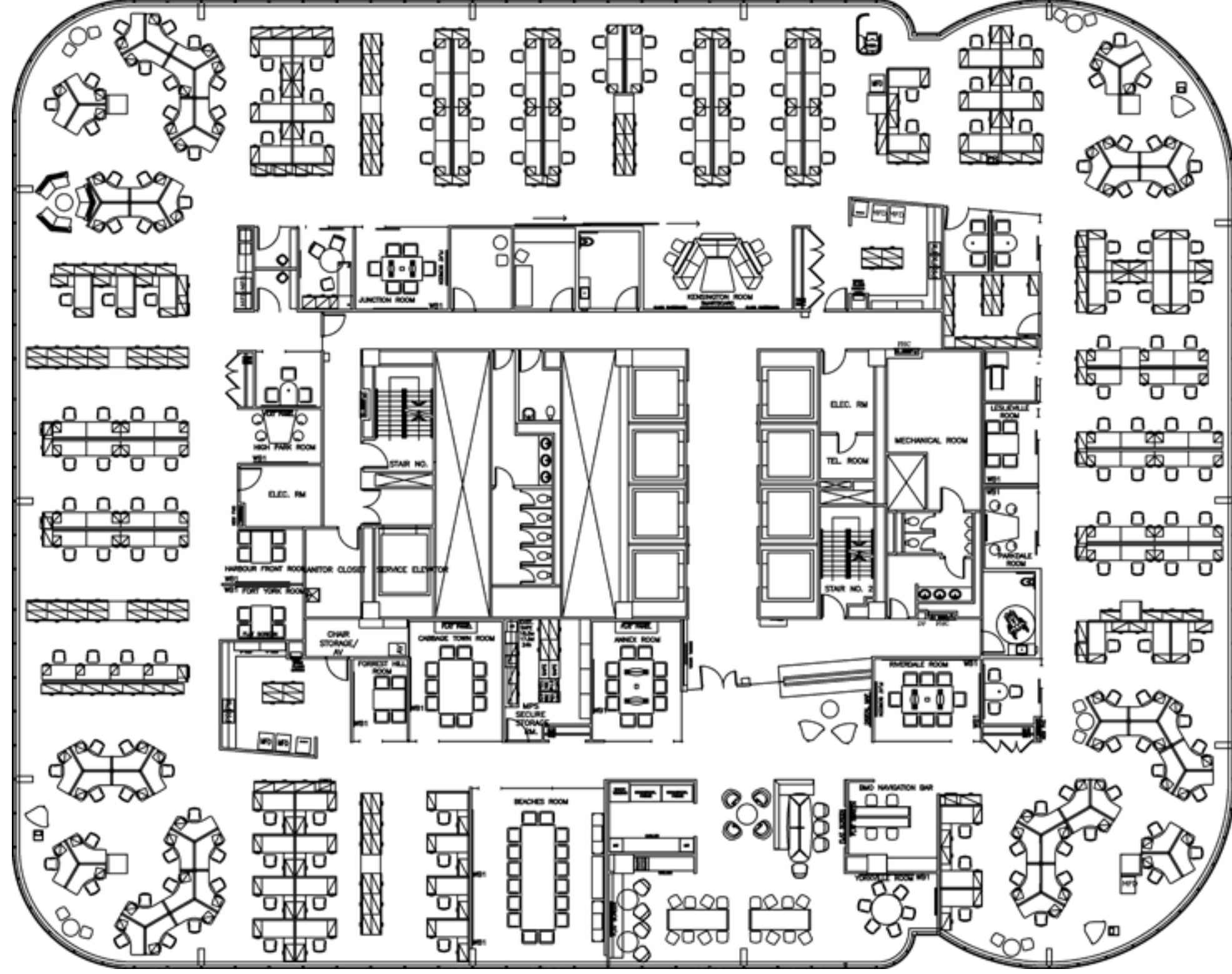



250

250



# 250 YONGE

STREET TORONTO

22,907 SF OF OFFICE SPACE AVAILABLE FOR SUBLEASE

**DEREK SNYDER\***

VICE CHAIR

**416 359 2459**

Derek.Snyder@cushwake.com

**KATYA SHABANOVA\***

SENIOR VICE PRESIDENT

**416 359 2517**

Katya.Shabanova@cushwake.com



**CUSHMAN &  
WAKEFIELD**

CUSHMAN & WAKEFIELD ULC, BROKERAGE  
161 BAY STREET, SUITE 1500  
TORONTO, ON | M5J 2S1

**VICTORIA GEE\***

TRANSACTION MANAGER

**416 359 2604**

victoria.gee@cushwake.com