

STORY ROAD LOGISTICS CENTER

FOR LEASE

750 STORY ROAD, SAN JOSE, CA

± 71,219 SF CLASS A INDUSTRIAL



 CLARION PARTNERS

 GO
INDUSTRIAL

 CUSHMAN &
WAKEFIELD

FRED EDER
408.489.2263
fred.eder@cushwake.com
LIC #00949342

SITE PLAN, BUILDING & PROPERTY HIGHLIGHTS

STORY ROAD

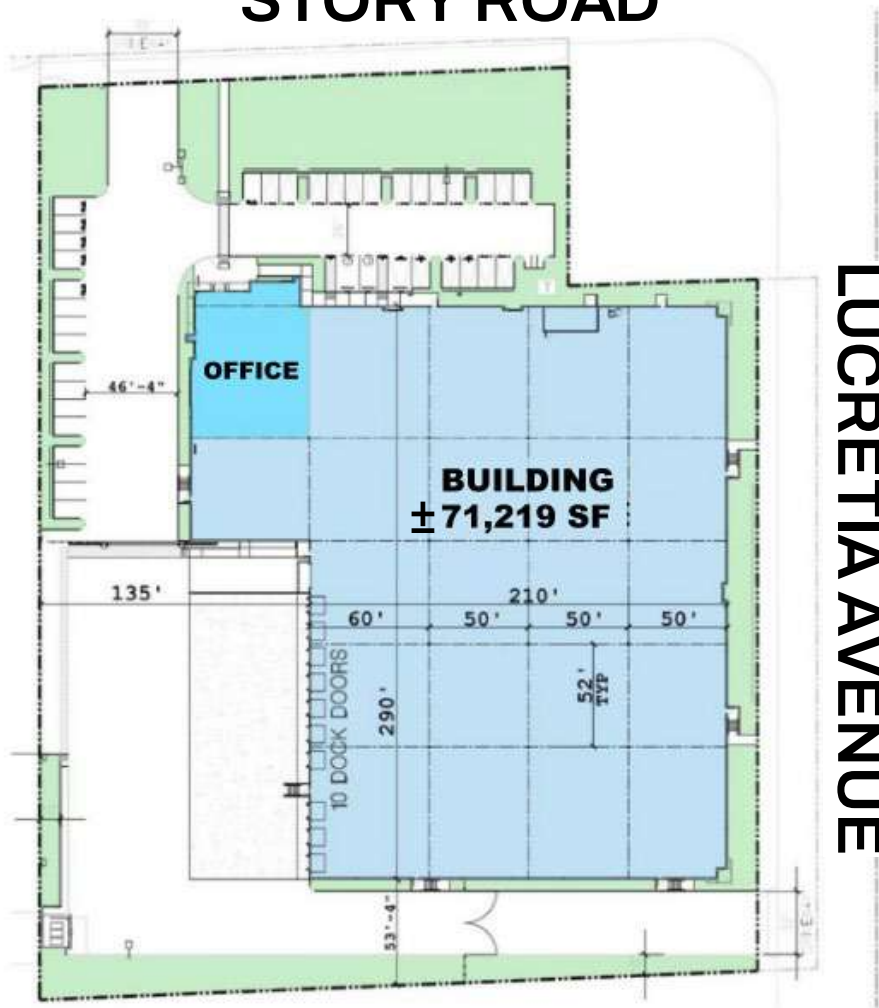

PROPERTY & BUILDING FEATURES

- ± 71,219 SF
- ± 3.63 Acres
- ± 6,100 SF of Office (Two Story)
- 32' Clear Height
- ± 60' Speed Bay
- 50' x 52' Column Spacing
- 10 – 9'x12' Dock Doors
- 1 – 12'x12' Grade Level Doors
- 135' Truck Court
- Private, Fenced Truck Entrance with Lighted Truck Court
- 6" Thick Floor Slab
- ± 36 Auto Stalls
- ESFR Sprinkler System
- 3,000 Amps 277/480 Volts
- Traffic Volume:
 - Story Road: ± 25,918
 - Lucretia Avenue: ± 10,000



NEARBY COMPANIES AND AMENITIES



SJC SAN JOSE MINETA INTERNATIONAL AIRPORT

Kellogg's

 DOWNTOWN SAN JOSE

 SAN JOSE STATE SPARTANS

SAN JOSE MCENERY CONVENTION CENTER

LEGACY
Walmart

Public Storage
VIETNAM TOWN

amazon

FBM
Foundation Building Materials

STORY ROAD

Acosta
The Max Manufacturing, Inc.

AIR SYSTEMS
Solutions that flow

AIRPORTS

SAN JOSE (SJC)	6 miles
OAKLAND (OAK)	37 miles
SAN FRANCISCO (SFO)	37 miles

HIGHWAYS

HWY-280	0.6 miles
HWY-101	0.7 miles
HWY 680	2 miles
HWY 87	3 Miles

LOCAL DEMOGRAPHICS

	1 MI RADIUS	5 MI RADIUS
TOTAL POPULATION	31,473	648,736
PERCENT OF POPULATION WITH A BACHELORS OR HIGHER	12.36%	21.32%
TOTAL # OF HOUSEHOLDS	8,268	197,575
AVERAGE INCOME PER HOUSEHOLD	\$115,273	\$136,105

REGIONAL MAP

MAJOR MARKETS

DOWNTOWN SAN JOSE	3 miles
CUPERTINO	11 miles
MOUNTAIN VIEW	16 miles
SUNNYVALE	13 miles
TRACY	60 miles
SALINAS	57 miles
PALO ALTO	20 miles
OAKLAND	42 miles
SAN FRANCISCO	51 miles
SACRAMENTO	119 miles
LOS ANGELES	339 miles
RENO, NV	249 miles
SEATTLE, WA	839 miles

PORTS/FACILITIES

PORT OF OAKLAND	42 miles
OAKLAND INTERMODAL FACILITY	45 miles
PORT OF LA & LONG BEACH	363 miles

STORY ROAD

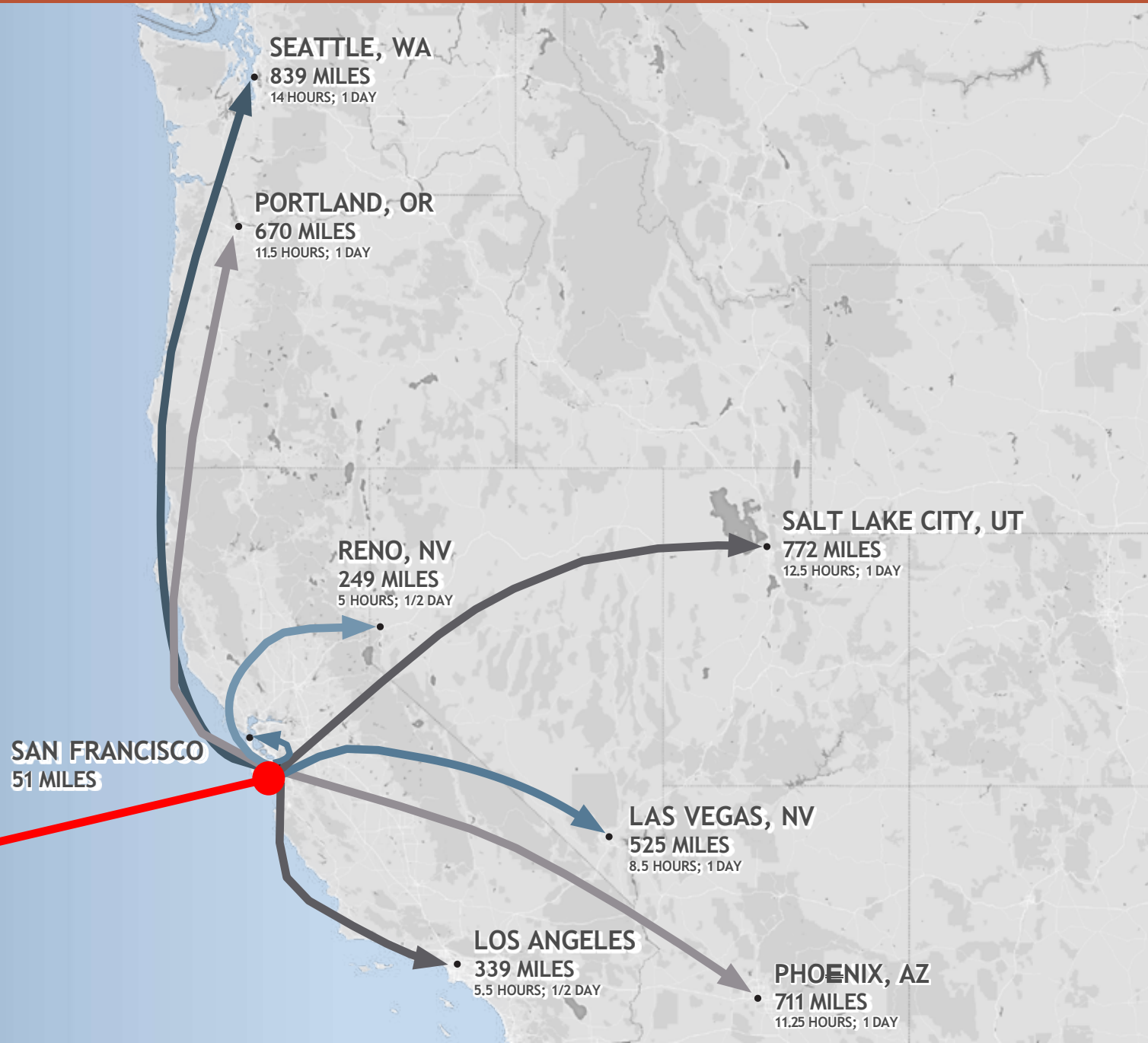

STORY ROAD LOGISTICS CENTER

FOR LEASE

750 STORY ROAD, SAN JOSE, CA



OWNER:  CLARION PARTNERS

DEVELOPER:  GO
INDUSTRIAL

**For more information on this
opportunity, please contact:**

FRED EDER
408.489.2263
fred.eder@cushwake.com
LIC#00949342

 CUSHMAN &
WAKEFIELD