

FOR SUBLEASE

Paloma Ridge C

13620 Ranch Road 620, Austin, TX 78717



SUITE 150 | 20,963 RSF

- ~7,300 RSF LAB
~13,700 RSF OFFICE
- \$10/RSF NNN +
\$15.22/RSF OPEX
- AVAILABLE
IMMEDIATELY
- LED
8/31/2025

FOR SUBLEASE

Paloma Ridge C

13620 Ranch Road 620, Austin, TX 78717

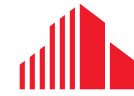

CUSHMAN &
WAKEFIELD



FOR SUBLEASE

Paloma Ridge C

13620 Ranch Road 620, Austin, TX 78717



FLOOR PLAN

SUITE 150

Office Lab Subleased

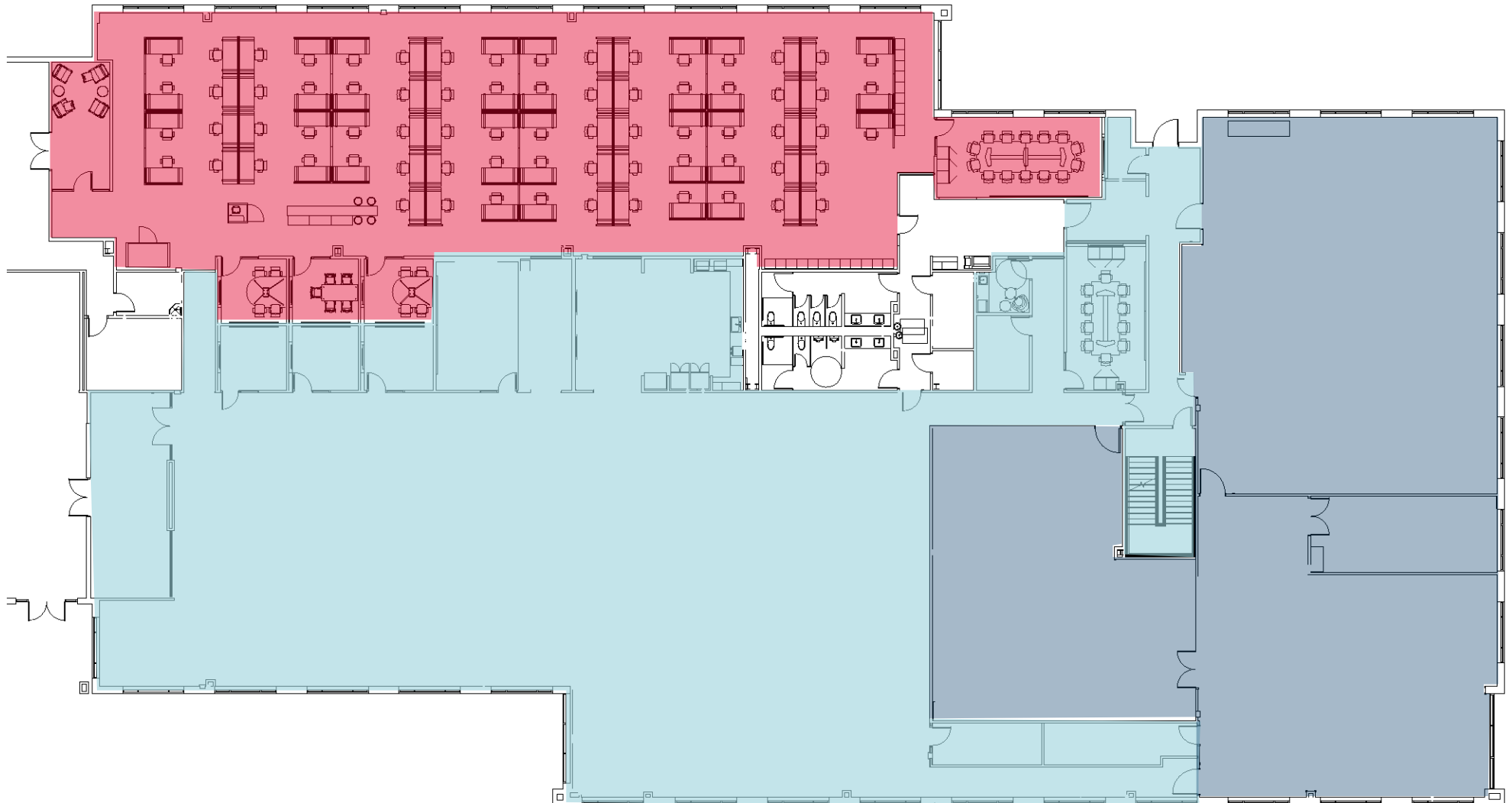

FOR SUBLEASE

Paloma Ridge C

13620 Ranch Road 620, Austin, TX 78717



LOCATION MAP

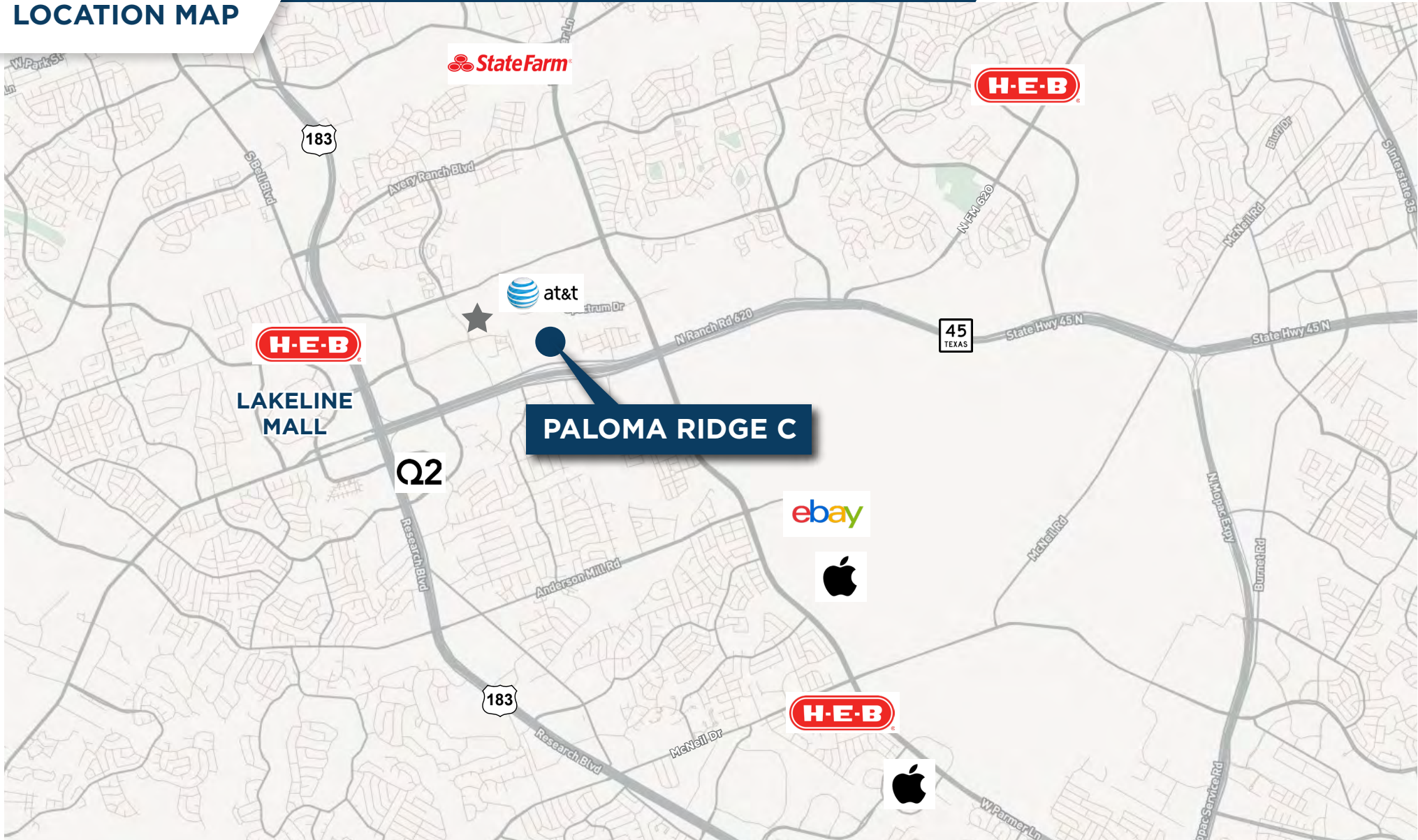

★ Lakeline MetroRail Station

FOR SUBLEASE

Paloma Ridge C

13620 Ranch Road 620, Austin, TX 78717



AERIAL

PALOMA RIDGE C

N FM 620

For more information please contact:

CHRIS PEDDIE
Senior Associate
+1 512 370 2447

chris.peddie@cushwake.com

BRETT ARABIE
Managing Director
+1 512 370 2411

brett.arabie@cushwake.com

ANDRES CONTRERAS
Associate
+1 512 222 0962

andres.contreras@cushwake.com

405 Colorado Street, Suite 2300
Austin, TX 78701
United States
+1 512 474 2400

cushmanwakefield.com

©2023 Cushman & Wakefield. All rights reserved. The information contained in this communication is strictly confidential. This information has been obtained from sources believed to be reliable but has not been verified. NO WARRANTY OR REPRESENTATION, EXPRESS OR IMPLIED, IS MADE AS TO THE CONDITION OF THE PROPERTY (OR PROPERTIES) REFERENCED HEREIN OR AS TO THE ACCURACY OR COMPLETENESS OF THE INFORMATION CONTAINED HEREIN, AND SAME IS SUBMITTED SUBJECT TO ERRORS, OMISSIONS, CHANGE OF PRICE, RENTAL OR OTHER CONDITIONS, WITHDRAWAL WITHOUT NOTICE, AND TO ANY SPECIAL LISTING CONDITIONS IMPOSED BY THE PROPERTY OWNER(S). ANY PROJECTIONS, OPINIONS OR ESTIMATES ARE SUBJECT TO UNCERTAINTY AND DO NOT SIGNIFY CURRENT OR FUTURE PROPERTY PERFORMANCE.