

9785
GOETHE
ROAD

SACRAMENTO, CALIFORNIA

BUILDING AVAILABLE FULLY FURNISHED

FOR SALE OR LEASE
±25,000 SF OFFICE BUILDING

9785
GOETHE
ROAD

SACRAMENTO, CALIFORNIA



PROPERTY HIGHLIGHTS

- ±25,000 SF standalone office building at hard corner of Goethe Road and Granby Road
- Less than 1 mile south of Highway 50 with easy access to the State Capitol and Sacramento's business district
- Available as fully furnished space
- Dedicated parking (4/1,000 SF) and bike rack
- Fully scured exterior area
- Monument signage opportunities available
- Outdoor patio area



SALES PRICE:	\$2,500,000
RENTAL RATE:	\$1.00 PSF - Modified Gross
ADDRESS:	9785 Goethe Road, Sacramento, CA 95827
APN:	067-0170-003
BUILDING SIZE:	±25,000 SF
PARCEL SIZE:	±2.02 AC
DIVISIBLE SPACE:	±10,000 - 15,000 SF
PARKING:	4/1,000 SF Parking Ratio
ZONING:	MP
POWER:	600 Amps/480 Volts

9785
GOETHE
ROAD

SACRAMENTO, CALIFORNIA

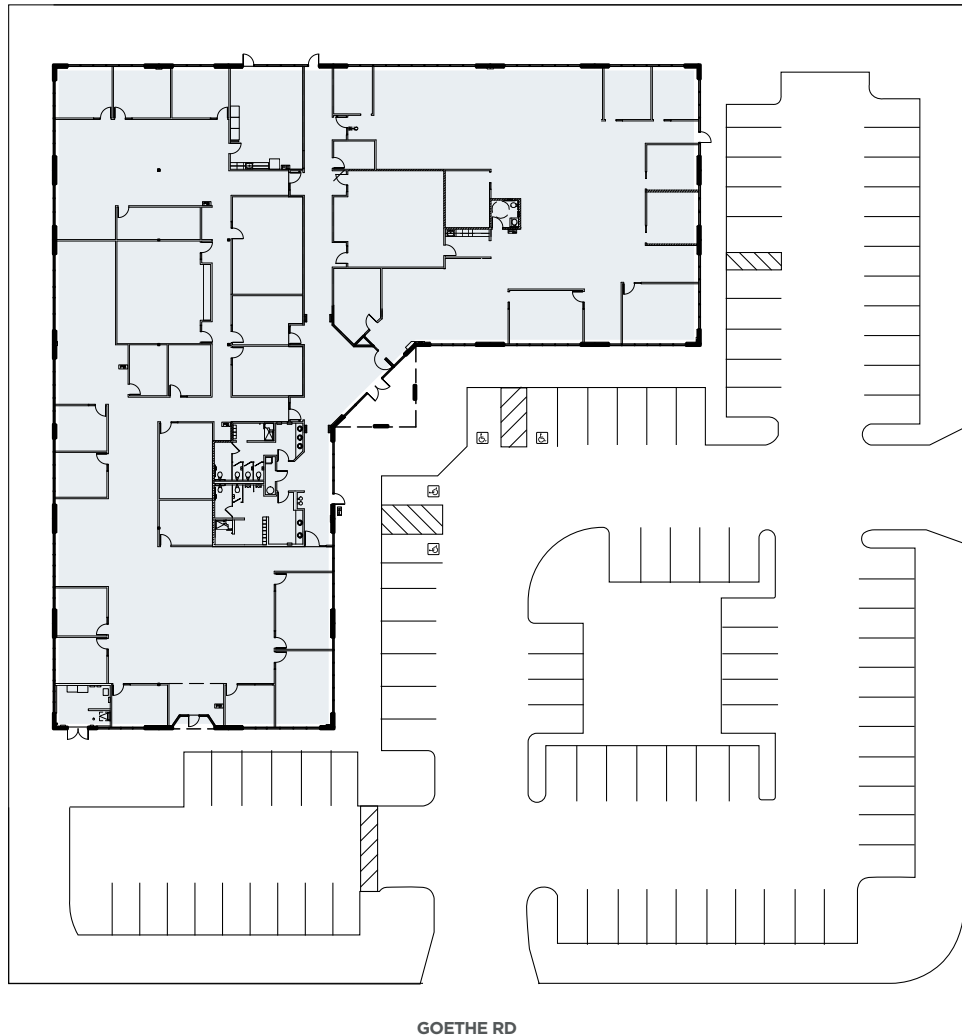

SPACE HIGHLIGHTS

- $\pm 25,000$ SF office space
- Floor-to-ceiling glass windows
- Private offices and open office space
- Large conference room/training center
- Showers and locker rooms
- 15' ceiling height
- Space demisable to 10,000 - 15,000 SF
- Outdoor patio area
- Available as fully furnished space

9785
GOETHE
ROAD

SACRAMENTO, CALIFORNIA



EXTERIOR IMAGES



9785
GOETHE
ROAD

SACRAMENTO, CALIFORNIA



INTERIOR PHOTOS



9785 GOETHE ROAD

SACRAMENTO, CALIFORNIA



9785 GOETHE ROAD

SACRAMENTO, CALIFORNIA



AREA AMENITIES

FOOD/RESTAURANTS

1. SUBWAY
2. BURGER KING
3. I LOVE TERIYAKI
4. IHOP
5. PAPA MURPHEY'S PIZZA
6. KFC
7. STARBUCKS
8. MCDONALD'S
9. OZ KOREAN BBQ
10. IPPOLITO'S TRATTORIA
11. TACO BELL
12. ADALBERTO'S
13. HUCKLEBERRY'S
14. MOUNTAIN MIKE'S PIZZA
15. EL POLLO LOCO
16. FALAFEL CORNER

BANKS

1. SACRAMENTO CREDIT UNION
2. WELLS FARGO
3. OE FEDERAL CREDIT UNION

GROCERY

1. FOOD 4 LESS
2. GROCERY OUTLET
3. DOLLAR TREE
4. 7-ELEVEN

FITNESS

1. 24 HOUR FITNESS
2. PLANET FITNESS
3. SPORTS COURT FITNESS

DRIVE TIME / DISTANCE

DOWNTOWN SACRAMENTO	20 MINUTES / 10.5 MILES
FOLSOM	15 MINUTES / 12.5 MILES
ELK GROVE	25 MINUTES / 12.5 MILES
US-50/BRADSHAW RD	3 MINUTES / 1 MILE
CA-99/BUS 80 INTERCHANGE	13 MINUTES / 9 MILES
I-5/I-80 INTERCHANGE	18 MINUTES / 11 MILES



CONTACT

KRIS KALMBACH

Managing Director

+1 916 288 4421

kris.kalmbach@cushwake.com

Lic #01436668



**CUSHMAN &
WAKEFIELD**

400 Capitol Mall, Suite 1800 | Sacramento, CA 95814

cushmanwakefield.com

9785
GOETHE
ROAD

SACRAMENTO, CALIFORNIA

©2025 Cushman & Wakefield. All rights reserved. The information contained in this communication is strictly confidential. This information has been obtained from sources believed to be reliable but has not been verified. NO WARRANTY OR REPRESENTATION, EXPRESS OR IMPLIED, IS MADE AS TO THE CONDITION OF THE PROPERTY (OR PROPERTIES) REFERENCED HEREIN OR AS TO THE ACCURACY OR COMPLETENESS OF THE INFORMATION CONTAINED HEREIN, AND SAME IS SUBMITTED SUBJECT TO ERRORS, OMISSIONS, CHANGE OF PRICE, RENTAL OR OTHER CONDITIONS, WITHDRAWAL WITHOUT NOTICE, AND TO ANY SPECIAL LISTING CONDITIONS IMPOSED BY THE PROPERTY OWNER(S). ANY PROJECTIONS, OPINIONS OR ESTIMATES ARE SUBJECT TO UNCERTAINTY AND DO NOT SIGNIFY CURRENT OR FUTURE PROPERTY PERFORMANCE.