

3909 OCEANIC DRIVE

UNIT 403, OCEANSIDE, CA



FOR LEASE

INDUSTRIAL CONDO

5,159 RSF AVAILABLE



PROPERTY HIGHLIGHTS



- Located right off Oceanside Blvd and blocks away from the Frontwave Arena and SoCal Sports Complex
- Ocean Ranch Corporate Center is situated within a quiet and well-maintained professional business park.
- Easy access to Interstate-5 and Highway 76
- Centrally located near shops, restaurants, a hotel, and the north county sprinter station



RECEPTION, 2 PRIVATE OFFICES, 2 RESTROOMS, AND 1 GL ROLL-UP DOOR



EXCELLENT PARKING (2.82/1,000 SF)



HEAVY POWER:
600 AMPS
120/208V 3 PHASE



22' CLEAR HEIGHT



12'X14' GL ROLL-UP DOOR



LEASE RATE:
\$1.40/SF NNN
EST. NNN: \$0.37/SF

FLOOR PLAN

403

UNIT

5,159

TOTAL SQUARE FEET

\$1.40/SF NNN

EST. NNN: \$0.37/SF

LEASE RATE

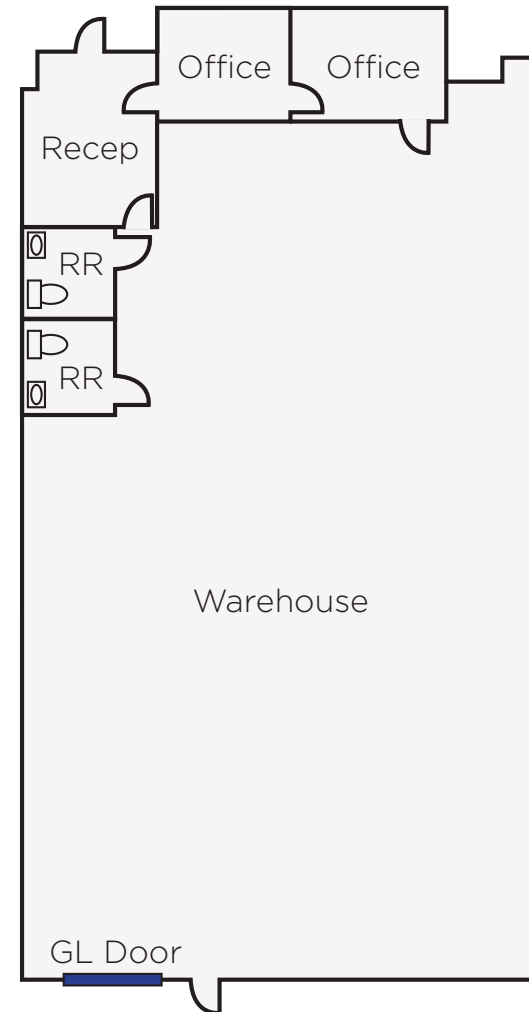

LOCATION

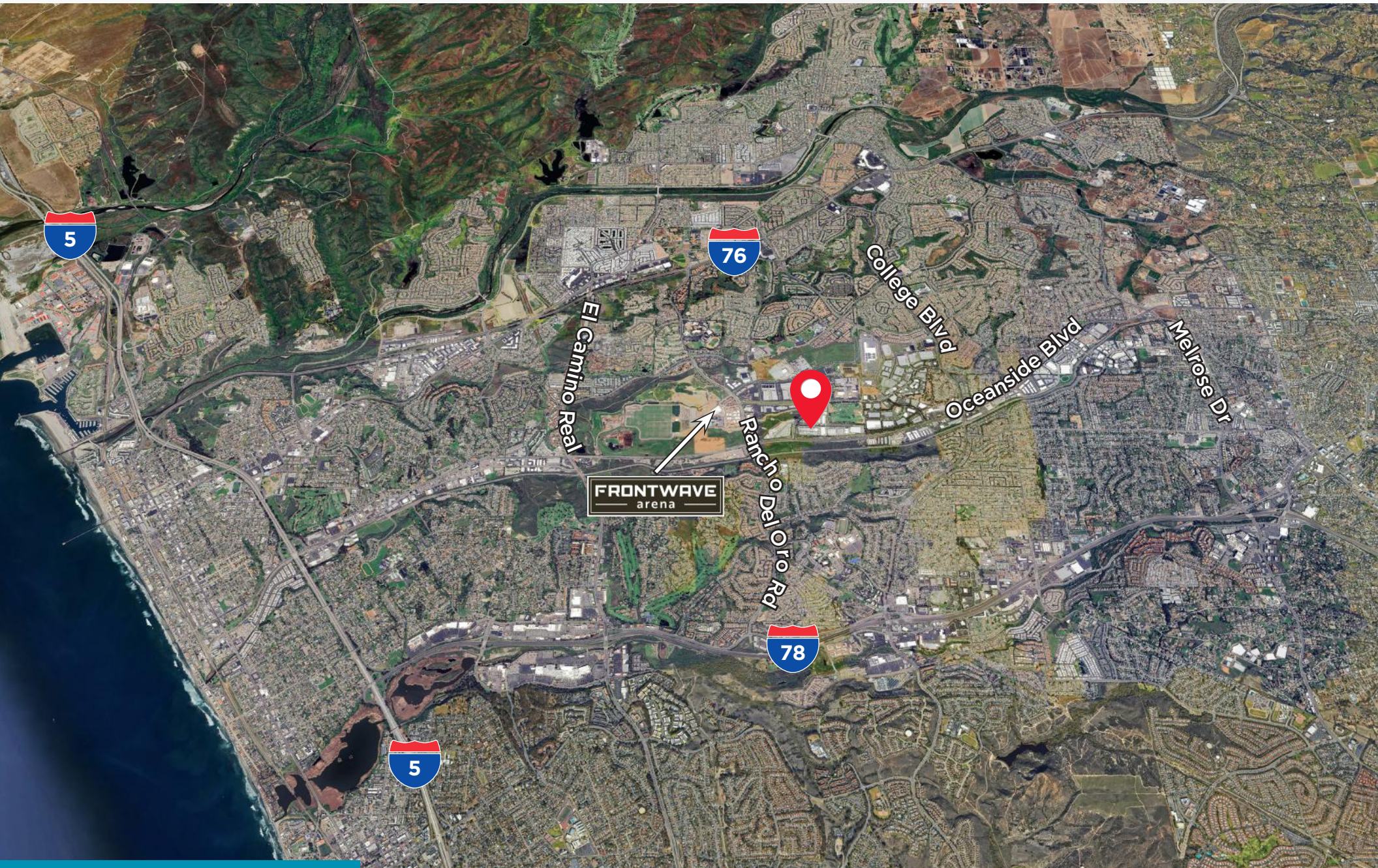

3909 OCEANIC DRIVE, UNIT 403, OCEANSIDE, CA

3909 OCEANIC DRIVE, UNIT 403 //// OCEANSIDE

FOR LEASE



JOE CROTTY

760.473.1811
joe.crotty@cushwake.com
Lic. No.01369821

TYLER STEMLEY

760.908.4270
tyler.stemley@cushwake.com
Lic. No.02003867

CONOR BOYLE

760.458.5739
conor.boyle@cushwake.com
Lic. No.01813305

©2024 Cushman & Wakefield. All rights reserved. The information contained in this communication is strictly confidential. This information has been obtained from sources believed to be reliable but has not been verified. NO WARRANTY OR REPRESENTATION, EXPRESS OR IMPLIED, IS MADE AS TO THE CONDITION OF THE PROPERTY (OR PROPERTIES) REFERENCED HEREIN OR AS TO THE ACCURACY OR COMPLETENESS OF THE INFORMATION CONTAINED HEREIN, AND SAME IS SUBMITTED SUBJECT TO ERRORS, OMISSIONS, CHANGE OF PRICE, RENTAL OR OTHER CONDITIONS, WITHDRAWAL WITHOUT NOTICE, AND TO ANY SPECIAL LISTING CONDITIONS IMPOSED BY THE PROPERTY OWNER(S). ANY PROJECTIONS, OPINIONS OR ESTIMATES ARE SUBJECT TO UNCERTAINTY AND DO NOT SIGNIFY CURRENT OR FUTURE PROPERTY PERFORMANCE.

