

FOR SUBLEASE

18219 77TH PL S SUITE 101
KENT, WA 98032



Below Market Rates \$0.85/SF Blended



PROPERTY HIGHLIGHTS



Available Space

±20,000 SF - 35,000 SF



Office Size

2,167 SF



Clear Height

24'



Loading

5-8 Dock High | 1 Grade Level



Sprinkler

ESFR



Column Spacing

±52' x 32'



Year Built

1979



Master Lease Expiration

7/31/2027



Rate

\$0.85/SF Blended plus NNN

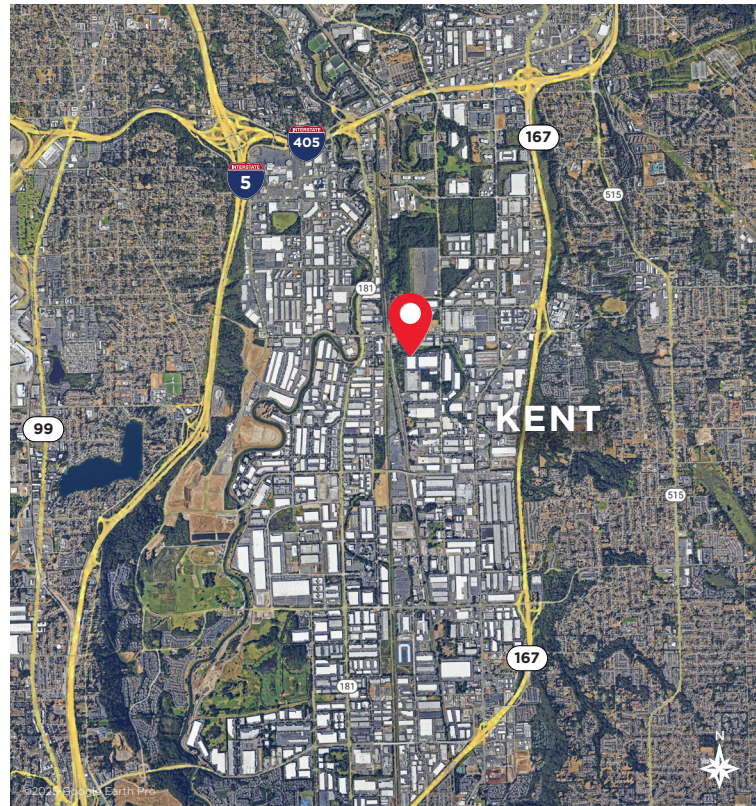

CONTACT

PATRICK MULLIN
Executive Managing Director
+1 206 521 0265
patrick.mullin@cushwake.com

SCOTT ALAN, SIOR
Executive Managing Director
+1 206 521 0236
scott.alan@cushwake.com

NICOLAS ALFIERI
Senior Associate
+1 425 985 5764
nicolas.alfieri@cushwake.com

601 Union Street, Suite 1100
Seattle, Washington 98101

cushmanwakefield.com

©2025 Cushman & Wakefield. All rights reserved. The material in this presentation has been prepared solely for information purposes, and is strictly confidential. Any disclosure, use, copying or circulation of this presentation (or the information contained within it) is strictly prohibited, unless you have obtained Cushman & Wakefield's prior written consent. The views expressed in this presentation are the views of the author and do not necessarily reflect the views of Cushman & Wakefield. Neither this presentation nor any part of it shall form the basis of, or be relied upon in connection with any offer, or act as an inducement to enter into any contract or commitment whatsoever. NO REPRESENTATION OR WARRANTY IS GIVEN, EXPRESS OR IMPLIED, AS TO THE ACCURACY OF THE INFORMATION CONTAINED WITHIN THIS PRESENTATION, AND CUSHMAN & WAKEFIELD IS UNDER NO OBLIGATION TO SUBSEQUENTLY CORRECT IT IN THE EVENT OF ERRORS.

SITE PLAN

Flexible Divisible Options Available

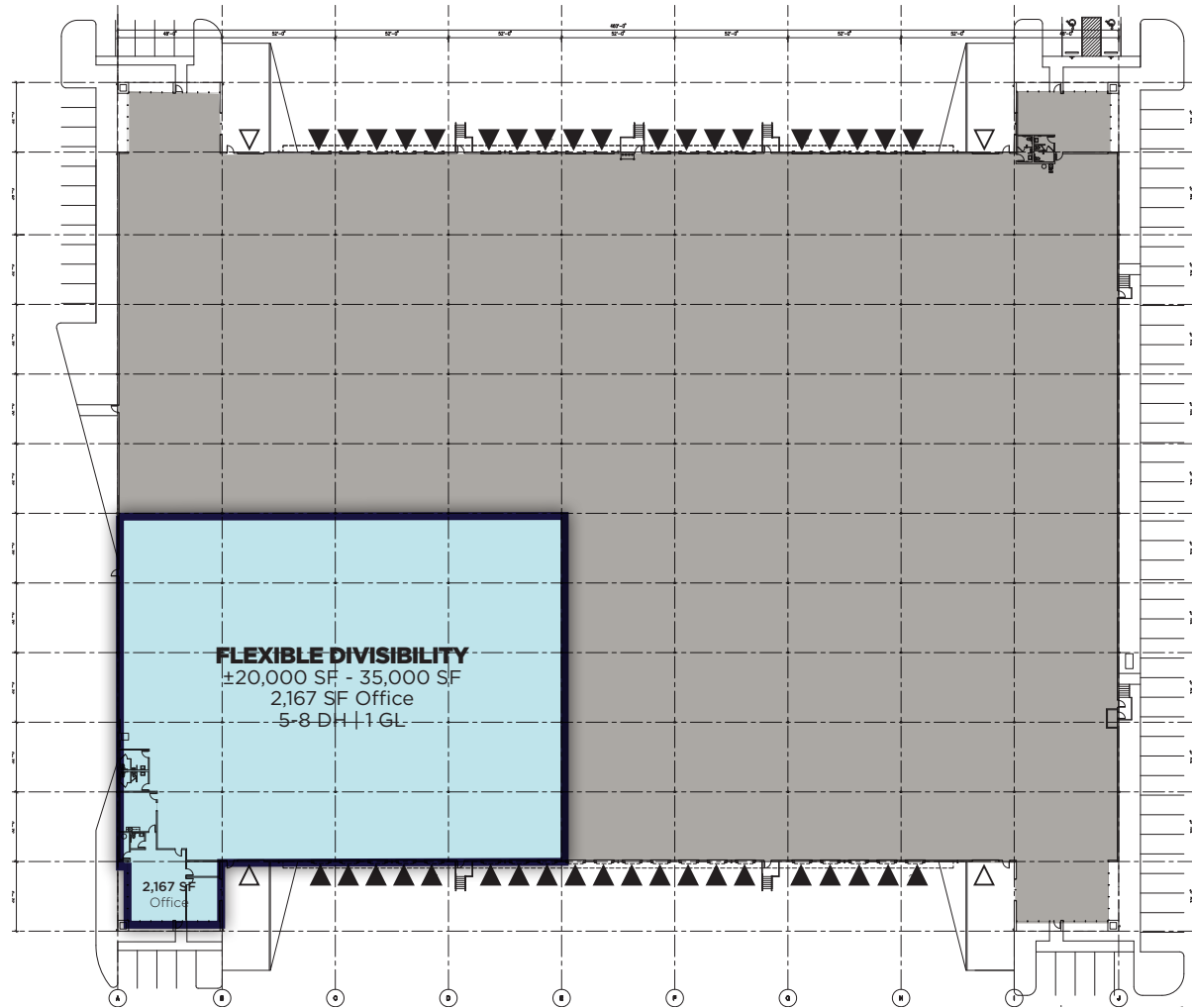

CONTACT

PATRICK MULLIN
Executive Managing Director
+1 206 521 0265
patrick.mullin@cushwake.com

SCOTT ALAN, SIOR
Executive Managing Director
+1 206 521 0236
scott.alan@cushwake.com

NICOLAS ALFIERI
Senior Associate
+1 425 985 5764
nicolas.alfieri@cushwake.com



©2025 Cushman & Wakefield. All rights reserved. The material in this presentation has been prepared solely for information purposes, and is strictly confidential. Any disclosure, use, copying or circulation of this presentation (or the information contained within it) is strictly prohibited, unless you have obtained Cushman & Wakefield's prior written consent. The views expressed in this presentation are the views of the author and do not necessarily reflect the views of Cushman & Wakefield. Neither this presentation nor any part of it shall form the basis of, or be relied upon in connection with any offer, or act as an inducement to enter into any contract or commitment whatsoever. NO REPRESENTATION OR WARRANTY IS GIVEN, EXPRESS OR IMPLIED, AS TO THE ACCURACY OF THE INFORMATION CONTAINED WITHIN THIS PRESENTATION, AND CUSHMAN & WAKEFIELD IS UNDER NO OBLIGATION TO SUBSEQUENTLY CORRECT IT IN THE EVENT OF ERRORS.