

FOR LEASE

# 7100 N LOOP E

HOUSTON, TX 77028



CUSHMAN &  
WAKEFIELD

# 7100 N LOOP E

HOUSTON, TX 77028

## BUSINESS PARK & LOCATION HIGHLIGHTS

- Great Freeway Frontage on Loop 610
- Excellent Ingress and Egress
- Fully Sprinklered
- 16' Clear Height
- Secured Truck Court
- Rear Load Building Configuration

### AVAILABLE UNITS

<b>A-18</b>	3,000 SF	<b>Available Now</b>
<b>A-19</b>	14,999 SF	Available Dec 1
<b>A-20</b>	4,840 SF	Available Dec 1

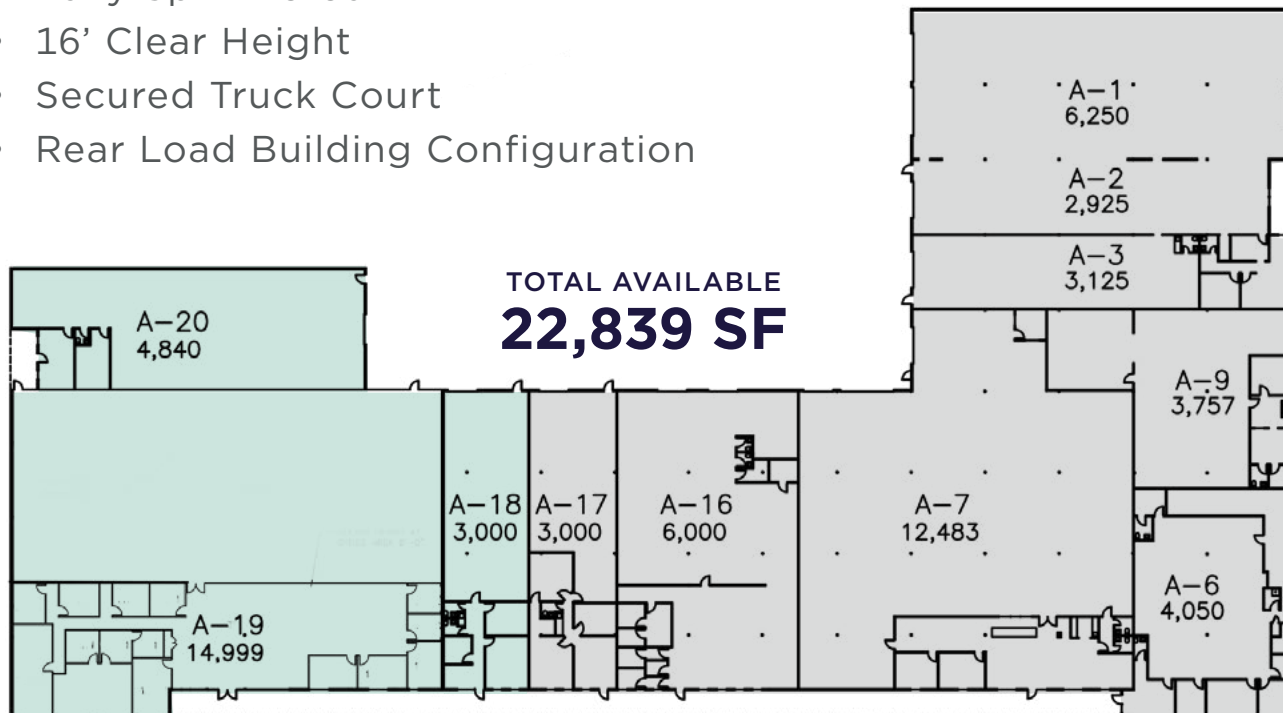

**ALSO AVAILABLE NOW**

**± 25,000 SF  
FREESTANDING  
WAREHOUSE IN  
SAME BUSINESS  
PARK**

**CLICK TO  
VIEW FLYER**

# 7100 N LOOP E

HOUSTON, TX 77028

## SUITE A-18

### PROPERTY DETAILS

TOTAL SF	± 3,000 SF
OFFICE SF	± 900 SF
WAREHOUSE SF	± 2,100 SF
CLEAR HEIGHT	16'
DOORS	1 Semi Dock Door w/ Ramp
AVAILABILITY	<b>Available Now</b>

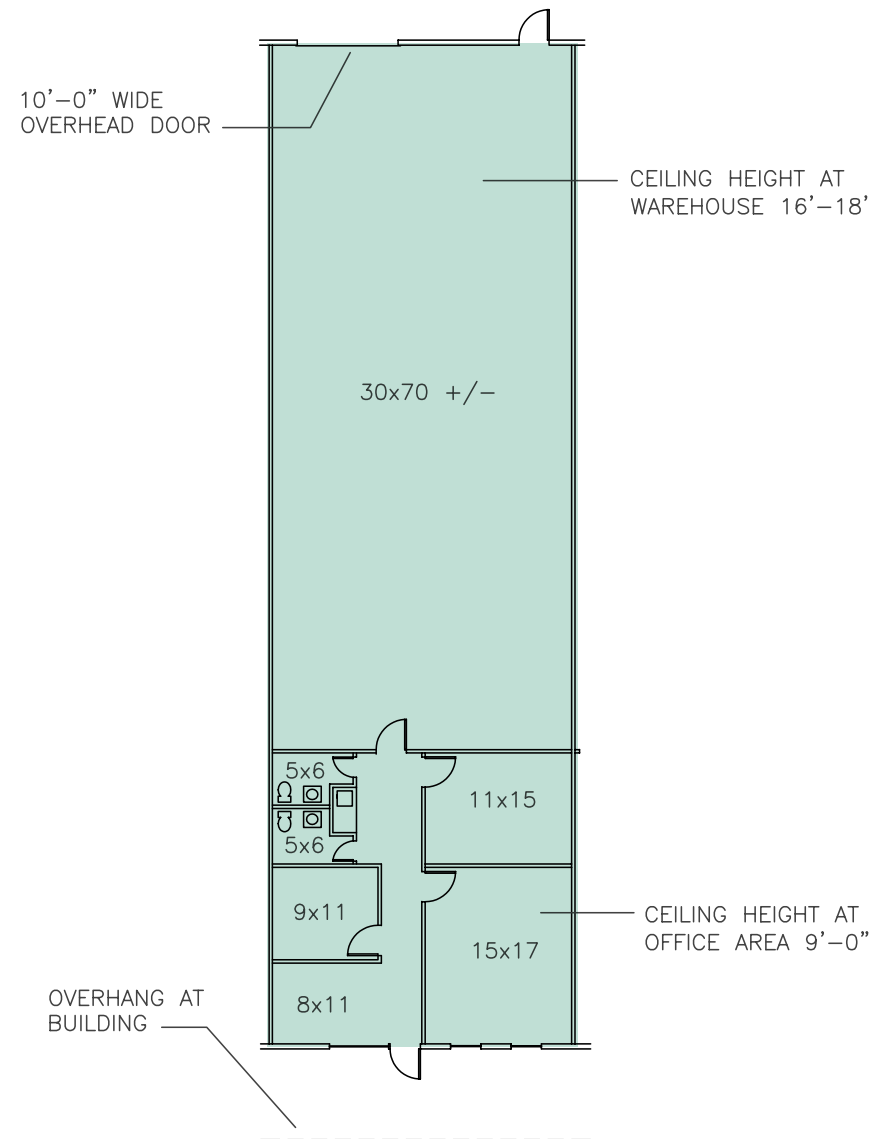
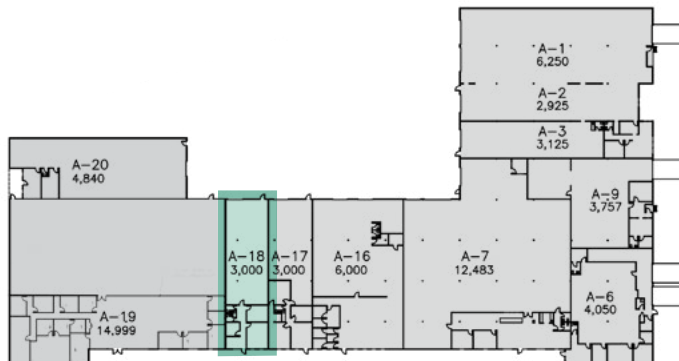

# 7100 N LOOP E

HOUSTON, TX 77028

## SUITE A-19

### PROPERTY DETAILS

TOTAL SF	± 14,999 SF
OFFICE SF	± 5,575 SF
WAREHOUSE SF	± 9,424 SF
CLEAR HEIGHT	16'
DOORS	1 Semi Dock, 1 Ramp
AVAILABILITY	December 1

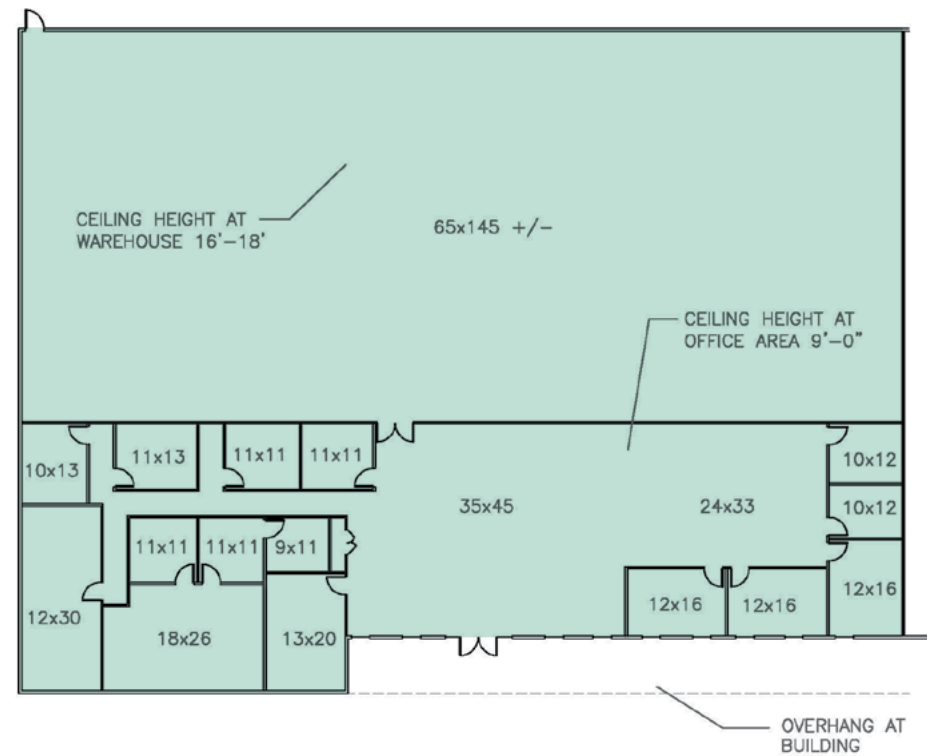
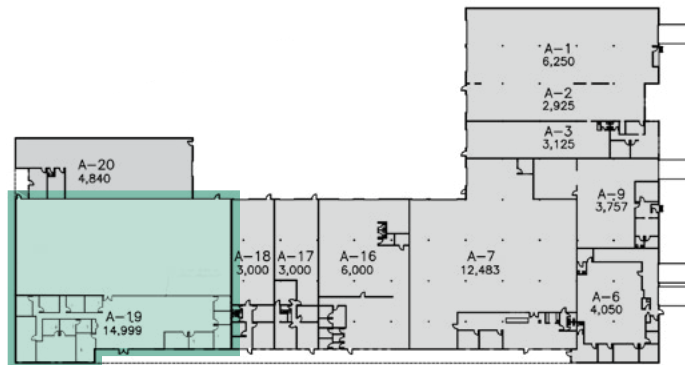

# 7100 N LOOP E

HOUSTON, TX 77028

## SUITE A-20

### PROPERTY DETAILS

TOTAL SF ±4,840 SF

OFFICE SF ± 600 SF

WAREHOUSE SF ± 4,240 SF

CLEAR HEIGHT 16'

DOORS 2 Ramps

AVAILABILITY December 1

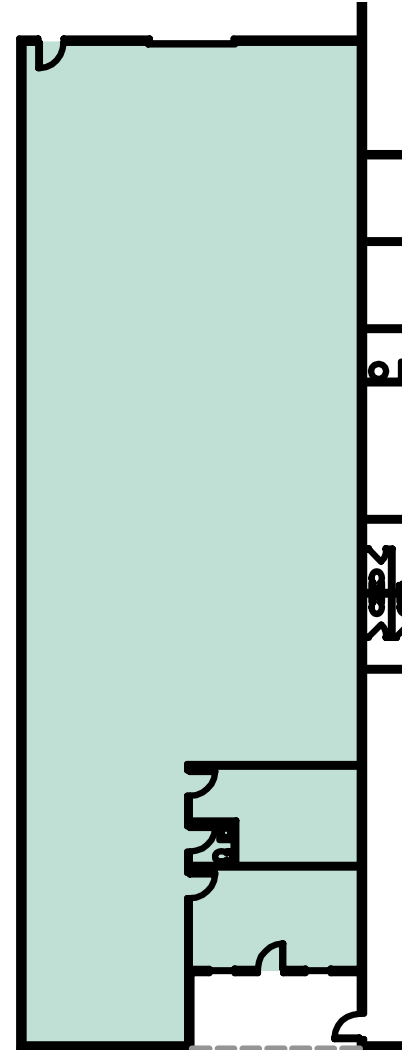
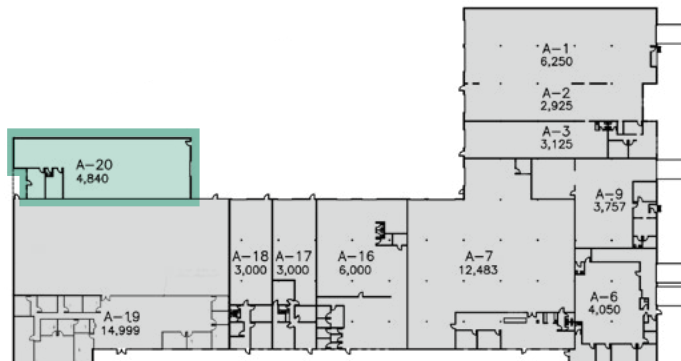

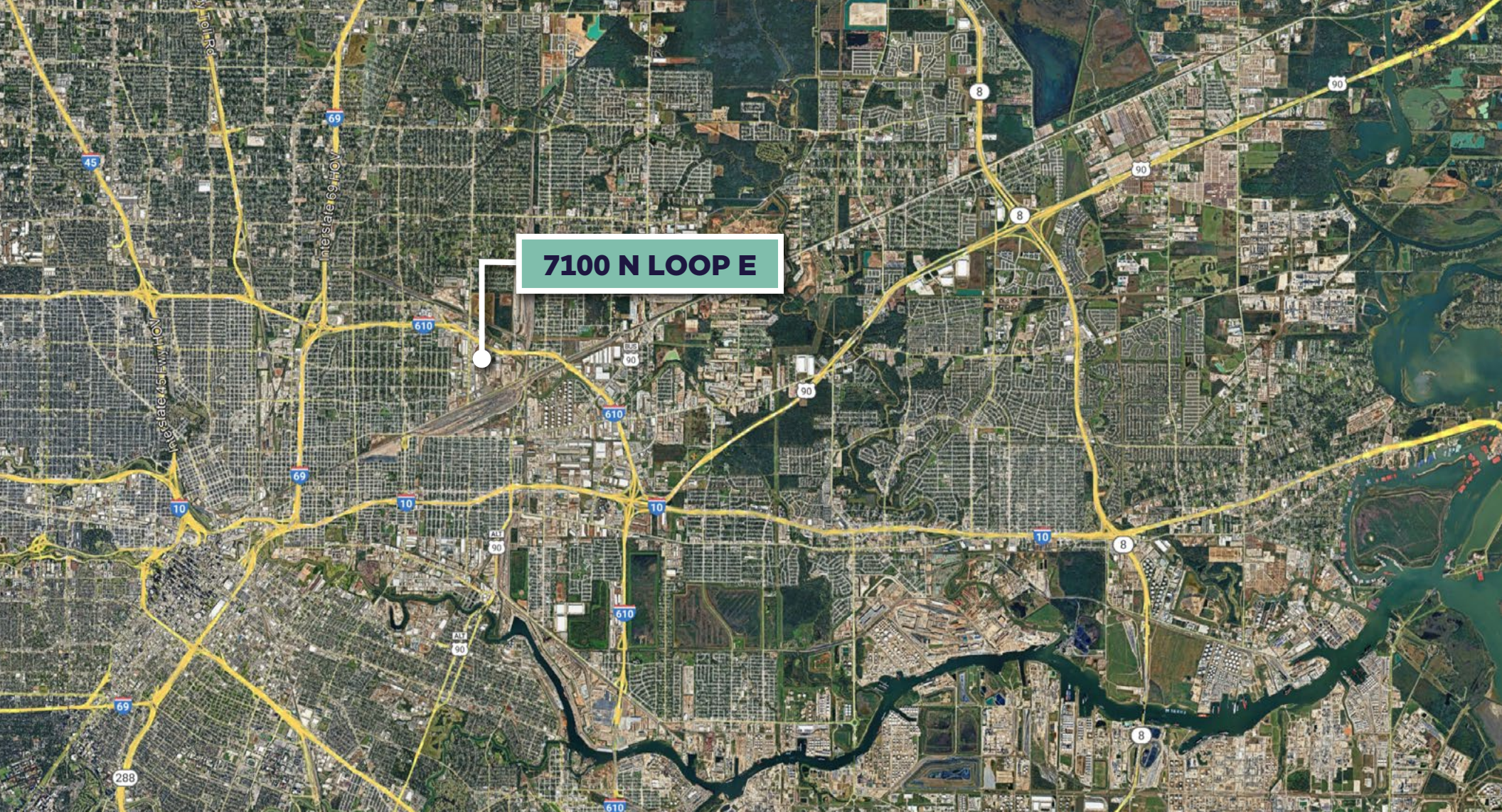

**7100 N LOOP E**

**FOR MORE INFORMATION, CONTACT:**

DAVID MUSON  
Executive Managing Director  
Direct: +1 713 913 5473  
Mobile: +1 832 545 8204  
david.munson@cushwake.com

GARRETT THOMAS  
Director  
Direct: +1 713 260 0244  
Mobile: +1 318 581 7695  
garrett.thomas@cushwake.com

1330 Post Oak Blvd.  
Houston, Texas 77056  
+1 713 877 1700  
cushmanwakefield.com

