



MFG/INDUSTRIAL/DISTRIBUTION

LEASE RATE: \$7.00/SF NNN



- 203,840 SF of New Construction!
- Divisible 43,680 - 203,840 SF
- 2,273 SF Office
- 32' Clear Height
- (24) Dock Doors; (13) Knock Outs
- (2) Drive-In Doors
- I-2; Heavy Industrial Zoning
- Close proximity to Cincinnati/N. Kentucky International Airport, DHL SuperCargo and Amazon Air Hubs

For more information, contact:

Jeffrey R. Bender, SIOR, CCIM
Executive Vice Chair
+1 513 763 3046
jeff.bender@cushwake.com

David Kelly, CCIM
Managing Director
+1 513 763 3009
dave.kelly@cushwake.com

Seattle Stein
Director
+1 513 763 3027
seattle.stein@cushwake.com

**CROW
HOLDINGS**

CAPITAL

© 2022 Cushman & Wakefield. All rights reserved. The information contained in this communication is strictly confidential. This information has been obtained from sources believed to be reliable but has not been verified. NO WARRANTY OR REPRESENTATION, EXPRESS OR IMPLIED, IS MADE BY THE COMPANY OR THE PROPERTY (OR PROPERTIES) REFERENCED HEREIN AS TO THE ACCURACY OR COMPLETENESS OF THE INFORMATION CONTAINED HEREIN, AND THE SAME IS SUBMITTED SUBJECT TO ERRORS, OMISSIONS, AND CHANGES WITHOUT NOTICE. THE COMPANY AND THE PROPERTY (OR PROPERTIES) REFERENCED HEREIN MAKE NO REPRESENTATION OR WARRANTY AS TO THE ACCURACY, COMPLETENESS, OR RELIABILITY OF ANY INFORMATION, INCLUDING BUT NOT LIMITED TO, PRICE, RENTAL OR OTHER CONDITIONS, WITHDRAWAL WITHOUT NOTICE, AND TO ANY SPECIAL LISTING CONDITIONS IMPOSED BY THE PROPERTY OWNER(S). ANY PROJECTIONS, OPINIONS OR ESTIMATES ARE SUBJECT TO UNCERTAINTY AND DO NOT SIGNIFY CURRENT OR FUTURE PROPERTY PERFORMANCE.

BUILDING SPECIFICATIONS

LEASE RATE: \$7.00/SF NNN

LOCATION	Walton, KY	LIGHTING	LED Lighting
BUILDING SIZE	203,840 SF (260' x 784')	DOCK DOORS	(24) 9' x 10'; (13) knock out panels
OFFICE SIZE	2,273 SF	DRIVE-IN DOORS	(2) 12' x 14' with electric operators
ACRES	15±	TRUCK COURT	130' - 185' of 10" thick non-reinforced concrete pavement
YEAR BUILT	2023	ELECTRIC	1,200 amps with the capacity to increase to 3,000 amps; 480 volt; 3 phase
CONSTRUCTION	Tilt-Wall concrete panels - white interior	HVAC	Gas fired air/energy rotation rack units
CLEAR HEIGHT	32'	ELECTRIC	www.owenelectric.com
COLUMN SPACING	56' x 50' typical; 56' x 60' speed bay	GAS	www.duke-energy.com
FLOORS	7" unreinforced, 4,000 psi concrete	WATER	www.boonewater.com
ROOF	Mechanically-attached 0.60 mil TPO with R-20.5 insulation	SEWER	www.sd1.org
PARKING	190± auto stalls; 35 trailer stalls	TELEPHONE	www.altafiber.com
FIRE SUPPRESSION	ESFR	DATA	www.spectrum.com

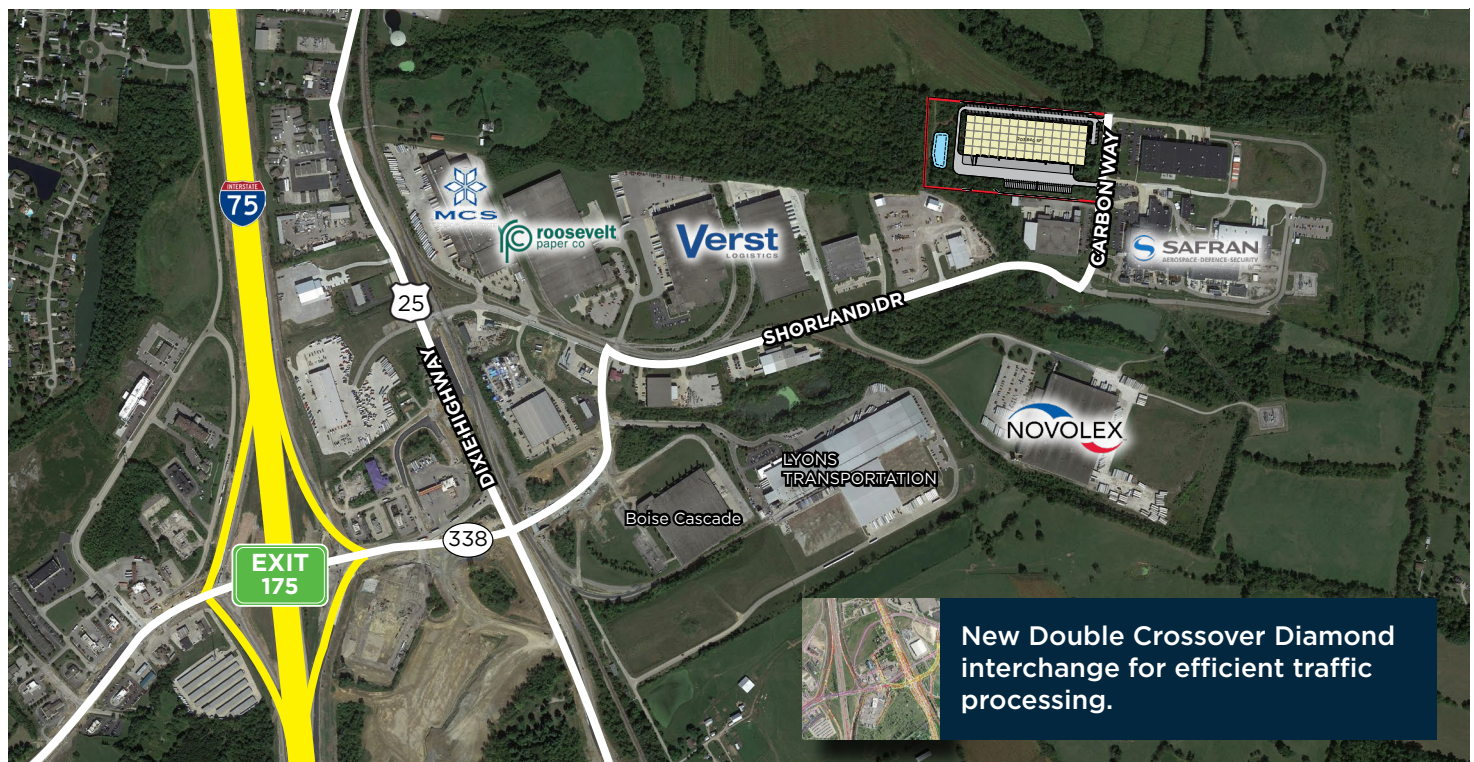

BUILDING PLAN

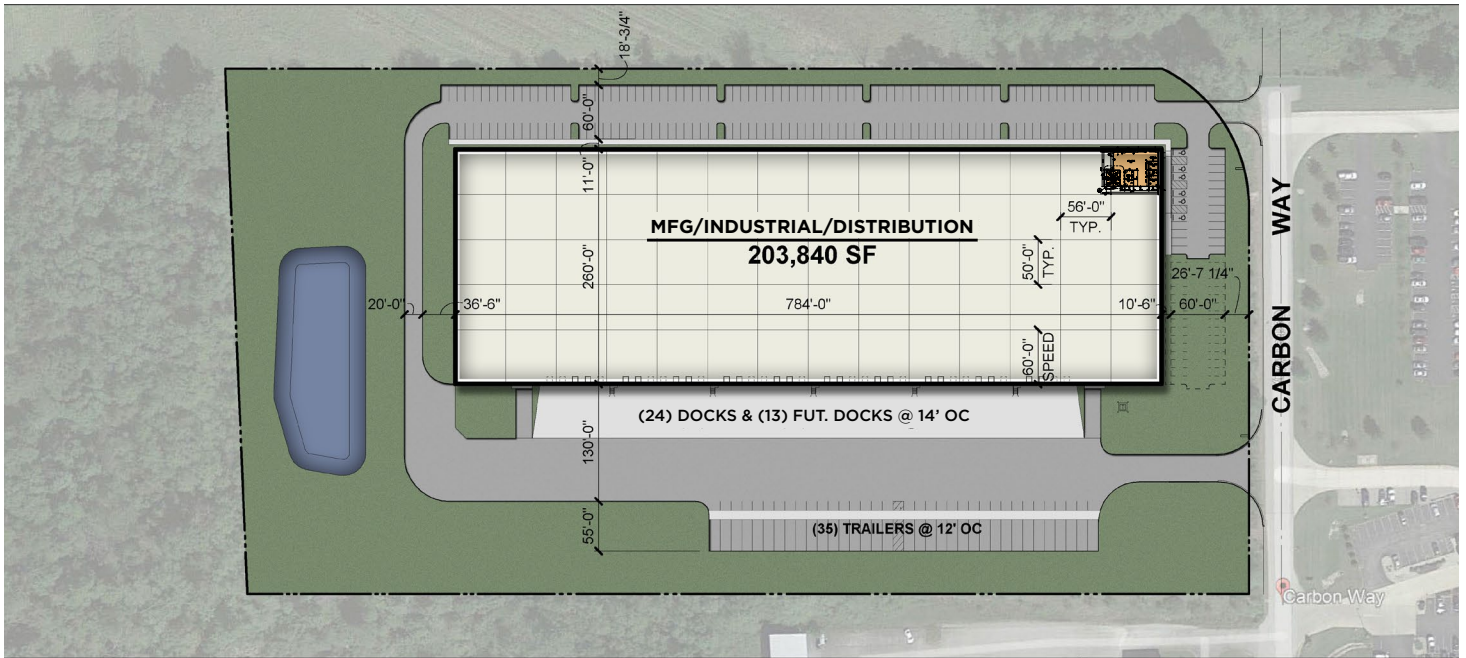

OFFICE PLAN

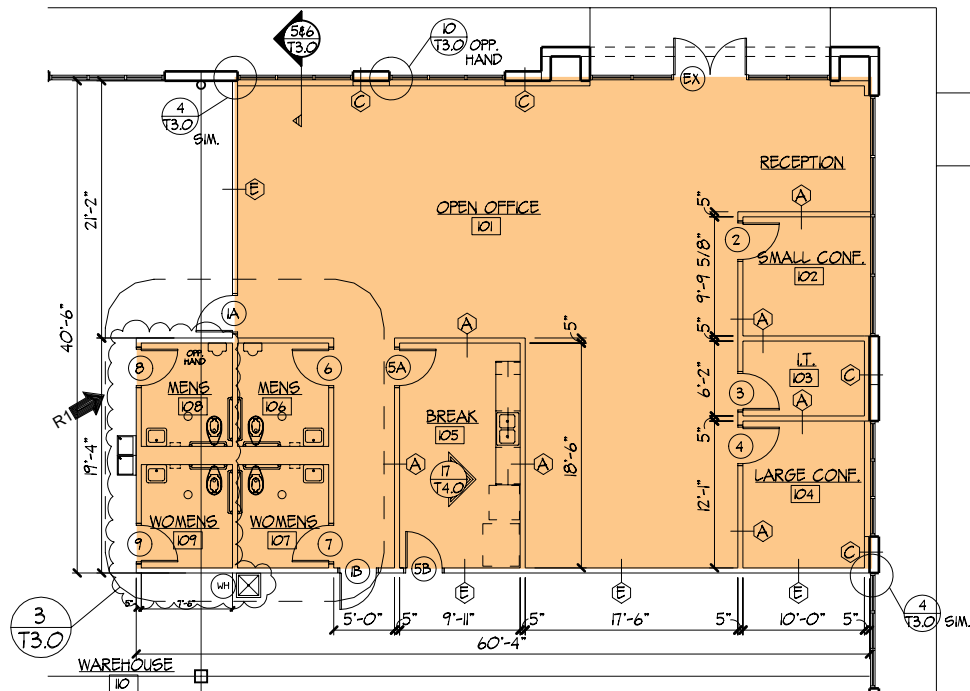

PHOTOS

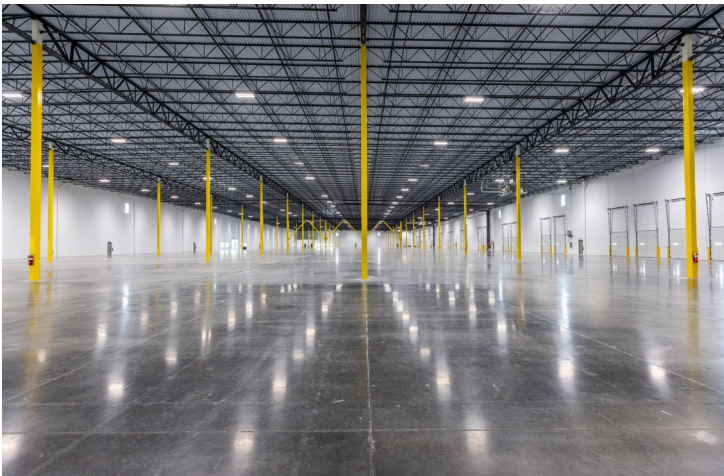

AERIAL LOCATION



For more information, contact:

Jeffrey R. Bender, SIOR, CCIM
Executive Vice Chair
+1 513 763 3046
jeff.bender@cushwake.com

David Kelly, CCIM
Managing Director
+1 513 763 3009
dave.kelly@cushwake.com

Seattle Stein
Director
+1 513 763 3027
seattle.stein@cushwake.com

**CROW
HOLDINGS**
CAPITAL