

5340 SOUTH QUEBEC STREET | GREENWOOD VILLAGE, CO 80111



Greenwood Place



ZACHARY T. WILLIAMS
303.813.6474
zach.williams@cushwake.com

W. RYAN STOUT
303.813.6448
ryan.stout@cushwake.com

CAITLIN ELLENSON
303.312.1914
caitlin.ellenson@cushwake.com





work where balance Comes Naturally

At Greenwood Place, work feels effortless. Surrounded by mountain views and fresh air, this thoughtfully designed environment brings calm to your workday. Flexible spaces, refined interiors, and wellness-driven amenities create the ideal balance between productivity and peace — a place where focus and comfort coexist.

Move-In Ready Spaces

3-story, 73,429 SF office building with spec suites ready for immediate occupancy and secure 24-hour key card access

Connected & Convenient

Steps from The Landmark's retail and dining, with seamless access to I-25, I-225, and Belleview Avenue

Wellness-Inspired Amenities

Recharge in the fitness center, collaborate in the tenant lounge, or unwind in the outdoor pavilion



Views That Refresh

Expansive mountain vistas and outdoor spaces bring calm and inspiration to your workday



designed for the way **You Work**

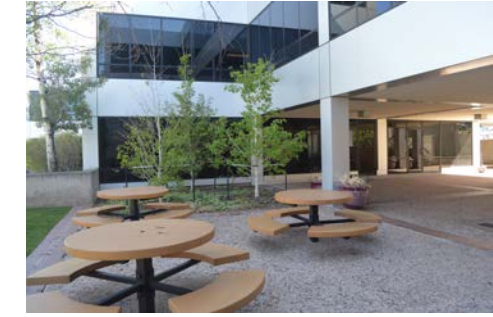

Easy Access to Belleview Ave.,
E. Orchard Rd., I-25 & I-225



Outdoor Pavilion with Seating



Tenant Lounge



252 Free Surface Spaces



Common Conference Room



Scenic Mountain Views



Fitness Center with
Showers & Lockers



Monument Signage Available



24-Hour Key Card
Access & Security



step out. explore.

Recharge.

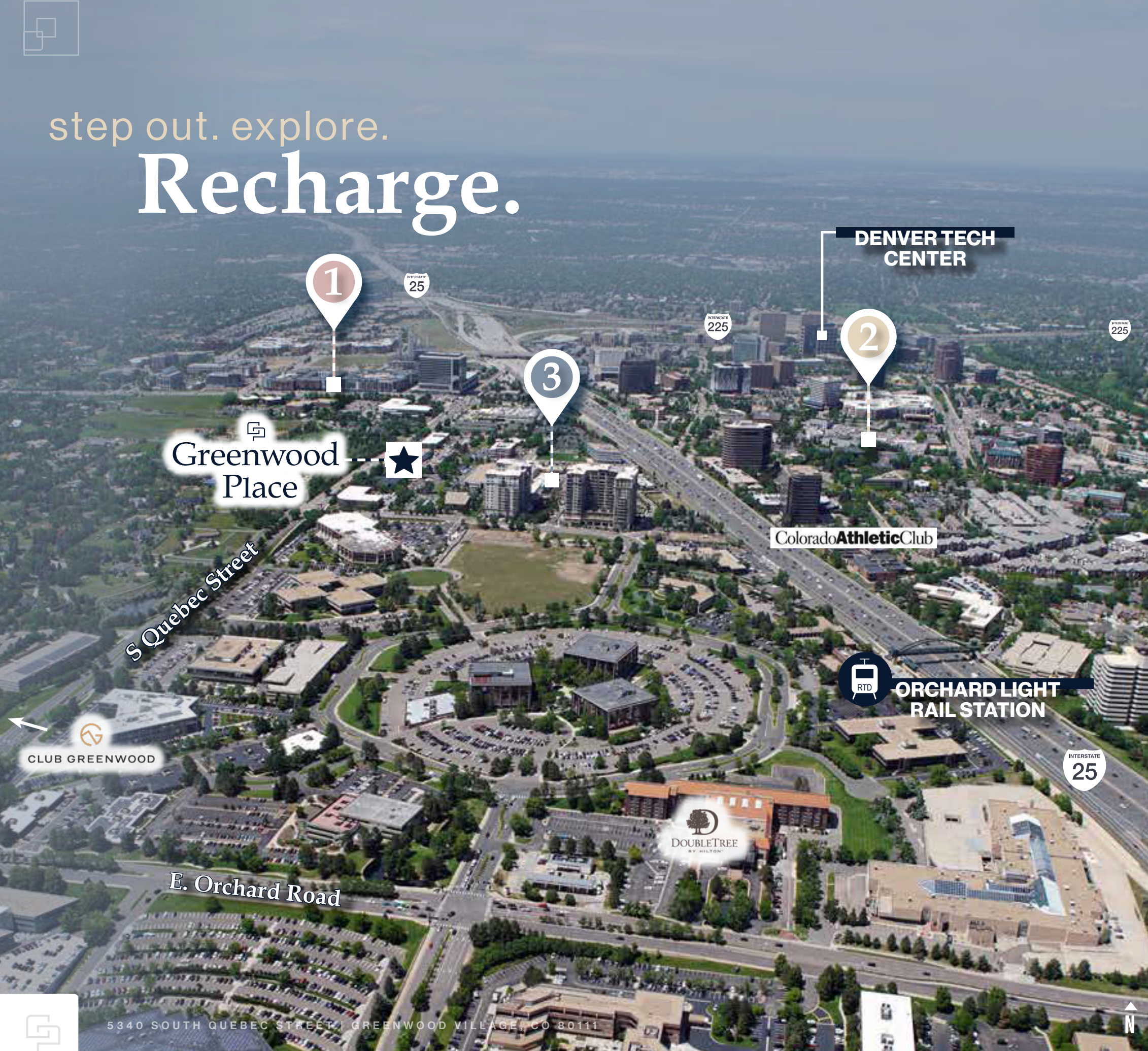

Bellevue STATION

- | | |
|----------------------------|-----------------------------|
| 1. Ruth's Chris Steakhouse | 9. Barre |
| 2. Yampa Sandwich Co. | 10. Frozen Matter |
| 3. Corvus Coffee Roasters | 11. Orangetheory |
| 4. Los Chingones | 12. Waxing the City |
| 5. Ambli | 13. Midici Pizza Napoletana |
| 6. Sushi-rama | 14. Tap Burger |
| 7. Urban Egg | 15. Le French |
| 8. A Line Boutique | |

Bellevue PROMENADE

- | | |
|----------------------|-------------------------------|
| 1. Firehouse Subs | 6. The Original Pancake House |
| 2. Starbucks | 7. Bara Sushi & Grill |
| 3. Il Fornaio | 8. Chipotle |
| 4. Noodles & Company | 9. Larkburger |
| 5. Ocean Prime | |

Landmark

- | | |
|-------------------------|--------------------------------|
| 1. Pizza Republica | 5. Cyclebar |
| 2. Slattery's Irish Pub | 6. Hapa Sushi Grill & Sake Bar |
| 3. Jing | 7. Yanni's Greek Cuisine |
| 4. Ted's Montana Grill | 8. Early Bird Restaurant |



DENVER CBD
31 min. | 11.5 mi.

CHERRY CREEK
19 mins | 4.8 mi.



Greenwood Place

ZACHARY T. WILLIAMS

303.813.6474

zach.williams@cushwake.com

W. RYAN STOUT

303.813.6448

ryan.stout@cushwake.com

CAITLIN ELLENSON

303.312.1914

caitlin.ellenson@cushwake.com

