

# For Lease



**Crosspoint VIII**  
**7998 Centerpoint Dr., Suite 300**  
**Indianapolis, IN 46256**

**±19,221 Square Feet Available**



## OFFICE/WAREHOUSE SPACE

- Total Available SF: ±19,221 SF
- Office SF: ±2,435 SF
- Ceiling Height: 27.5'
- Docks: 5
- Drive-in Door: 1
- ESFR Sprinkler
- Convenient access to I-69 and I-465
- Lease Rate: TBD
- 2025 OPEX: \$2.82/SF
- Available: ±July 1, 2025



Managed by:



CLARION PARTNERS

## Crosspoint VIII

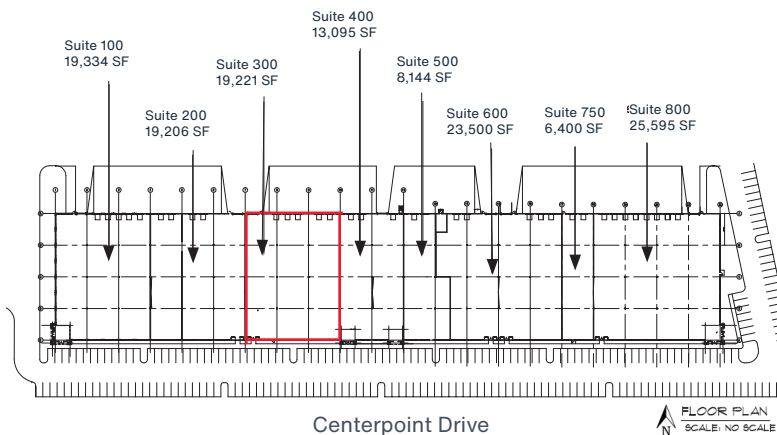
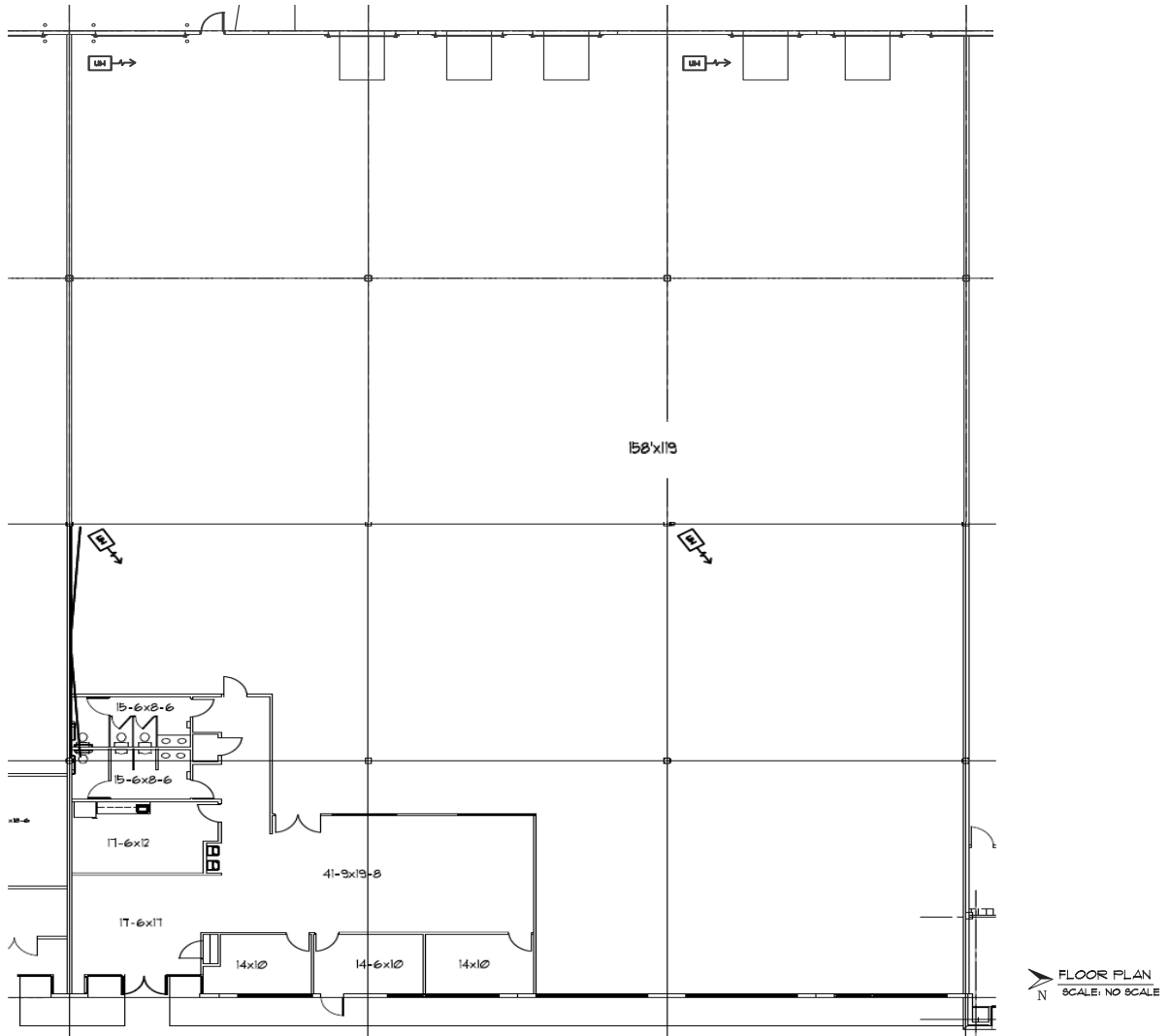

CLARION  
PARTNERS

[www.clarionpartners.com](http://www.clarionpartners.com)

For more information on this  
opportunity, please contact.



Bryan W. Poynter, SIOR, CCIM  
+1 317 670 4171  
[bryan.poynter@cushwake.com](mailto:bryan.poynter@cushwake.com)

Fritz A. Kauffman, SIOR  
+1 317 753 4444  
[fritz.kauffman@cushwake.com](mailto:fritz.kauffman@cushwake.com)

Crosspoint VIII is a well-located  
industrial building with a diverse  
tenant mix in the heart of the fastest  
growing community in Indiana.