

**AVAILABLE
8,200 SF**



FOR SALE | \$1,875,000.00

1917 INDUSTRIAL ROAD

NAMPA, IDAHO 83687



1917 INDUSTRIAL ROAD

NAMPA, IDAHO 83687

Property Highlights

Building Size:	1,800 SF Office/Showroom
	6,400 SF Warehouse
	8,200 SF TOTAL
Lot Size:	0.69 Acres
Leaseback:	Seller to lease property for up to one (1) year after closing
Zoning:	IL (Light industrial)
Year Built:	2003
Parcel Number:	R3118001000

Property Features



PAVED PARKING
-2.32/1,000



**STRONG
GROWTH MARKET**



**ESTABLISHED
INDUSTRIAL AREA**



**FENCED
STORAGE YARD**



1917 INDUSTRIAL ROAD

NAMPA, IDAHO 83687



WAREHOUSE

- Clear height: 12'-21' at peak
- 1 (12'x10') grade level door
- 1 (12'x12') grade level door
- Small secure yard
- Excess parking



OFFICE / SHOWROOM

- ±1,800 SF
- Store front doors
- 2 Restrooms
- Great for sales / distribution user

1917 INDUSTRIAL ROAD NAMPA, IDAHO 83687



1917 INDUSTRIAL ROAD
NAMPA, IDAHO 83687

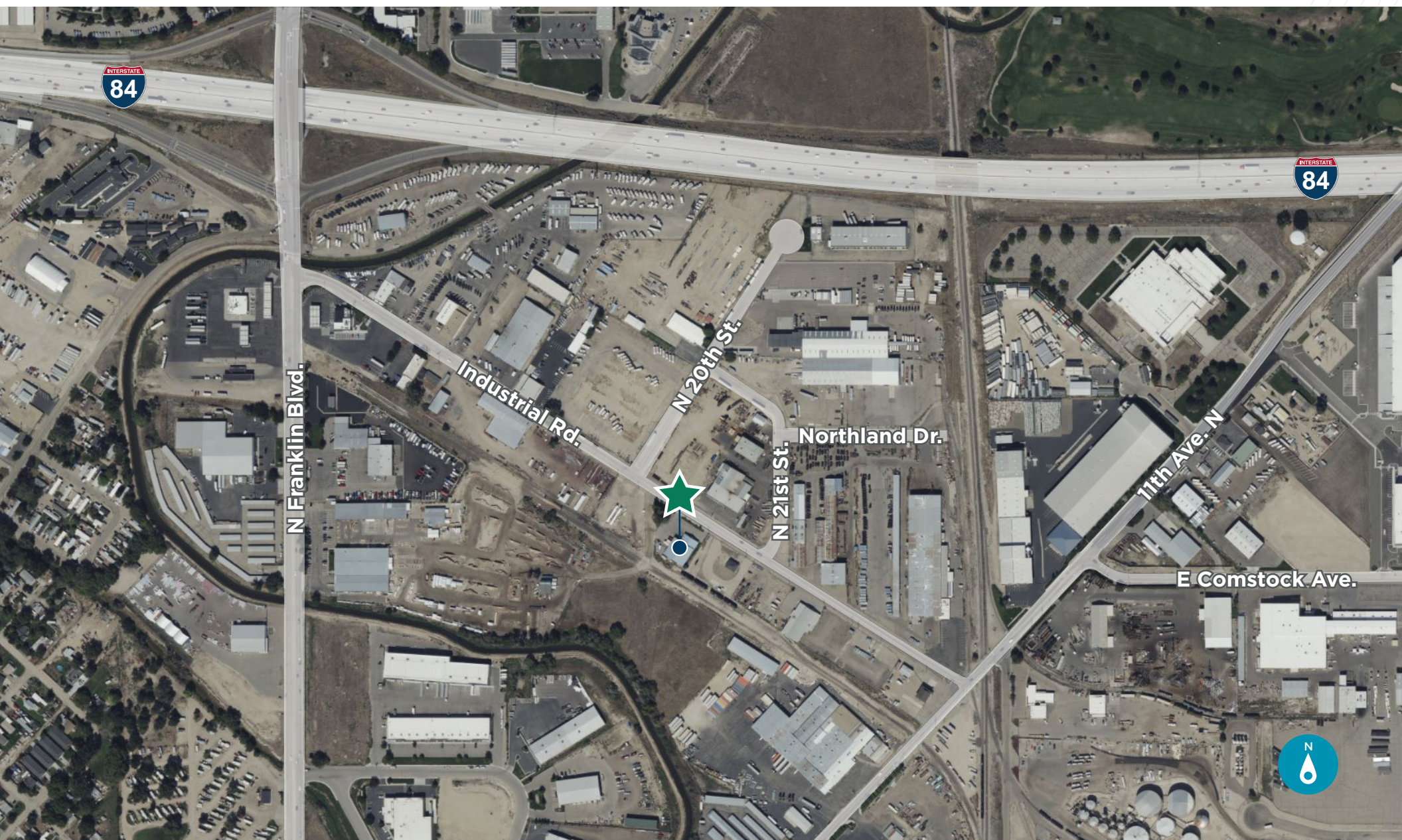



FOR MORE INFORMATION, CONTACT:

STEPHEN FIFE

Senior Director
+1 208 559 4581
stephen.fife@cushwake.com

TYLER MARTIN, MAI

Senior Associate
+1 208 921 7037
tyler.martin@cushwake.com

999 West Main St., Suite 1300
Boise, Idaho 83702
+1 208 287 9500
cushmanwakefield.com

©2025 Cushman & Wakefield. All rights reserved. The information contained in this communication is strictly confidential. This information has been obtained from sources believed to be reliable but has not been verified. NO WARRANTY OR REPRESENTATION, EXPRESS OR IMPLIED, IS MADE AS TO THE CONDITION OF THE PROPERTY (OR PROPERTIES) REFERENCED HEREIN OR AS TO THE ACCURACY OR COMPLETENESS OF THE INFORMATION CONTAINED HEREIN, AND SAME IS SUBMITTED SUBJECT TO ERRORS, OMISSIONS, CHANGE OF PRICE, RENTAL OR OTHER CONDITIONS, WITHDRAWAL WITHOUT NOTICE, AND TO ANY SPECIAL LISTING CONDITIONS IMPOSED BY THE PROPERTY OWNER(S). ANY PROJECTIONS, OPINIONS OR ESTIMATES ARE SUBJECT TO UNCERTAINTY AND DO NOT SIGNIFY CURRENT OR FUTURE PROPERTY PERFORMANCE.

