

THE HAT AT FIVE CORNERS

10215 95 Street NW
Edmonton, AB T5H 4M4

1,257 - 6,294 SF Available Immediately

THE HAT
FIVE CORNERS

RENT NOW
HATFIVECORNERS.COM
(825) 202-7276

VISIT OUR
LEASING
CENTRE

Cushman & Wakefield Edmonton

Suite 2700, TD Tower
10088 102 Avenue
Edmonton, AB T5J 2Z1
cwedm.com

Devan Ramage

Associate
780 702 9479
devan.ramage@cwedm.com

Cushman & Wakefield Edmonton is independently owned and operated / A Member of the Cushman & Wakefield Alliance. No warranty or representation express or implied is made to the accuracy or completeness of the information contained herein, and same is submitted subject to errors, omissions, change of price, rental or other conditions, withdrawal without notice, and to any special listing conditions imposed by the property owner(s). As applicable, we make no representation as to the condition of the property for properties in question. March 2025

THE OPPORTUNITY

Cushman and Wakefield Edmonton is pleased to present the unique main floor retail leasing opportunity in the Hat at Five Corners. The Hat at Five Corners provides exceptional curb appeal with multiple demising options available. This 199 unit mixed-use luxury complex will provide your business with a spacious open concept space with 20' ceiling height!

THE PROPERTY

- Conveniently located on the high traffic intersection of Jasper Avenue and 95 Street.
- High exposure to over 16,700 vehicles per day by being located at the corner of a major intersection.
- Healthy existing consumer based in residential tower
- Building predominately occupied by business professionals.
- Strategically located across the street from new Valley Line LRT (Quarters Stop LRT Station).
- South facing patio opportunity.
- DC1 Zoning allows for a wide variety of uses.
 - Possession available immediately.
- High exposure signage opportunities available.
- Nearby Tenants include The Moth Cafe, Syphay Restaurant and many others.



IDEAL FOR:



RESTAURANT



RETAIL STORE



MEDICAL USE

PROPERTY DETAILS

MUNICIPAL ADDRESS

10215 95 Street NW, Edmonton, AB

LEGAL DESCRIPTION

Plan 1221938, Block 1, Lot 2

ZONING

DC1

AVAILABLE SIZES

Retail Area 1: $\pm 1,257$ SF

Retail Area 2: $\pm 1,724$ SF

Retail Area 3: $\pm 2,551$ SF

Retail Area 4: $\pm 2,019$ SF

*Up to $\pm 6,294$ SF of contiguous space available

BASE RENT

Market

OPERATING COSTS

\$15.92/SF/annum (2025 estimate)

*Includes building insurance, property tax, common area maintenance and management fees

PARKING

Street parking in the area, plus potential for heated underground parking for tenants at current market rates

CEILING HEIGHT

20'±

OCCUPANCY

Available Immediately

LEASE TERM

Negotiable

TI ALLOWANCE

Negotiable

ROGERS PLACE

asa
art gallery of alberta

THE HAT
FIVE CORNERS

Quarters Stop
LRT Station

VALLEY LINE LRT

95 STREET NW (18,060 VPD)

JASPER AVENUE (17,953 VPD)

Street
Parking

Dog Park

Customer
Parking

Syphay
THAI & LAO CUISINE

The Moth



FLOOR PLAN

DEMOGRAPHICS

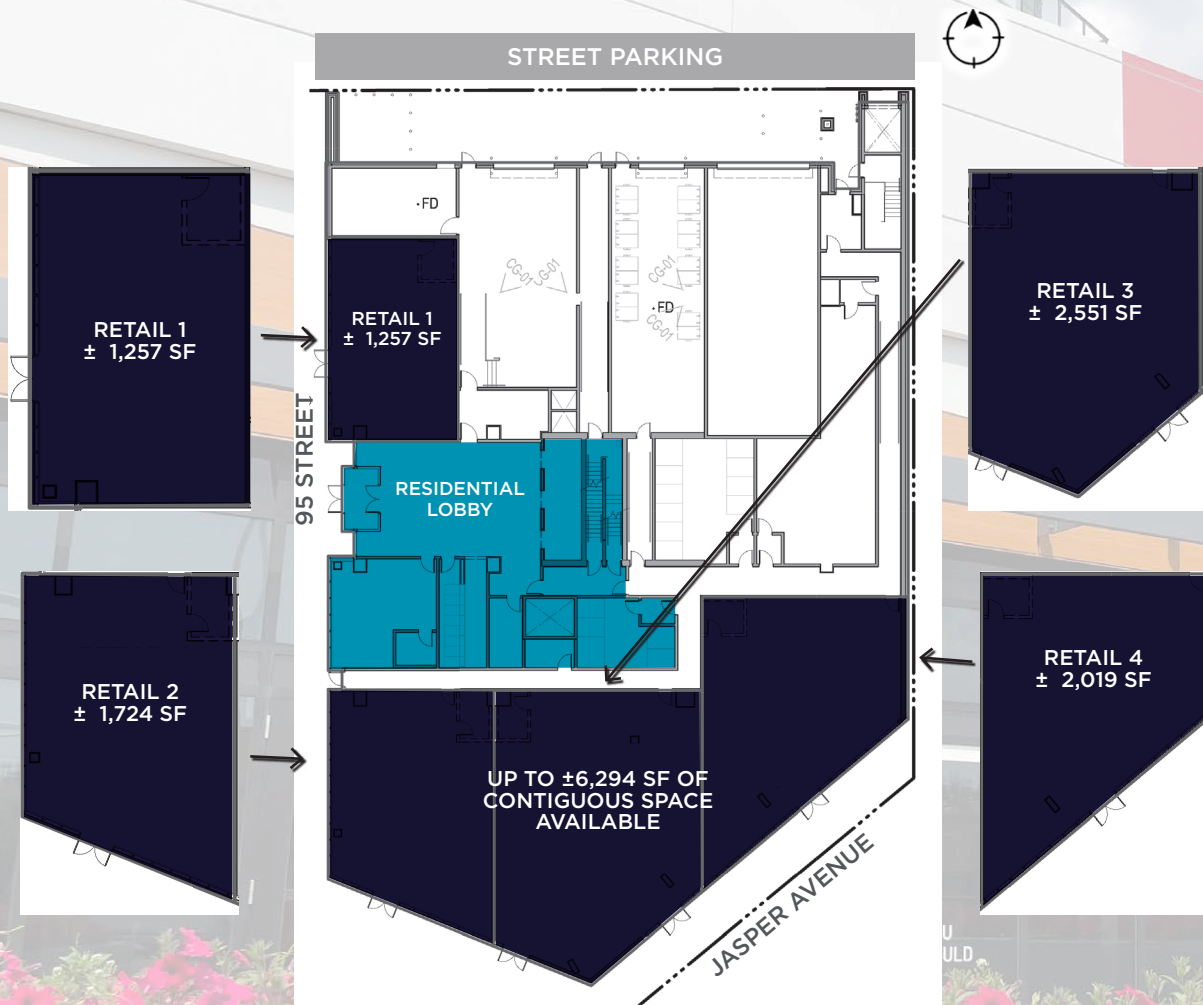

POPULATION	1km 9,900	3km 94,091	5km 211,961
HOUSEHOLDS	1km 5,056	3km 48,755	5km 102,924
AVERAGE INCOME	1km \$83,440	3km \$97,620	5km \$104,532
VEHICLES PER DAY	Jasper Avenue: 17,953	95 Street: 18,060	

CUSHMAN & WAKEFIELD
Edmonton

Devan Ramage
Associate
780 702 9479
devan.ramage@cwedm.com