

95 MAYHILL STREET

SADDLE BROOK, NJ 07663

48,500 SF AVAILABLE | FOR SUBLEASE

\$15.00/SF Gross



6 Month, 1-2 Year Terms Available

95 MAYHILL STREET

SADDLE BROOK, NJ 07663

48,500 SF AVAILABLE | FOR SUBLEASE



Property Highlights

- Available Immediately
- Phased in Occupancy Possible



5 Loading Docks



1 Drive-In
Door



22' Ceiling Height



1,500 SF Office



Sublease Through
12/31/2027



Flexible Terms
Available

Floor Plan

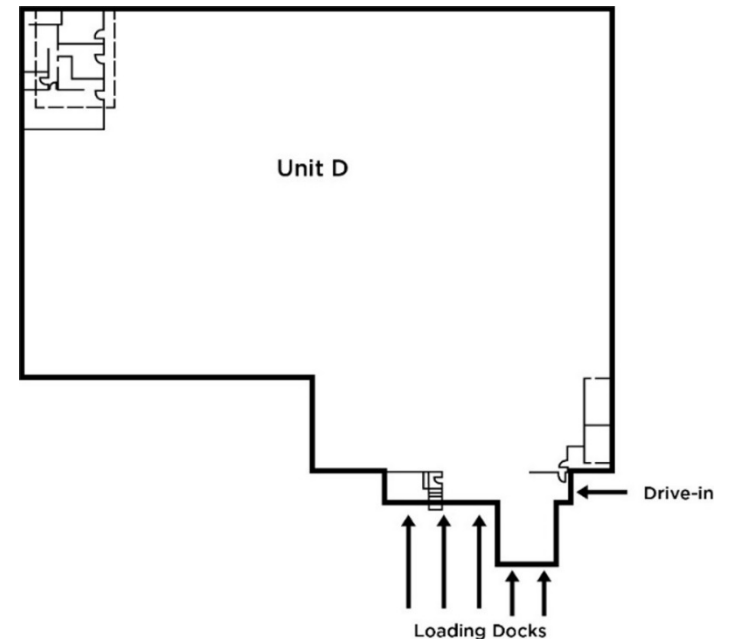

LOCATION MAP

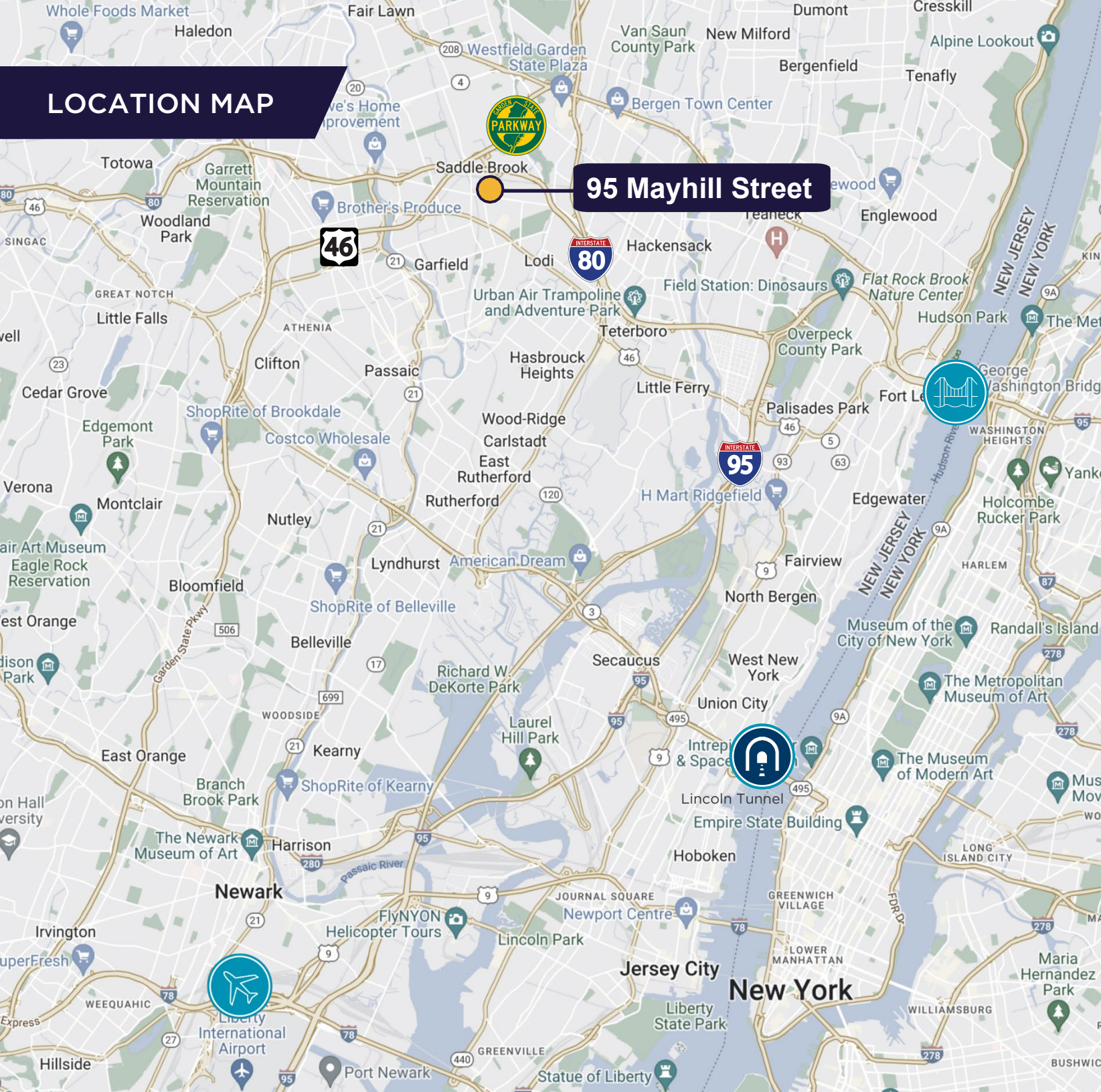

For more information,
please contact:

TORSTEN THALER

+1 732 243 3060
torsten.thaler@cushwake.com

THOMAS D. TUCCI, SIOR

+1 732 243 3120
thomas.tucci@cushwake.com

JONATHAN (JACK) WINGE

+1 732 243 3114
jack.winge@cushwake.com

One Meadowlands Plaza, 7th Floor
East Rutherford, NJ 07073
+1 201 935 4000 |
99 Wood Avenue South, 8th Floor
Iselin, NJ 08830-2734
+1 732 623 4700

cushmanwakefield.com



©2025 Cushman & Wakefield. All rights reserved.
The information contained in this communication is strictly confidential. This information has been obtained from sources believed to be reliable but has not been verified. NO WARRANTY OR REPRESENTATION, EXPRESS OR IMPLIED, IS MADE AS TO THE CONDITION OF THE PROPERTY (OR PROPERTIES) REFERENCED HEREIN OR AS TO THE ACCURACY OR COMPLETENESS OF THE INFORMATION CONTAINED HEREIN, AND SAME IS SUBMITTED SUBJECT TO ERRORS, OMISSIONS, CHANGE OF PRICE, RENTAL OR OTHER CONDITIONS, WITHDRAWAL WITHOUT NOTICE, AND TO ANY SPECIAL LISTING CONDITIONS IMPOSED BY THE PROPERTY OWNER(S). ANY PROJECTIONS, OPINIONS OR ESTIMATES ARE SUBJECT TO UNCERTAINTY AND DO NOT SIGNIFY CURRENT OR FUTURE PROPERTY PERFORMANCE.