



25,232 SF FREESTANDING INDUSTRIAL BUILDING

AVAILABLE FOR SALE OR LEASE

1346 S 28TH STREET, SAN DIEGO, CALIFORNIA 92113

BRANT ABERG, SIOR
858.546.5464
brant.aberg@cushwake.com
CA Lic. 01773573

TRENT SMITH
619.988.5340
trent.smith@cushwake.com
CA Lic. 02189114



Cushman & Wakefield
12830 El Camino Real, Suite 100
San Diego, CA 92130
www.cushmanwakefield.com

**1346 S 28TH STREET
SAN DIEGO, CA 92113**

PROPERTY OVERVIEW

- 25,232 SF freestanding industrial building available for lease
- Dock & grade level loading doors
- $\pm 18'$ warehouse clearance
- 1,200 amps, 120/240v 3-phase
- Fully sprinklered
- Secured yard
- Available Now
- Lease Rate: \$1.50 PSF Gross
- Sale Price: Call Broker

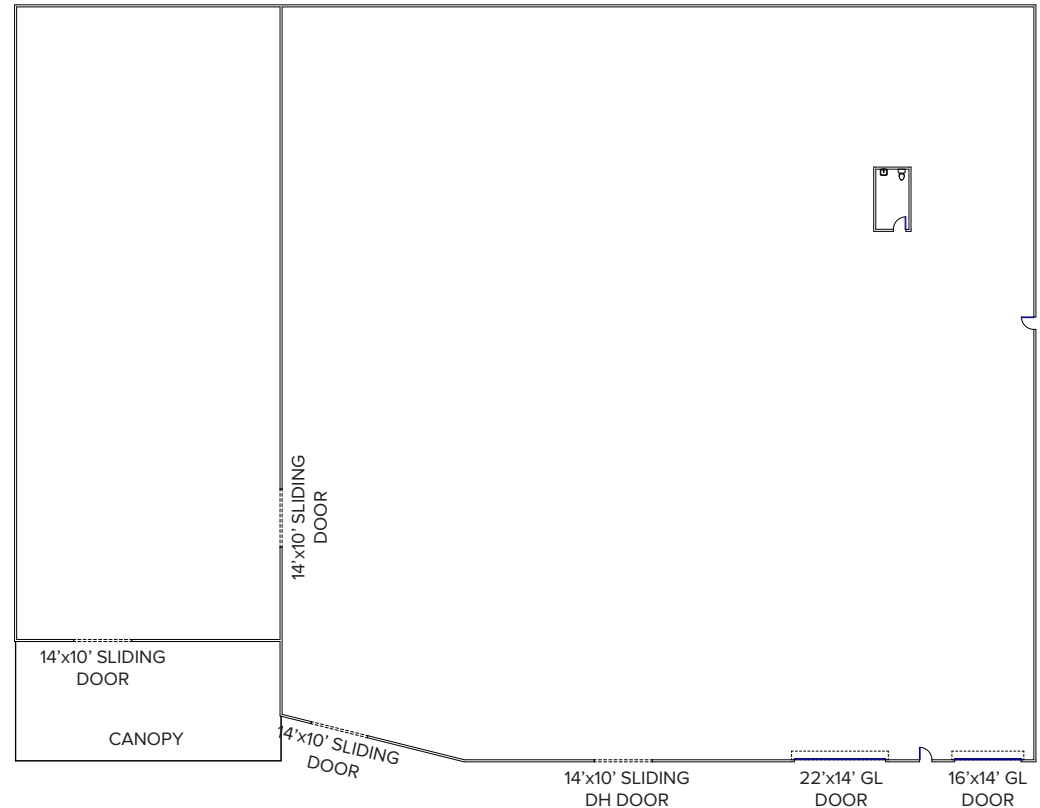

©CUSHMAN & WAKEFIELD. ALL RIGHTS RESERVED. THIS INFORMATION HAS BEEN OBTAINED FROM SOURCES BELIEVED TO BE RELIABLE BUT HAS NOT BEEN VERIFIED. NO WARRANTY OR REPRESENTATION, EXPRESS OR IMPLIED, IS MADE AS TO THE CONDITION OF THE PROPERTY (OR PROPERTIES) REFERENCED HEREIN OR AS TO THE ACCURACY OR COMPLETENESS OF THE INFORMATION CONTAINED HEREIN, AND SAME IS SUBMITTED SUBJECT TO ERRORS, OMISSIONS, CHANGE OF PRICE, RENTAL OR OTHER CONDITIONS, WITHDRAWAL WITHOUT NOTICE, AND TO ANY SPECIAL LISTING CONDITIONS IMPOSED BY THE PROPERTY OWNER(S).

BRANT ABERG, SIOR
858.546.5464

brant.aberg@cushwake.com

CA Lic. 01773573

TRENT SMITH
619.988.5340

trent.smith@cushwake.com

CA Lic. 02189114



Cushman & Wakefield
12830 El Camino Real, Suite 100
San Diego, CA 92130
www.cushmanwakefield.com