

RARE ±12,000 SF STANDALONE LIGHT INDUSTRIAL BUILDING



AVAILABLE FOR OCCUPANCY NOW

2245 VIA DE MERCADOS
CONCORD, CA



NEWLY REFURBISHED STAND-ALONE LIGHT INDUSTRIAL/SERVICE COMMERCIAL BUILDING IN CENTRAL CONCORD

SITE

- » Approximately ±.5 Acres (±21,780 SF)
- » Dimensions: ±135' W x ±160' D
- » APN: 126-010-063
- » Located in Central Concord close to amenities
- » Service Commercial Zoning

BUILDING

- » Available: ±12,000 SF
- » Dimensions: ±100' D x ±120' W
- » Construction: Concrete tilt-up
- » Parking: ±1/1,000 (additional on street parking)
- » Column Spacing: ±50' D x ±20' W
- » Power: TBD
- » Loading: Four (4) Grade Level Doors
 - Two (2) 12' x 12': One (1) oversized 16' x 14', One (1) 12' x 14'
 - Conversion possible to add one (1) additional loading door (front)
- » Clear Height: ±16'
- » Sprinklered: .18/3,000 GPM

OFFICE / SHOWROOM

- » ±3,000 SF

WAREHOUSE

- » ±9,000 SF
- » ±750 SF Mezzanine
- » Compressed Air Lines
- » Natural gas with three (3) warehouse heaters
- » Insulated

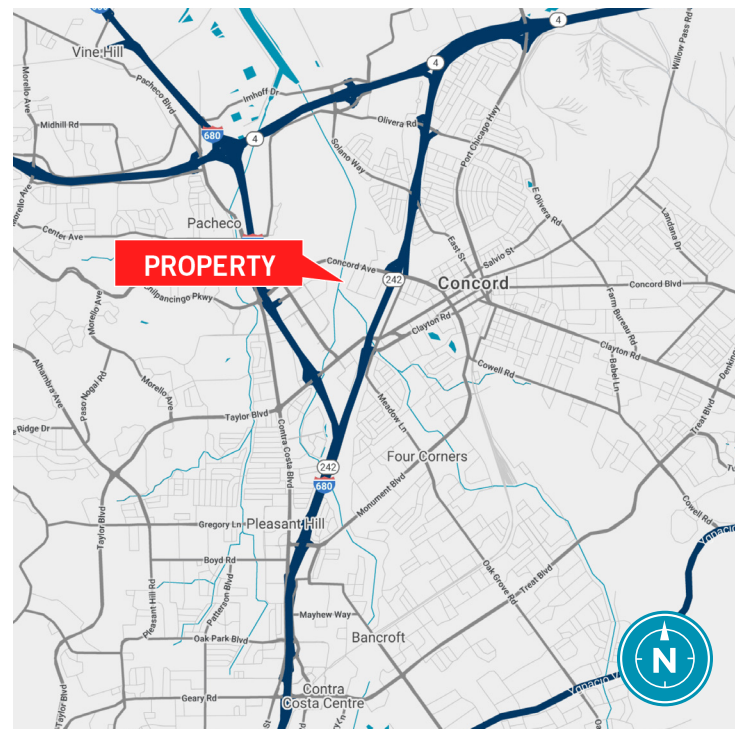

[View Site Specific COVID-19 Prevention Plan](#)

Tony Binswanger, SIOR
Executive Director
+1 925 627 2482
tony.binswanger@cushwake.com
LIC#01861701

Bo Harkins
Director
+1 925 627 2481
bo.harkins@cushwake.com
LIC#01943785

Brooks Pedder, SIOR
Executive Managing Director
+1 925 627 2480
brooks.pedder@cushwake.com
LIC#00902154



FLOOR PLAN

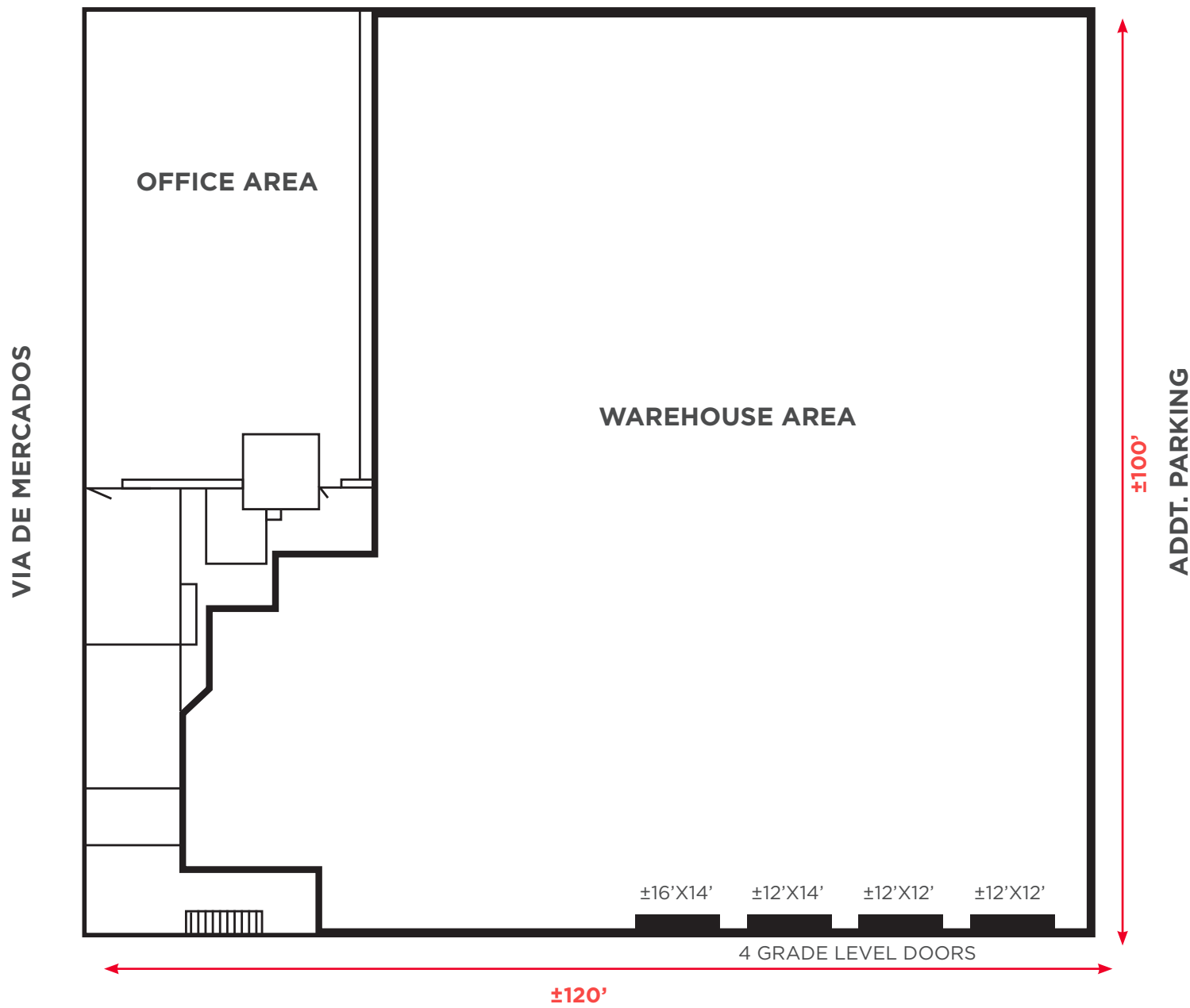

©2022 Cushman & Wakefield. All rights reserved. The information contained in this communication is strictly confidential. This information has been obtained from sources believed to be reliable but has not been verified. NO WARRANTY OR REPRESENTATION, EXPRESS OR IMPLIED, IS MADE AS TO THE CONDITION OF THE PROPERTY (OR PROPERTIES) REFERENCED HEREIN OR AS TO THE ACCURACY OR COMPLETENESS OF THE INFORMATION CONTAINED HEREIN, AND SAME IS SUBMITTED SUBJECT TO ERRORS, OMISSIONS, CHANGE OF PRICE, RENTAL OR OTHER CONDITIONS, WITHDRAWAL WITHOUT NOTICE, AND TO ANY SPECIAL LISTING CONDITIONS IMPOSED BY THE PROPERTY OWNER(S). ANY PROJECTIONS, OPINIONS OR ESTIMATES ARE SUBJECT TO UNCERTAINTY AND DO NOT SIGNIFY CURRENT OR FUTURE PROPERTY PERFORMANCE.

Tony Binswanger, SIOR
Executive Director
+1 925 627 2482
tony.binswanger@cushwake.com
LIC#01861701

Bo Harkins
Director
+1 925 627 2481
bo.harkins@cushwake.com
LIC#01943785

Brooks Pedder, SIOR
Executive Managing Director
+1 925 627 2480
brooks.pedder@cushwake.com
LIC#00902154



PHOTO GALLERY

