



# FOR LEASE

## 15148-15168 FRASER HIGHWAY

### SURREY, BC

915 SF UP TO 3,916 SF



**Eric Walker**  
 Associate Vice President  
 +1 604 608 5998  
 eric.walker@ca.cushwake.com

700 West Georgia Street, Suite 1200  
 Pacific Centre, PO Box 10023  
 Vancouver, BC V7Y 1A1  
 +1 604 683 3111  
[cushmanwakefield.ca](http://cushmanwakefield.ca)

©2025 Cushman & Wakefield ULC. All rights reserved. The information contained in this communication is strictly confidential. This information has been obtained from sources believed to be reliable but has not been verified. NO WARRANTY OR REPRESENTATION, EXPRESS OR IMPLIED, IS MADE AS TO THE CONDITION OF THE PROPERTY (OR PROPERTIES) REFERENCED HEREIN OR AS TO THE ACCURACY OR COMPLETENESS OF THE INFORMATION CONTAINED HEREIN, AND SAME IS SUBMITTED SUBJECT TO ERRORS, OMISSIONS, CHANGE OF PRICE, RENTAL OR OTHER CONDITIONS, WITHDRAWAL WITHOUT NOTICE, AND TO ANY SPECIAL LISTING CONDITIONS IMPOSED BY THE PROPERTY OWNER(S). ANY PROJECTIONS, OPINIONS OR ESTIMATES ARE SUBJECT TO UNCERTAINTY AND DO NOT SIGNIFY CURRENT OR FUTURE PROPERTY PERFORMANCE.

**AVAILABLE AREAS**

Unit 15160 - 915 SF  
Unit 15164 - 3,001 SF

**TOTAL CONTIGUOUS  
AVAILABLE**

3,916 SF

**RENT**

Starting at \$46.00 net PSF

**ADDITIONAL RENT**

\$20.18 PSF for 2024

**AVAILABLE**

Upon Tenant signing Lease and providing evidence of Insurance

**PARKING**

Onsite, free parking for 53 vehicles  
(16 stalls in front; 37 stalls at rear)

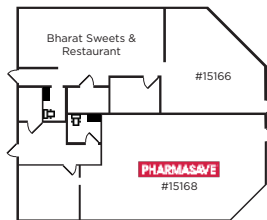
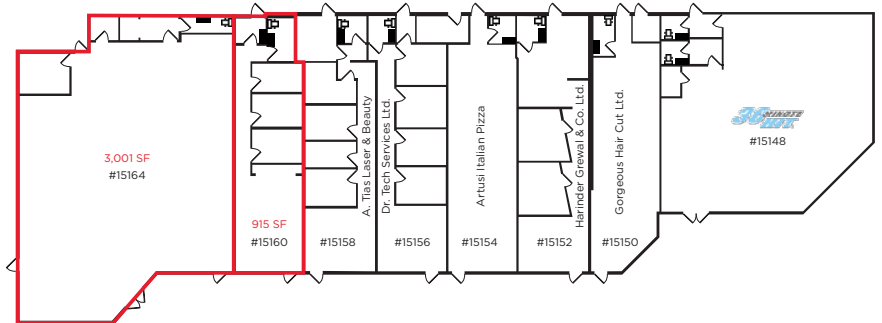

**EXCELLENT EXPOSURE**



152<sup>ND</sup> STREET SOUTH  
OF FRASER HIGHWAY  
**39,900** VEHICLES DAILY

**WITHIN 1 KILOMETER**



<b>302</b>	Businesses
<b>2,719</b>	Daytime Working Population
<b>12,973</b>	Total Population
<b>4.3%</b>	Projected Growth (2021 - 2026)
<b>3,817</b>	Households
<b>3.8%</b>	Projected Growth (2022 - 2027)
Ages:	
<b>21.4%</b>	< 19
<b>62.3%</b>	20 - 64
<b>16.1%</b>	> 65
<b>39.2</b>	Median Age
<b>\$115,656</b>	Average Household Income



**Eric Walker**  
Associate Vice President  
+1 604 608 5998  
eric.walker@ca.cushwake.com

700 West Georgia Street, Suite 1200  
Pacific Centre, PO Box 10023  
Vancouver, BC V7Y 1A1  
+1 604 683 3111  
[cushmanwakefield.ca](http://cushmanwakefield.ca)