



## ±5,000 SF - ±13,200 SF Industrial Space with Fenced Yard

### Edward Business Park

3393 & 3395 Edward Ave., Santa Clara, CA

### Property Highlights

- Two (2) Industrial Units Totaling ±13,200 SF
- Divisible to ±5,000 SF and ±8,200 SF

#### 3393 Edward:

- ±5,000 SF
- ±27% Office Area, Includes ±288 SF Inspection Room/Former Cleanroom
- 2 Grade Level Doors
- 200 Amps @ 120/240 Volt
- ±16' Clear Height
- 2/1000 Parking

#### 3395 Edward:

- ±8,200 SF
- ±8% Office Area
- 2 Grade Level Doors
- 600 Amps @ 120/240 Volt
- ±16' Clear Height
- ±7,000 SF Fenced Yard Area
- 2/1000 Parking

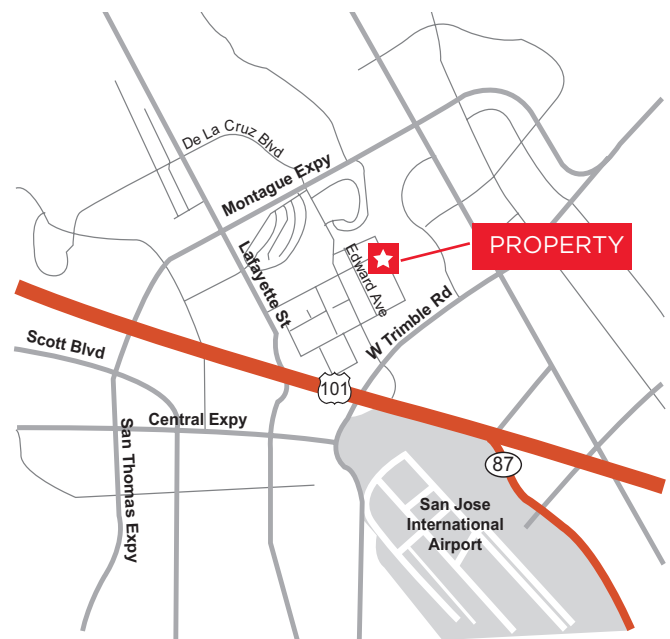

**Tom Snider**  
**Executive Managing Director**  
 +1 408 436 3639  
 tom.snider@cushwake.com  
 LIC #00847073

300 Santana Row, Fifth Floor  
 San Jose, California  
 P +1 408 615 3400

**cushmanwakefield.com**

## Floor Plan

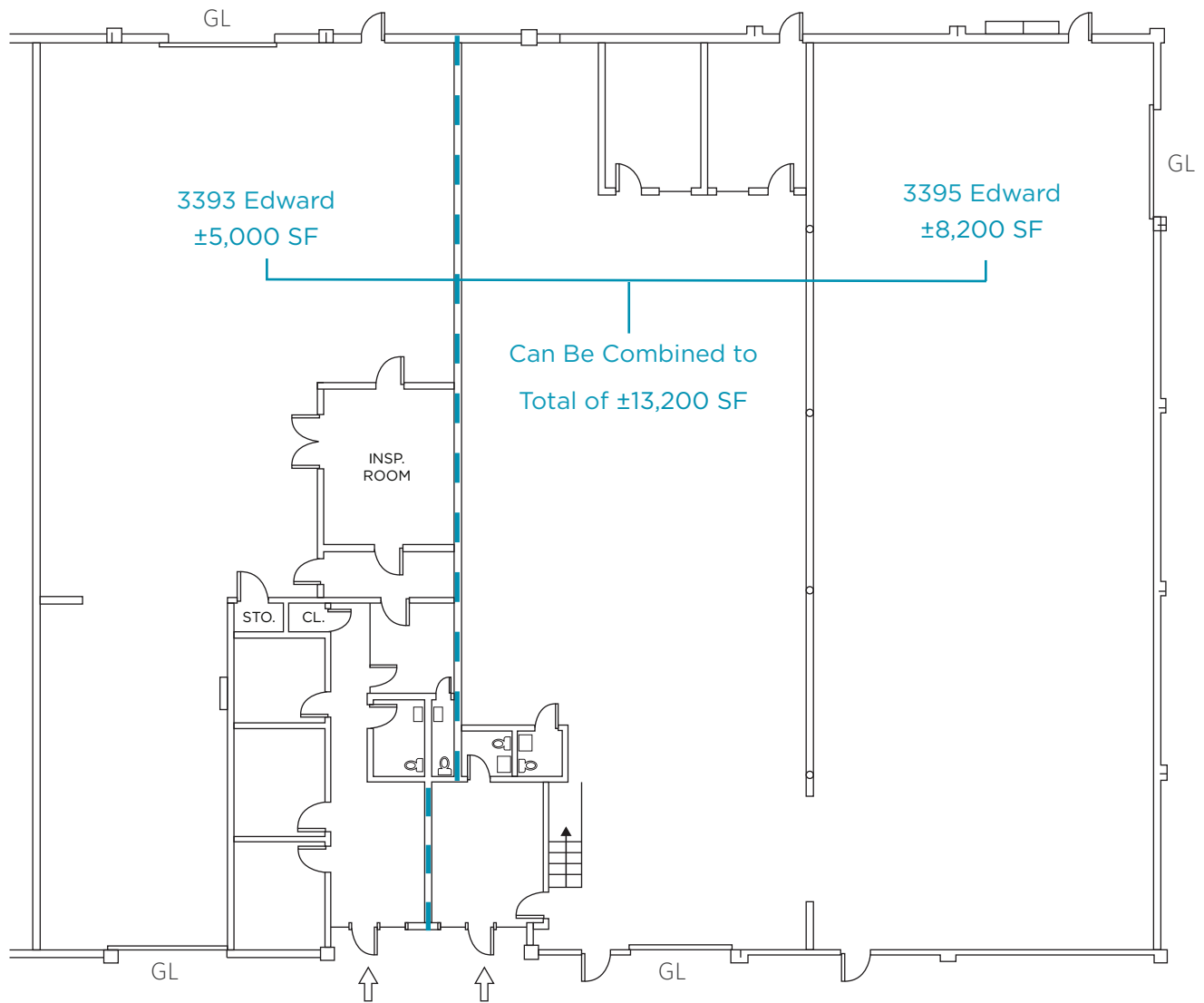

— — Demising Wall

NOT TO SCALE

**Tom Snider**  
**Executive Managing Director**  
+1 408 436 3639  
tom.snider@cushwake.com  
LIC #00847073

300 Santana Row, Fifth Floor  
San Jose, California  
P +1 408 615 3400

**cushmanwakefield.com**