

# 101 GLACIER POINT ROAD, SAN RAFAEL CA

±5,763 SF 2ND FLOOR OFFICE AVAILABLE

**PRICE REDUCTION**



## STEVEN LEONARD

Managing Director  
415-722-1080  
steven.leonard@cushwake.com  
LIC #00909604

## BRIAN FOSTER

Executive Director  
415-297-6817  
brian.foster@cushwake.com  
LIC #01393059







101 Glacier Point Road is San Rafael's best in class office & warehouse building situated in East San Rafael with immediate access to Interstate 580, US 101 and the Richmond San Rafael Bridge. 101 Glacier is located on the San Francisco Bay with unparalleled views contiguous to the Bay Trail which connects to downtown San Rafael. 3 miles to Larkspur Landing & Ferry access to San Francisco. 2.5 miles to downtown San Rafael.

Constructed in 1999, it is located in Central San Rafael providing easy access from Richmond and the greater East Bay over the San Rafael Bridge and 580/80, centrally located in Marin County and minutes away from Larkspur Landing and downtown San Rafael each providing excellent access to services, food and transportation options.



**SUITE 5:** ±5,763 SF 2nd floor office with floor to ceiling glass and Bay views

**RENT:** \$1.25 PSF NNN (NNNs = \$0.40 PSF approx.)

**CONSTRUCTION:** Concrete Tilt up

**YEAR BUILT:** 1999

**FIRE PROTECTION:** Fully Sprinklered

**ELEVATOR:** Serving 2nd floor office off the main building lobby

**APN:** 009-291-23

**ZONING:** PD (Planned Development) and the Land Use code is Light Industry/Office. LI/O land use allows for “motor vehicle service, contractor uses and yards, light manufacturing, distribution, warehousing and storage, incidental employee serving retail/service, and office use.

**PARKING:** 121 Surface spaces



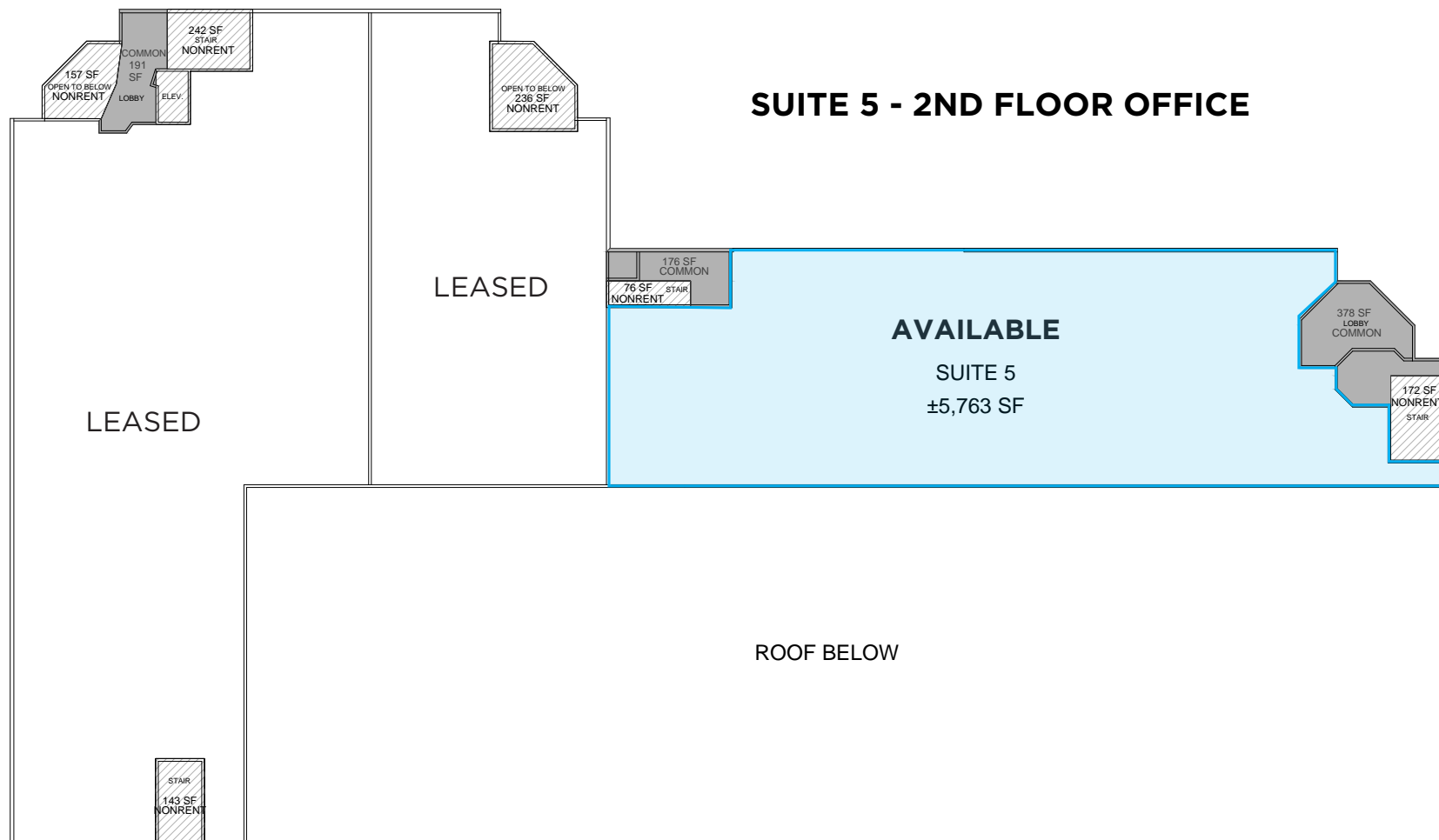



## SUITE 5:

±5,763 SF Office Space



Floor to ceiling glass line



Unobstructed Bay views



Kitchen



Private restrooms



2nd floor office



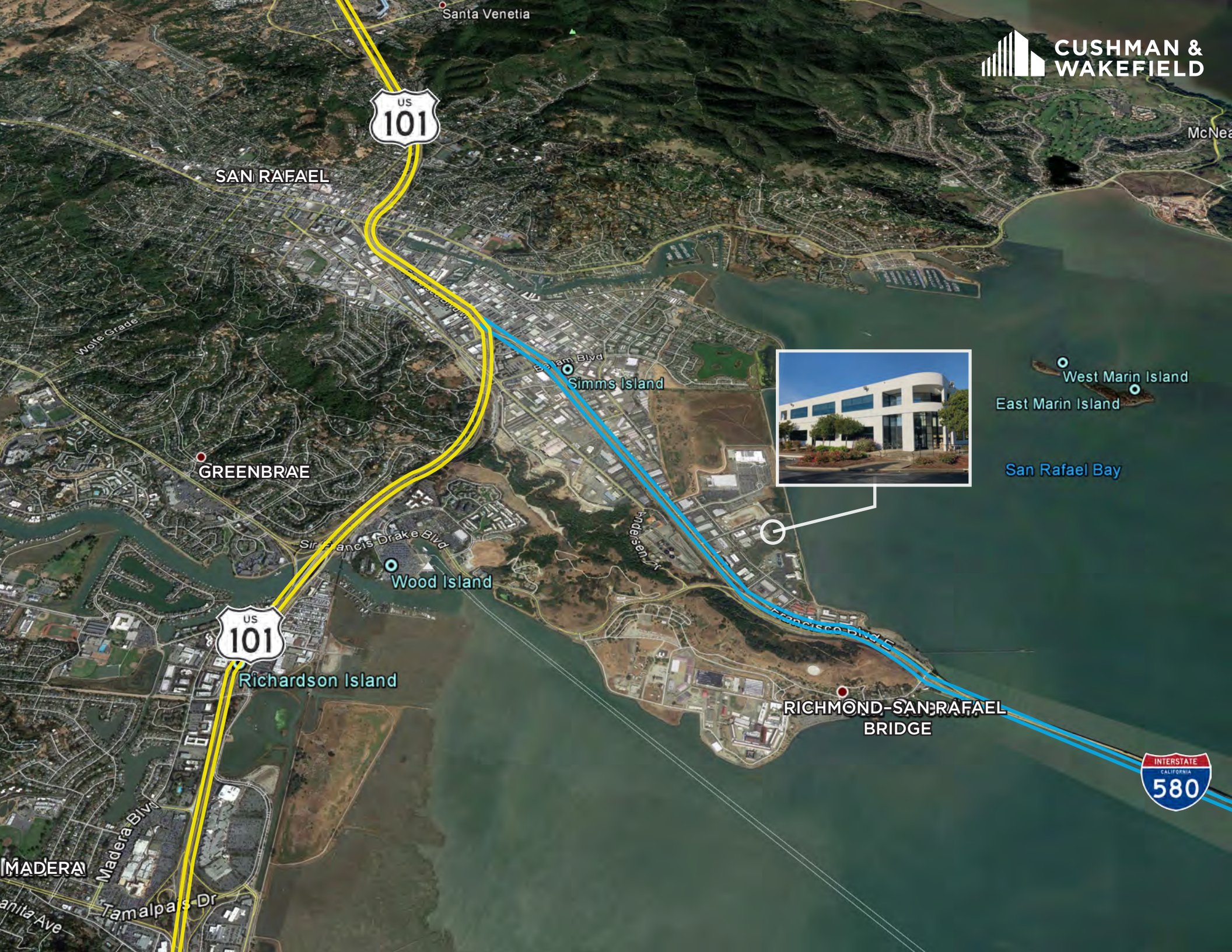

Santa Venetia

SAN RAFAEL



GREENBRAE



Richardson Island

MADERA

Sanita Ave

Madera Blvd

Tamalpais Dr

Epam Blvd

Simms Island

San Francisco Drake Blvd

Wood Island

RICHMOND-SAN RAFAEL  
BRIDGE



West Marin Island  
East Marin Island

San Rafael Bay



**STEVEN LEONARD**

Managing Director

415-722-1080

[steven.leonard@cushwake.com](mailto:steven.leonard@cushwake.com)

LIC #00909604

**BRIAN FOSTER**

Executive Director

415-297-6817

[brian.foster@cushwake.com](mailto:brian.foster@cushwake.com)

LIC #01393059

©2025 Cushman & Wakefield. All rights reserved. The information contained in this communication is strictly confidential. This information has been obtained from sources believed to be reliable but has not been verified. NO WARRANTY OR REPRESENTATION, EXPRESS OR IMPLIED, IS MADE AS TO THE CONDITION OF THE PROPERTY (OR PROPERTIES) REFERENCED HEREIN OR AS TO THE ACCURACY OR COMPLETENESS OF THE INFORMATION CONTAINED HEREIN, AND SAME IS SUBMITTED SUBJECT TO ERRORS, OMISSIONS, CHANGE OF PRICE, RENTAL OR OTHER CONDITIONS, WITHDRAWAL WITHOUT NOTICE, AND TO ANY SPECIAL LISTING CONDITIONS IMPOSED BY THE PROPERTY OWNER(S). ANY PROJECTIONS, OPINIONS OR ESTIMATES ARE SUBJECT TO UNCERTAINTY AND DO NOT SIGNIFY CURRENT OR FUTURE PROPERTY PERFORMANCE.