

FOR LEASE

Owned and Operated by 

AIRPARK EAST BUSINESS PARK

408, 410 & 412 Gallimore Dairy Road
Greensboro, NC 27410

+/- 8,000 - 40,000 SF



LEASING INFO & CONTACT

Ryan Conboy, SIOR
Bobby Finch

(336) 821-3832 / ryan.conboy@cushwake.com
(336) 812-3303 / bobby.finch@cushwake.com



This is not an offer or acceptance of an offer to lease space. A lease will only be offered or made in a written agreement signed by landlord. No representation or warranty of any kind is made by landlord unless set forth in a written definitive lease executed by the landlord.

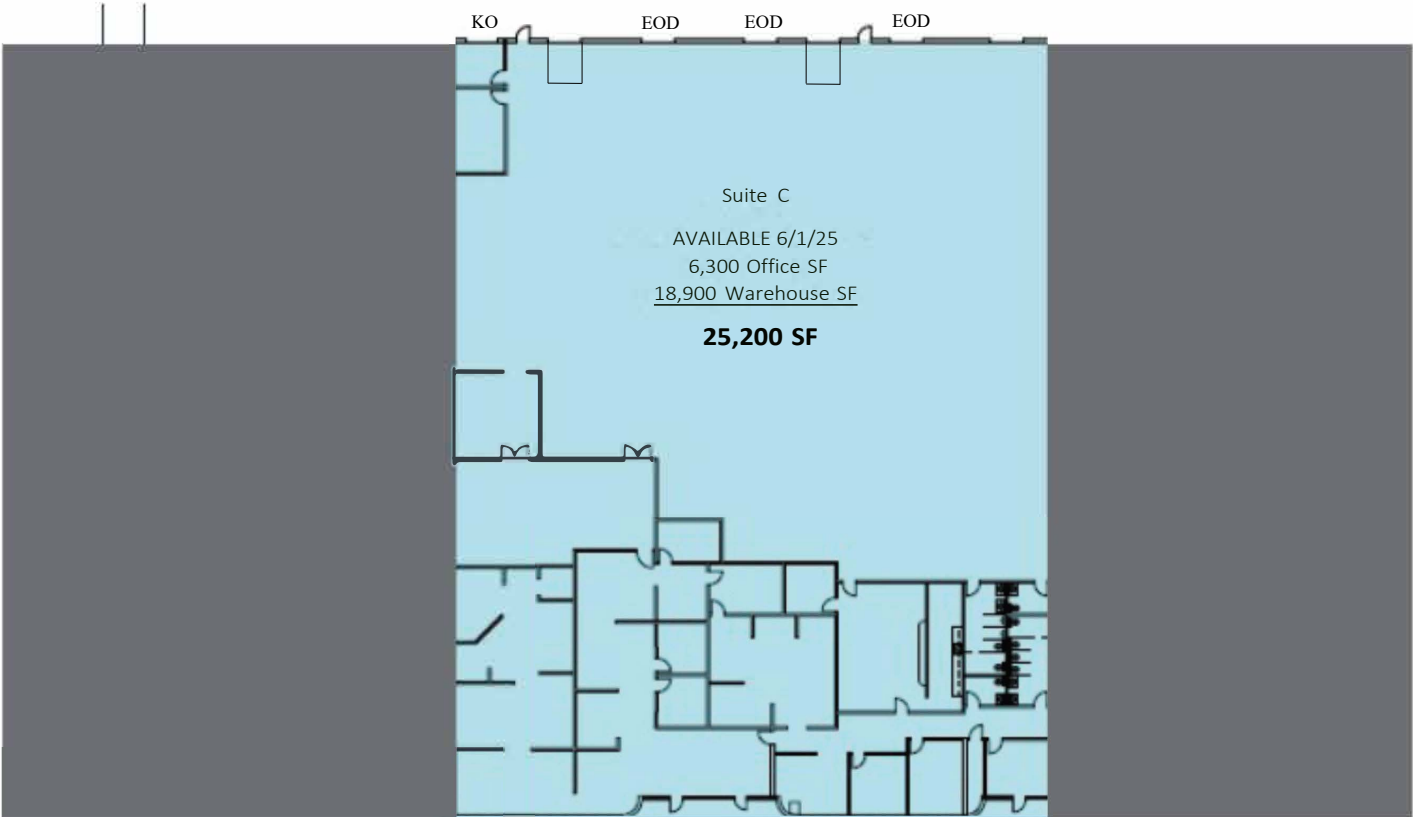

408 Gallimore Dairy Road, Suite C

Available: 6/1/25	Dock Doors: Six (6) 8' x 10'
Size: 25,200 SF (6,300 SF Office)	Two (2) W/Pit Leveler, Three (3) W/Edge Of Dock
Clear Height: 21'	One (1) Knock-Out Panel
Column Spacing: 40' x 50'	Sprinkler: Wet System
Lighting: LED (To Be Updated)	

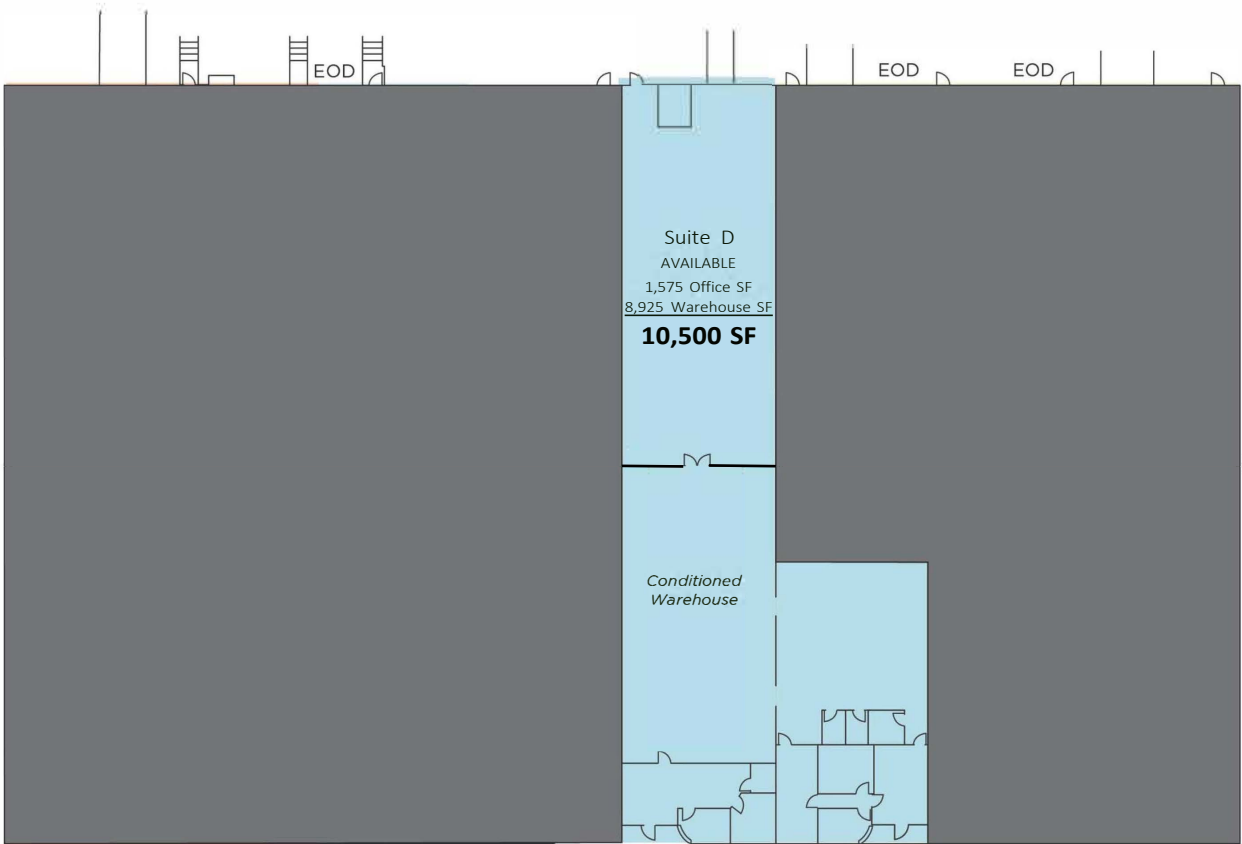

410 Gallimore Dairy Road, Suite D

Size: 10,500 SF (1,575 SF Office)
Fully Conditioned
Clear Height: 21'
Column Spacing: 40' x 50'

Dock Doors: One (1) 8' x 10' w/ Pit Leveler
Drive-up Ramp: One (1) 10' x 10'
Lighting: LED (Update in Progress)
Sprinkler: Wet System

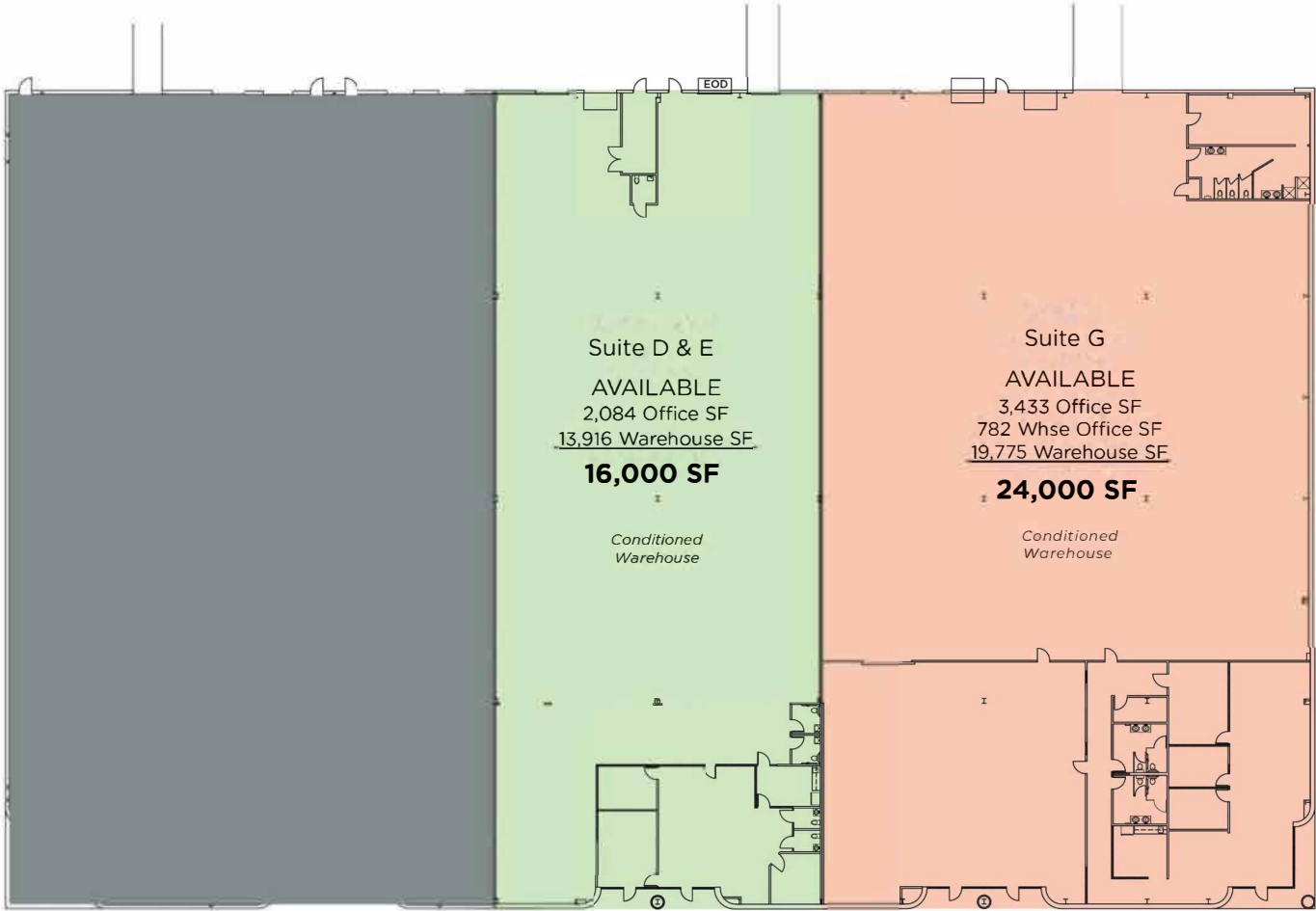

412 Gallimore Dairy Road

Suite D & E

Size: 16,000 SF (2,084 SF Office)

Fully Conditioned

Clear Height: 21'

Column Spacing: 40' x 50'

Dock Doors: Three (3) 8' x 10' -

One w/ Pit Leveler and One w/ EOD Leveler

Drive-Up Ramp: One (1) 10' x 10'

Lighting: LED (Update in Progress)

Sprinkler: Wet System

Suite G

Size: 24,000 SF (3,433 SF Office)

Fully Conditioned

Clear Height: 21'

Column Spacing: 40' x 50'

Dock Doors: Three (3) 8' x 10' -One w/ Pit Leveler

Drive-up Ramp: One (1) 10' x 10'

Lighting: LED (Update in Progress)

Sprinkler: Wet System



