



FOR LEASE

BRAND NEW INDUSTRIAL/OFFICE SPACE AVAILABLE IMMEDIATELY

Key Features

- Functional ceiling heights to accommodate future racking requirements
- Fully finished accessible washroom on the ground floor
- Individual signage opportunities
- Common amenities including a rooftop amenity area overlooking the waterfront and YVR, end of trip facilities including washrooms and shower rooms, common garbage rooms, and bike storage rooms
- A freight lift has been installed to enhance accessibility to the second floor. The upstairs tenant will be granted access to the lift, allowing for safe and efficient movement to the second floor for when stairs would otherwise pose a challenge

Contact Listing Agent for Rates & Additional Rent

Available Unit

Second Floor

Unit 204

1,685 SF

Clear Height

±17' clear

Parking

One (1) reserved parking stall

NORTH BUILDING - LEVEL 1

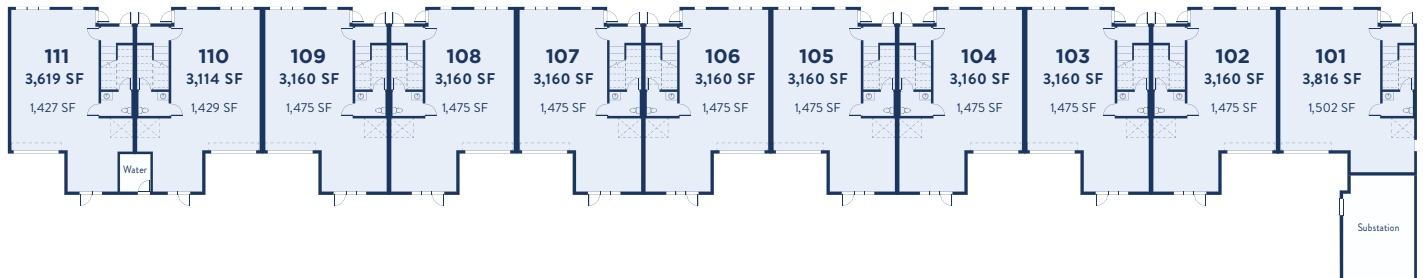

NORTH BUILDING - LEVEL 2

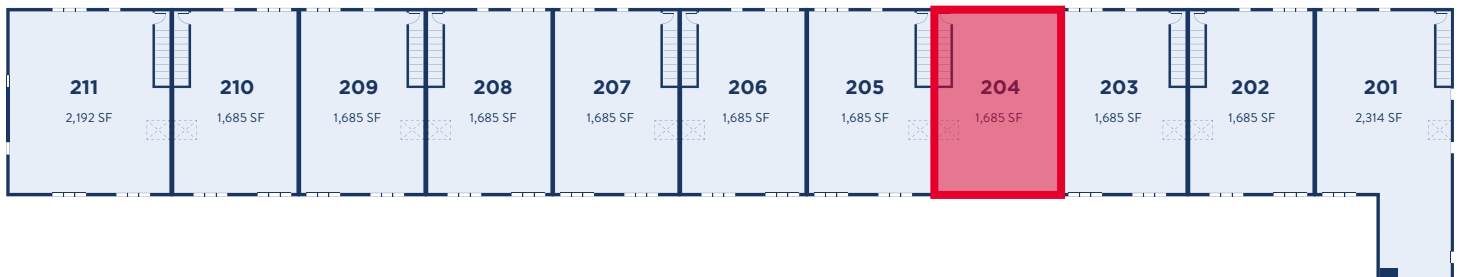

**UNIT 104
2ND FLOOR**

FOR MORE INFORMATION, PLEASE CONTACT:

JORDAN SENGARA

Personal Real Estate Corporation
Vice President, Industrial
+1 604 640 5845
jordan.sengara@cushwake.com

BRANDO RILEY

Associate, Industrial
+1 778 855 7550
brando.riley@cushwake.com

700 West Georgia Street
Suite 1200, Toronto Dominion Tower
Pacific Centre Vancouver, BC
cushmanwakefield.com