

FOR SUBLEASE • SUITE 102 • AVAILABLE NOW • FULLY FURNISHED



11246

GOLD EXPRESS DRIVE



GOLD RIVER, CALIFORNIA

KRIS KALMBACH • *Managing Director*  
+1 916 288 4421 • [kris.kalmbach@cushwake.com](mailto:kris.kalmbach@cushwake.com) • Lic #01436668

## PROPERTY HIGHLIGHTS:

- 2,902 SF Available for Sublease
- Available Immediately
- Fully Furnished
- Expansive Window line facing Gold Express Drive
- Prominent Monument Signage Available
- Walking distance to numerous high end retail amenities & fitness opportunities

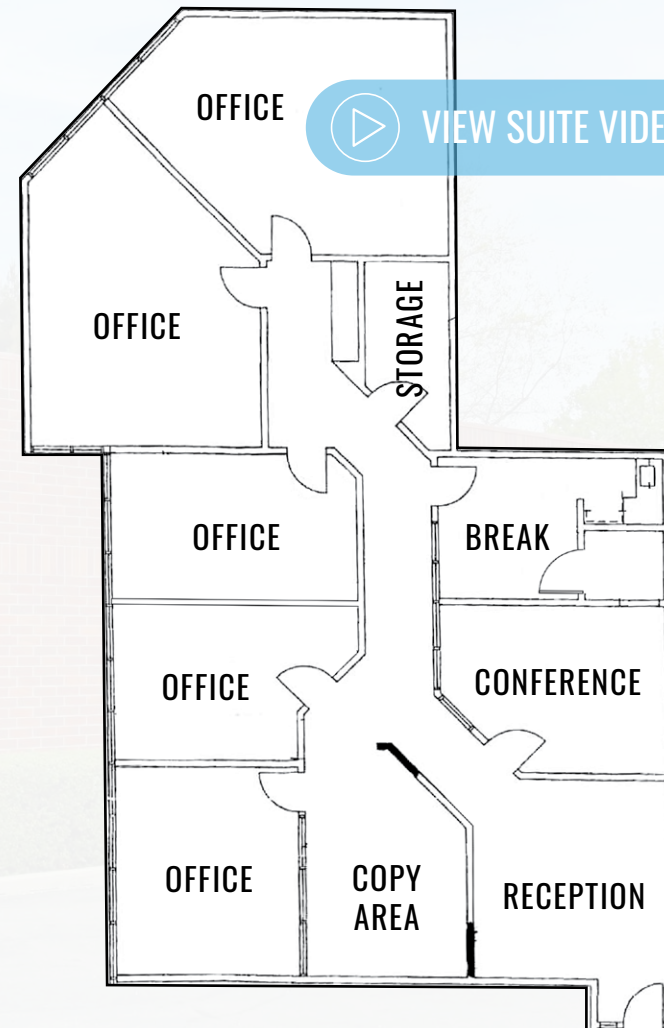

**GOLD RIVER, CALIFORNIA**



©2023 Cushman & Wakefield. All rights reserved. The information contained in this communication is strictly confidential. This information has been obtained from sources believed to be reliable but has not been verified. NO WARRANTY OR REPRESENTATION, EXPRESS OR IMPLIED, IS MADE AS TO THE CONDITION OF THE PROPERTY (OR PROPERTIES) REFERENCED HEREIN OR AS TO THE ACCURACY OR COMPLETENESS OF THE INFORMATION CONTAINED HEREIN, AND SAME IS SUBMITTED SUBJECT TO ERRORS, OMISSIONS, CHANGE OF PRICE, RENTAL OR OTHER CONDITIONS, WITHDRAWAL WITHOUT NOTICE, AND TO ANY SPECIAL LISTING CONDITIONS IMPOSED BY THE PROPERTY OWNER(S). ANY PROJECTIONS, OPINIONS OR ESTIMATES ARE SUBJECT TO UNCERTAINTY AND DO NOT SIGNIFY CURRENT OR FUTURE PROPERTY PERFORMANCE.