

610 CORONATION DRIVE, Toronto, ON

71,960 SF FOR SALE/LEASE
BRAND NEW INDUSTRIAL FACILITY



**CUSHMAN &
WAKEFIELD**



**STERLING
GROUP**

SUMMER 2025 OCCUPANCY

PETER SCHMIDT* B.A.A., SIOR
Executive Vice President
416 543 8083
peter.schmidt@cushwake.com

DANIEL HUBERT*
Executive Vice President
416 859 4879
daniel.hubert@cushwake.com

JAMES MILDON*
Vice President
416 908 4118
james.mildon@cushwake.com

D'ARCY BAK*
Associate Vice President
416 570 5447
darcy.bak@cushwake.com

An aerial photograph of a large, rectangular industrial building under construction. The building has a flat, light-colored roof and blue-grey exterior walls. It is surrounded by a parking lot with several cars and trucks, and some construction equipment. In the background, there are other industrial buildings and a road. The text "ADVANCED BUILD, ADVANCED BUSINESS" is overlaid in white, and "610 CORONATION DRIVE, TORONTO" is overlaid in teal below it.

ADVANCED BUILD, ADVANCED BUSINESS

610 CORONATION DRIVE, TORONTO



**CUSHMAN &
WAKEFIELD**





610

CORONATION DR

Toronto

BUILDING SPECIFICATIONS

BUILDING SIZE	71,960 SF
INDUSTRIAL AREA	67,960 SF
OFFICE AREA	4,000 SF (6%) - Steel Mezzanine - Build to Suit
GROSS LAND AREA	5.49 Acres
NET LAND AREA	3.38 Acres (after conveyance to TRCA)
CLEAR HEIGHT	36' under joist
SHIPPING	12 TL Doors 1 DI Door
VEHICLE PARKING	67 vehicle parking stalls
OCCUPANCY	Summer 2025
ZONING	E 0.7 - Employment
OFFICIAL PLAN	Core Employment Area

610

CORONATION DR

Toronto



BUILDING SPECIFICATIONS

36'

CLEAR HEIGHT

6%

OFFICE AREA
(STEEL MEZZANINE)

38' x 54'

BAY SIZE

60'

STAGING BAY

12 -9'x10'

DOCK DOORS

1 -12'x14'

DRIVE-IN DOORS

DOCK PACKAGE:

LEVELLER TYPE Hydraulic/Blue Giant

LEVELLER CAPACITY 19,000 lbs

BUMPERS & SEALS Yes

BUILDING:

WAREHOUSE FLOOR 6" Slab Steel Fibre

CONCRETE STRENGTH 32 Mpa (4,641 psi)

LIGHTING LED (Warehouse & Office)

WAREHOUSE HEAT Ceiling-Hung Lennox Forced Air CAS Units

POWER 1,500 KVA Transformer
1,200 A / 600V 3 Phase

EXTERIOR:

TRUCK COURT Asphalt with concrete apron

SHIPPING APRON 6" concrete

EMPLOYEE PARKING 60 Stalls

IRRIGATION SYSTEM Automated landscaping
irrigation system included

610

CORONATION DR

Toronto

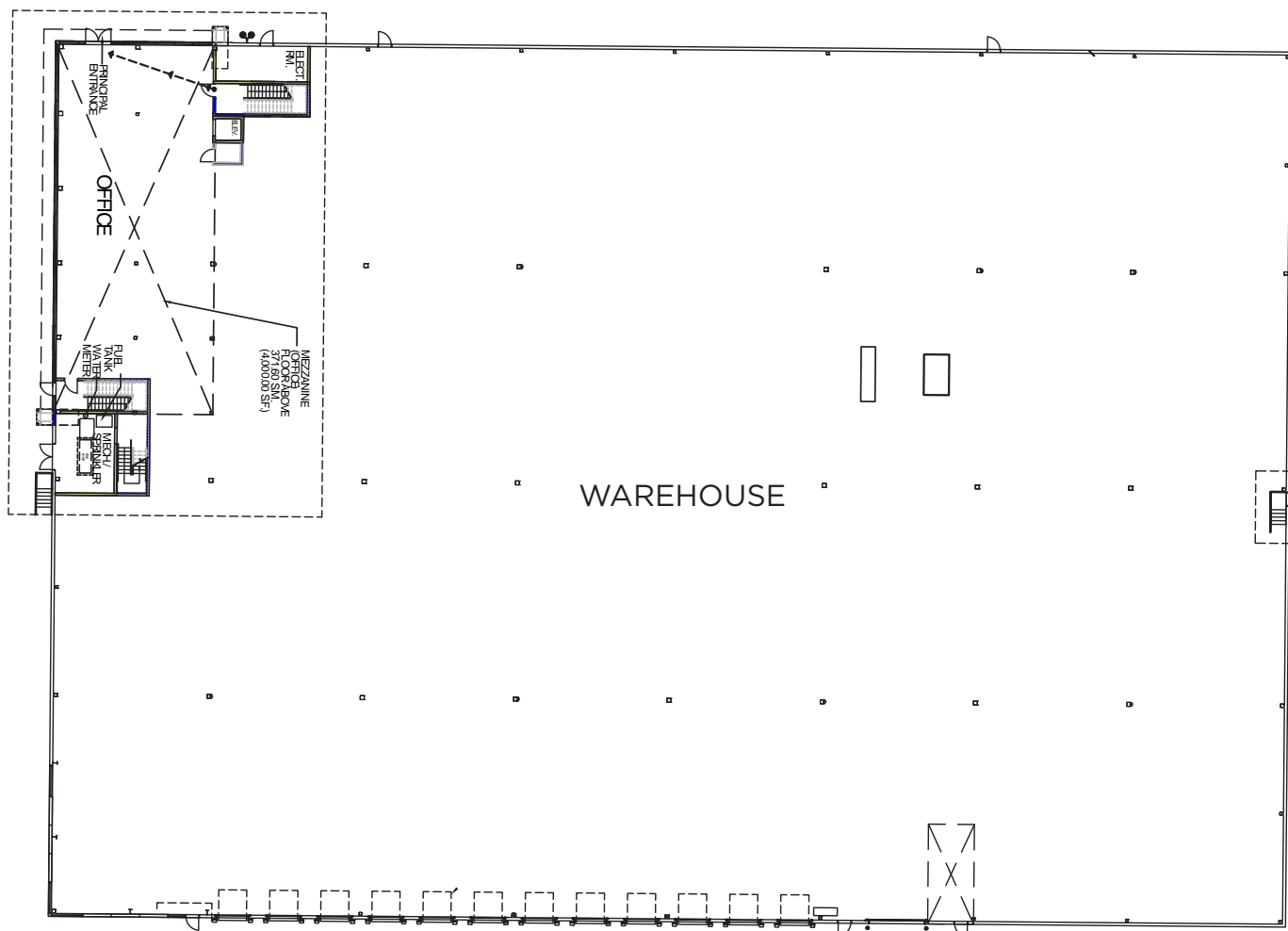

67,960 SF INDUSTRIAL

4,000 SF OFFICE

71,960 SF TOTAL

©2025 Cushman & Wakefield. All rights reserved. The information contained in this communication is strictly confidential. This information has been obtained from sources believed to be reliable but has not been verified. NO WARRANTY OR REPRESENTATION, EXPRESS OR IMPLIED, IS MADE AS TO THE CONDITION OF THE PROPERTY (OR PROPERTIES) REFERENCED HEREIN OR AS TO THE ACCURACY OR COMPLETENESS OF THE INFORMATION CONTAINED HEREIN, AND SAME IS SUBMITTED SUBJECT TO ERRORS, OMISSIONS, CHANGE OF PRICE, RENTAL OR OTHER CONDITIONS, WITHDRAWAL WITHOUT NOTICE, AND TO ANY SPECIAL LISTING CONDITIONS IMPOSED BY THE PROPERTY OWNER(S). ANY PROJECTIONS, OPINIONS OR ESTIMATES ARE SUBJECT TO UNCERTAINTY AND DO NOT SIGNIFY CURRENT OR FUTURE PROPERTY PERFORMANCE.

610

CORONATION DR
Toronto

MAY 2025 GALLERY



610

CORONATION DR
Toronto

MAY 2025 GALLERY



610

CORONATION DR

Toronto



PERMITTED USES

Within the E zone, the following uses are permitted:

- Ambulance Depot
- Animal Shelter
- Artist Studio
- Automated Banking Machine
- Bindery
- Building Supply Yards
- Carpenter's Shop
- Cold Storage
- Contractor's Establishment
- Custom Workshop
- Dry Cleaning or Laundry Plant
- Financial Institution
- Fire Hall
- Industrial Sales and Service Use
- Kennel
- Laboratory
- Office
- Park
- Performing Studio
- Pet Services
- Police Station
- Printing Establishment
- Production Studio
- Public Works Yard
- Service Shop
- Software Development & Processing
- Warehouse
- Wholesaling Use
- All Manufacturing Uses **Except**:
 1. Abattoir, slaughterhouse or animal rendering
 2. Ammunition, Firearms, Fireworks
 3. Asphalt Plant
 4. Cement or Concrete Plant
 5. Crude Petrol Oil or Coal Refinery
 6. Explosives Factory
 7. Industrial Gas Manufacturing
 8. Large Scale Smelting
 9. Primary Processing of Metals
 10. Pesticide/Fertilizer Manufacturing
 11. Petrochemical Manufacturing
 12. Primary Processing of Gypsum
 13. Primary Processing of Limestone
 14. Primary Processing of Oil-Based Paints
 15. Pulp Mill
 16. Resin, Natural or Synthetic Rubber Manufacturing
 17. Tannery

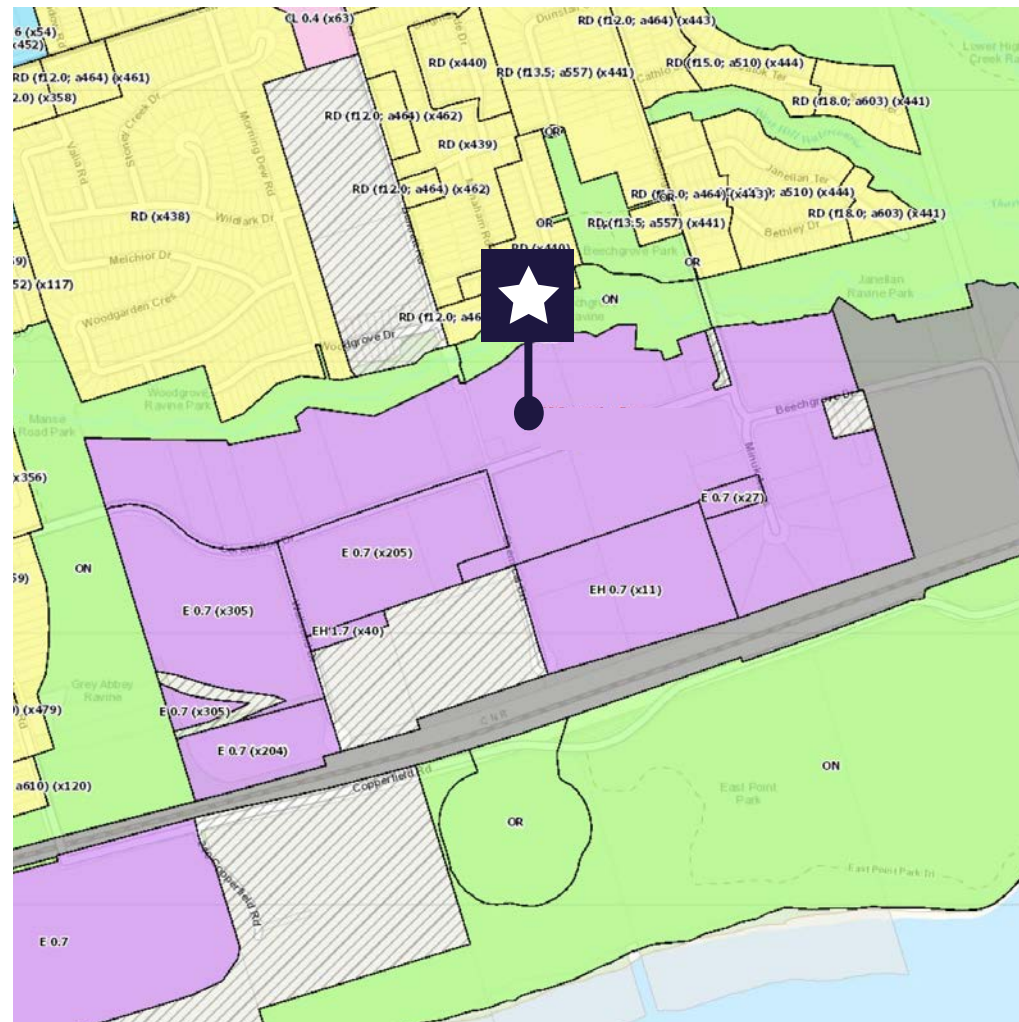

610

CORONATION DR

Toronto



CORPORATE NEIGHBOURS



©2025 Cushman & Wakefield. All rights reserved. The information contained in this communication is strictly confidential. This information has been obtained from sources believed to be reliable but has not been verified. NO WARRANTY OR REPRESENTATION, EXPRESS OR IMPLIED, IS MADE AS TO THE CONDITION OF THE PROPERTY (OR PROPERTIES) REFERENCED HEREIN OR AS TO THE ACCURACY OR COMPLETENESS OF THE INFORMATION CONTAINED HEREIN, AND SAME IS SUBMITTED SUBJECT TO ERRORS, OMISSIONS, CHANGE OF PRICE, RENTAL OR OTHER CONDITIONS, WITHDRAWAL WITHOUT NOTICE, AND TO ANY SPECIAL LISTING CONDITIONS IMPOSED BY THE PROPERTY OWNER(S). ANY PROJECTIONS, OPINIONS OR ESTIMATES ARE SUBJECT TO UNCERTAINTY AND DO NOT SIGNIFY CURRENT OR FUTURE PROPERTY PERFORMANCE.

610

CORONATION DR

Toronto

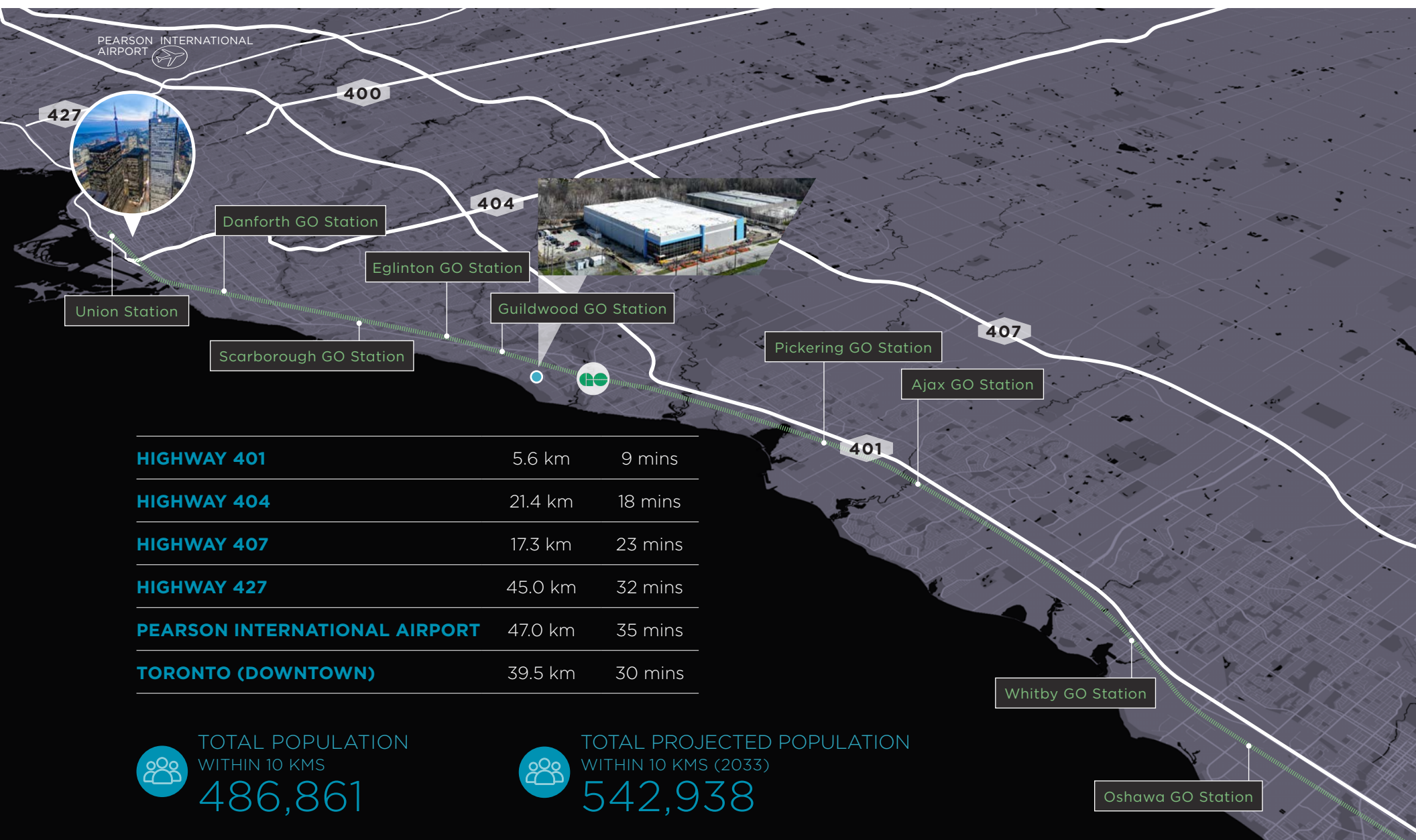

HIGHWAY 401	5.6 km	9 mins
HIGHWAY 404	21.4 km	18 mins
HIGHWAY 407	17.3 km	23 mins
HIGHWAY 427	45.0 km	32 mins
PEARSON INTERNATIONAL AIRPORT	47.0 km	35 mins
TORONTO (DOWNTOWN)	39.5 km	30 mins



TOTAL POPULATION
WITHIN 10 KMS

486,861



TOTAL PROJECTED POPULATION
WITHIN 10 KMS (2033)

542,938

CONTACT



PETER SCHMIDT* B.A.A., SIOR
Executive Vice President
Corporate Real Estate Services, Canada
416 543 8083
peter.schmidt@cushwake.com

DANIEL HUBERT*
Executive Vice President
Corporate Real Estate Services, Canada
416 859 4879
daniel.hubert@cushwake.com

JAMES MILDON*
Vice President
Corporate Real Estate Services, Canada
416 908 4118
james.mildon@cushwake.com

D'ARCY BAK*
Associate Vice President
Corporate Real Estate Services, Canada
416 570 5447
darcy.bak@cushwake.com

Cushman & Wakefield ULC, Brokerage
1 Prologis Boulevard, Suite 300, Mississauga, ON L5W 0G2
cushmanwakefield.com | 905 568 9500

No warranty or representation, expressed or implied, is made as to the accuracy of the information contained herein, and same is submitted subject to errors, omissions, change of price, rental or other conditions, withdrawal without notice, and to any specific listing condition, imposed by our principals.

*Sales Representative

