

1,663 SF OFFICE SUITE FOR LEASE

1951 WILMINGTON DRIVE

FORT COLLINS, CO 80528

LEASE RATE: \$21.50/SF NNN
EST. NNN: \$15.16/SF



CUSHMAN &
WAKEFIELD



1951 WILMINGTON DRIVE



1951 Wilmington Drive offers prime office space for lease in Harmony Village, a well-maintained office park just off Timberline Road. Suite 101 features a reception area, break room, conference room, copy room, three offices, common restrooms, and an IT room. Surrounded by thriving businesses and with easy access to I-25, this location is ideal for businesses seeking a professional and convenient setting. Please contact the listing brokers for additional information.

PROPERTY DETAILS



Available Size:
1,663 SF (Suite 101)



Year Built:
2005



Building Size:
4,224 SF



Zoning:
Harmony Corridor District
- Fort Collins



1951 WILMINGTON DRIVE

FLOOR PLAN

SUITE 101 1,663 SF

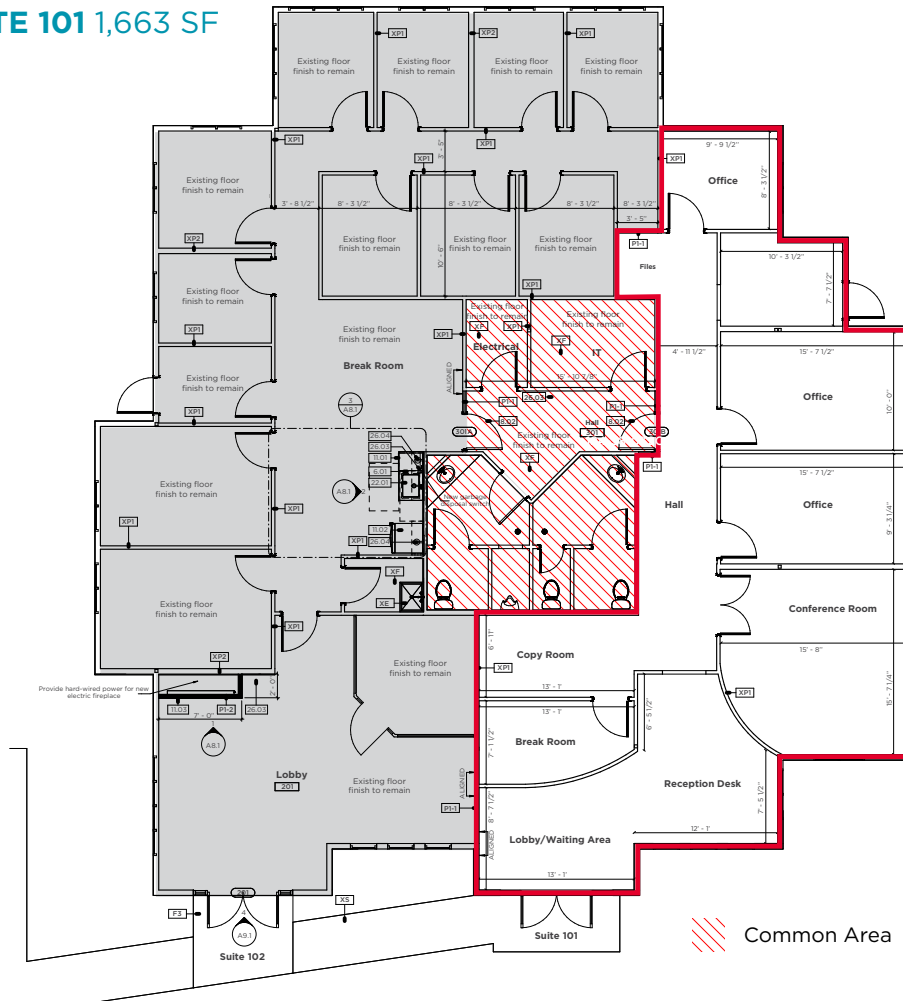

VIEW DETAILED FLOOR PLAN

PROPERTY FEATURES

- Central Heating
- Fully Carpeted
- Kitchen
- Natural Light
- Print/Copy Room
- Reception
- Wheelchair Accessible



1951 WILMINGTON DRIVE



PROPERTY PHOTOS



1951 WILMINGTON DRIVE



AERIAL MAP

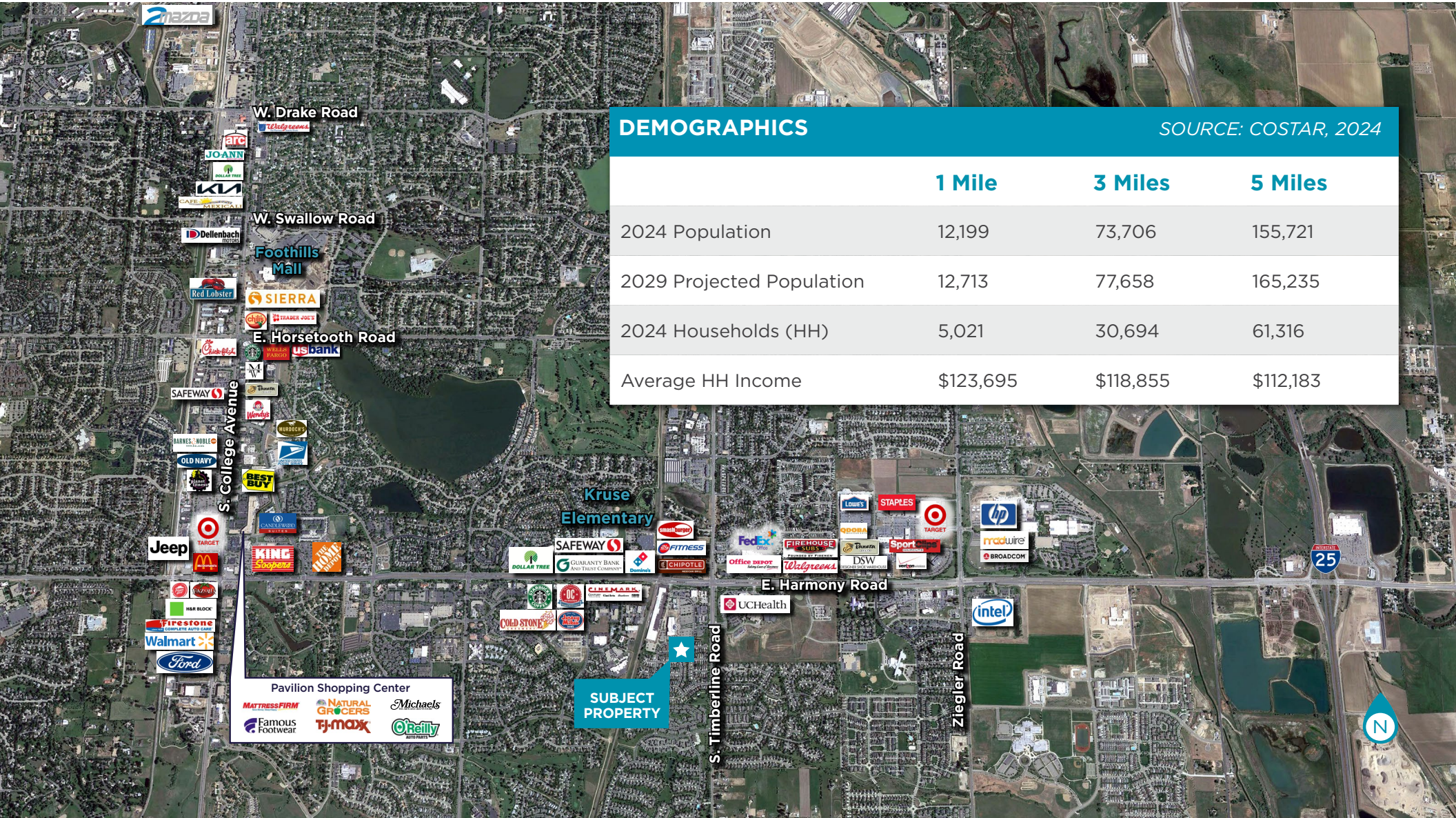

DEMOGRAPHICS

SOURCE: COSTAR, 2024

	1 Mile	3 Miles	5 Miles
2024 Population	12,199	73,706	155,721
2029 Projected Population	12,713	77,658	165,235
2024 Households (HH)	5,021	30,694	61,316
Average HH Income	\$123,695	\$118,855	\$112,183



For more information, please contact:

Travis Ackerman
Executive Managing Director
Cushman & Wakefield
+1 970 267 7720
travis.ackerman@cushwake.com

Mike Campana
Associate Broker
TRX, Inc.
+1 970 690 3391
mdcampana@gmail.com

772 Whalers Way, Suite 200
Fort Collins, Colorado 80525
+1 970 776 3900
cushmanwakefield.com



©2025 Cushman & Wakefield. All rights reserved. The information contained in this communication is strictly confidential. This information has been obtained from sources believed to be reliable but has not been verified. NO WARRANTY OR REPRESENTATION, EXPRESS OR IMPLIED, IS MADE AS TO THE CONDITION OF THE PROPERTY (OR PROPERTIES) REFERENCED HEREIN OR AS TO THE ACCURACY OR COMPLETENESS OF THE INFORMATION CONTAINED HEREIN, AND SAME IS SUBMITTED SUBJECT TO ERRORS, OMISSIONS, CHANGE OF PRICE, RENTAL OR OTHER CONDITIONS, WITHDRAWAL WITHOUT NOTICE, AND TO ANY SPECIAL LISTING CONDITIONS IMPOSED BY THE PROPERTY OWNER(S). ANY PROJECTIONS, OPINIONS OR ESTIMATES ARE SUBJECT TO UNCERTAINTY AND DO NOT SIGNIFY CURRENT OR FUTURE PROPERTY PERFORMANCE.