



**CUSHMAN &  
WAKEFIELD**

Southwestern Ontario

**FOR LEASE**

**45 ARTISANS CRESCENT UNIT 2**

*London, ON*



## EXCELLENT OFFICE OPPORTUNITY

### ASKING RENT

**\$12.00**

**PSF GROSS**

### AVAILABLE SPACE

**UP TO 15,000**

**SF**

### ZONING

**LI3/4/5**

**LIGHT INDUSTRIAL**

**ANDREW JOHNSON**

*Sales Representative*

519 438 8639

[andrew.johnson@cushwakeswo.com](mailto:andrew.johnson@cushwakeswo.com)

**CUSHMAN & WAKEFIELD  
SOUTHWESTERN ONTARIO**  
850 Medway Park Dr, Suite 201  
London, Ontario N6G 5G6  
[www.cushwakeswo.com](http://www.cushwakeswo.com)

©2025 Cushman & Wakefield Southwestern Ontario, Real Estate Brokerage, Independently Owned and Operated. A Member of the Cushman & Wakefield Alliance.  
This information has been obtained from sources believed to be reliable but has not been verified. No warranty or representation, express or implied, is made as to the condition of the property (or properties) referenced herein or as to the accuracy or completeness of the information contained herein, and same is submitted subject to errors, omissions, change of price, rental or other conditions, withdrawal without notice, and to any special listing conditions imposed by the property owner(s). Any projections, opinions or estimates are subject to uncertainty and do not signify current or future property performance. All rights reserved.

# ABOUT THE PROPERTY

Versatile space that offers the perfect blend of accessibility, security, and professional amenities. The flexible floor plan allows for customization to meet your business needs, while the all-inclusive lease structure simplifies your occupancy costs. The Building is conveniently located in close proximity to London International Airport and provides excellent exposure to Oxford St. and Veterans Memorial Parkway.

- **Asking rent is inclusive of building insurance, property taxes and utilities**
- **Zoning:** LI3/4/5
- **Parking:** Ample spaces available on-site
- The space offers a combination of private offices, and boardroom areas
- The 2<sup>nd</sup> floor offices are nicely appointed with plenty of natural light throughout
- The unit has secure access and is accessible
- Various configurations available

45 Artisans Cr., London, ON

## Second Floor Plan

| FLOOR | OFFICE AREA           | WAREHOUSE AREA        |
|-------|-----------------------|-----------------------|
| 1     | 25,168 Sq. Ft.        | 23,375 Sq. Ft.        |
| 2     | 24,229 Sq. Ft.        | 1,895 Sq. Ft.         |
| 3     | 9,862 Sq. Ft.         |                       |
|       | <b>59,259 Sq. Ft.</b> | <b>25,270 Sq. Ft.</b> |

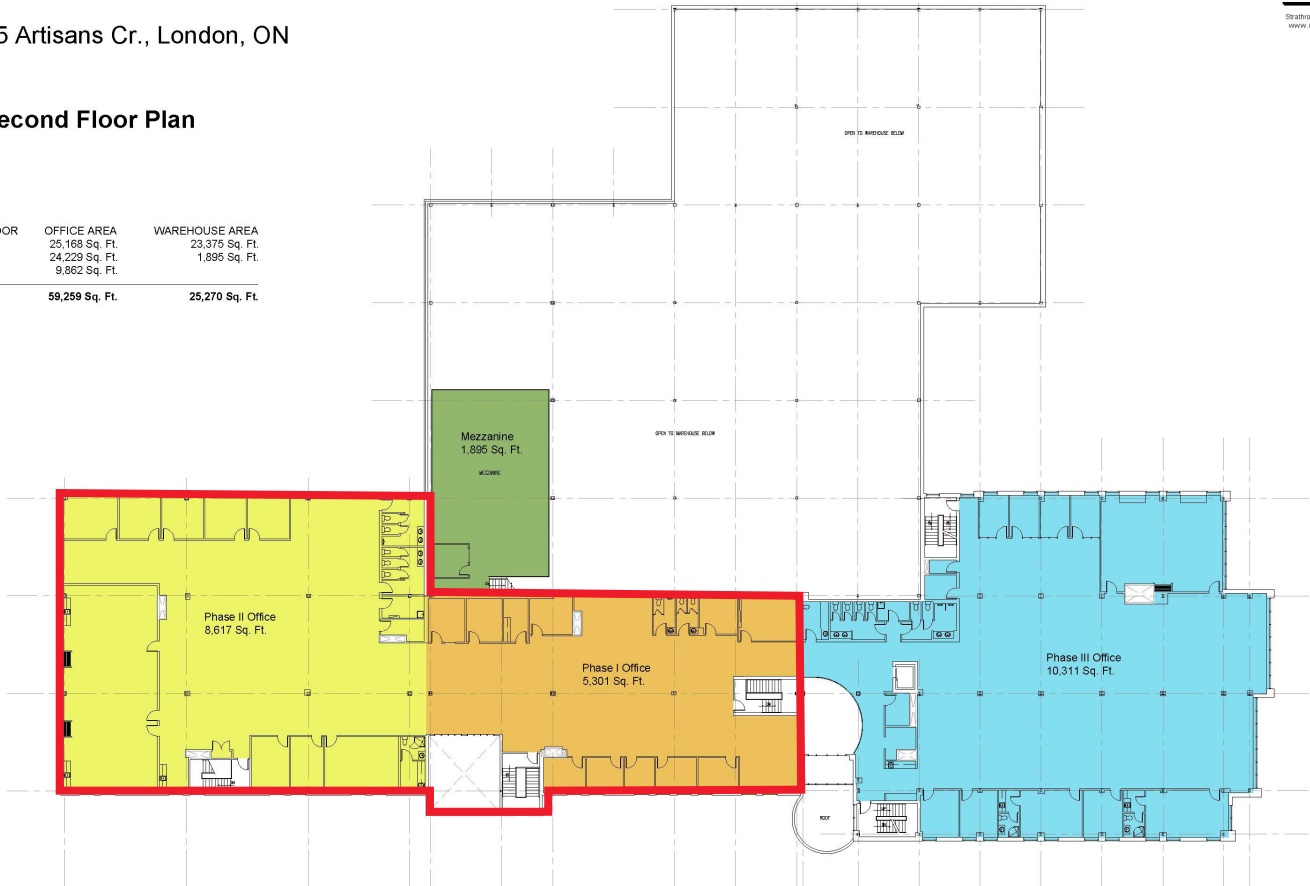

Brathway, ON 519-245-4147  
www.dimensions-ca.com

**ANDREW JOHNSON**  
Sales Representative

519 438 8639

andrew.johnson@cushwakeswo.com

**CUSHMAN & WAKEFIELD**  
SOUTHWESTERN ONTARIO  
850 Medway Park Dr, Suite 201  
London, Ontario N6G 5G6  
[www.cushwakeswo.com](http://www.cushwakeswo.com)



**CUSHMAN & WAKEFIELD**

Southwestern Ontario

©2025 Cushman & Wakefield Southwestern Ontario, Real Estate Brokerage, Independently Owned and Operated. A Member of the Cushman & Wakefield Alliance. This information has been obtained from sources believed to be reliable but has not been verified. No warranty or representation, express or implied, is made as to the condition of the property (or properties) referenced herein or as to the accuracy or completeness of the information contained herein, and same is submitted subject to errors, omissions, change of price, rental or other conditions, withdrawal without notice, and to any special listing conditions imposed by the property owner(s). Any projections, opinions or estimates are subject to uncertainty and do not signify current or future property performance. All rights reserved.