

# FOR LEASE

**2309**  
**CALLE DE LUNA**  
SANTA CLARA, CA

**±8,348 SF MANUFACTURING SPACE AVAILABLE**

## HIGHLIGHTS

- Office and Production Space
- 14 Parking Spaces, 1.68/1,000 Ratio
- Zoning ML
- Power: 800 Amps @ 120/208 Volts, 3-Phase
- Fully Insulated
- 2 Grade Level Doors
- Call to Tour
- Asking \$1.75 Gross

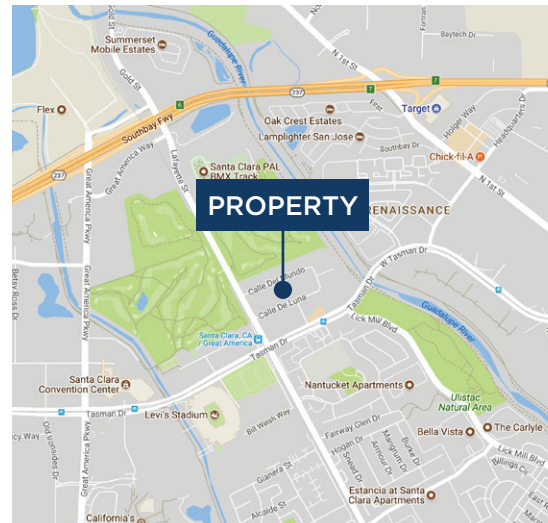

## CONTACT

**JOHN BRACKETT**  
408.309.3300  
john.brackett@cushwake.com  
LIC #00906947



# 2309

## CALLE DE LUNA

SANTA CLARA, CA

### FLOOR PLAN

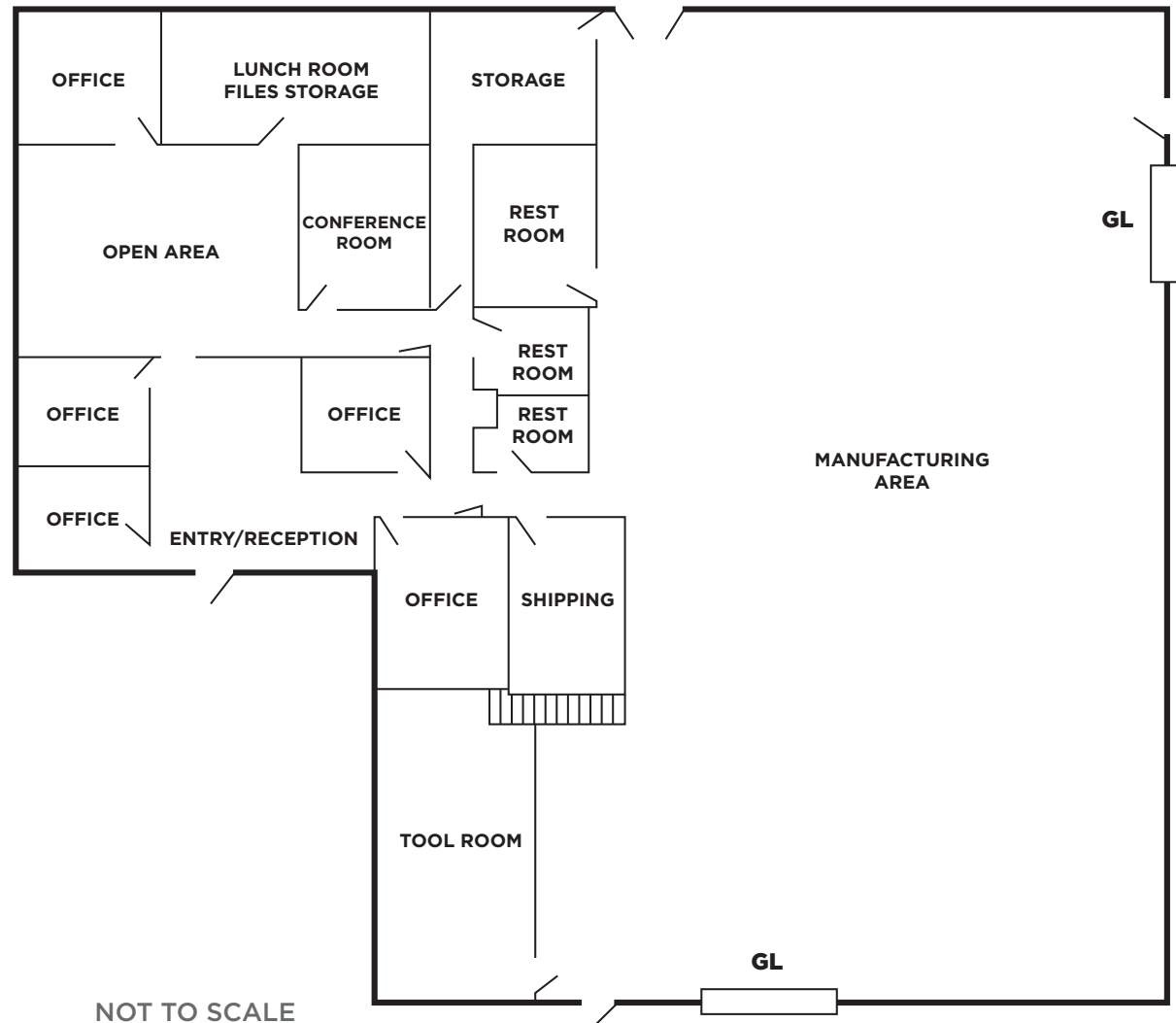

JOHN BRACKETT | 408.309.3300 | [john.brackett@cushwake.com](mailto:john.brackett@cushwake.com) | LIC #00906947

