

FOR LEASE
13,969 SF



TILBURY STRATA UNIT

UNIT 216 - 6901 72ND STREET, DELTA, BC

UNIT FEATURES

- Premium tilt-up concrete construction
- Five (5) washrooms
- 26' clear ceiling height
- One (1) grade door
- Three (3) dock doors
- ESFR sprinkler system
- Skylights
- Ceiling fans
- 3 phase, 400 amp, 600 volt electrical service
- Clear span bay
- T -5 high output fluorescent lighting
- Twelve (12) designated parking stalls

Location:

Tilbury Business Park in Delta. The unit is located within the highly desirable Tilbury West Corporate Centre II industrial strata development.

Unit Size:

Main Floor Office	2,278 SF
2 nd Floor Office	2,278 SF
Warehouse	9,413 SF
Total	13,969 SF

Zoning:

I-2, Medium Industrial

Lease Rate:

Please contact listing agents

Taxes & Operating Costs (2025 Est.):

\$5.68 PSF

Availability:

May 1, 2025

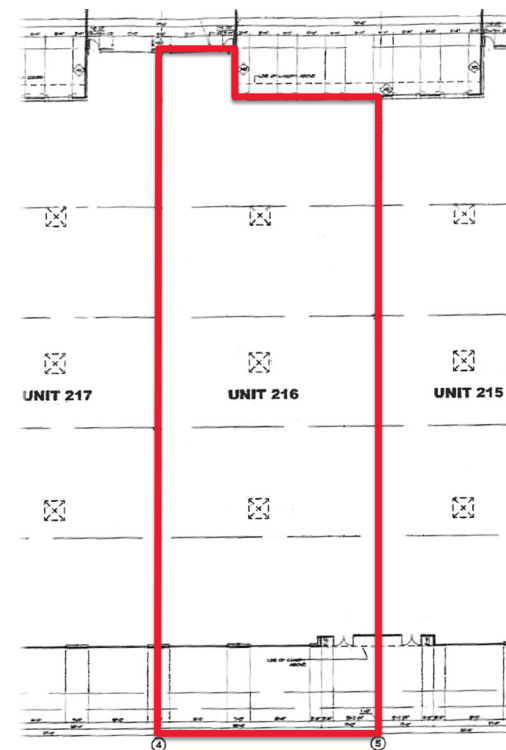
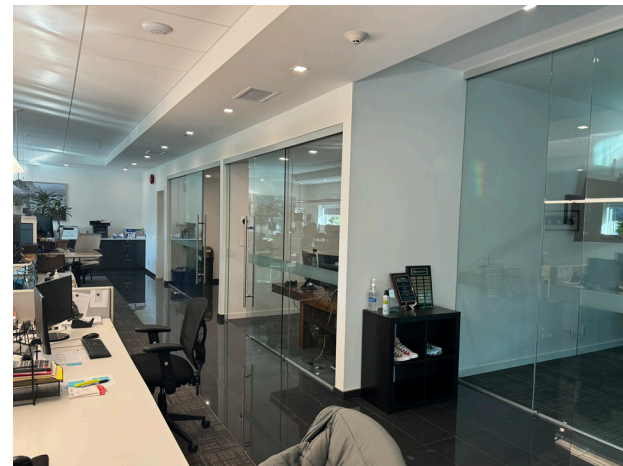

RON EMERSON

Personal Real Estate Corporation
Vice President
+1 604 608 5921
ron.emerson@cushwake.com

JOHN WEISS

Senior Associate
+1 604 640 5865
john.weiss@cushwake.com

Suite 1200-700 West Georgia
Street PO Box 10023, Pacific Centre
Vancouver, BC V7Y 1A1
+1 604 683 3111 | +1 877 788 3111

**CUSHMAN &
WAKEFIELD**
cushmanwakefield.com