

# B

## THE BIRMINGHAM

Where Industry Grows

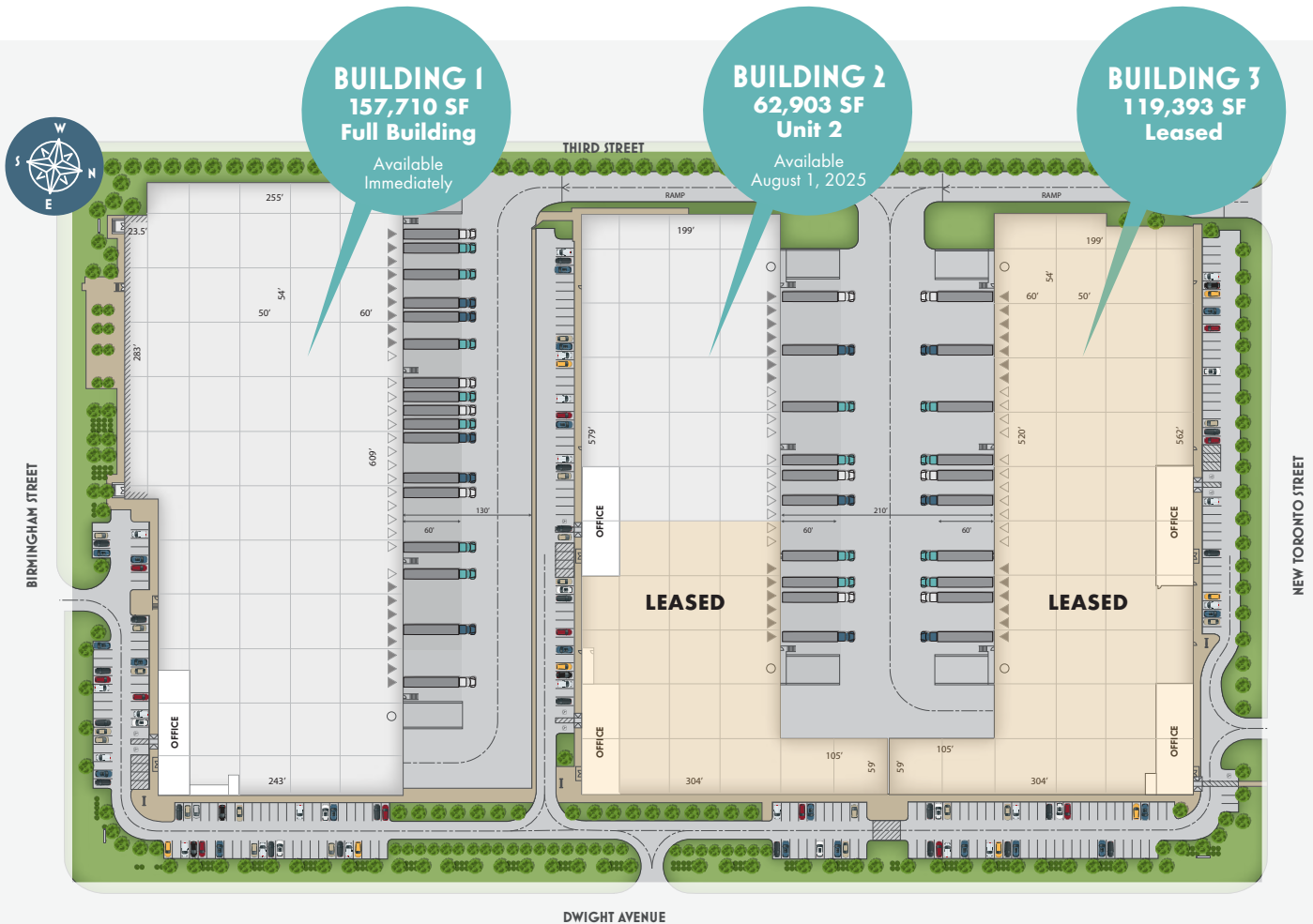

## SPECIFICATIONS

36'

CLEAR HEIGHT

2.5%

OFFICE AREA

54'x46'

BAY SIZE

60'

STAGING BAY

17-9'x10'

DOCK DOORS  
PER BUILDING

2-12'x16'

DRIVE-IN DOORS  
PER BUILDING

### DOCK PACKAGE:

#### LEVELER TYPE

Hydraulic

#### LEVELER CAPACITY

40,000

#### BUMPERS & SEALS

Yes

#### KNOCK OUTS

15 / Building

### BUILDING:

#### WAREHOUSE FLOOR

8" Slab Steel Fiber

#### CONCRETE STRENGTH

25 Mpa (4060 psi)

#### LIGHTING

LED - Warehouse & Office

#### WAREHOUSE AIR

Roof Mounted Cambridge Makeup  
Air Units w/Destratification Fans

#### OFFICE AIR

Rooftop HVAC

#### POWER

750 KVA Transformer 1250A, 347/600V 3 phase

#### SPRINKLER

ESFR

### EXTERIOR:

#### TRUCK COURT

Full Concrete

#### SHIPPING APRON

7" Reinforced Concrete

#### EV CHARGING

6 / Building

#### EMPLOYEE PARKING

.72 / 1,000 sf

Disclaimer: All specifications and depictions contained herein, including the site plan layout, are based on preliminary plans, are subject to change and do not constitute a representation, warranty or covenant of any kind by Landlord/Owner.



# WHERE INDUSTRY GROWS

60 BIRMINGHAM STREET, ETOBICOKE ON



PETER A. SCHMIDT

Executive Vice President, Industrial Leasing  
Sales Representative  
Cushman & Wakefield, Brokerage

**T 416-756-5460**

**E [peter.schmidt@cushwake.com](mailto:peter.schmidt@cushwake.com)**

DANIEL HUBERT

Senior Vice President, Corporate Real Estate Services  
Sales Representative, Canada  
Cushman & Wakefield, Brokerage

**T 416-756-5460**

**E [Daniel.hubert@cushwake.com](mailto:Daniel.hubert@cushwake.com)**