



AVAILABLE FOR LEASE

ENTERPRISE INDUSTRIAL PARK

530 PENDLETON STREET, HIGH POINT, NC 27260



ENTERPRISE INDUSTRIAL PARK

530 PENDLETON STREET, HIGH POINT, NC 27260

FLOOR PLAN

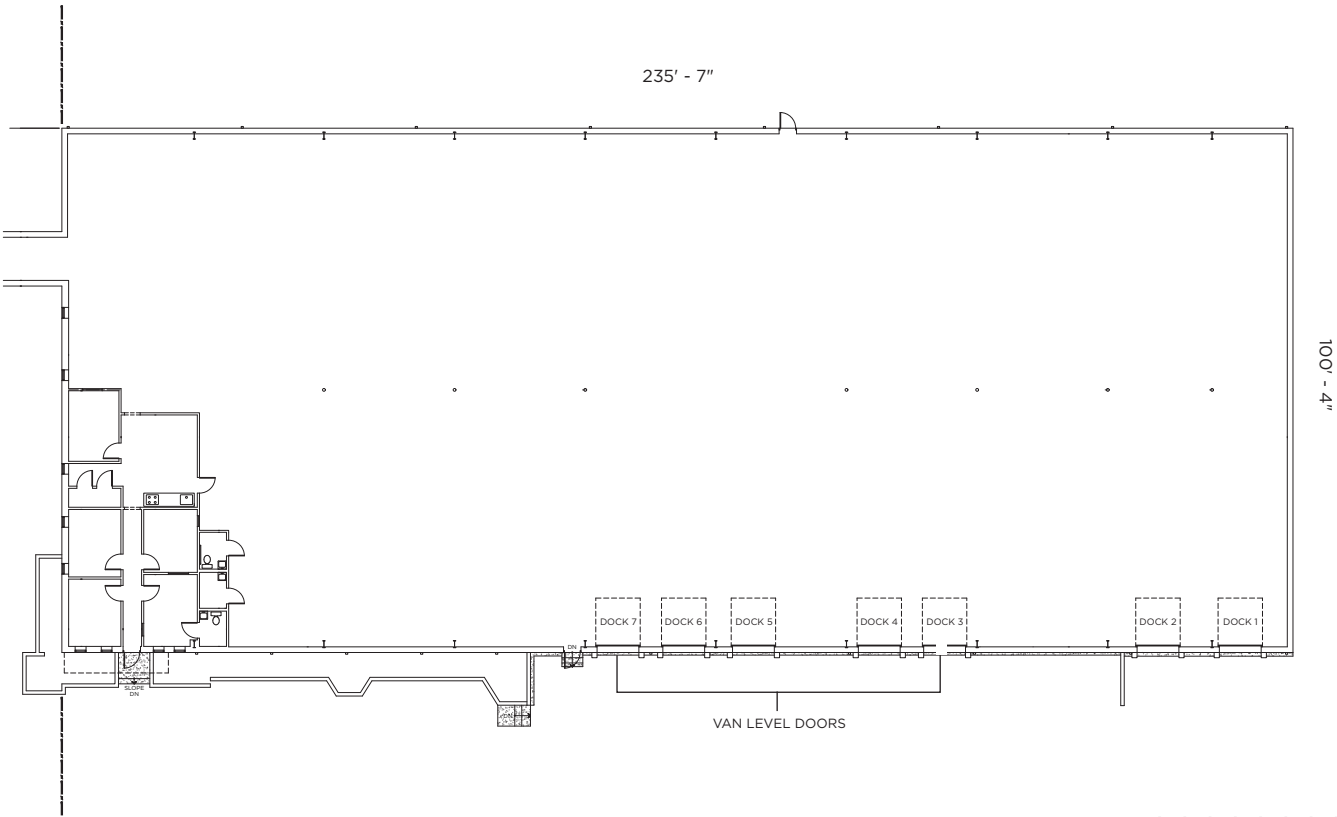

530 PENDLETON STREET	
Size:	23,637 SF (43,548 SF Total)
Office:	± 2,100 SF of renovated office
Dock-High Doors:	Two Dock-High Doors
Van Level Doors:	Five Van-Level Doors
Column Spacing:	24.5' x 48'
Clear Height:	10' eaves and 13'4" in the center
Electrical Service:	3 phase 200 AMP panel
Industrial Outdoor Storage Opportunity:	± 4.25 Acres

ENTERPRISE INDUSTRIAL PARK

530 PENDLETON STREET, HIGH POINT, NC 27260

AERIAL MAP



ENTERPRISE INDUSTRIAL PARK

530 PENDLETON STREET, HIGH POINT, NC 27260

AERIAL LOCATION



ENTERPRISE INDUSTRIAL PARK

530 PENDLETON STREET, HIGH POINT, NC 27260

LOCATOR MAP

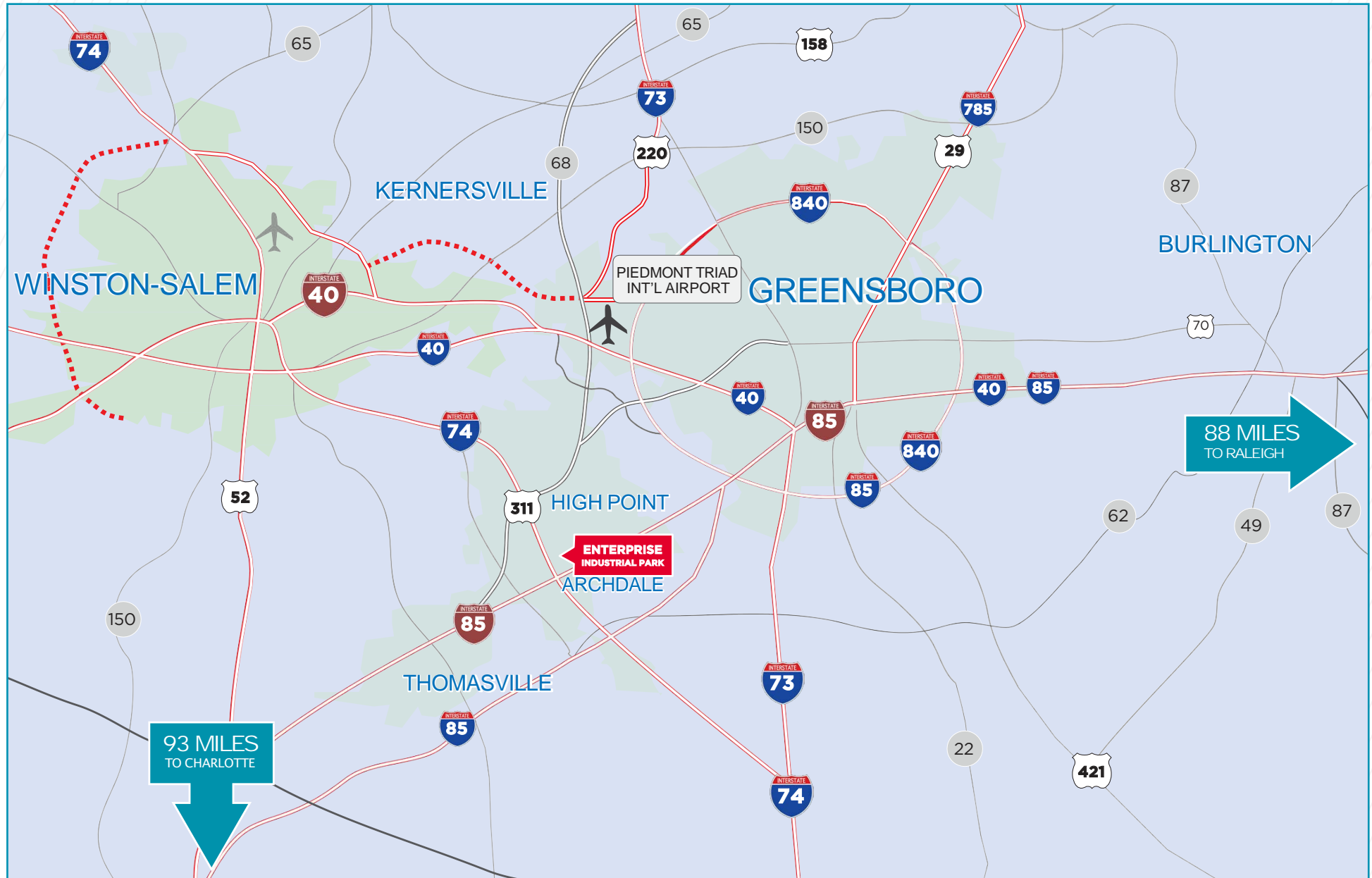

ENTERPRISE INDUSTRIAL PARK

530 PENDLETON STREET, HIGH POINT, NC 27260

FOR MORE INFORMATION, CONTACT:

JORDAN MITCHELL

Senior Director

+1 336 201 0495

jordan.mitchell@cushwake.com

RYAN CONBOY, SIOR

Managing Director

+1 336 821 3832

ryan.conboy@cushwake.com

628 Green Valley Road, Suite 202

Greensboro, NC 27408

+1 336 668 9999

cushmanwakefield.com

©2025 Cushman & Wakefield. All rights reserved. The information contained in this communication is strictly confidential. This information has been obtained from sources believed to be reliable but has not been verified. NO WARRANTY OR REPRESENTATION, EXPRESS OR IMPLIED, IS MADE AS TO THE CONDITION OF THE PROPERTY (OR PROPERTIES) REFERENCED HEREIN OR AS TO THE ACCURACY OR COMPLETENESS OF THE INFORMATION CONTAINED HEREIN, AND SAME IS SUBMITTED SUBJECT TO ERRORS, OMISSIONS, CHANGE OF PRICE, RENTAL OR OTHER CONDITIONS, WITHDRAWAL WITHOUT NOTICE, AND TO ANY SPECIAL LISTING CONDITIONS IMPOSED BY THE PROPERTY OWNER(S). ANY PROJECTIONS, OPINIONS OR ESTIMATES ARE SUBJECT TO UNCERTAINTY AND DO NOT SIGNIFY CURRENT OR FUTURE PROPERTY PERFORMANCE.

