



AVAILABLE FOR LEASE

# ENTERPRISE INDUSTRIAL PARK

530 PENDLETON STREET, HIGH POINT, NC 27260





# ENTERPRISE INDUSTRIAL PARK

530 PENDLETON STREET, HIGH POINT, NC 27260

AVAILABILITY





# ENTERPRISE INDUSTRIAL PARK

530 PENDLETON STREET, HIGH POINT, NC 27260

## FLOOR PLAN

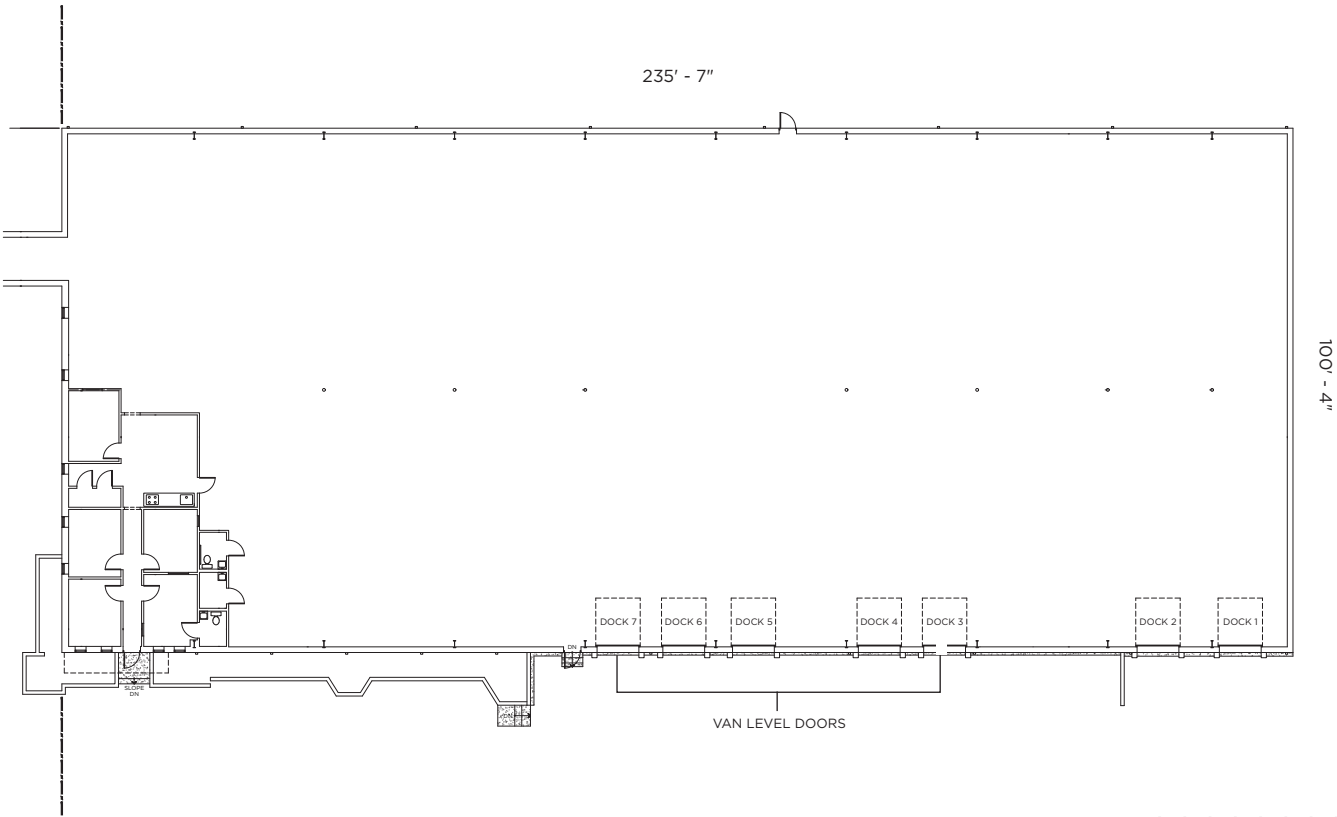

| 530 PENDLETON STREET                    |                                   |
|---|-----------------------------------|
| Size:                                   | 23,637 SF (43,548 SF Total)       |
| Office:                                 | ± 2,100 SF of renovated office    |
| Dock-High Doors:                        | Two Dock-High Doors               |
| Van Level Doors:                        | Five Van-Level Doors              |
| Column Spacing:                         | 24.5' x 48'                       |
| Clear Height:                           | 10' eaves and 13'4" in the center |
| Electrical Service:                     | 3 phase 200 AMP panel             |
| Industrial Outdoor Storage Opportunity: | ± 4.25 Acres                      |



# ENTERPRISE INDUSTRIAL PARK

530 PENDLETON STREET, HIGH POINT, NC 27260

AERIAL MAP





# ENTERPRISE INDUSTRIAL PARK

530 PENDLETON STREET, HIGH POINT, NC 27260

AERIAL LOCATION





# ENTERPRISE INDUSTRIAL PARK

530 PENDLETON STREET, HIGH POINT, NC 27260

LOCATOR MAP

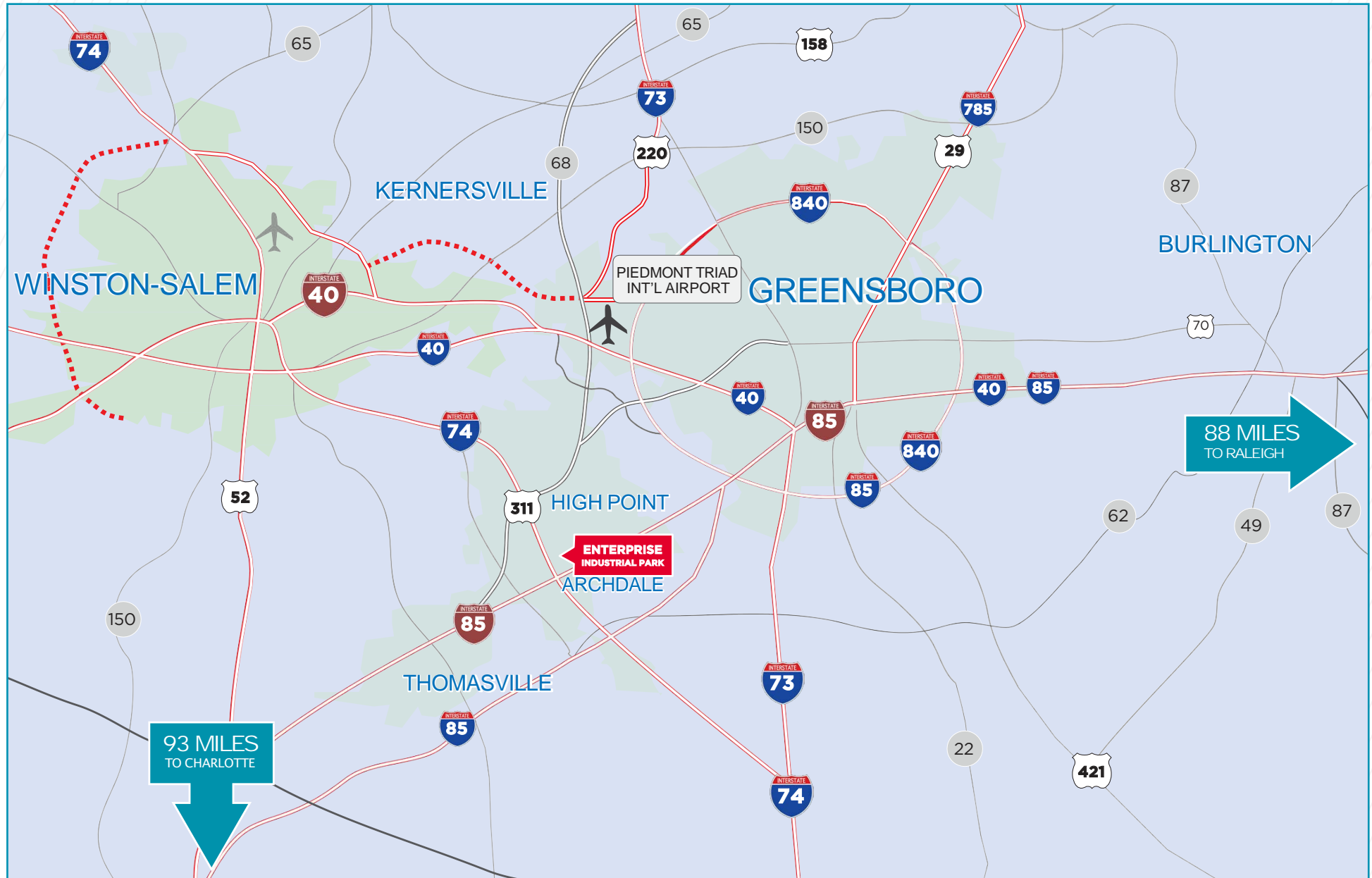

# ENTERPRISE INDUSTRIAL PARK

530 PENDLETON STREET, HIGH POINT, NC 27260

## FOR MORE INFORMATION, CONTACT:

### **JORDAN MITCHELL**

Senior Director

+1 336 201 0495

[jordan.mitchell@cushwake.com](mailto:jordan.mitchell@cushwake.com)

### **RYAN CONBOY, SIOR**

Managing Director

+1 336 821 3832

[ryan.conboy@cushwake.com](mailto:ryan.conboy@cushwake.com)

628 Green Valley Road, Suite 202

Greensboro, NC 27408

+1 336 668 9999

[cushmanwakefield.com](http://cushmanwakefield.com)

©2025 Cushman & Wakefield. All rights reserved. The information contained in this communication is strictly confidential. This information has been obtained from sources believed to be reliable but has not been verified. NO WARRANTY OR REPRESENTATION, EXPRESS OR IMPLIED, IS MADE AS TO THE CONDITION OF THE PROPERTY (OR PROPERTIES) REFERENCED HEREIN OR AS TO THE ACCURACY OR COMPLETENESS OF THE INFORMATION CONTAINED HEREIN, AND SAME IS SUBMITTED SUBJECT TO ERRORS, OMISSIONS, CHANGE OF PRICE, RENTAL OR OTHER CONDITIONS, WITHDRAWAL WITHOUT NOTICE, AND TO ANY SPECIAL LISTING CONDITIONS IMPOSED BY THE PROPERTY OWNER(S). ANY PROJECTIONS, OPINIONS OR ESTIMATES ARE SUBJECT TO UNCERTAINTY AND DO NOT SIGNIFY CURRENT OR FUTURE PROPERTY PERFORMANCE.

