

**AVAILABLE FOR LEASE**

**1709 HEATH PARKWAY**  
**FORT COLLINS, CO 80524**



CUSHMAN &  
WAKEFIELD



**7,425 SF WAREHOUSE AVAILABLE**  
**LEASE PRICE: \$10.00/SF NNN | NNN'S: \$4.04/SF**

1709 Heath Parkway features a spacious 7,425 SF industrial warehouse facility. Located only minutes from the amenities of Old Town, this is an excellent location ideal for any flex/warehouse or industrial. Contact the listing brokers for more information on this great opportunity.

### **Property Highlights**

- NNN expenses of \$4.04/SF
- On-site parking
- Two overhead doors
- Building signage
- Easy access to Mulberry Street and I-25
- Close proximity to Old Town Fort Collins

# 1709 HEATH PARKWAY

## FORT COLLINS, CO 80524

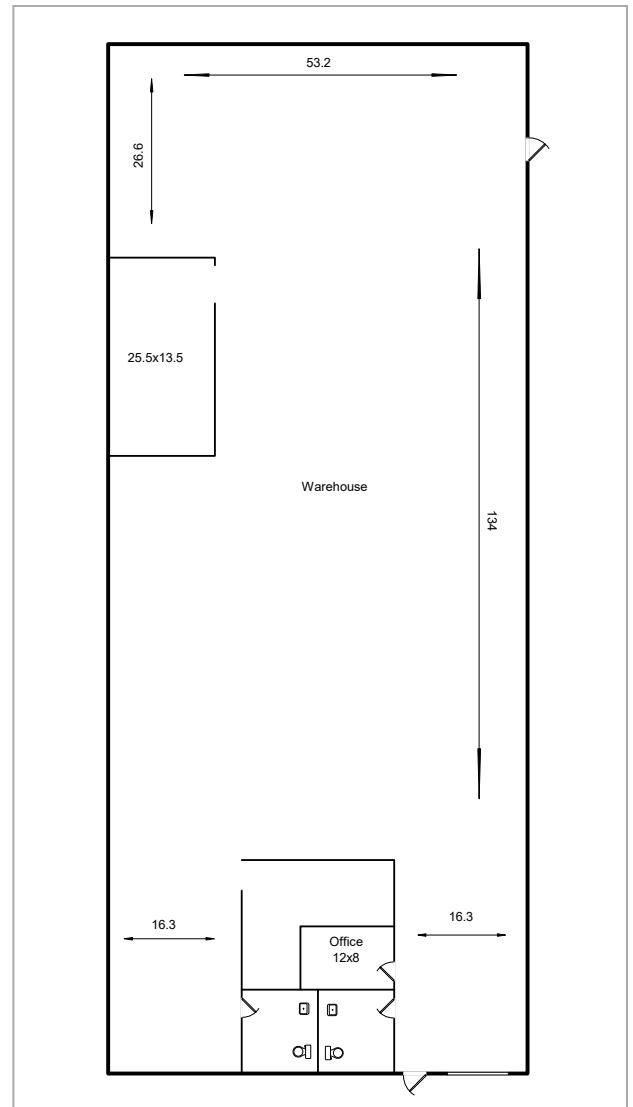

### Warehouse

- 7,425 SF
- 3 Phase
- 200 amp (2-100 Amp Panel)
- 208/108 Service
- Sprinkled
- Two 10' x 12' Overhead Doors

1709 HEATH PARKWAY



---

# 1709 HEATH PARKWAY

## FORT COLLINS, CO 80524





## Demographics

CoStar, 2024

	2 Miles	5 Miles	10 Miles
2024 Population	28,434	156,524	248,960
2024 Households (HH)	11,983	64,076	97,997
Avg. HH Income	\$91,511	\$93,074	\$108,456
Daytime Employment	38,103	98,691	118,381



## FOR MORE INFORMATION, CONTACT:

AKI PALMER  
Executive Managing Director  
+1 970 267 7727  
aki.palmer@cushwake.com

COLE VANMEVEREN  
Senior Director  
+1 970 219 3802  
cole.vanmeveren@cushwake.com

PATRICK SOUKUP  
Broker/Owner  
+1 970 893 3533  
patrick@soukuprealestate.com

772 Whalers Way, Suite 200 | Fort Collins, Colorado 80525  
+1 970 776 3900 | [cushmanwakefield.com](https://www.cushmanwakefield.com)

©2025 Cushman & Wakefield. All rights reserved. The information contained in this communication is strictly confidential. This information has been obtained from sources believed to be reliable but has not been verified. NO WARRANTY OR REPRESENTATION, EXPRESS OR IMPLIED, IS MADE AS TO THE CONDITION OF THE PROPERTY (OR PROPERTIES) REFERENCED HEREIN OR AS TO THE ACCURACY OR COMPLETENESS OF THE INFORMATION CONTAINED HEREIN, AND SAME IS SUBMITTED SUBJECT TO ERRORS, OMISSIONS, CHANGE OF PRICE, RENTAL OR OTHER CONDITIONS, WITHDRAWAL WITHOUT NOTICE, AND TO ANY SPECIAL LISTING CONDITIONS IMPOSED BY THE PROPERTY OWNER(S). ANY PROJECTIONS, OPINIONS OR ESTIMATES ARE SUBJECT TO UNCERTAINTY AND DO NOT SIGNIFY CURRENT OR FUTURE PROPERTY PERFORMANCE.

