

AVAILABLE
10,920 SF



INTERBELT BUSINESS CENTER

5258 N. SAM HOUSTON PARKWAY EAST
HOUSTON, TX 77032

SPACE HIGHLIGHTS

FLOOR PLAN

Total Building Available: 10,920 SF

Office Area: 2,500 SF

Warehouse Area: 8,420 SF

Clear Height: 18'

Loading: (2) Drive-in Ramps
(2) Dock High / Dock Wells

Sprinkler: YES

Security: Fencing

Configuration: Rear Load Configuration

Comments: Located near Bush IAH with
Convenient Access to Beltway 8,
Hwy 59, Hardy Toll Road, and I-45

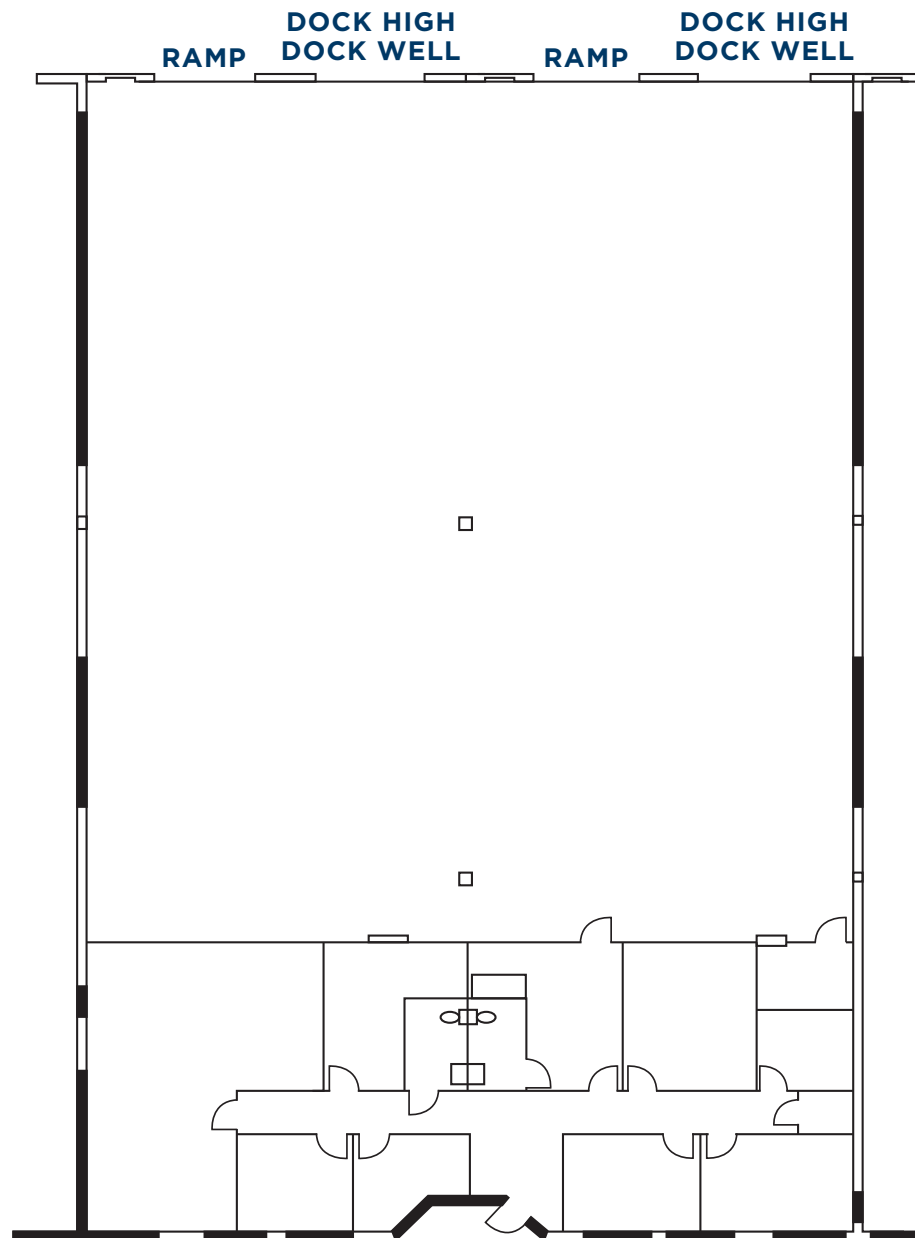



AERIAL MAP



For more information,
please contact:

JOHN KRUSE

Managing Director

Direct: +1 281 688 9234

Mobile: +1 713 304 4919

john.kruse@cushwake.com



1330 Post Oak Blvd., Suite 2700
Houston, TX 77056

cushmanwakefield.com

©2025 Cushman & Wakefield. All rights reserved. The information contained in this communication is strictly confidential. This information has been obtained from sources believed to be reliable but has not been verified. NO WARRANTY OR REPRESENTATION, EXPRESS OR IMPLIED, IS MADE AS TO THE CONDITION OF THE PROPERTY (OR PROPERTIES) REFERENCED HEREIN OR AS TO THE ACCURACY OR COMPLETENESS OF THE INFORMATION CONTAINED HEREIN, AND SAME IS SUBMITTED SUBJECT TO ERRORS, OMISSIONS, CHANGE OF PRICE, RENTAL OR OTHER CONDITIONS, WITHDRAWAL WITHOUT NOTICE, AND TO ANY SPECIAL LISTING CONDITIONS IMPOSED BY THE PROPERTY OWNER(S). ANY PROJECTIONS, OPINIONS OR ESTIMATES ARE SUBJECT TO UNCERTAINTY AND DO NOT SIGNIFY CURRENT OR FUTURE PROPERTY PERFORMANCE.