

CUSHMAN &
WAKEFIELD

259-263 PRINCESS STREET

Kingston, ON

PRIME RETAIL OPPORTUNITIES IN DOWNTOWN KINGSTON

WELCOME TO 259-263 PRINCESS STREET

Located in the heart of downtown Kingston, 259-263 Princess Street offers an exceptional retail opportunity in a shopping destination. Previously occupied by Indigo, this prime space is surrounded by top-tier national and independent retailers, benefiting from strong foot traffic and a vibrant downtown atmosphere. Multiple retail units available, with the flexibility to combine two spaces for a larger footprint. With excellent frontage along Princess Street, this location is ideal for a variety of retail uses.

Details

SIZE:	Unit A: 1,956 SF Unit B: 2,166 SF Unit C: 3,768 SF (Under Contract)
NET RENT:	Contact Listing Agents
ADDITIONAL RENT:	\$12.00 PSF (Est. 2025)
TERM:	5-10 Years
AVAILABILITY:	Immediate

Highlights

- Ability to Combine Unit A and Unit B for 4,122 SF
- Building exterior work underway to create separate entrances
- Prime visibility with excellent signage opportunities in downtown Kingston
- Municipal and monthly tenant parking available

PROPERTY OVERVIEW



FLOORPLAN

GROUND FLOOR - 7,890 SF

Unit A - 1,956 SF

Unit B - 2,166 SF

Unit C - 3,768 SF

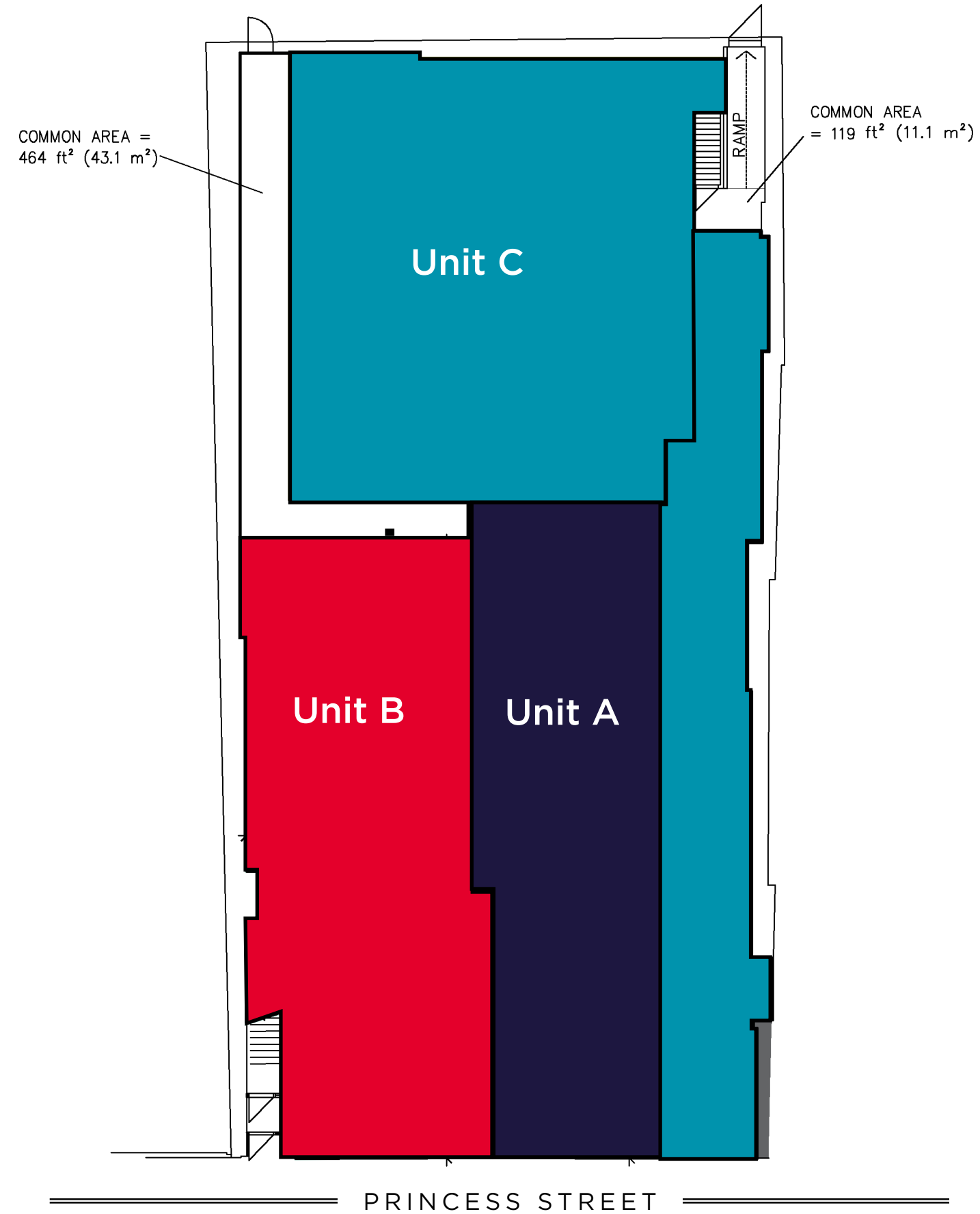

BUILDING RENDERING

EXTERIOR STOREFRONT



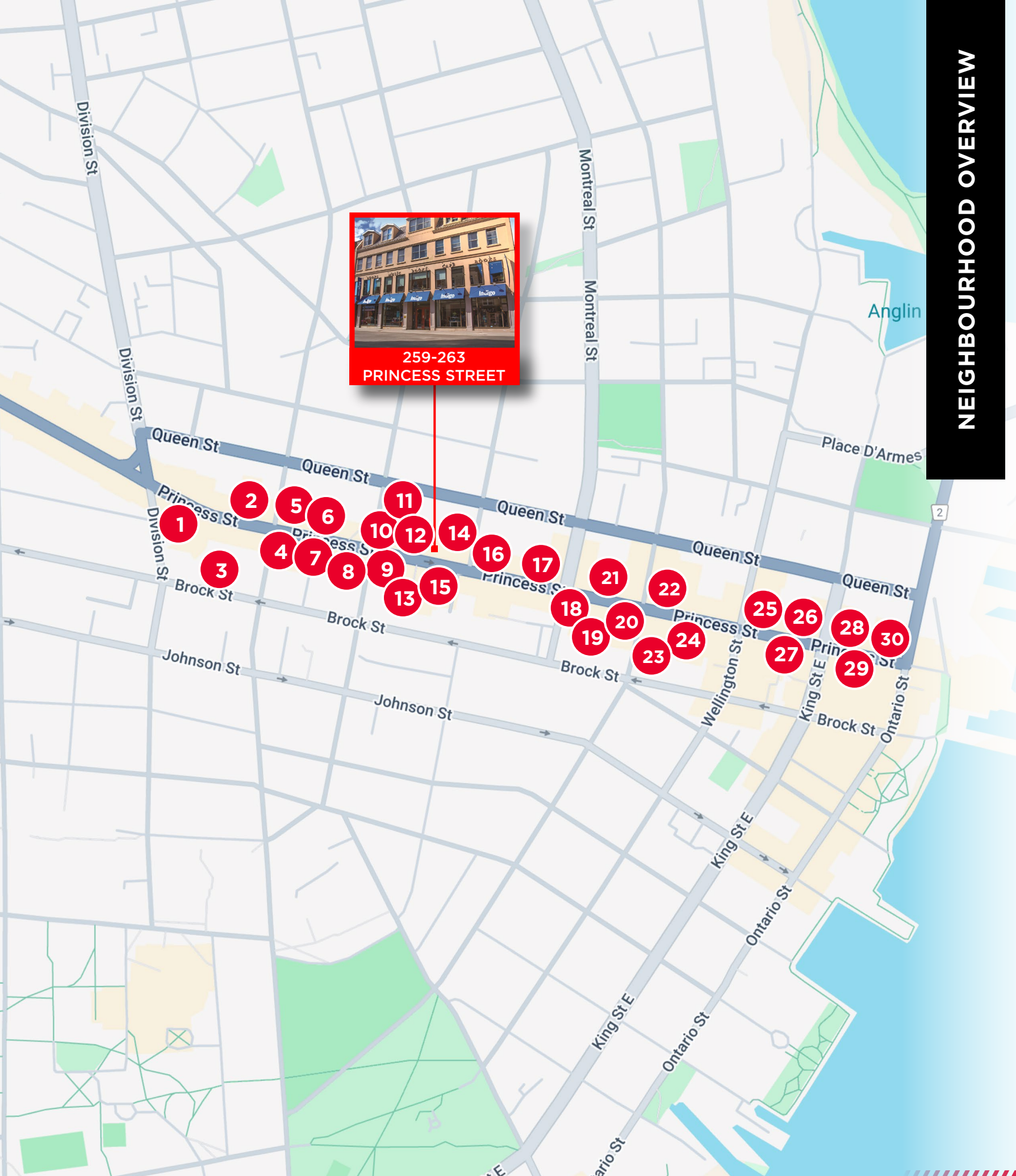

Neighbourhood Amenities

- | | |
|-----------------------------------|---------------------------------|
| 1. Edo Japan | 16. Roots |
| 2. Tommy's | 17. Urban Outfitters |
| 3. Metro | 18. Union Kitchen + Cocktails |
| 4. Pizza Studio | 19. Dollarama |
| 5. Loaded Pierogi | 20. Crave Coffee House & Bakery |
| 6. Osmow's Shawarma | 21. Grecos |
| 7. Tahini's | 22. Bulk Barn |
| 8. McDonalds | 23. Shoppers Drug Mart |
| 9. The WORKS Craft Burgers & Beer | 24. Dollar Tree |
| 10. Northside espresso + kitchen | 25. Starbucks |
| 11. Wine Rack | 26. RBC |
| 12. Freshii | 27. Chez Piggy Restaurant & Bar |
| 13. Lululemon | 28. Coffee & Company |
| 14. Balzac's Kitchen | 29. Pan Chancho Bakery & Café |
| 15. Eggstastic | 30. Milestones |

Demographics (1km)

 Population within 1 km 11,064	 Traffic Score 80
 Daytime Population 42,871.1	 Pedestrian Score 100
 Average Household Income \$78,501	 Transit Score 62
 Median Age 37	



161 Bay Street, Suite 1500
Toronto, ON M5J 2S1 | Canada

CARMEN SIEGEL

Associate Vice President
+1 416 359 2365
+1 416 648 0451
carmen.siegel@cushwake.com

HANNAH KINNEY

Associate
+1 416 359 2390
+1 647 294 0367
hannah.kinney@cushwake.com

CONTACT

©2025 Cushman & Wakefield ULC. All rights reserved. The information contained in this communication is strictly confidential. This information has been obtained from sources believed to be reliable but has not been verified. NO WARRANTY OR REPRESENTATION, EXPRESS OR IMPLIED, IS MADE AS TO THE CONDITION OF THE PROPERTY (OR PROPERTIES) REFERENCED HEREIN OR AS TO THE ACCURACY OR COMPLETENESS OF THE INFORMATION CONTAINED HEREIN, AND SAME IS SUBMITTED SUBJECT TO ERRORS, OMISSIONS, CHANGE OF PRICE, RENTAL OR OTHER CONDITIONS, WITHDRAWAL WITHOUT NOTICE, AND TO ANY SPECIAL LISTING CONDITIONS IMPOSED BY THE PROPERTY OWNER(S). ANY PROJECTIONS, OPINIONS OR ESTIMATES ARE SUBJECT TO UNCERTAINTY AND DO NOT SIGNIFY CURRENT OR FUTURE PROPERTY PERFORMANCE.

