

OFFICE/WAREHOUSE/R&D
UP TO ±43,439 SQUARE FEET AVAILABLE (DIVISIBLE)



2180



FOR LEASE OR SALE

2180 South McDowell Blvd
Petaluma, California

TREVOR BUCK

Executive Managing Director
415 451 2436
trevor.buck@cushwake.com
LIC #01255462

BRIAN FOSTER

Executive Director
415 451 2437
brian.foster@cushwake.com
LIC #01393059

STEVEN LEONARD

Managing Director
415 722 1080
steven.leonard@cushwake.com
LIC #00909604

OFFICE/WAREHOUSE/R&D

UP TO ±43,439 SF AVAILABLE



FEATURES:

Minimum Size:	± 10,426 SF
Site Area:	± 2.37 AC
Clear Height:	± 14' - 17'
Parking:	2.3/1000
Column Spacing:	± 29' x 59'
Sprinklers:	Yes
Building Lease Rate:	\$1.25 NNN
Dock Doors:	1
Grade Level Doors (G):	5 (± 9'x10')
Zoning:	BP (Business Park)
Year Built:	1996
Building Power:	2,000Amp, 480Volts

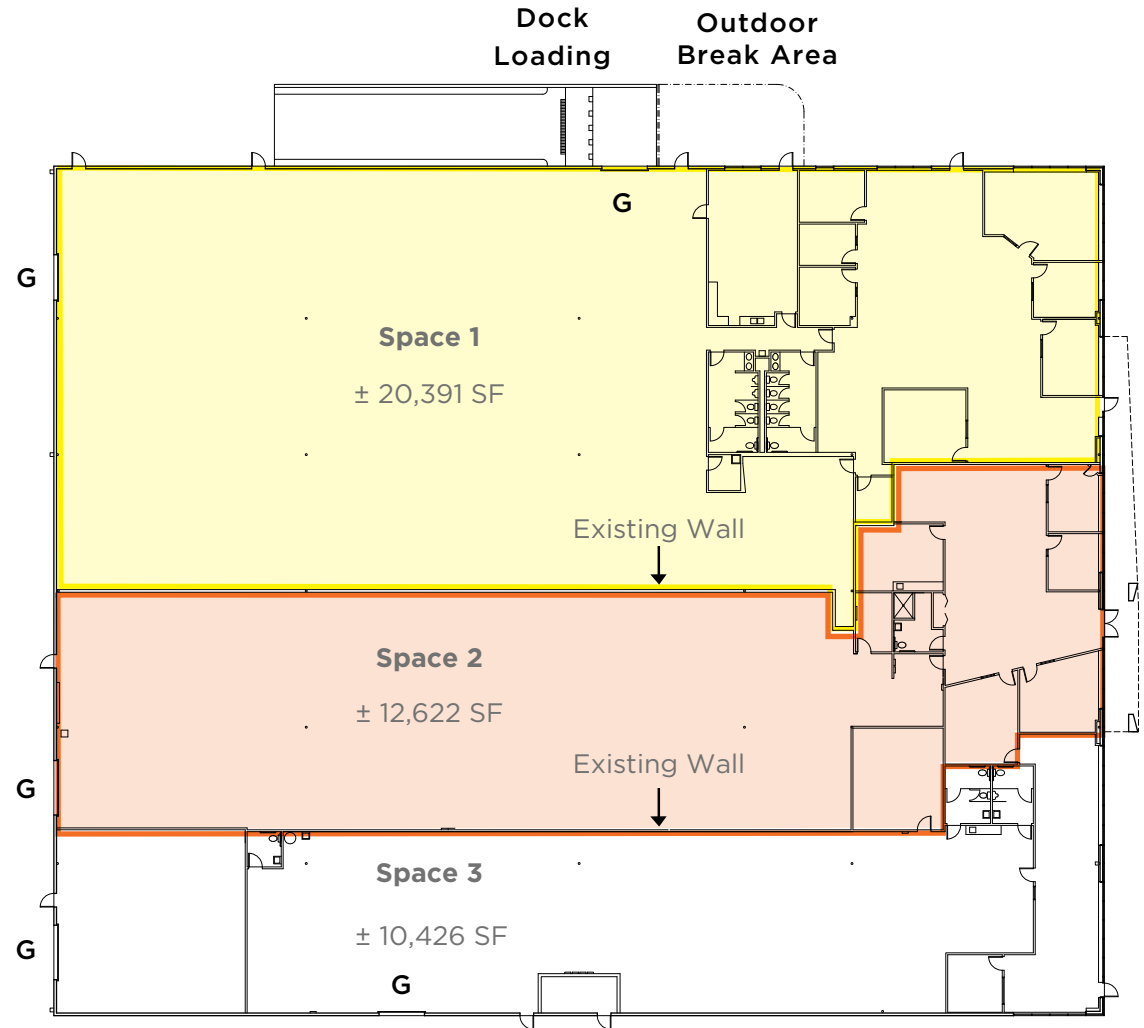

TREVOR BUCK
Executive Managing Director
415 451 2436
trevor.buck@cushwake.com
LIC #01255462

BRIAN FOSTER
Executive Director
415 451 2437
brian.foster@cushwake.com
LIC #01393059

STEVEN LEONARD
Managing Director
415 722 1080
steven.leonard@cushwake.com
LIC #00909604

OFFICE/WAREHOUSE/R&D
UP TO ±43,439 SF AVAILABLE



HIGHLIGHTS:

- Extensive glass line and mature landscaping
- Convenient access to Highways 101 and 37 in Southern Petaluma
- Dock high and grade level loading
- Built out office in place
- Location backs up to Shollenberger Park, walking paths, and open space
- Walking distance to restaurants, coffee, and other amenities
- Outdoor seating area

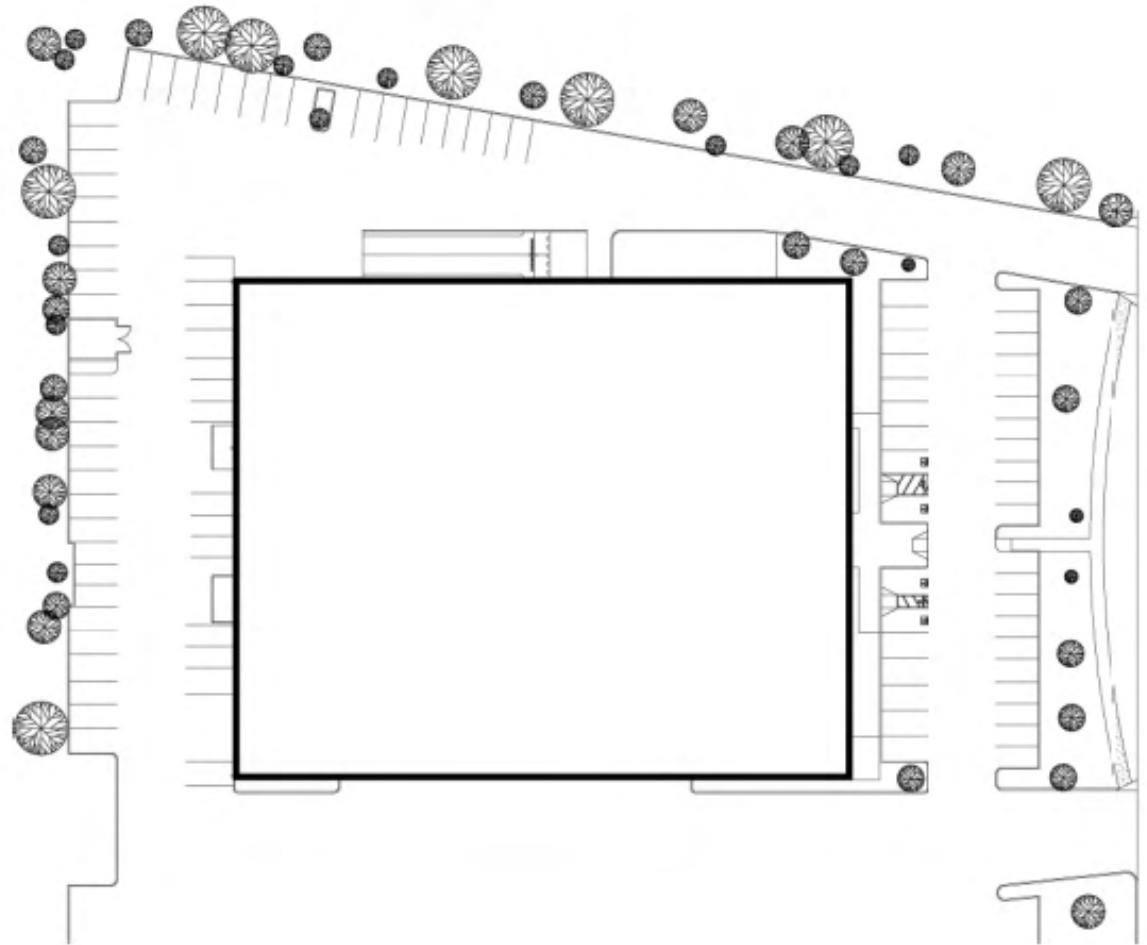

TREVOR BUCK
Executive Managing Director
415 451 2436
trevor.buck@cushwake.com
LIC #01255462

BRIAN FOSTER
Executive Director
415 451 2437
brian.foster@cushwake.com
LIC #01393059

STEVEN LEONARD
Managing Director
415 722 1080
steven.leonard@cushwake.com
LIC #00909604

OFFICE/WAREHOUSE/R&D
UP TO ±43,439 SF AVAILABLE



OFFICE/WAREHOUSE/R&D
UP TO ±43,439 SF AVAILABLE



TREVOR BUCK
Executive Managing Director
415 451 2436
trevor.buck@cushwake.com
LIC #01255462

BRIAN FOSTER
Executive Director
415 451 2437
brian.foster@cushwake.com
LIC #01393059

STEVEN LEONARD
Managing Director
415 722 1080
steven.leonard@cushwake.com
LIC #00909604

OFFICE/WAREHOUSE/R&D
UP TO ±43,439 SF AVAILABLE

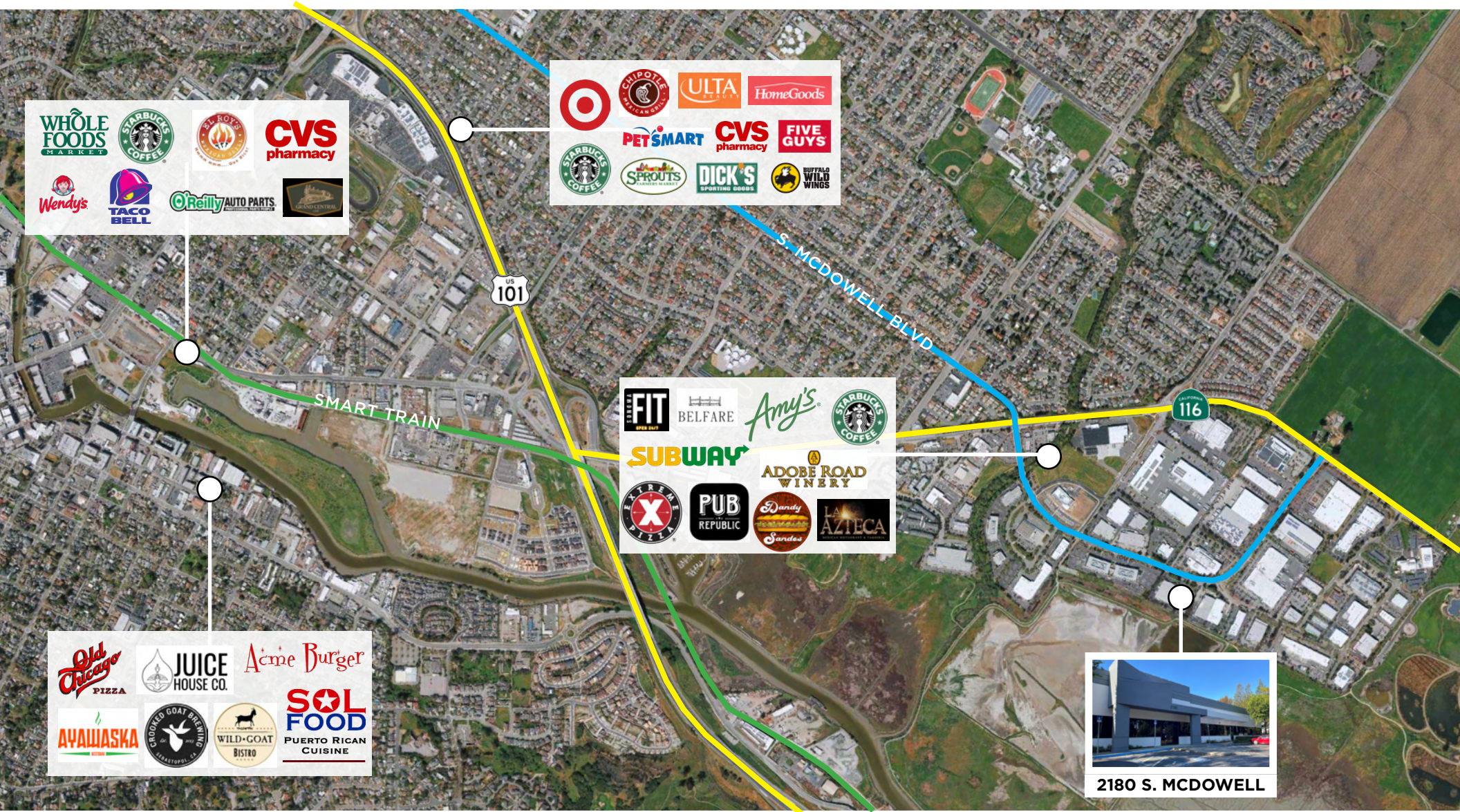

2180 S. MCDOWELL

TREVOR BUCK
Executive Managing Director
415 451 2436
trevor.buck@cushwake.com
LIC #01255462

BRIAN FOSTER
Executive Director
415 451 2437
brian.foster@cushwake.com
LIC #01393059

STEVEN LEONARD
Managing Director
415 722 1080
steven.leonard@cushwake.com
LIC #00909604



FOR LEASE OR SALE

2180 South McDowell Blvd
Petaluma, California

©2026 Cushman & Wakefield. All rights reserved. The information contained in this communication is strictly confidential. This information has been obtained from sources believed to be reliable but has not been verified. NO WARRANTY OR REPRESENTATION, EXPRESS OR IMPLIED, IS MADE AS TO THE CONDITION OF THE PROPERTY (OR PROPERTIES) REFERENCED HEREIN OR AS TO THE ACCURACY OR COMPLETENESS OF THE INFORMATION CONTAINED HEREIN, AND SAME IS SUBMITTED SUBJECT TO ERRORS, OMISSIONS, CHANGE OF PRICE, RENTAL OR OTHER CONDITIONS, WITHDRAWAL WITHOUT NOTICE, AND TO ANY SPECIAL LISTING CONDITIONS IMPOSED BY THE PROPERTY OWNER(S). ANY PROJECTIONS, OPINIONS OR ESTIMATES ARE SUBJECT TO UNCERTAINTY AND DO NOT SIGNIFY CURRENT OR FUTURE PROPERTY PERFORMANCE.