

**Alex Eastman**

Associate, Industrial Sales & Leasing  
+1 778 986 7300  
alex.eastman@cushwake.com

**Kevin Volz**

Personal Real Estate Corporation  
Vice President, Industrial Sales & Leasing  
+1 604 640 5851  
kevin.volz@cushwake.com

**Rick Eastman**

Personal Real Estate Corporation  
Executive Vice President, Industrial  
+1 604 640 5863  
rick.eastman@cushwake.com





FOR LEASE  
UNIT 9  
20071 113B AVENUE  
MAPLE RIDGE, BC

The Subject property is located in the Maple Meadows Industrial Area, at the entrance to the Golden Ears Bridge, which provides access to the Trans-Canada Highway north to Vancouver and south to the US border. This fully serviced industrial park is located immediately south of the Lougheed Highway (Highway #7) near the intersection at Dewdney Trunk Road.

- End unit in concrete tilt up Strata complex
- Small office / reception area
- One (1) grade loading door
- Auto uses considered
- Four (4) parking stalls

## 1,480 SF

M-3 Business Park Zone.  
Light industrial and office use.

\$21.95 per sf, per annum

\$8.71 per sf, per annum

April 1, 2025

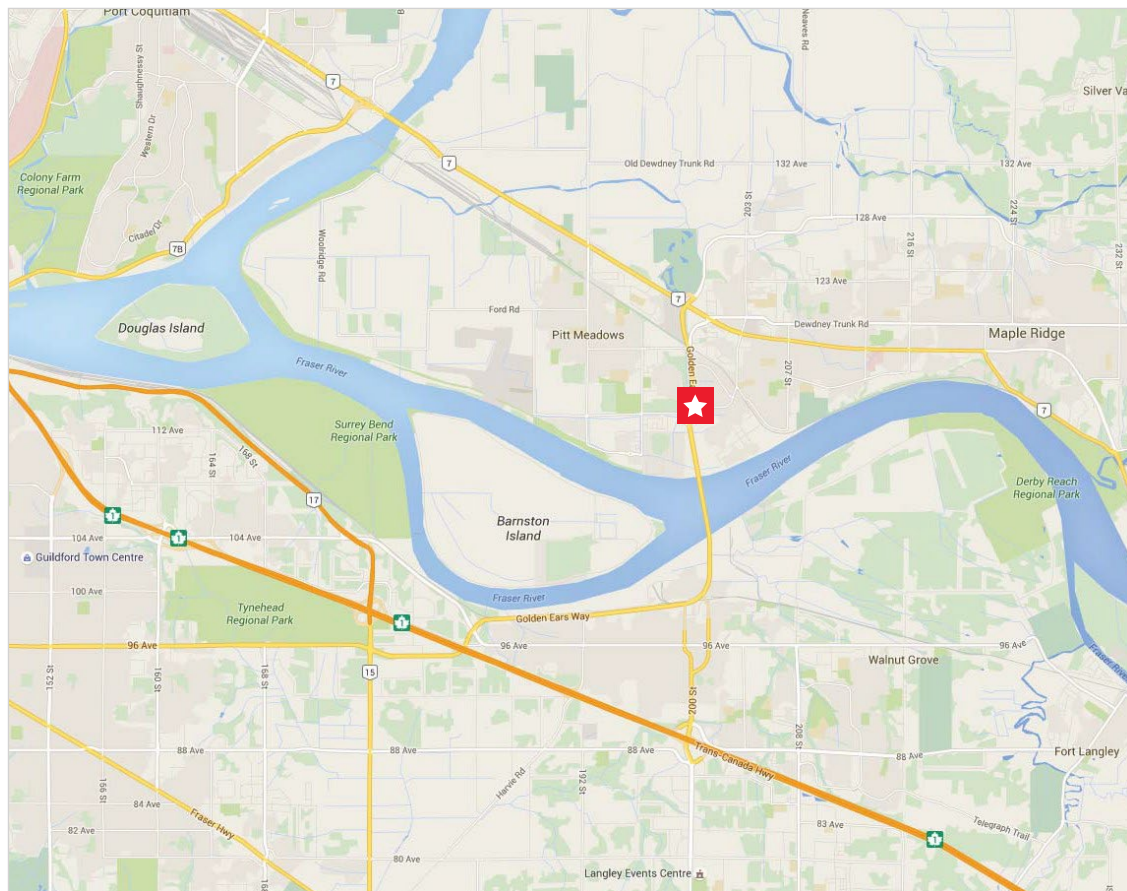
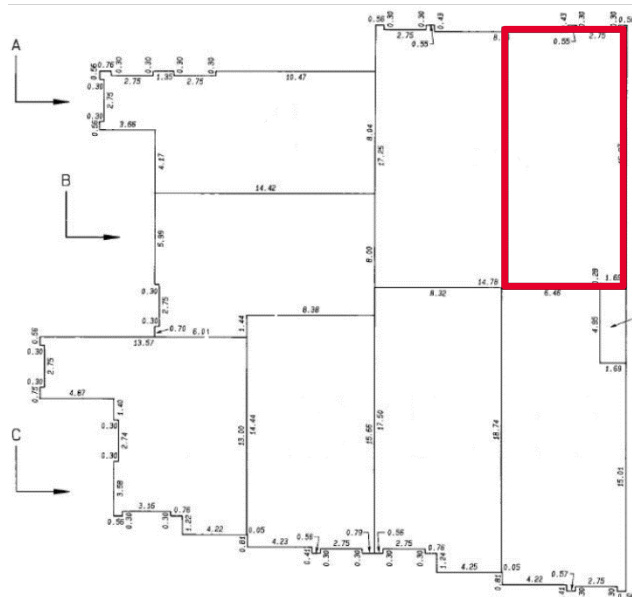

Associate, Industrial Sales & Leasing  
+1 778 986 7300  
alex.eastman@cushwake.com

Personal Real Estate Corporation  
Vice President, Industrial Sales & Leasing  
+1 604 640 5851  
kevin.volz@cushwake.com

Personal Real Estate Corporation  
Executive Vice President, Industrial  
+1 604 640 5863  
rick.eastman@cushwake.com