



FOR SALE

47.78± acres

Mixed Use, Office, Retail, Multifamily Land Development Site
Pasco County, FL



PROPERTY PROFILE

LOCATION:

- Southeast quadrant of State Road 54 and Madison, West Pasco County

DISTANCES:

- U.S. Highway 19 – 1.4 miles
- Suncoast Expressway – 10.9 miles
- Target/Public – 3 miles
- Hospital – 3 miles

SIZE:

- 47.78± acres gross
- 18 acres multifamily
- 34.7 acres retail/office

ZONING:

- MPUD for 250,000 SF of retail, 244,000 SF of office, and 300 units multifamily

FUTURE LAND USE:

- PD

UTILITIES:

- Sewer: 10" PVC FM, south side of State Road 54
- Water: 24" DIP, south side of State Road 54

For more information, please contact:

Bruce Erhardt, ALC
Executive Managing Director
813.223.6300
Bruce.erhardt@cushwake.com

Patrick Berman
Managing Director
813.204.5363
Patrick.berman@cushwake.com

201 N. Franklin St., Suite 3300
Tampa, Florida 33602
T +1 813 223 6300



FOR SALE

47.78± acres

Mixed Use, Office, Retail, Multifamily Land Development Site
Pasco County, FL



TOPO:

- 40-60 feet

ACCESS:

- 30k median cuts on SR 54 and full access from Madison St.
- Light at Madison and when warranted at the eastern median at Thys Rd.

DEMOGRAPHICS:

	1 MILE	3 MILES	5 MILES
Population	11,579	86,306	154,773
Median Income	\$41,838	\$42,776	\$46,842
Retail Sales	\$67,416,360	\$610,379,243	\$1,194,924,338

PRICE:

- Market

BROKERAGE NOTE:

- Outside brokers representing Buyers must be compensated by the Buyer. Cushman & Wakefield of Florida, Inc. is not paying an outside broker

For more information, contact:

Bruce Erhardt, ALC
Executive Managing Director
813.223.6300
Bruce.erhardt@cushwake.com

Patrick Berman
Managing Director
813.204.5363
Patrick.berman@cushwake.com

201 N. Franklin St., Suite 3300
Tampa, Florida 33602
813 223 6300

cushmanwakefield.com

SITE PLAN

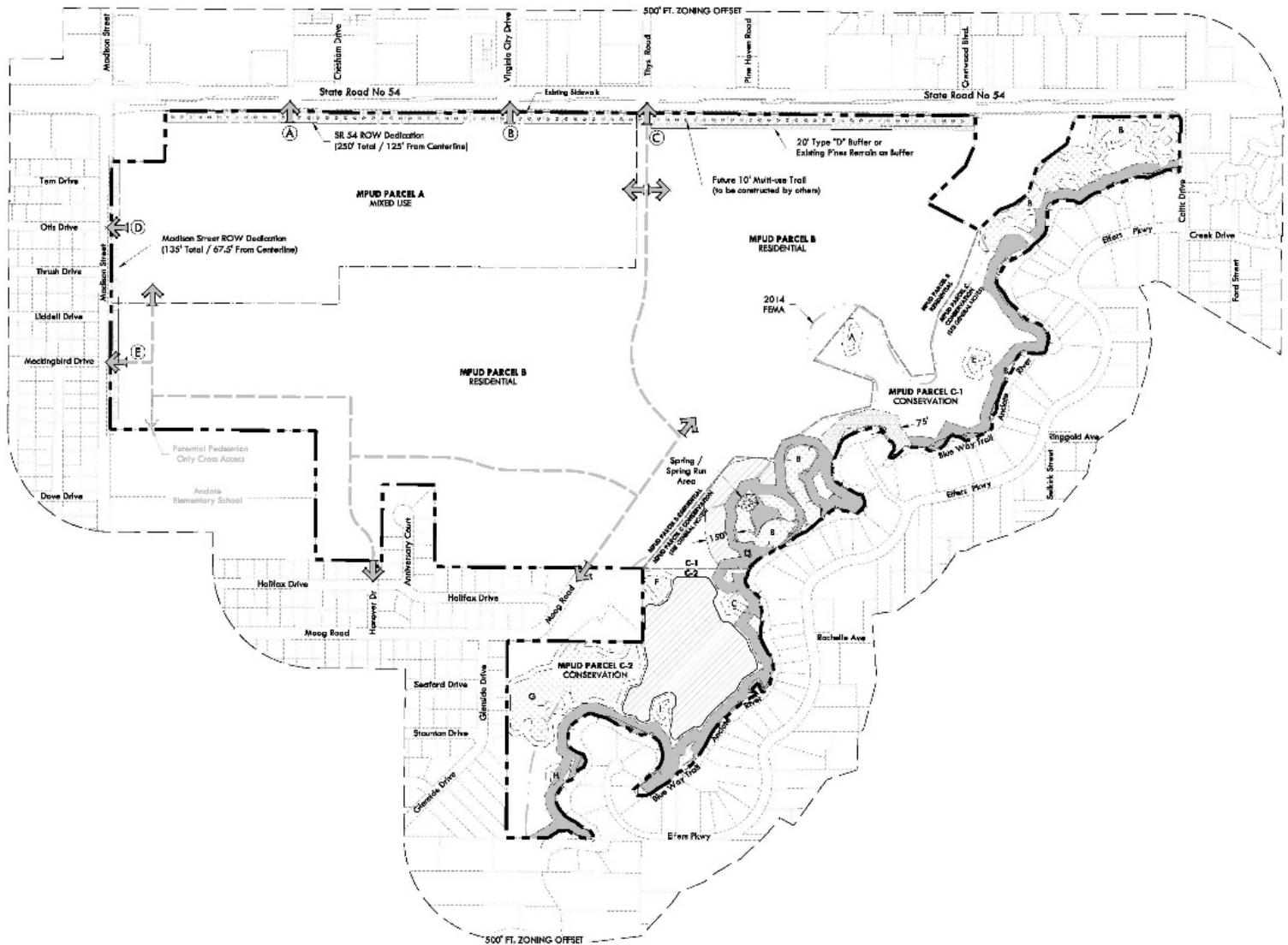

For more information, please contact:

Bruce Erhardt, ALC
Executive Managing Director
813.223.6300
Bruce.erhardt@cushwake.com

Patrick Berman
Managing Director
813.204.5363
Patrick.berman@cushwake.com

201 N. Franklin St., Suite 3300
Tampa, Florida 33602
T +1 813 223 6300



47.78± acres

Mixed Use, Office, Retail, Multifamily Land Development Site
Pasco County, FL

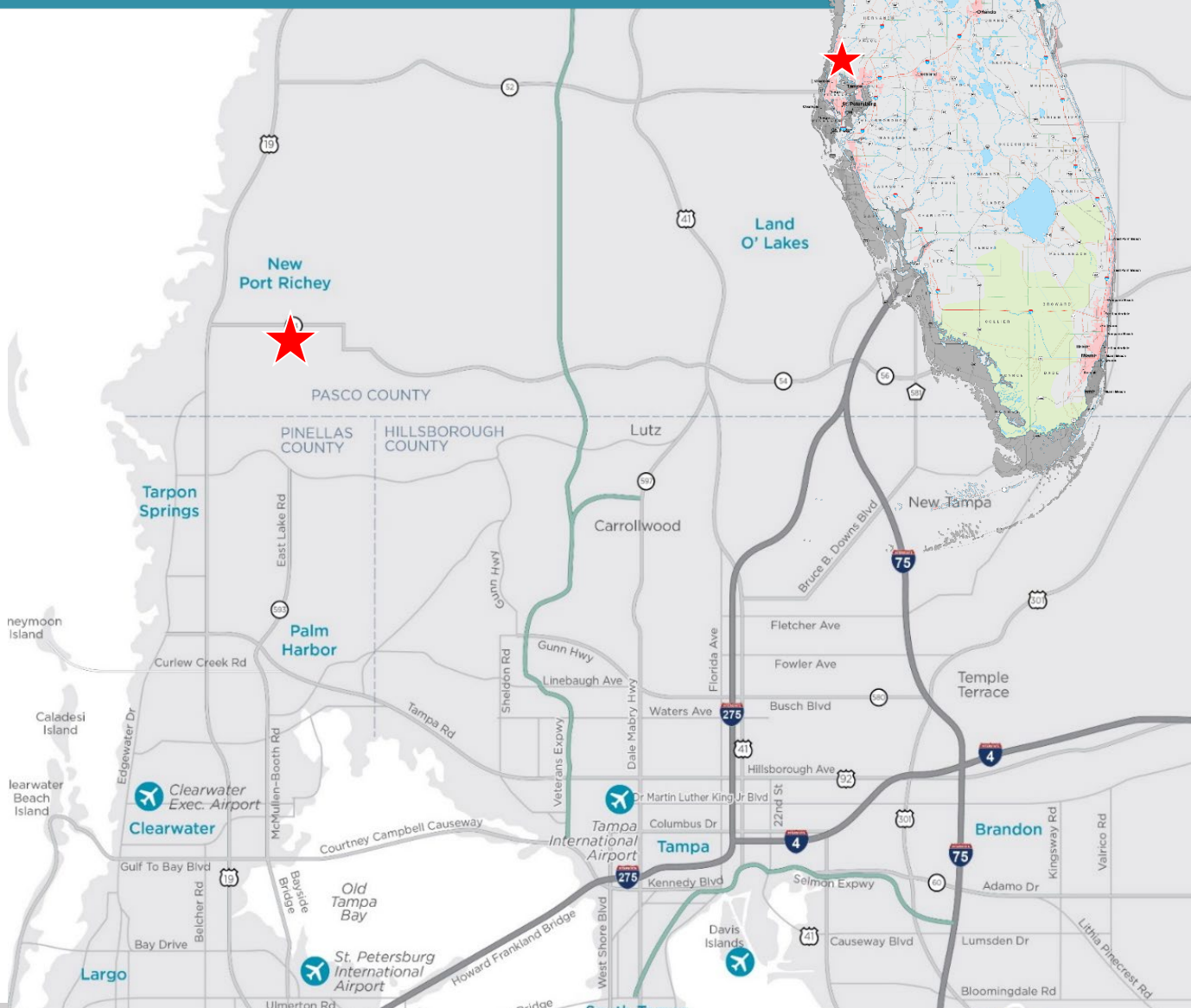

Bruce Erhardt, ALC
Executive Managing Director
813.223.6300
Bruce.erhardt@cushwake.com

Patrick Berman
Managing Director
813.204.5363
Patrick.berman@cushwake.com

201 N. Franklin St., Suite 3300
Tampa, Florida 33602
T +1 813 223 6300