

±46,057 Square Feet Available for Sublease through 10/31/2029



2401

**EAST MONTE VISTA AVE., SUITE 200
VACAVILLE, CA**

TYLER EPTING

Managing Director

925 548 3484

tyler.epting@cushwake.com

Lic #01317533

KRIS HAGAR

Senior Director

925 382 8887

kris.hagar@cushwake.com

Lic #02009499

BRYCE MACDONALD

Executive Director

916 288 4806

bryce.macdonald@cushwake.com

Lic #01422174



**CUSHMAN &
WAKEFIELD**

2401

EAST MONTE VISTA AVE., SUITE 200
VACAVILLE, CA



Property Features

- ±46,057 SF
- ±2,012 SF Office
 - *Five (5) Private Offices
 - *Three (3) Restrooms
 - *One (1) Large Conference Room
 - *One (1) Breakroom
- Seven (7) Dock High Doors (9' x 10')
- Two (2) Grade Level Doors (12' x 14')
- ESFR Sprinklers
- ±32' Clear Height (minimum)
- 60' x 52' Column Spacing
- Available Now
- 277/480 V Electrical Service
- Master Lease Expiration: 10/31/2029

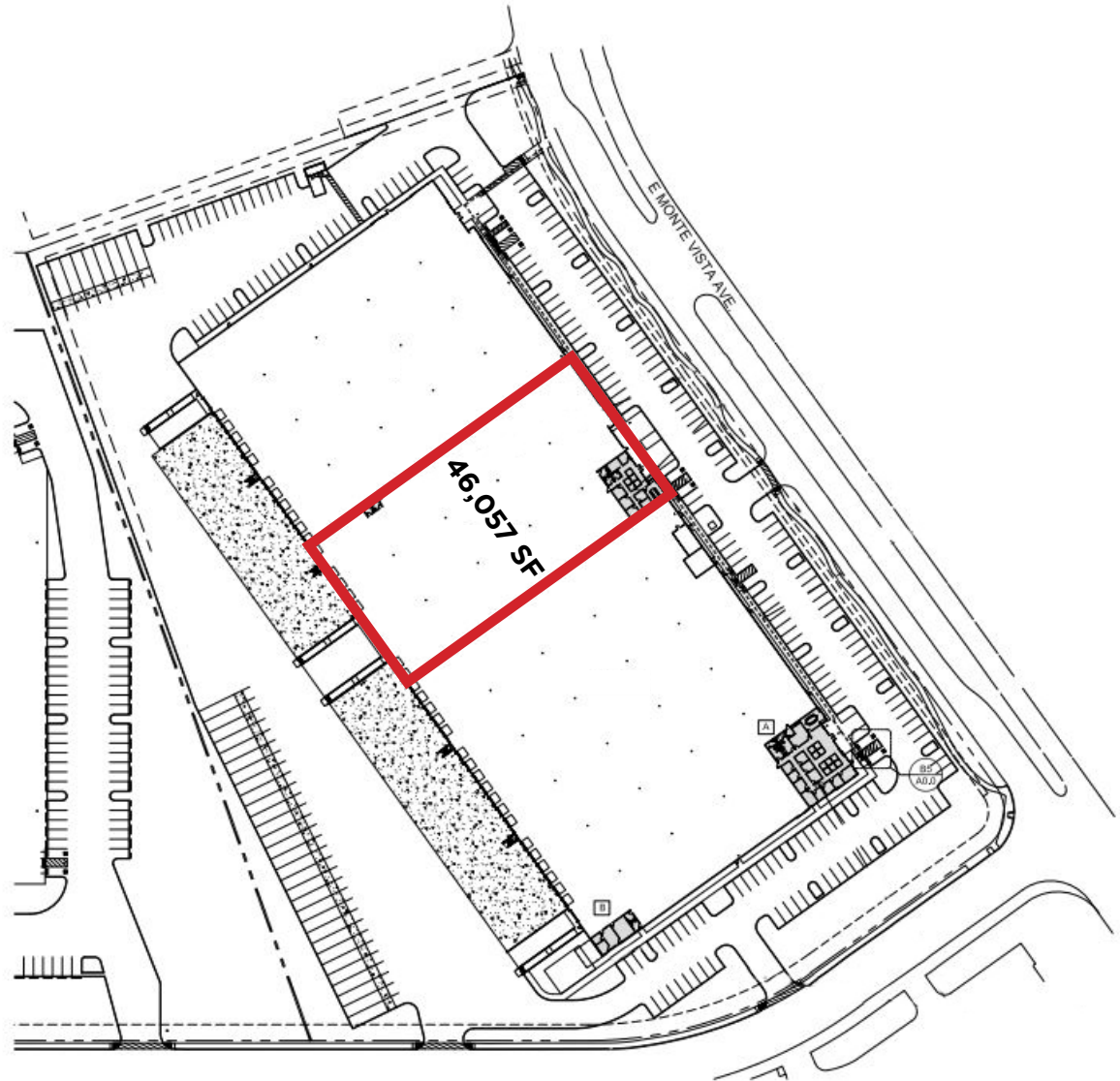

2401

EAST MONTE VISTA AVE., SUITE 200
VACAVILLE, CA



DISTANCE

Airports:	Miles
Sacramento International	37
Oakland International	60
Nut Tree Airport	2

Ports:	Miles
Port of Oakland	52
Port of San Francisco	56
Port of Redwood City	83
Port of Richmond	47
Port of Benicia/Amports	30
Port of West Sacramento	30
Port of Stockton	64

Amtrak:	Miles
Fairfield Vacaville Station	9

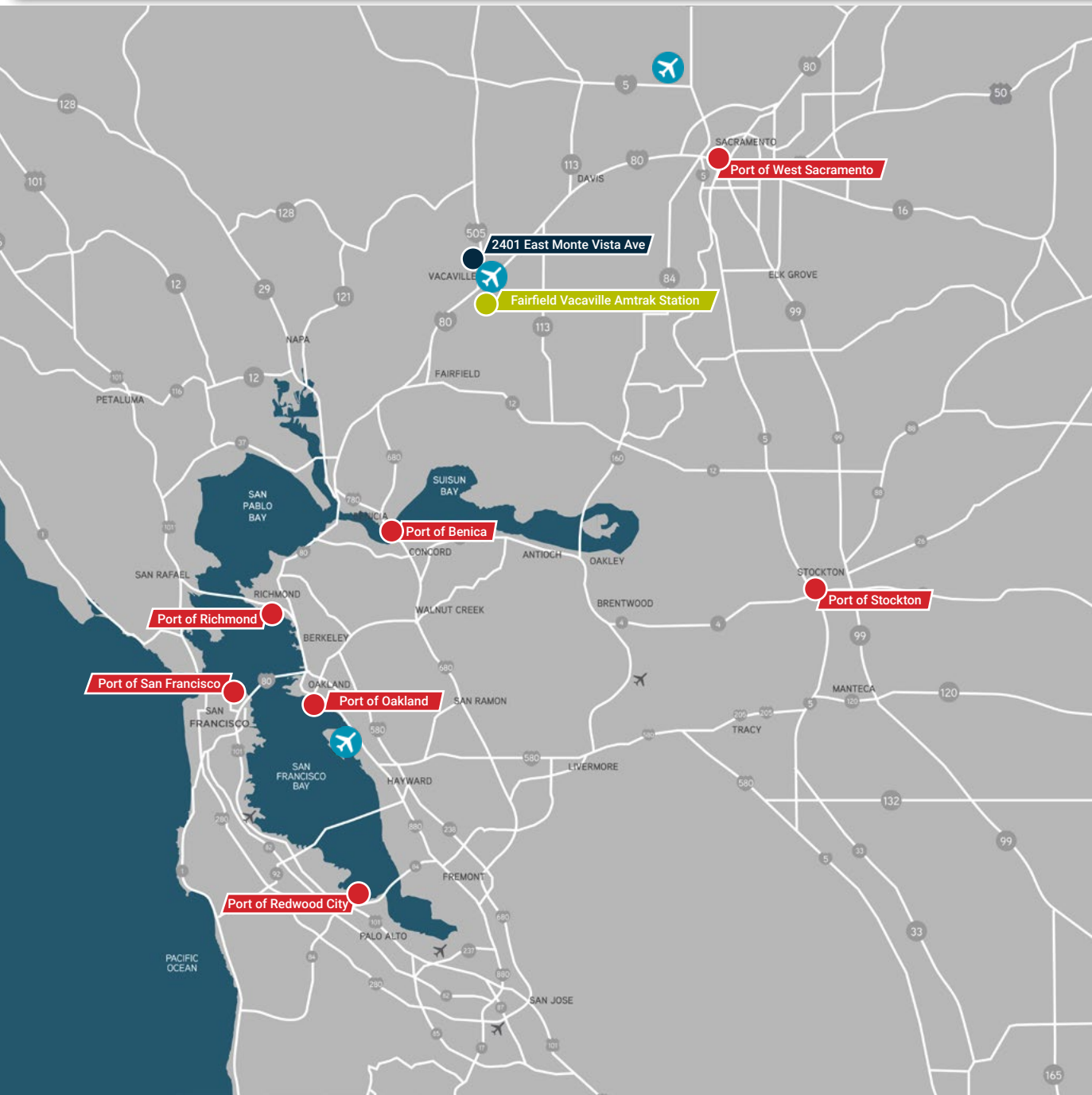

1.3 Miles



2401

EAST MONTE VISTA AVE., SUITE 200
VACAVILLE, CA

TYLER EPTING

Managing Director

925 548 3484

tyler.epting@cushwake.com

Lic #01317533

KRIS HAGAR

Senior Director

925 382 8887

kris.hagar@cushwake.com

Lic #02009499

BRYCE MACDONALD

Executive Director

916 288 4806

bryce.macdonald@cushwake.com

Lic #01422174



**CUSHMAN &
WAKEFIELD**

©2025 Cushman & Wakefield. All rights reserved. The information contained in this communication is strictly confidential. This information has been obtained from sources believed to be reliable but has not been verified. NO WARRANTY OR REPRESENTATION, EXPRESS OR IMPLIED, IS MADE AS TO THE CONDITION OF THE PROPERTY (OR PROPERTIES) REFERENCED HEREIN OR AS TO THE ACCURACY OR COMPLETENESS OF THE INFORMATION CONTAINED HEREIN, AND SAME IS SUBMITTED SUBJECT TO ERRORS, OMISSIONS, CHANGE OF PRICE, RENTAL OR OTHER CONDITIONS, WITHDRAWAL WITHOUT NOTICE, AND TO ANY SPECIAL LISTING CONDITIONS IMPOSED BY THE PROPERTY OWNER(S). ANY PROJECTIONS, OPINIONS OR ESTIMATES ARE SUBJECT TO UNCERTAINTY AND DO NOT SIGNIFY CURRENT OR FUTURE PROPERTY PERFORMANCE.