

<http://www.cbreim.com/logistics>

2765 Loker Ave

93,254 SF

(Divisible down to 38,593 SF)



2765 Loker Ave
Carlsbad, CA 92010



Total Available	93,254 SF (38,593 Divisible)
Office Space	To suit
Mezzanine	6,990 SF
Clear Height	30'
Dock Doors	7 Loading positions
Grade Level Doors	2 Drive-in doors
Power	3,000 - 4,000a 227/480v
HVAC	Fully HVAC warehouse

Year Built	1999
Sprinklers	Fully sprinklered (ESFR)
EV Charging	2 Auto spaces
Car Parking	245 (2.6/1000) Auto spaces
Column Spacing	48' x 48'
Lighting	LED with motion sensors
Site Size	5.22 acres
Amenities	Outdoor break area

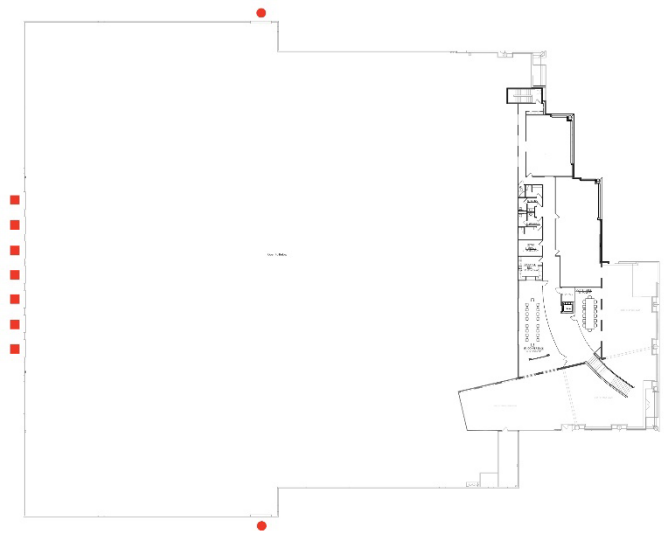
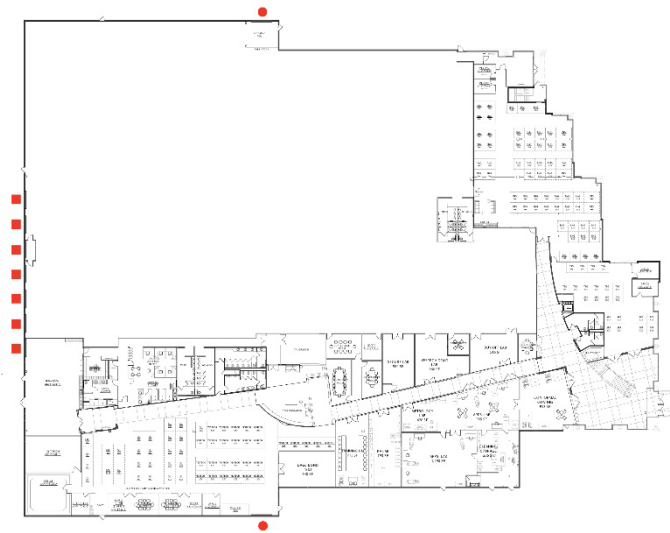

■ Dock Door
● Drive-in Door



Contact us

LEASED BY:

Cushman & Wakefield

Brant Aberg, SIOR

Vice Chairman

D: +1 858 546 5454

C: +1 858 413 5600

brant.aberg@cushwake.com

OPERATED BY:

CBRE Investment Management

Brian Woolford

Asset Manager

+1 949 514 1412

brian.woolford@cbreim.com

© 2024 CBRE, Inc. All rights reserved. This information has been obtained from sources believed reliable but has not been verified for accuracy or completeness. You should conduct a careful, independent investigation of the property and verify all information. Any reliance on this information is solely at your own risk.

CBRE and the CBRE logo are service marks of CBRE, Inc. All other marks displayed on this document are the property of their respective owners, and the use of such logos does not imply any affiliation with or endorsement of CBRE. Photos herein are the property of their respective owners. Use of these images without the express written consent of the owner is prohibited.