



### PROPERTY HIGHLIGHTS

**Address:** 4190 Eagle Hill Drive  
**Type:** Distribution / Office  
**Available SF:** 343,000 ± SF (Expandable to 480,000 ± SF)  
**Office SF:** 30,000 ± SF  
**Mezzanine SF:** 28,000 ± SF  
**Year Built:** 2002  
**Clear Height:** 34' ±

**Sprinkler:** ESFR  
**Column Spacing:** 48' x 50' & 65' x 50'  
**Dock Doors:** (30) Dock Height & (1) 12' x 14' Drive-In  
**Expansion Area:** 451' x 304' = 137,104 SF  
**Parking:** 175 Car Spaces & 20 Trailer Spaces  
**Utilities:** All Municipal

**William Woltz**  
 Vice Chairman  
 +1 336 821 3824  
[william.woltz@cushwake.com](mailto:william.woltz@cushwake.com)

**John Schultz**  
 Managing Director  
 +1 336 812 3301  
[john.schultz1@cushwake.com](mailto:john.schultz1@cushwake.com)

**Jordan Mitchell**  
 Senior Director  
 +1 336 201 0495  
[jordan.mitchell@cushwake.com](mailto:jordan.mitchell@cushwake.com)

121-D Reynolda Village  
 Winston-Salem, NC 27106 | USA  
 Main: +1 336 668 9999  
 Fax: +1 336 668 0888  
[cushmanwakefield.com](http://cushmanwakefield.com)

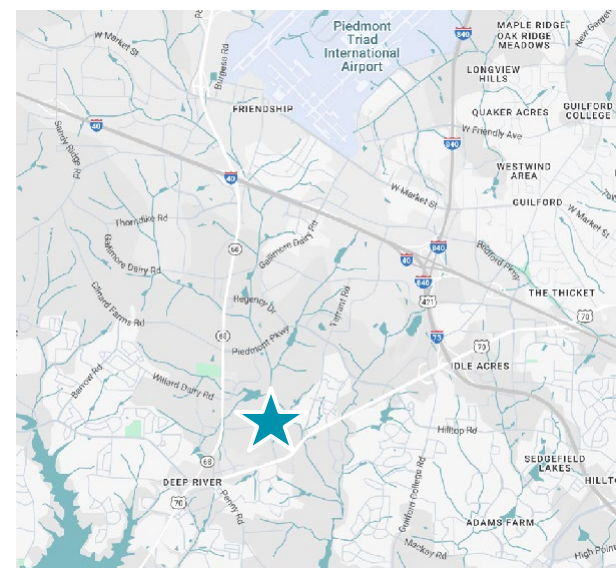





**4190 EAGLE HILL DRIVE**  
High Point, NC 27265

**UP TO 343,000 SF**  
AVAILABLE FOR SUBLEASE









### WAREHOUSE PLAN

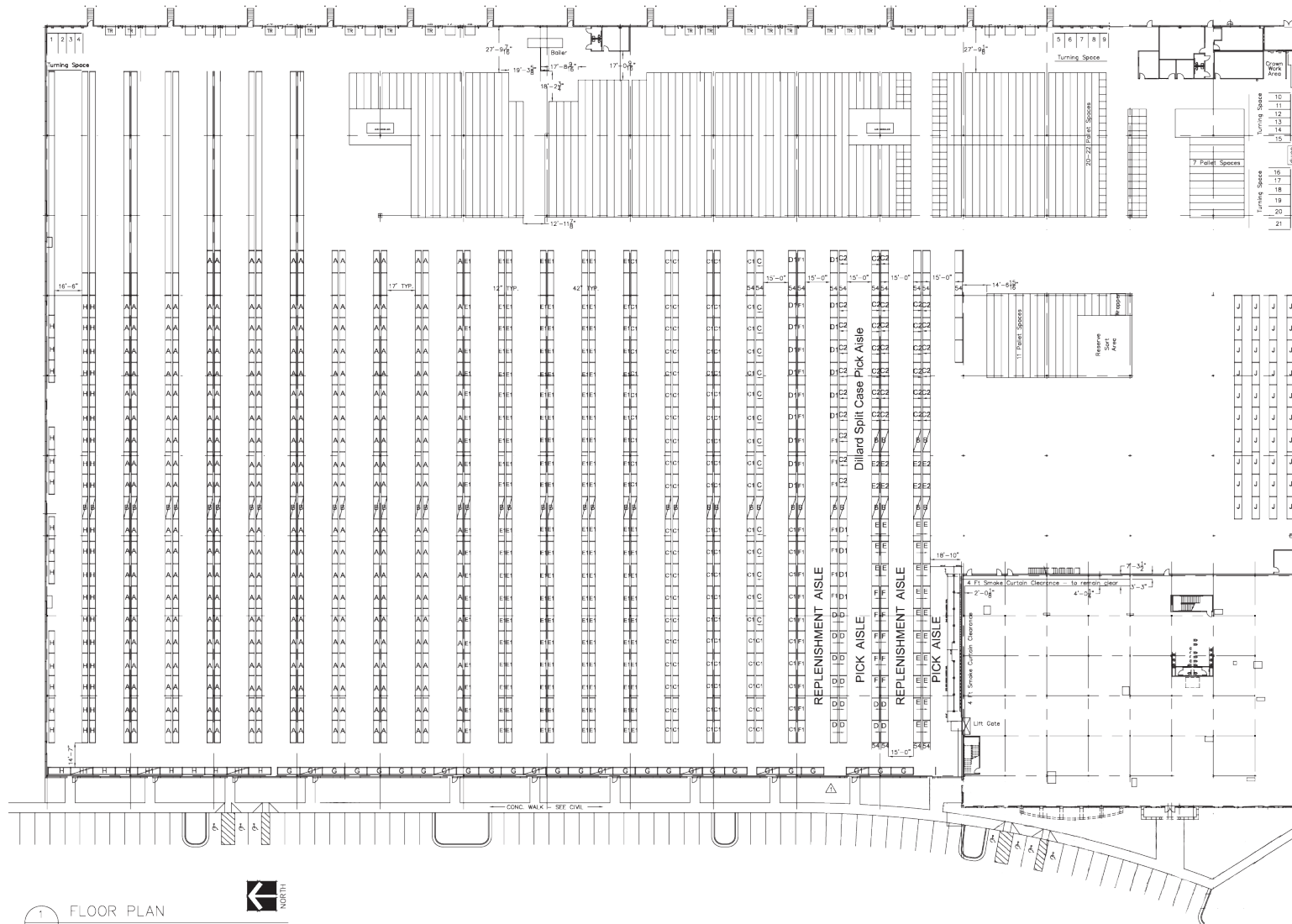



**CUSHMAN &  
WAKEFIELD**

**4190 EAGLE HILL DRIVE**  
High Point, NC 27265

**UP TO 343,000 SF**  
AVAILABLE FOR SUBLEASE

## OFFICE PLAN

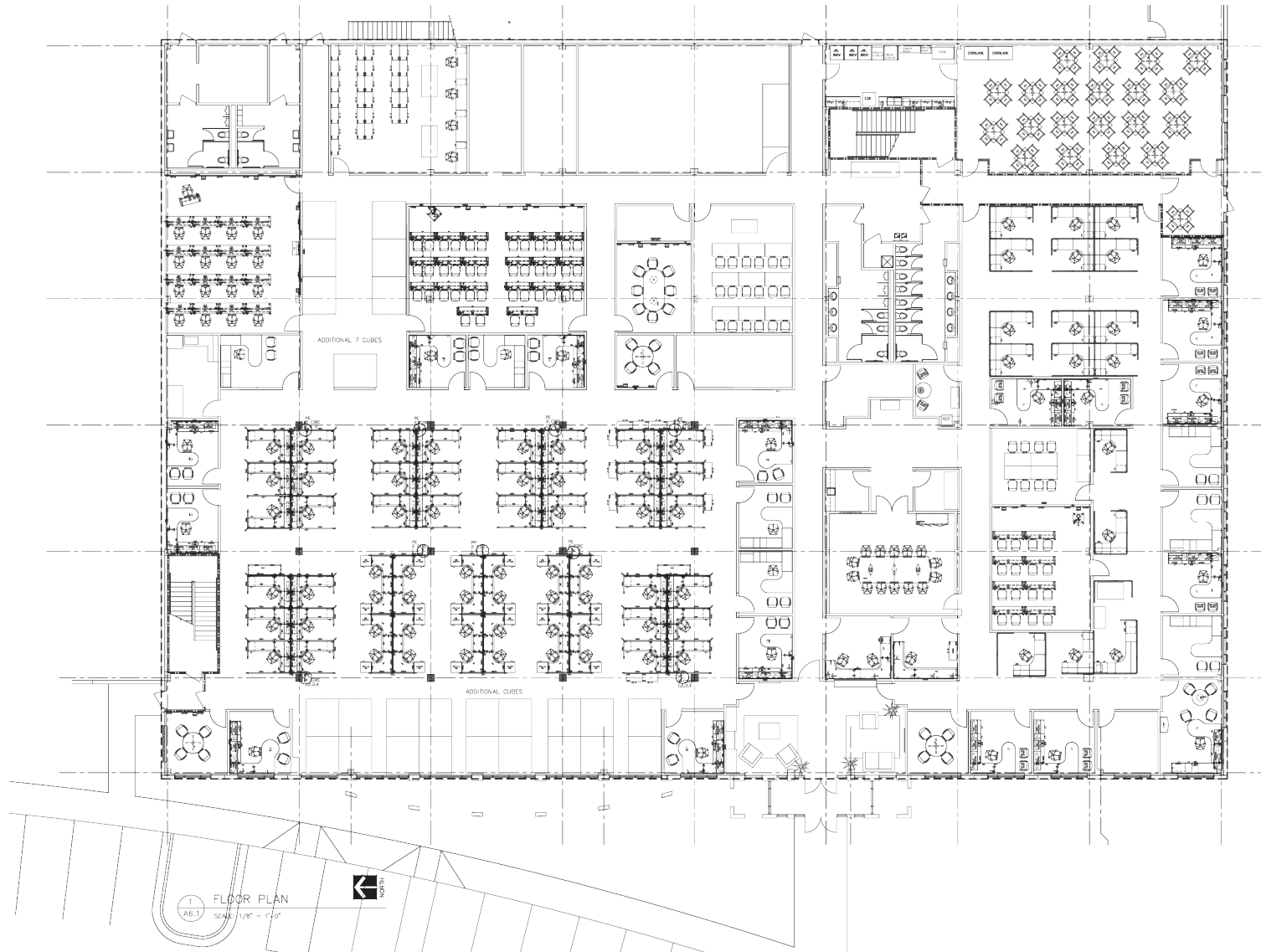

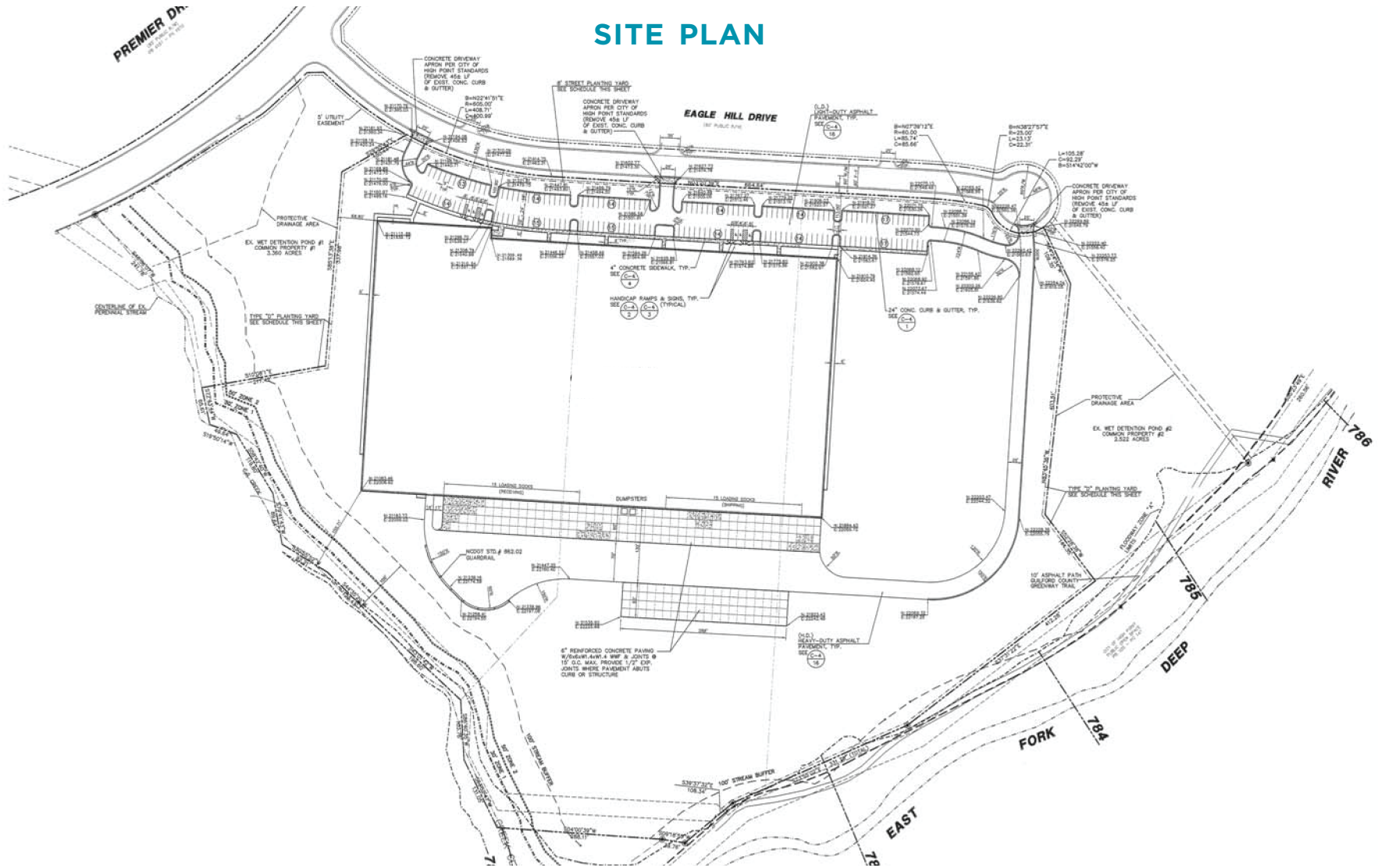

**William Woltz**  
Vice Chairman  
+1 336 821 3824  
william.woltz@cushwake.com

**John Schultz**  
Managing Director  
+1 336 812 3301  
john.schultz1@cushwake.com

**Jordan Mitchell**  
Senior Director  
+1 336 201 0495  
jordan.mitchell@cushwake.com

121-D Reynolda Village  
Winston-Salem, NC 27106 | USA  
Main: +1 336 668 9999  
Fax: +1 336 668 0888  
[cushmanwakefield.com](http://cushmanwakefield.com)