

FOR SALE

125 N JACKSON AVE

Suite 107 | San Jose, CA



RARE GROUND FLOOR MEDICAL OFFICE CONDO

PROPERTY HIGHLIGHTS

- ±931 SF Ground Floor Medical Office Condo
- Efficient Layout with 4 Offices, Lobby, Reception and Restroom
- Plumbing for Dentist Available
- Separate Storage
- Ample Free Parking in Structure
- Adjacent to Regional Medical Center
- Excellent Access to I-680 and Highway 101
- One Mile to VTA Light Rail @ McKee Station
- Currently Occupied but can be Delivered Vacant at Closing
- DO NOT DISTURB TENANT
- **Sale Price: \$372,000**

For more information, contact:

MIKI CORREA

Managing Director

+1 408 642 0826

miki.correa@cushwake.com

LIC #01718959

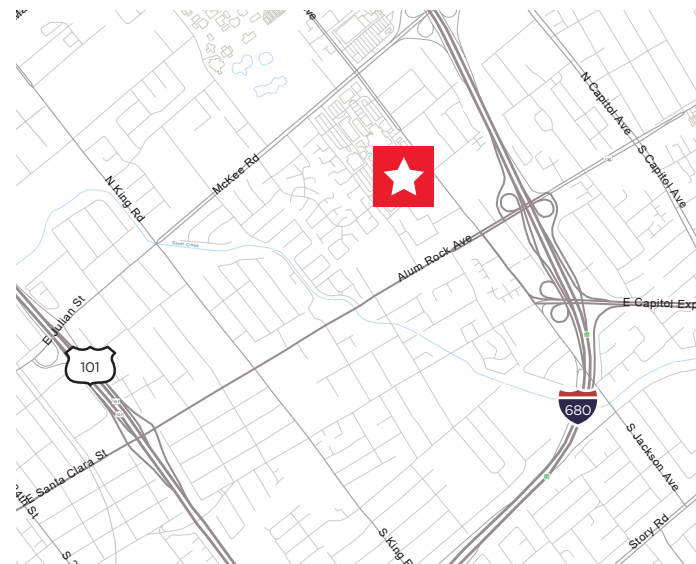

300 Santana Row, Fifth Floor

San Jose, CA

Main +1 408 615 3400

Fax +1 408 615 3444

cushmanwakefield.com



125 N JACKSON AVE

Suite 107 | San Jose, CA

±931 SF FOR SALE



FLOOR PLAN

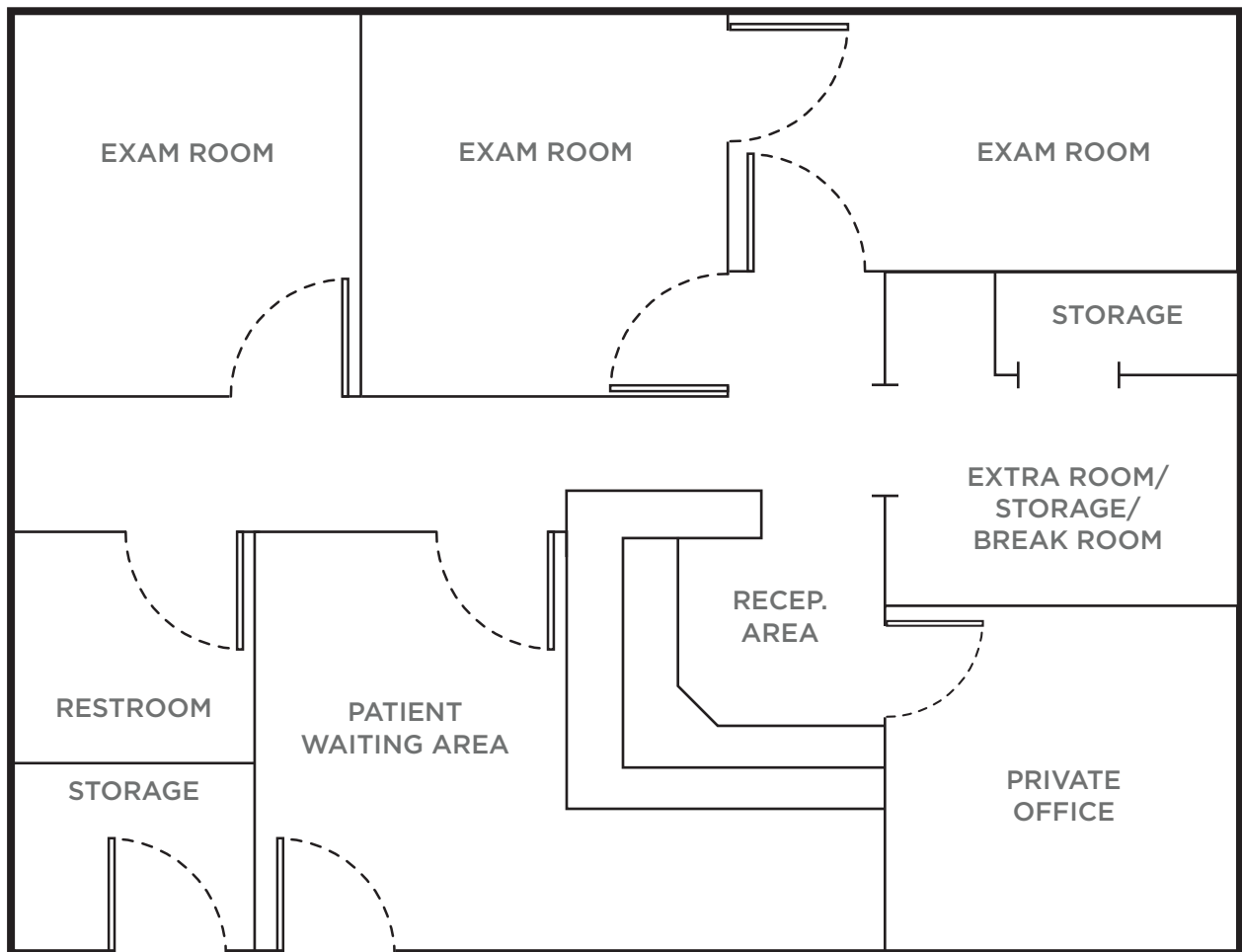

MIKI CORREA
Managing Director
+1 408 642 0826
miki.correa@cushwake.com
LIC #01718959

300 Santana Row, Fifth Floor
San Jose, CA 95128
Main +1 408 615 3400
Fax +1 408 615 3444
cushmanwakefield.com



125 N JACKSON AVE

Suite 107 | San Jose, CA

±931 SF FOR SALE



AERIAL/LOCATION MAP

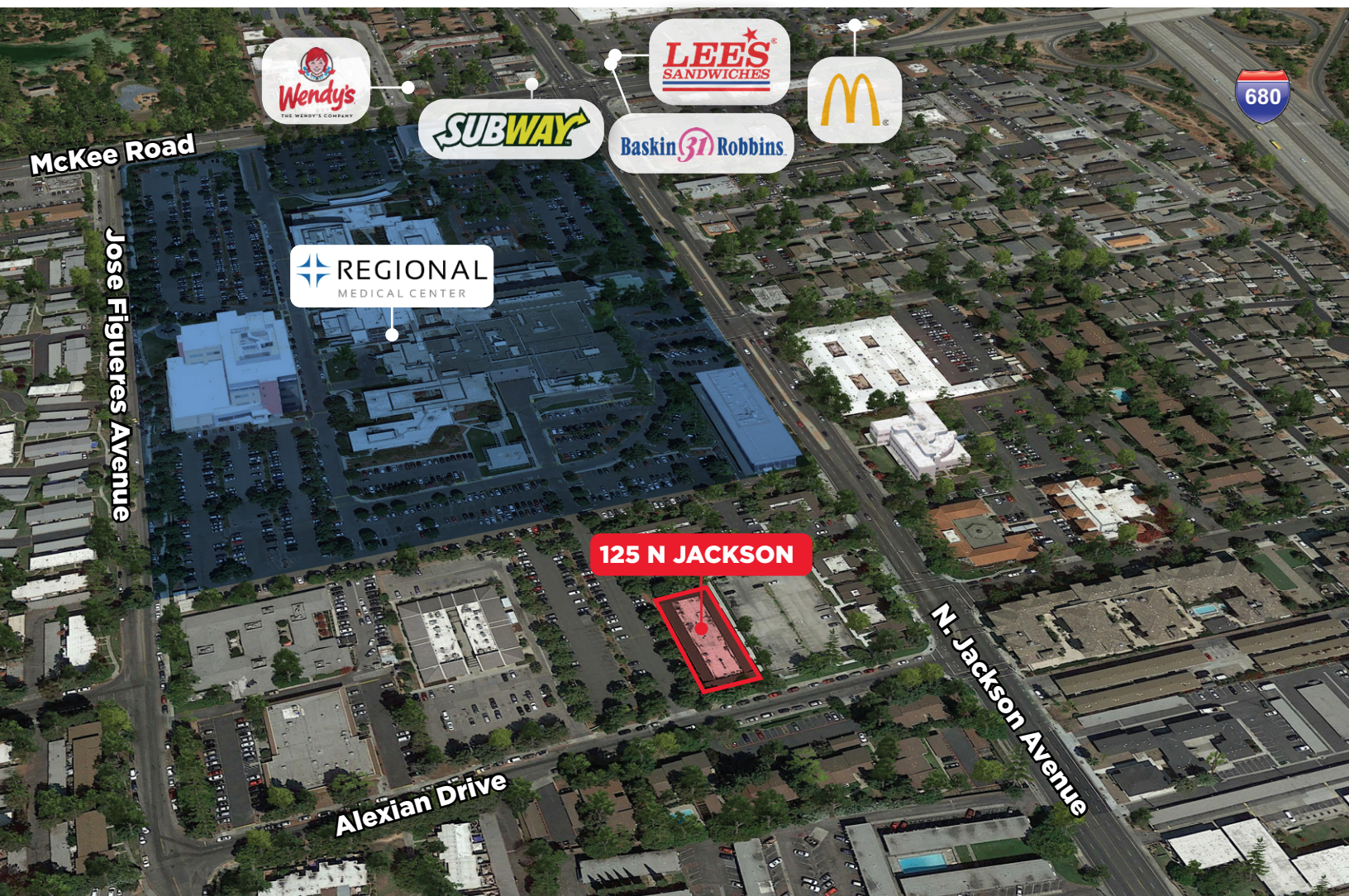

MIKI CORREA

Managing Director

+1 408 642 0826

miki.correa@cushwake.com

LIC #01718959

300 Santana Row, Fifth Floor

San Jose, CA 95128

Main +1 408 615 3400

Fax +1 408 615 3444

cushmanwakefield.com