

WAREHOUSE / STORAGE SPACE WITH YARD
FOR LEASE
± 107,000 SF



1700 W 4TH ST
ANTIOCH, CA

PROPERTY HIGHLIGHTS

±107,000 SF with large yard!

Clear Height	16-22' (to be verified)
Loading	Dock- and Grade-level
Zoning	M-1 Light Industrial
Power	2500 Amps @ 277/480 (to building)
Column Spacing	40' x 72', 40 x 67', 40' x 90'
Sprinklers	Yes
Access	360 access capabilities
Yard	±2.5 Acres available, partially paved
Pricing	\$0.65/SF Industrial Gross



SITE PLAN

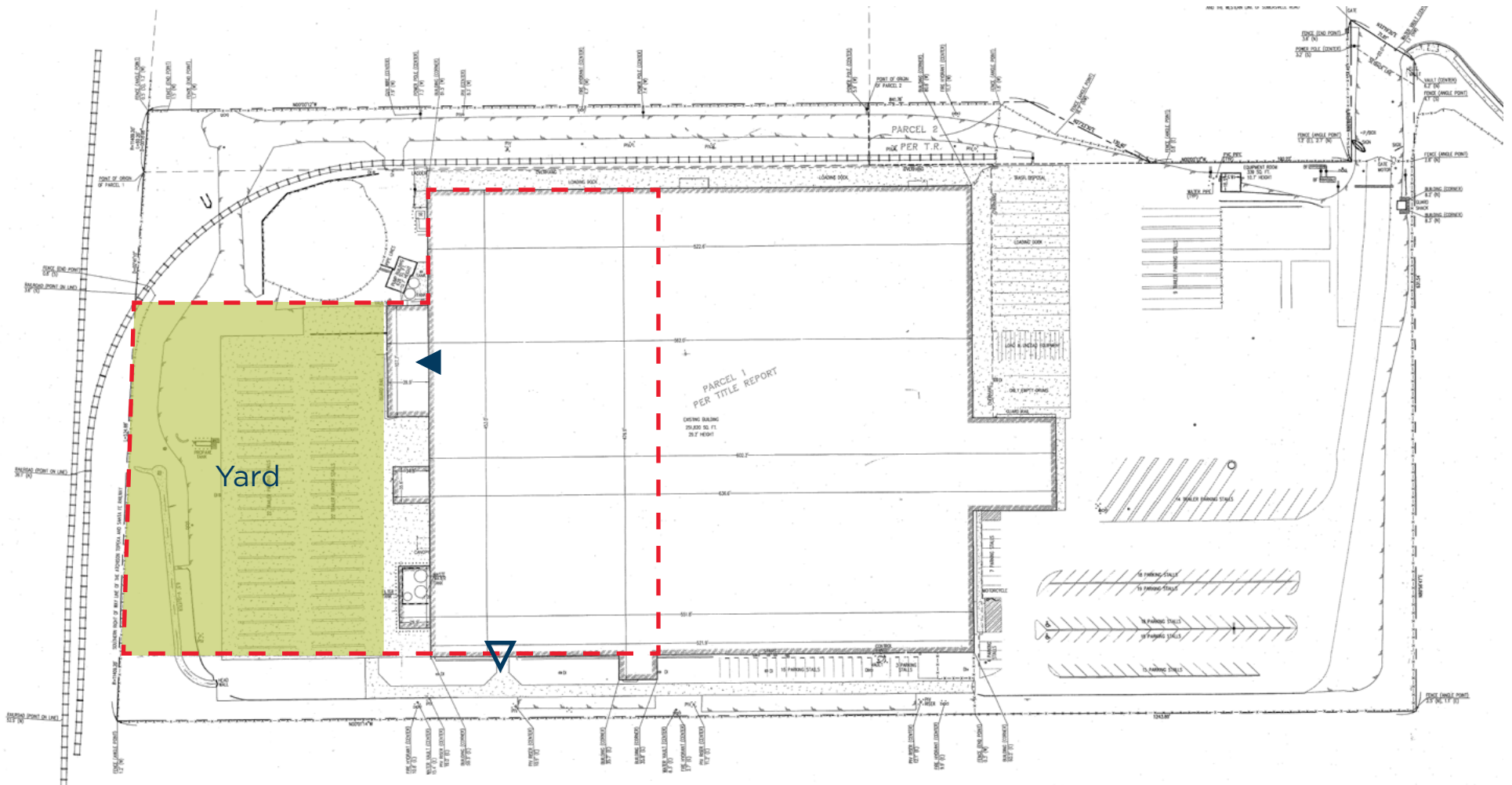

△ Grade Level Loading

▲ Dock-Level Loading



STRATEGICALLY
LOCATED
OPPORTUNITY



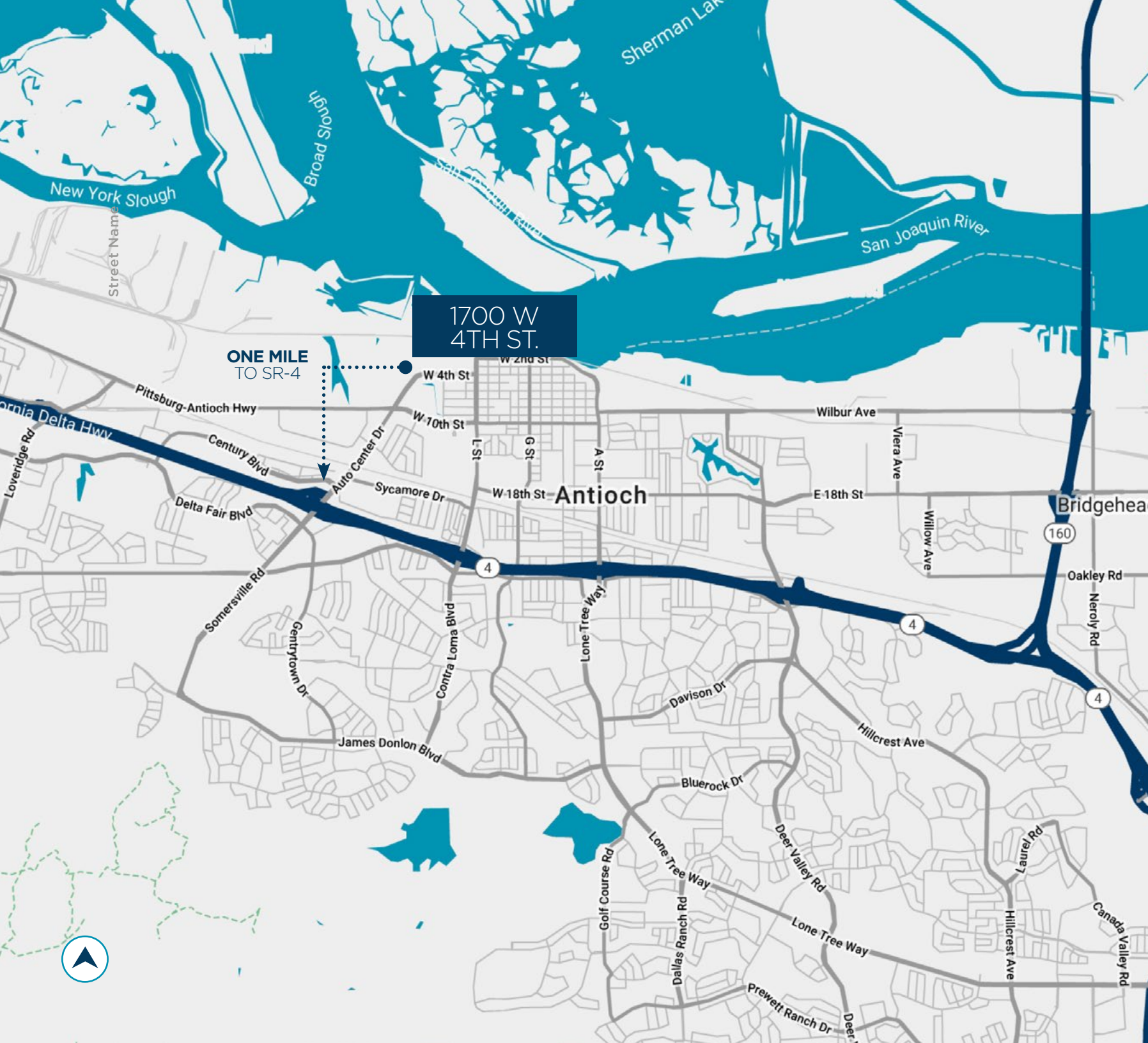

CONTACT INFORMATION

Tyler Epting

Managing Director

+1 925 548 3484

tyler.epting@cushwake.com

LIC #01317533

Kris Hagar, SIOR

Senior Director

+1 925 382 8887

kris.hagar@cushwake.com

LIC#02009499

