

# FOR SUBLEASE

155,367 AVAILABLE WAREHOUSE | 1885 ALAMAC ROAD, LUMBERTON



## CONTACTS:

### FERMIN DEOCA

Executive Managing Director  
+1 704 335 4436  
fermin.deoca@cushwake.com

### LAUREN ABSHER

Brokerage Specialist  
+1 704 916 1559  
lauren.absher@cushwake.com

### PATRICK MCGRATH

Senior Director  
+1 704 887 338  
patrick.mcgrath@cushwake.com





## PROPERTY HIGHLIGHTS

- **SF:** 155,367 Available Warehouse
- **Column spacing:** 30' x 50'
- **Clear Height:** 20' - 31'
- **Zoning:** I-2
- **Sprinklers:** Wet System
- **Opex Est:** \$.48/SF
- **Year Built:** 1962 Renovated 2023
- **Floors:** 6" Inch Reinforced
- **DH Doors:** 10
- **Office SF:** 936 SF
- **Power:** 3,000 AMPS
- **Term expires:** 9/30/2027
- Wastewater treatment facility on-site
- Close proximity to I-74 & I-95
- Gate guard and perimeter security fencing to truck courts
- Trailer parking

# FLOOR PLAN

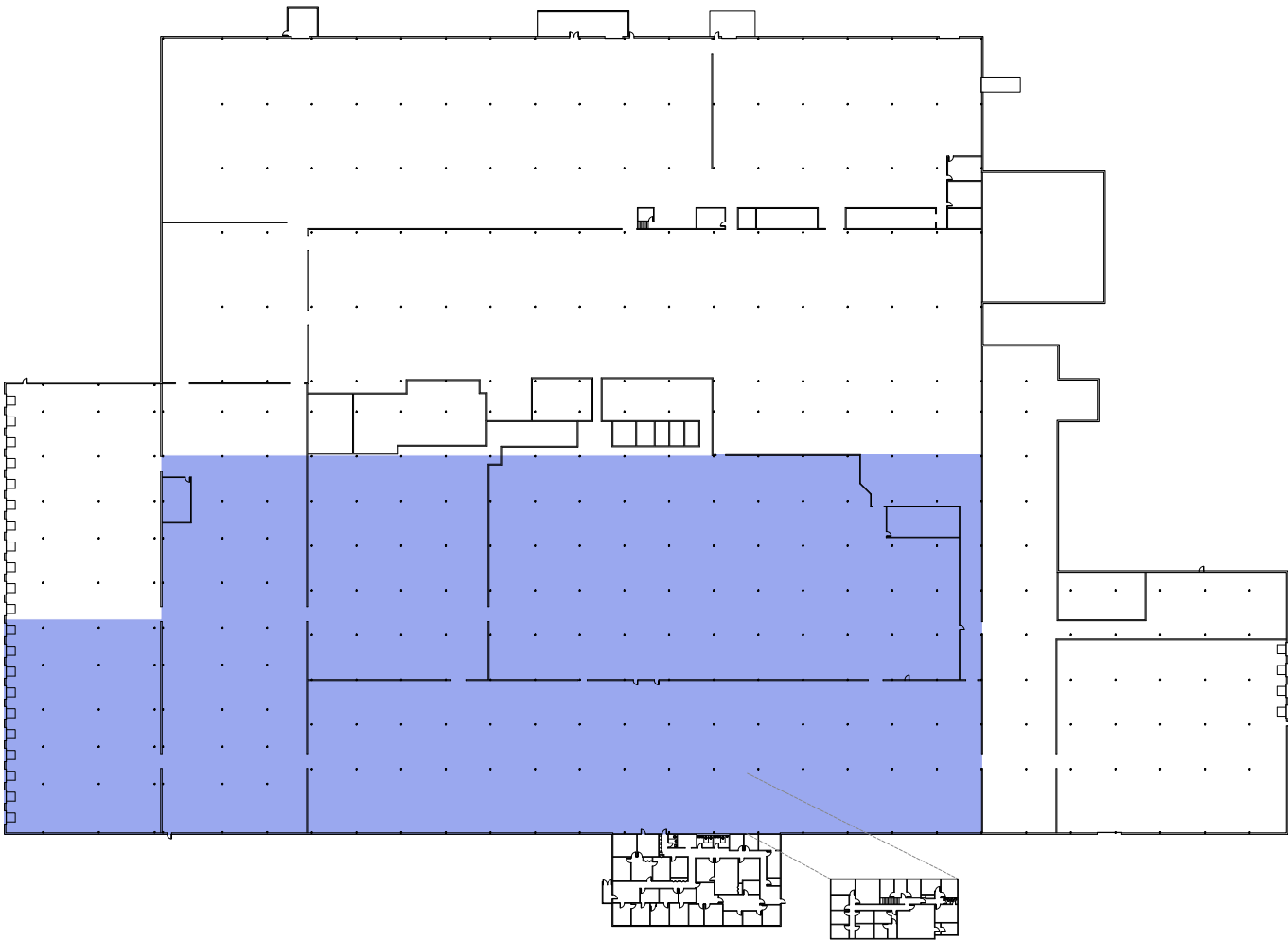

# LOCATION MAP

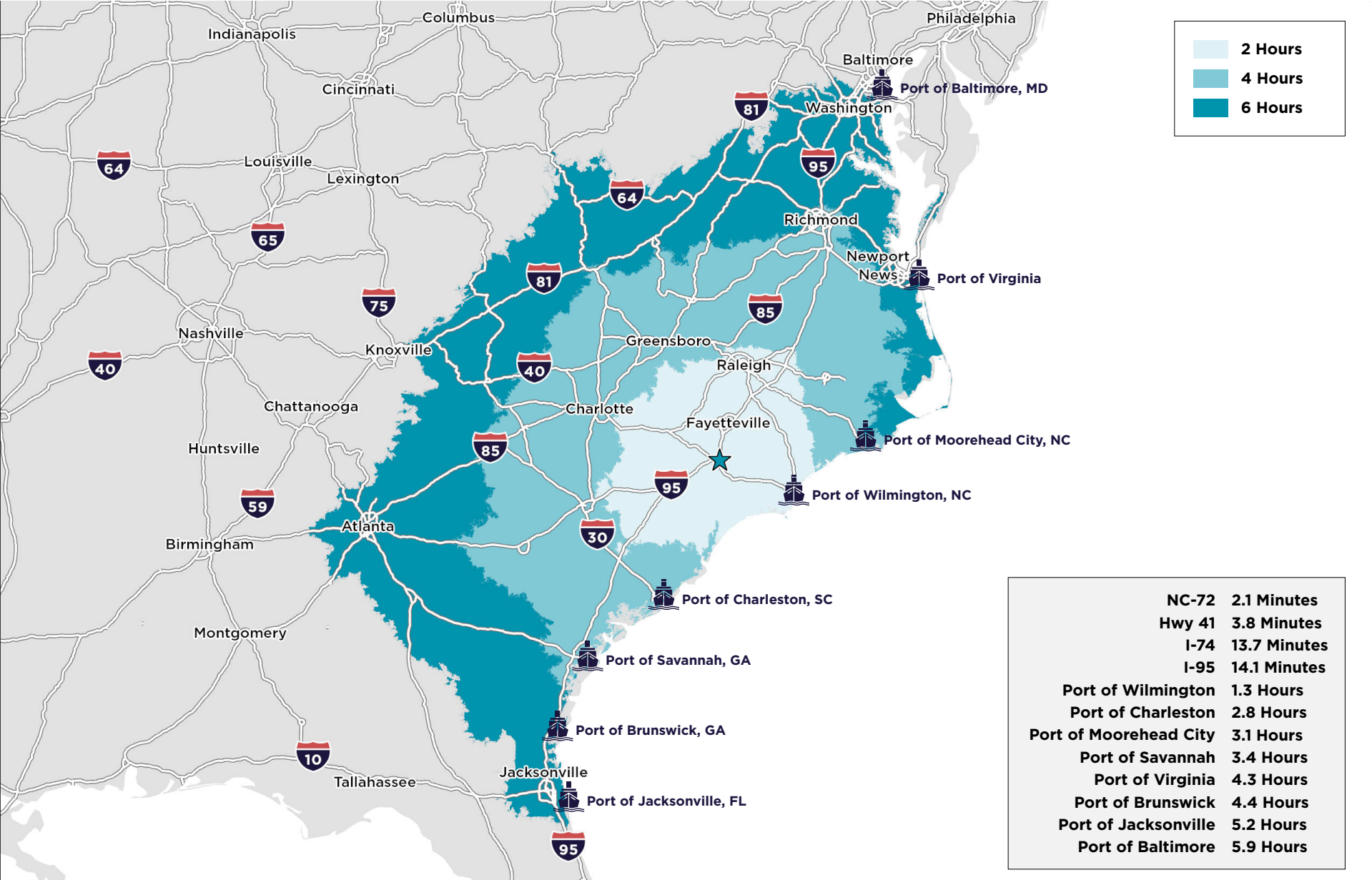



## CONTACTS:

---

### **FERMIN DEOCA**

Executive Managing Director  
+1 704 335 4436  
[fermin.deoca@cushwake.com](mailto:fermin.deoca@cushwake.com)

### **PATRICK MCGRATH**

Senior Director  
+1 704 887 338  
[patrick.mcgrath@cushwake.com](mailto:patrick.mcgrath@cushwake.com)

### **LAUREN ABSHER**

Brokerage Specialist  
+1 704 916 1559  
[lauren.absher@cushwake.com](mailto:lauren.absher@cushwake.com)

©2025 CUSHMAN & WAKEFIELD. ALL RIGHTS RESERVED. THE MATERIAL IN THIS PRESENTATION HAS BEEN PREPARED SOLELY FOR INFORMATION PURPOSES, AND IS STRICTLY CONFIDENTIAL. ANY DISCLOSURE, USE, COPYING OR CIRCULATION OF THIS PRESENTATION (OR THE INFORMATION CONTAINED WITHIN IT) IS STRICTLY PROHIBITED, UNLESS YOU HAVE OBTAINED CUSHMAN & WAKEFIELD'S PRIOR WRITTEN CONSENT. THE VIEWS EXPRESSED IN THIS PRESENTATION ARE THE VIEWS OF THE AUTHOR AND DO NOT NECESSARILY REFLECT THE VIEWS OF CUSHMAN & WAKEFIELD. NEITHER THIS PRESENTATION NOR ANY PART OF IT SHALL FORM THE BASIS OF, OR BE RELIED UPON IN CONNECTION WITH ANY OFFER, OR ACT AS AN INDUCEMENT TO ENTER INTO ANY CONTRACT OR COMMITMENT WHATSOEVER. NO REPRESENTATION OR WARRANTY IS GIVEN, EXPRESS OR IMPLIED, AS TO THE ACCURACY OF THE INFORMATION CONTAINED WITHIN THIS PRESENTATION, AND CUSHMAN & WAKEFIELD IS UNDER NO OBLIGATION TO SUBSEQUENTLY CORRECT IT IN THE EVENT OF ERRORS.

