

# Office/R&D/Lab for Lease

±14,142 SF



HIGH IMAGE CORNER LOCATION

176

COMPONENT DR.

SAN JOSE, CA



# 176

## COMPONENT DR.

SAN JOSE, CA

### FLOOR PLAN

- Concrete
- Polished Concrete
- Carpet
- VCT
- LVT

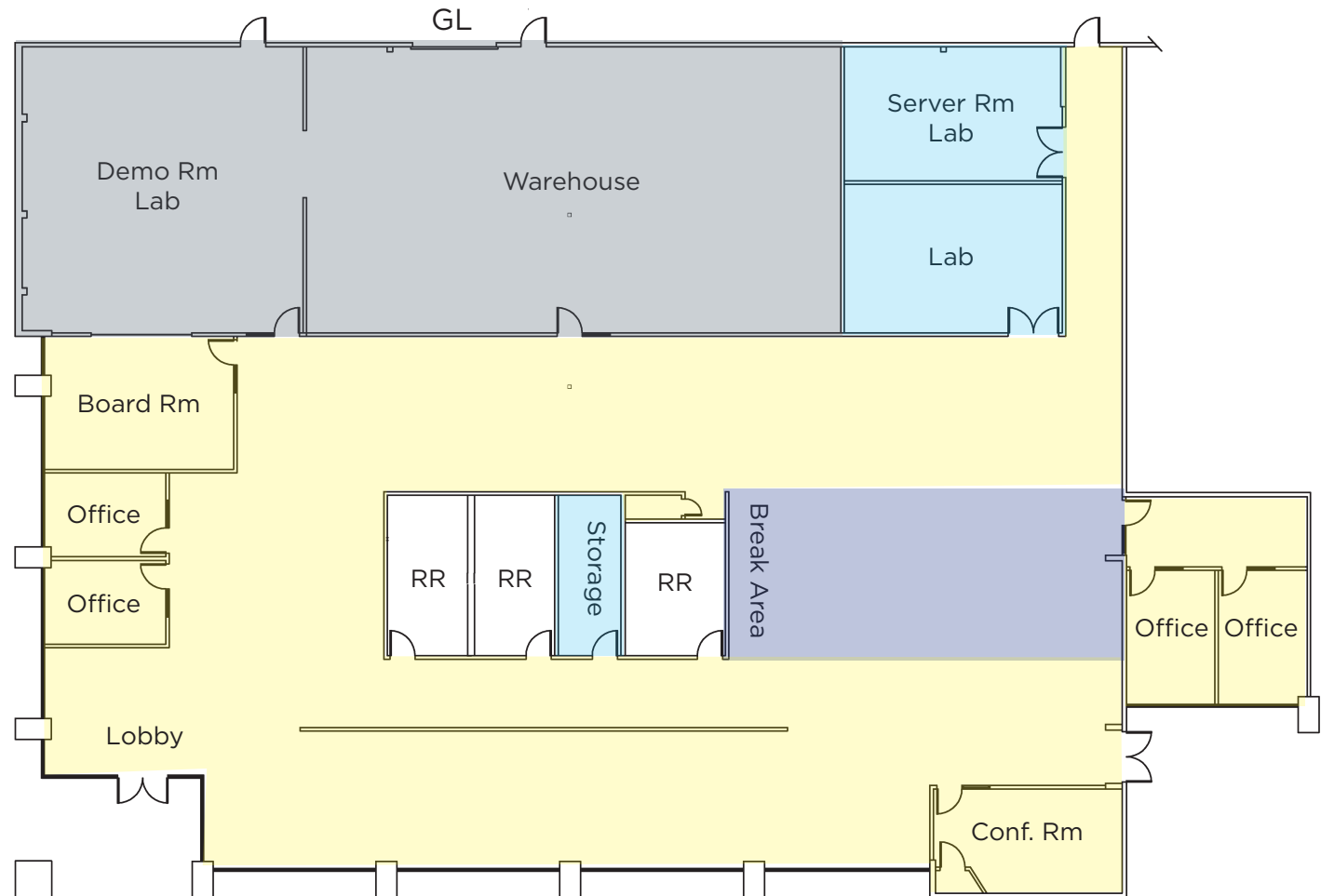

NOT TO SCALE

# 176

## COMPONENT DR.

SAN JOSE, CA

### PROPERTY HIGHLIGHTS

- High Image Corner Location
- Open Creative Office Ceiling
- Prominent Monument Signage
- 1,400 Amps @ 208 Volts
- HVAC Capacity 52.5 Tons
- Grade Level Loading
- New Roof
- Plentiful Lab & Demonstration Areas
- Flexible Open Landscape Interiors
- Low Operating Expenses



#### STEVE PACE

P +1 408 482 7037  
steve.pace@cushwake.com  
LIC #00817396

#### DAN HOLLINGSWORTH

P +1 408 615 3431  
dan.hollingsworth@cushwake.com  
LIC #01117716

#### TIANA DAMPIER

P +1 408 436 3680  
tiana.dampier@cushwake.com  
LIC #02191012

300 Santana Row, Fifth Floor  
San Jose, California 95128  
P +1 408 615 3400  
www.cushmanwakefield.com

